

PLAN  
 SURVEYED, PLOTTED, CHECKED, RE-CHECKED, DATE, BY, NO.

PROFILE  
 SURVEYED, GRADED, CHECKED, STRUCTURE NOTATIONS CHECKED, DATE, BY, NO.

|      |      |
|------|------|
| 1778 | 1778 |
| 1774 | 1774 |
| 1770 | 1770 |

GENERAL NOTES (L.V.V.W.D.)

1. ALL WORK TO CONFORM TO LAS VEGAS VALLEY WATER DISTRICT STANDARD PLATES.
2. ALL WORK, EXCEPT AS MODIFIED HEREON OR BY NOTE NO. 1 SHALL BE DONE IN ACCORDANCE WITH THE MOST CURRENT DRAFT OR EDITION OF UNIFORM STANDARD SPECIFICATIONS FOR PUBLIC WORKS (CONSTRUCTION OFF-SITE IMPROVEMENTS CLARK COUNTY AREA).
3. NOTICE TO BE GIVEN ENGINEERING DEPARTMENT OF THE LAS VEGAS VALLEY WATER DISTRICT 48 HOURS PRIOR TO ACTUAL CONSTRUCTION.
4. SERVICE SADDLES OR TAPPED COLLARS WILL BE REQUIRED ON ALL SERVICES. DOUBLE TAP COLLARS ARE NOT PERMITTED.
5. ALL LINES TO BE PRESSURE TESTED TO 200 PSI.
6. ALL VALVE BOXES SHALL HAVE CONCRETE COLLARS AT SURFACE OF PAVED AREAS.
7. DEFLECTION ANGLE SHALL NOT EXCEED 2% DEGREES PER 13 FOOT SECTION OF PIPE FOR PIPE SIZES SMALLER THAN 14 INCHES AND SHALL NOT EXCEED 2 DEGREES FOR PIPE SIZES BETWEEN 14" AND 16".
8. ALL METERS SHALL BE LOCATED OUTSIDE OF DRIVEWAYS.
9. SERVICE LATERALS FOR LOTS WILL BE TAPPED ON EXISTING MAIN BY OWNER'S CONTRACTOR UNDER DIRECTION OF THE LAS VEGAS VALLEY WATER DISTRICT.
10. DETECTOR TAP REQUIRED IN ACCORDANCE WITH STANDARD PLATE NO. 27 WHERE INDICATED AND AS FOLLOWS:
  - A. OVER ALL MAINS NOT INSTALLED AT 8 FEET FROM BACK OF CURB.
  - B. OVER ALL SERVICE LATERALS NOT INSTALLED AT RIGHT ANGLES TO MAINS.

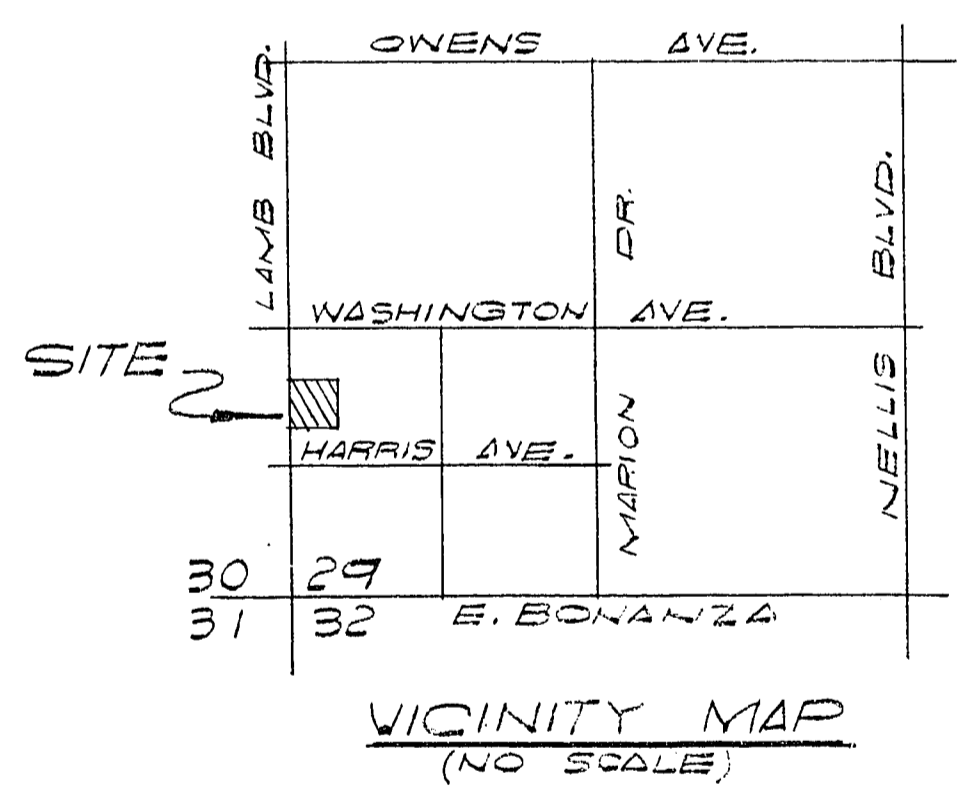

STREET LIGHT QUANTITIES (ESTIMATE FOR BONDING ONLY)

|   |          |
|---|----------|
| 250 W. H.P.S.   | 1 EA.    |
| UNDERGROUND CONDUIT (1 1/4")                                  | 102 L.F. |
| NEW SERVICE POINT (ST. LT. SERVICE WIRE 2 #2'S AND 1 #6 THW.) | 1 EA.    |

WATER QUANTITIES (ESTIMATE FOR BONDING ONLY)

|                        |       |
|------------------------|-------|
| TAPPING EX. WATER MAIN | 1 EA. |
| FIRE HYD. W/APPLURT.   | 1 EA. |
| WATER SERVICES         | 1 EA. |

APPROVALS

|   |         |      |
|---|---------|------|
| <i>M. Bjorn</i><br>C.I.V. FIRE MARSHALL         | 1/23/80 | DATE |
| <i>[Signature]</i><br>C.I.V. TRAFFIC ENG.       | 2-5-80  | DATE |
| <i>[Signature]</i><br>C.I.V. SANITATION ENG.    | 1-28-80 | DATE |
| <i>[Signature]</i><br>C.I.V. QUALITY CONT. ENG. | 1/24/80 | DATE |
| <i>[Signature]</i><br>C.I.V. ENGINEER           | 1/26/80 | DATE |
| <i>[Signature]</i><br>C.I.V. ELEC. 60-ORD.      | 1/25/80 | DATE |
| <i>[Signature]</i><br>C.I.V. ELEC. SUPERVISOR   | 1-28-80 | DATE |

Nevada Power Company approved the point of service to this street light system. This shall not be deemed to consent to the placement of one light pole which may be in violation of Nevada Power Company's power rights and/or facilities.  
 11-9-79  
 (Date) *Melan B. Blum*  
 NEVADA POWER COMPANY

NOTE:  
 FIRE HYDRANT TO BE LOCATED 15' BEHIND BACK OF CURB.

| REVISION NO. | DESCRIPTION | BY | DATE | APPROVAL |
|--------------|-------------|----|------|----------|
|--------------|-------------|----|------|----------|

SMALL WORLD INC.  
 LAS VEGAS, NEVADA  
 LAMB BLVD.  
 STREET IMPROVEMENT,  
 OFFSITE SEWER & ST. LIGHTING

ALCA ENGINEERING & SURVEYING INC.  
 CIVIL ENGINEERING - SURVEYING  
 2765 SOUTH HIGHLAND DRIVE - SUITE NO. 103  
 LAS VEGAS, NEVADA 89106 - 702-732-2105

|                  |                        |         |              |
|------------------|------------------------|---------|--------------|
| SCALE (H) 1"=30' | SCALE (V) 1"=1'        | DATE    | JOB NO.      |
| DES. J.P. Holt   | DES. 10/1/79           | 1/22/80 | 1702-4-B     |
| DR.              | CHK. BY: SEC. 29-20-82 | T-2     | SHEET 2 OF 2 |

