

**LEGEND**

- T.C. TOP OF CURB
- F.G. FINISH GRADE
- F.L. FLOW LINE
- F.H. FIRE HYDRANT
- G.B. GRADE BREAK
- F.F. FINISH FLOOR
- M.O. MID-ORDINATE
- M.H. MANHOLE (SEWER)
- T.M.H. TOP OF MANHOLE
- S.W. SIDEWALK
- P.I. POINT OF INTERSECTION
- V.C. VERTICAL CURVE
- B.V.C. BEGIN VERTICAL CURVE
- E.V.C. END VERTICAL CURVE
- P.G. PAD GRADE
- A.C. ASPHALT CONCRETE
- B.C. BACK OF CURB
- B.C.R. BEGIN & END OF CURB RADIUS
- C & G. CURB & GUTTER
- C.M.P. CORRUGATED METAL PIPE
- R/W. RIGHT OF WAY
- P.L. PROPERTY LINE
- ST. LT. STREET LIGHT
- A.C.P. ASBESTOS CEMENT PIPE
- V.C.P. VITRIFIED CLAY PIPE
- R.C.P. REINFORCED CONCRETE PIPE
- P.V.C. POLY VINYL CHLORIDE ( PLASTIC )
- INV. INVERT

- 19 LOT NUMBER
- 20 CURVE NUMBER
- 3 BLOCK NUMBER

- CENTERLINE
- BOUNDARY LINE
- PVC - PVC CONDUIT (ST LT.)
- W - W - SEWER LINE (VCP)
- W - W - WATER LINE (ACP)
- M.H. MANHOLE (SEWER)
- CURB & GUTTER

- 2050 CONTOUR
- POLE (T- TELEPHONE; P- POWER)
- SCARP

- SWALE
- BLOCK WALL
- SERVICE POINT
- 400 W. LUMINAIRE W/11 GA POLE
- 175 W. " " " "
- DRIVEWAY

- FIRE HYDRANT W/6" GATE VALVE

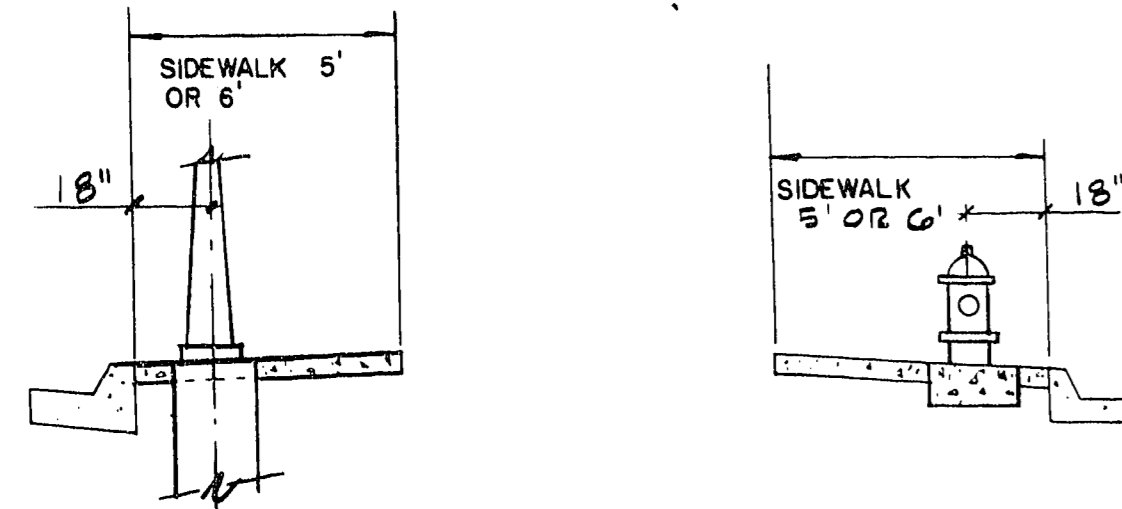

**STREET LIGHT & FIRE HYDRANT**

**LOCATION DETAIL**

**GENERAL NOTES**

1. Contractor shall provide all necessary horizontal and vertical transition between new construction and existing surfaces to provide for proper drainage and ingress and egress to said construction, extent of transitions to be determined by City Engineer.
2. Existing utilities are located on plans for the convenience of the Contractor only, the Contractor shall bear full responsibility for the protection of utilities and the Engineer bears no responsibility for utilities not shown on plans or not in the location shown on the plans.
3. Construction to be per Uniform Standard Specifications and Drawings; City of Las Vegas, Nevada.
4. Construction Survey: Grades are given from top of stakes or nails. The Contractors are cautioned to observe the following rule in using the grade stakes given by this office for putting in curbs or sewers: Three consecutive points that are shown to be on the same rate of slope must be used in common in order that any variation out of a perfect straight grade may be detected, and in case any such discrepancy is found, the same must be reported, otherwise this office will not be responsible for any error in the grade of the finish work.

**SEWER NOTES**

1. Housing services shall comply with the western plumbing code as to separation distance.
2. All houses to be served individually as per Section 313 of the Uniform Plumbing Code.

**STREET LIGHTING NOTES**

1. Street lighting standards shall be as shown by Drawing No. 4001, Page 40 of Uniform Standard Drawings and must conform to Sections 400 and 405 and any other applicable Sections of the Uniform Standard Specifications.
2. On 80' R/W streets, there shall be 2 poles on diagonal corners.
3. On 100' R/W streets, there shall be one (1) pole on each corner.
4. Mercury vapor luminaires to be used on 51' R/W and 60' R/W streets, except at inter-sections, shall be 175 watt, 120/240 volt I.E.S. distribution type 3, with integral constant wattage ballast, similar to line material catalog #LM44A2 or approved equal.
5. Mercury vapor luminaires to be used on 80' R/W streets and over, shall be 400 watt 240 volt, I.E.S. distribution type 3 with integral constant wattage ballast similar to General Electric type M-400 Catalog #C798G034 or approved equal.
6. Mercury vapor luminaires to be used on 51' R/W and 60' R/W streets, except at inter-sections, shall be 175 watt, 120/240 volt I.E.S. distribution type 3 with integral constant wattage ballast, similar to line material catalog #LM44A2 or approved equal.
7. 175 watt mercury vapor lamps shall be ASA Code #H39-22KC/W.
8. 400 watt mercury vapor lamps shall be ASA Code #H33-IG. /W.
9. Photo cell and control to be 120/240 volts.
10. Spacing of standards shall be 180' maximum on 51' R/W and 60' R/W streets on one side to provide 0.43 F.C.
11. Spacing of standards shall be 180' maximum on 80' R/W streets on both sides staggered to provide 0.9 F.C.
12. All standards to be set 18" back of curb.
13. Schedule 40 rigid non-metallic conduit (PVC) or approved equal complying with Article 347 of the National Electrical Code may be used for underground applications and to be within 12" back of curb and 24" cover.
14. Fuse holders and connectors shall be installed in the bases of all lighting standards, the fuse holders shall be Buss-Tron-Hex-AA.
15. Base covers for lighting standards are not to be installed before breakout caps are placed and inspected. All material used in underground wiring, in breakout caps and under base covers to be inspected before installation.
16. Foundations shall be constructed and located to line and grade as directed by the Field Engineer.
17. Lighting standard and mast arm cable to luminaire shall be 10/2 U.F. type 600 volt copper cable.
18. The Contractor shall be responsible for avoiding damage to property, either public or private and in the event of such damage, shall make satisfactory repairs at his own expense.
19. The Contractor shall furnish complete service to transformers and control systems, if required.
20. The service point standard is to be installed at the approved location shown on plans and to conform to Drawing #401.1, Page 44 of the Uniform Standard Drawings.
21. In the selection of 175 and 400 watt mercury vapor luminaires to be used in a particular development, one approved manufacturer shall be specified.
22. These specifications to become effective on all City of Las Vegas multiple street lighting designs approved on or after September 1, 1971.
23. These specifications shall be superseded by any revised specifications in existence at the time of installation.

**BENCH MARK**

C. L. V. B. M. #06035C4  
4" x 4" PLATE WITH BOLT IN T. C.  
SE CORNER ALTA & TORREY PINES  
ELEV. 2337.14

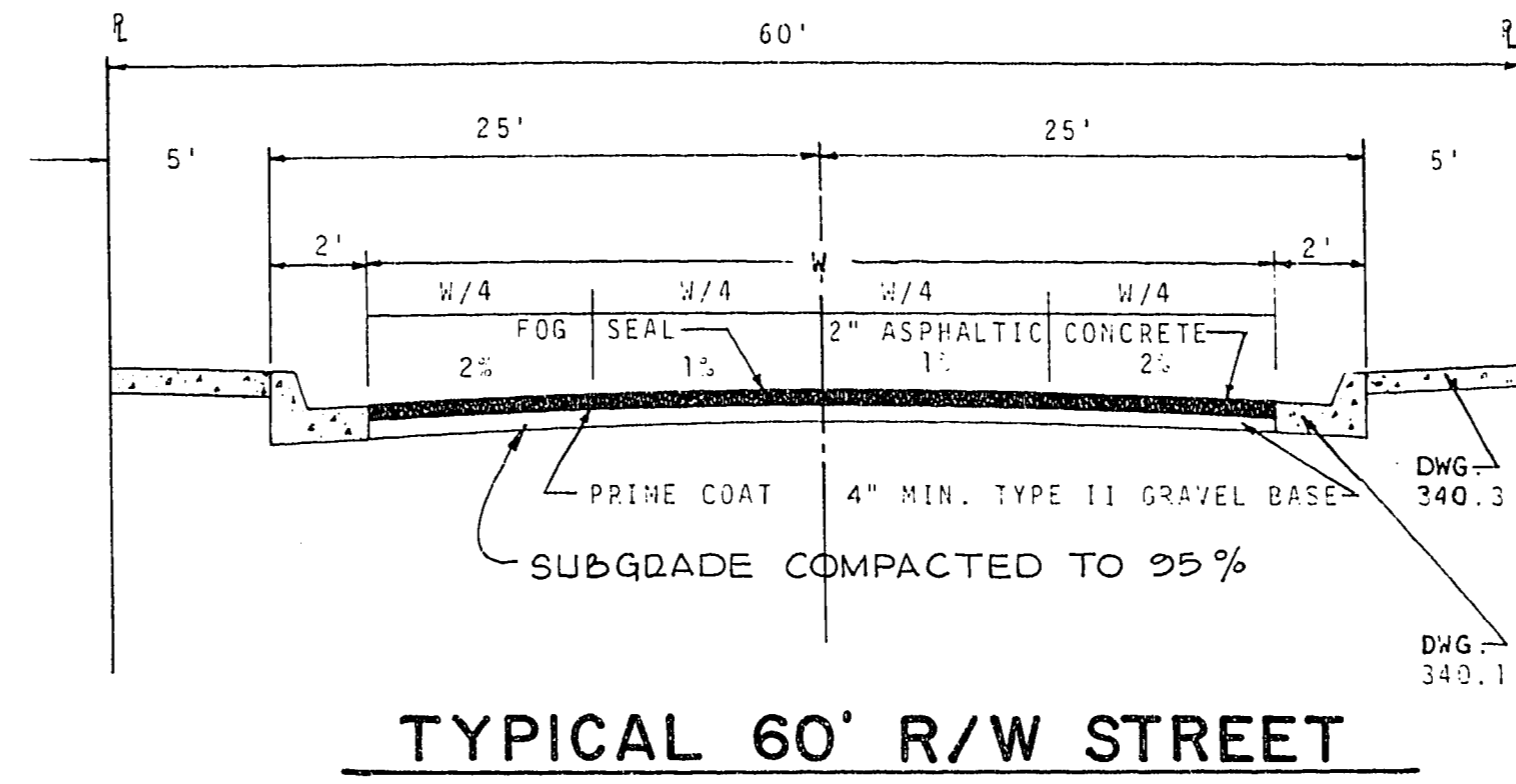

**TYPICAL 60' R/W STREET**

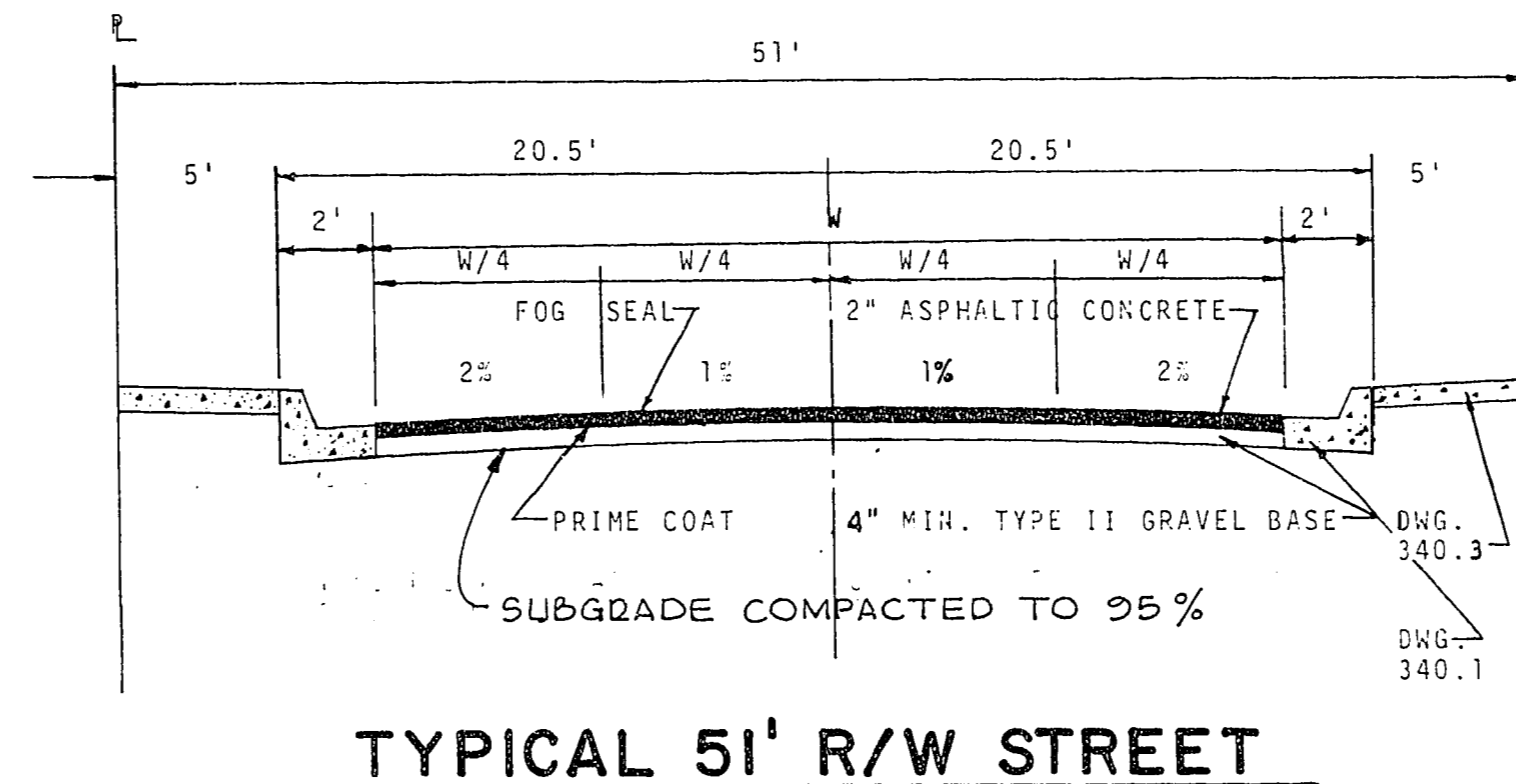

**TYPICAL 51' R/W STREET**

**ESTIMATE OF QUANTITIES**

**STREET IMPROVEMENTS**

2" AC Pavement with 4" Type II	6,424 SY
"L" Type Curb and Gutter	2,882 LF
Concrete Sidewalk	11,220 SF
16' Concrete Driveway (18' x 5') = 90 SF/DW	3,150 SF
* Approx. Driveway Quan.; Final quan. to be determined from model schedule shown on plot plan	

**WATER**

6" ACP	1,437 LF
Std. F.H. w/6" G.V. & 6" ACP Lateral	2 EA
Meter Box	35 EA
3/4" Service	35 EA

**SEWER**

Std. M.H.	4 EA
8" VCP	1,239 LF
4" VCP Lateral	955 LF

**STREET LIGHT**

175 W. Luminair w/Std.	10 EA
1-1/4" PVC Conduit	1,575 LF
#3-1/2 Conc. Pull Box w/Metal Cover	1 EA

**MISCELLANEOUS**

Excavation	7,950 CY
Street Sign	1 EA
Street & Stop Sign	1 EA
Lower Exist. M.H.	2 EA
Remove Exist. Pavement	1,010 SY
Temporary Pavement	180 SY

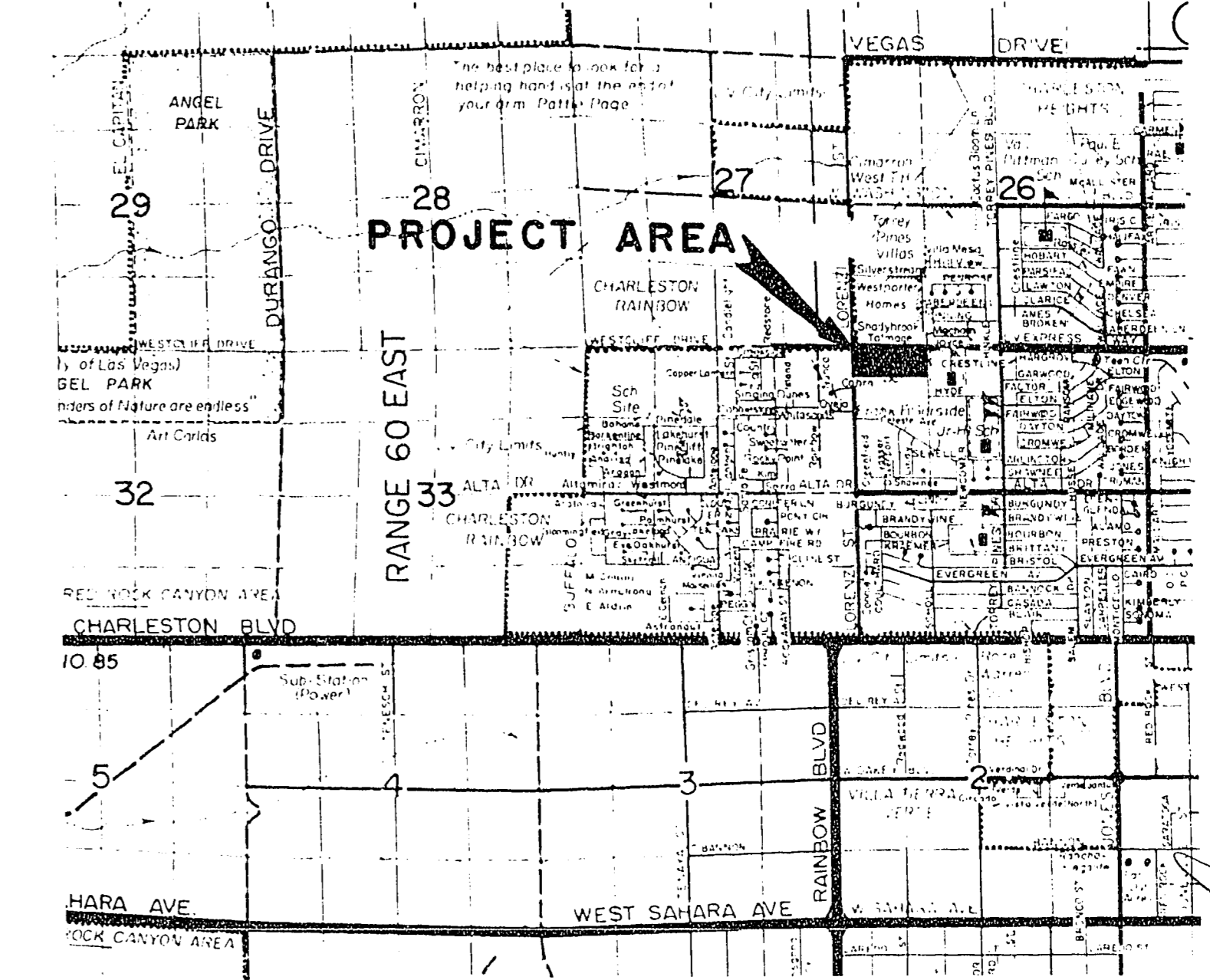

**VICINITY MAP**

**INDEX OF DRAWINGS**

NO.	TITLE
1.	COVER SHEET
2.	PLAT MAP
3.	PLAT MAP
4.	QUANTITIES, GENERAL NOTES & MISC.
5.	UTILITY PLAN
6.	LOWDEN LANE
7.	LOWDEN LANE & DEERBROOK LN.
8.	LORENZI ST.
9.	GRADING PLAN
10.	GRADING PLAN

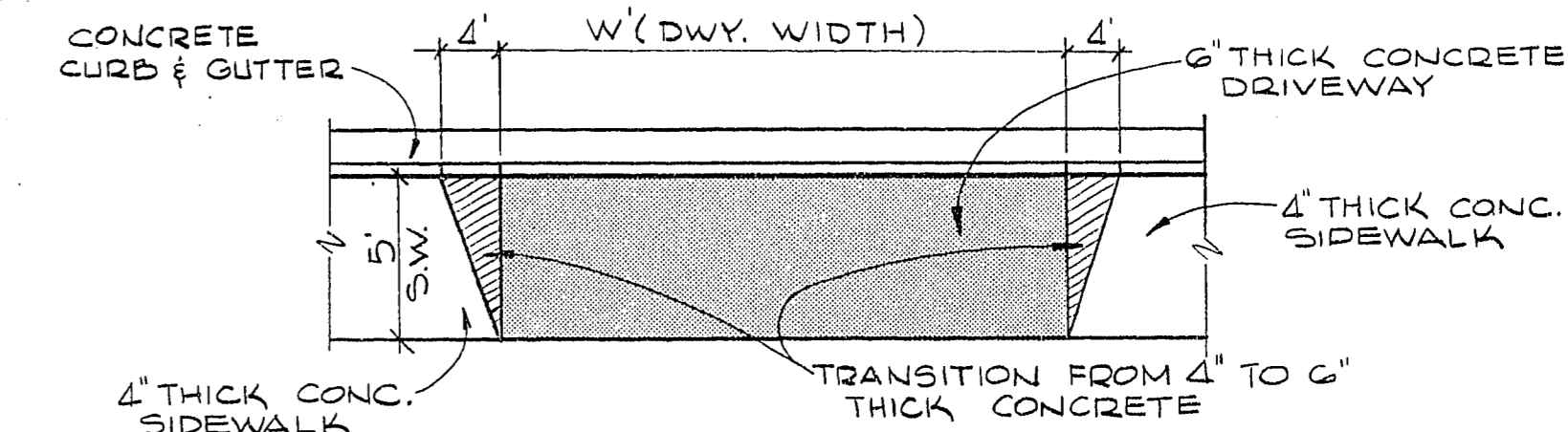

**DRIVEWAY DETAIL**

NO SCALE  
AREA FOR 6" THICK CONCRETE DRIVEWAY  
(W+2') x 5' = AREA/S.F.

**APPROVALS:**

*William Morris* 8/31/76  
CITY ENGINEER DATE

*R. J. A. Decker* 8-31-76  
FIELD/ENGINEER DATE

**ENGINEER'S CERTIFICATE**

I hereby certify that these plans and/or specifications comply with F.H.A. objectives, minimum property standards and neighborhood requirements and represents the best of my judgment.

*G. C. Wallace* 9/8/76  
G. C. Wallace RPE, RLS #1815 Date

REV	DATE	DESCRIPTION

RECOMMENDED BY: *G. C. Wallace*  
DATE: 8/31/76  
R.E. NO. 1815  
MONTGOMERY ENGINEERS OF NEVADA  
735-7198  
LAS VEGAS, NEVADA

LEWIS HOMES OF NEVADA  
LEWIS HOMES - CHARLESTON UNIT NO.11  
QUANTITIES, GENERAL NOTES & MISC.

SHEET  
**4**  
OF 10 SHEETS

5543.0030

107-2026-11