

1770
1770
1770

APPROVED BY

William Davis 10/28/76
Las Vegas City Engineer date

C.D. Peterson 10-27-76
Las Vegas Field Engineer date

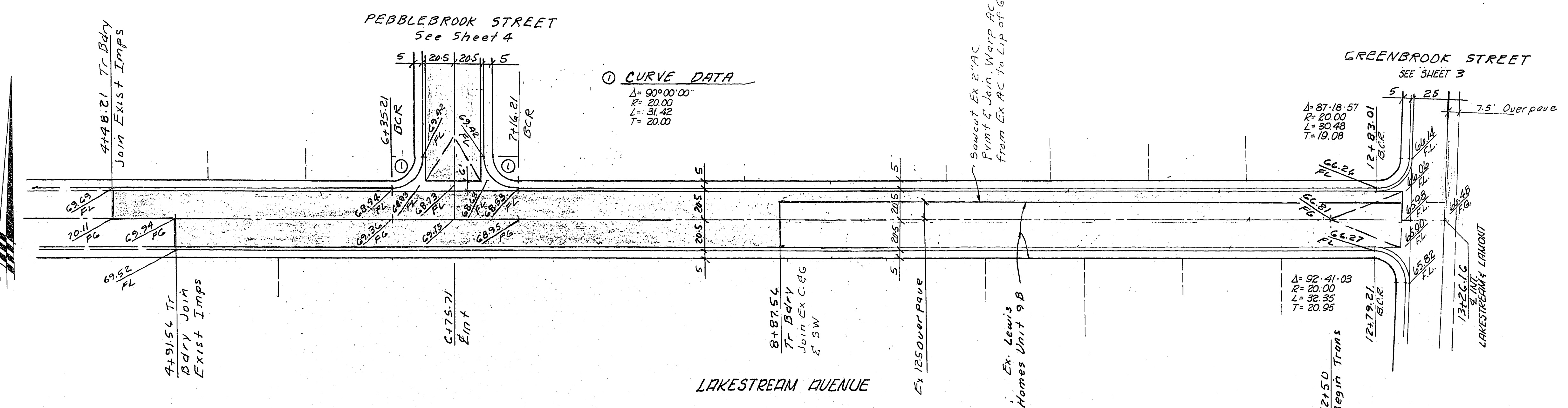

SUBMITTED BY

Charley R Johnson 8/23/76
Charley R Johnson date
Nev Cert 3005

CONSULTING ENGINEERS • PLANNERS 2000 FRENCH ROAD LAS VEGAS, NEVADA 89169 TEL: 752-2000				
LEWIS HOMES LAS VEGAS UNIT M-9A LAKESTREAM AVE. STREET PLAN & PROFILE				
SCALE:	WO. NO. 2019-9A	DATE 8/23/76	SHEET	OF
HORIZ: 1"=40'	DES.	REV.	5	11
VERT: 1"=4'	CHK.	REV.		