

CURVE DATA

NO.	LOC.	DELTA	RADIUS	TANGENT	LENGTH
33	B/C	86° 01' 31"	60.00'	55.98'	90.09'
34	B/C	88° 36' 06"	60.00'	58.55'	92.78'
A	ISL	180° 00' 00"	1.00'		3.14'
B	ISL	10° 53' 15"	250.00'	23.87'	47.51'
B ₁	ISL	6° 32' 46"	250.00'	14.30'	28.56'

JONES BLVD.

SMOKE RANCH RD.

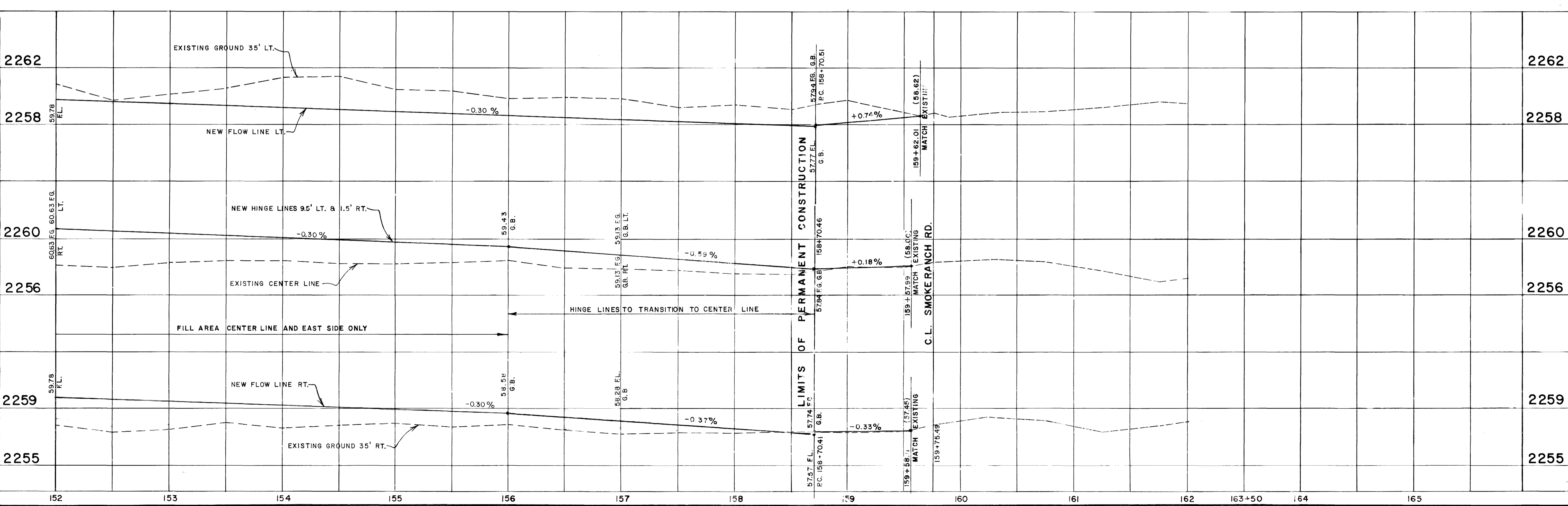
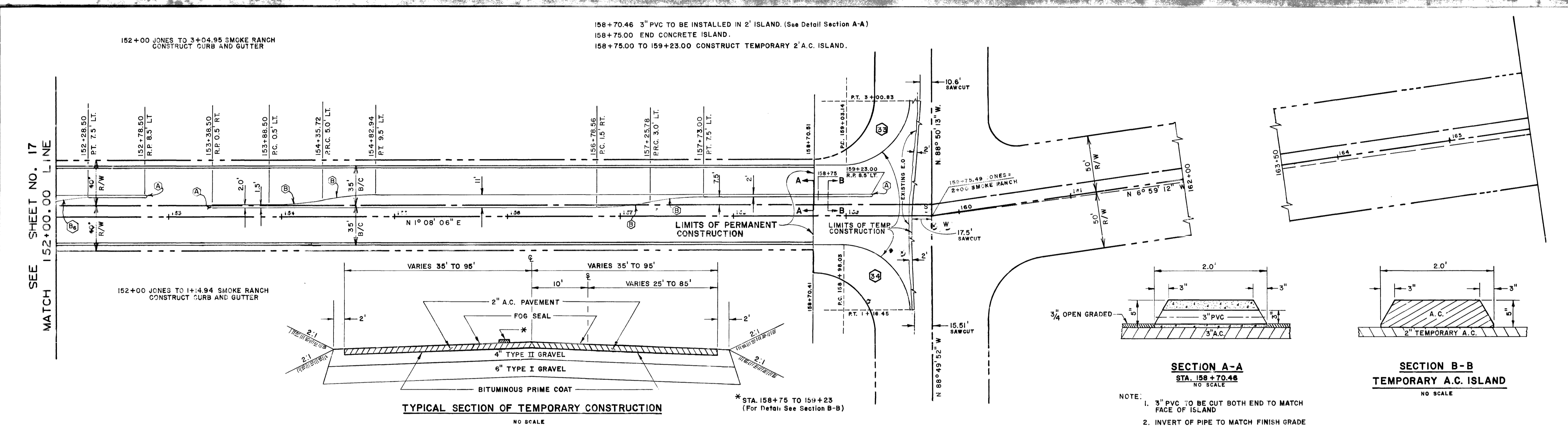

NO.	DESCRIPTION	BY	DATE	APPROVAL
REVISIONS				

FEB 2, 1979

E.E. HUNT
 2/14/79

Department of Public Services
Engineering Design Division
JONES BOULEVARD
 CHARLESTON BLVD. TO
 SMOKE RANCH ROAD

scale (h) 1" = 50'	scale (v) 1" = 4'	drawing no. 107-V948A
w.o.no. 7694	f.bk.no. 74-9XA	date
design by C. KREHNGVI	drawn by E. E. HUNT	date 12/7/78
approved by Director of Public Services		sht. 16 of 68