

JEFFERSON AVENUE

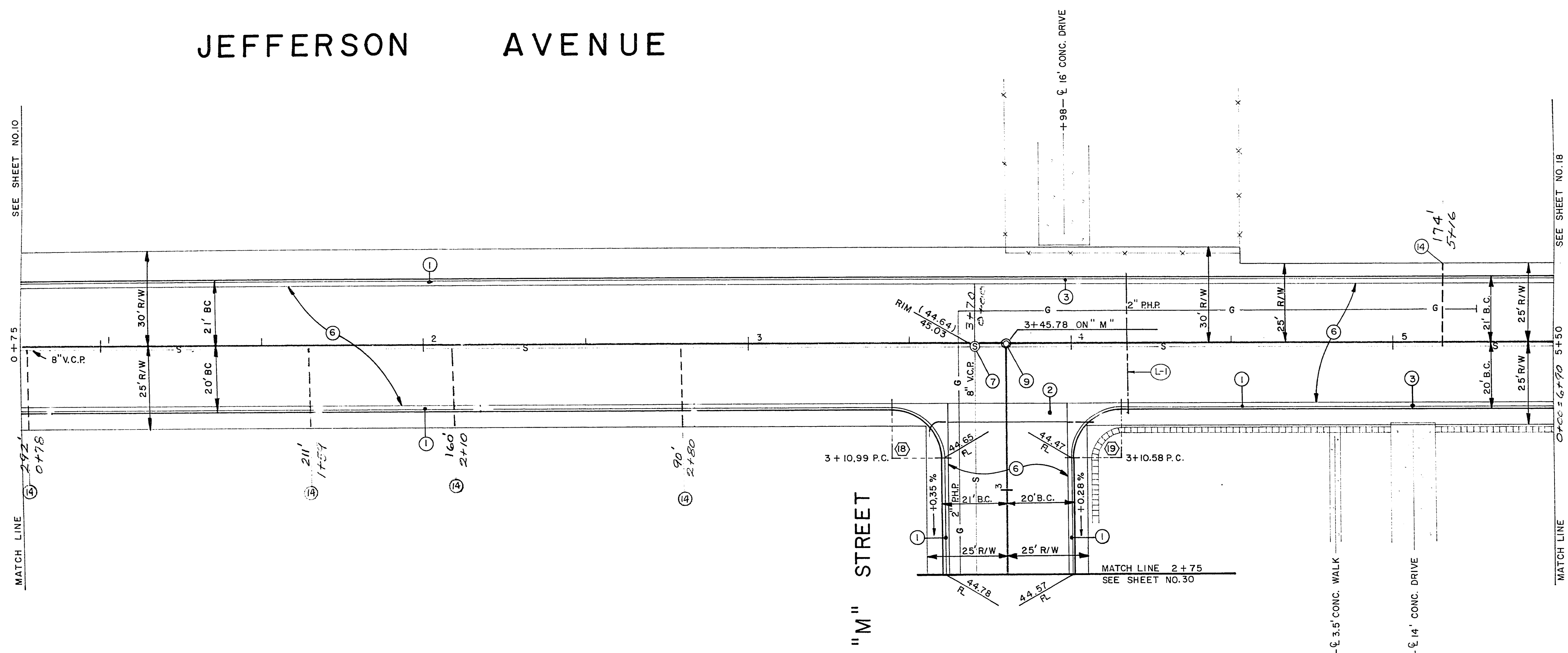

APPROXIMATE QUANTITIES - THIS SHEET

ITEM	DESCRIPTION	QUANTITY	UNIT
201.1	ROADWAY EXCAVATION	812	CU. YD.
340.1	CONSTRUCT CONCRETE CURB & GUTTER	1	998 LN. FT.
340.5	CONSTRUCT CONCRETE VALLEY GUTTER	2	346 SQ. FT.
302.1	TYPE I GRAVEL BASE	564	CU. YD.
302.2	TYPE II GRAVEL BASE	238	CU. YD.
334.4	2 INCH ASPHALTIC CONCRETE PAVEMENT	6	2145 SQ. YD.
333.1	BITUMINOUS FOG SEAL	6	2145 SQ. YD.
420.0	CONSTRUCT SURVEY MONUMENT	9	EACH
512.51	ADJUST MANHOLE TO GRADE	7	EACH
L-1	1/4\" CONDUIT IN PLACE	97	LN. FT.
L23.204	INSTALL 4\" V.C.P. (EXIST.)	14	LN. FT.

SCALE 1" = 20'

CURVE NO.	Δ	R	T	L
18	89°39'59"	15.00	14.91	23.47
19	90°20'01"	15.00	15.09	23.65

BENCH MARK: GUARD STAKE ON POWER POLE AT NORTH EAST CORNER OF IVY STREET AND MADISON AVENUE. ELEVATION 2042.48

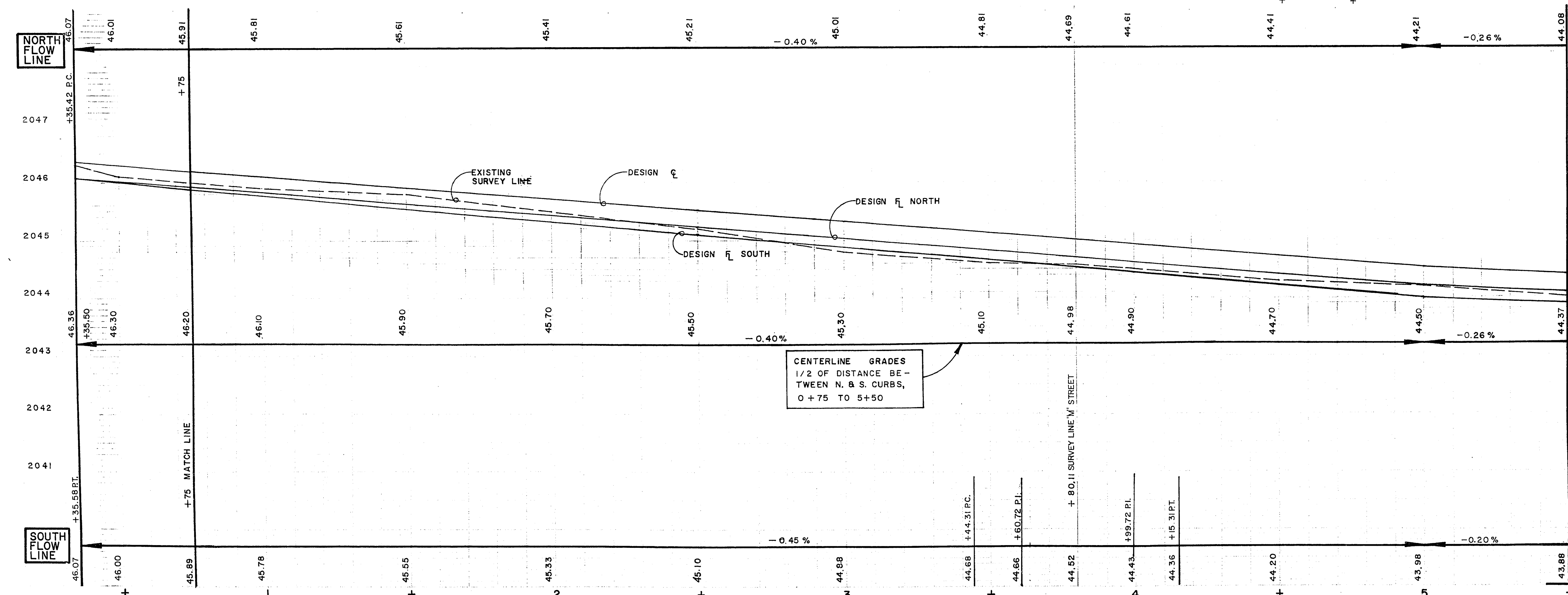

APPROVED

DATE: 1/18/68

DR. AL ARMSTRONG

1/18/68

CONTRACT DRAWING
FEB 3 1968

AS BUILT SEWER

CITY OF LAS VEGAS NEVADA
ENGINEERING DEPT.

JEFFERSON AVENUE
"N" STREET TO "J" STREET
STATION 0+75 TO STATION 5+30

S.A.D. 486 UNIT I & II	DATE: 4-25-68	SC. III	1" = 1"
DES. K. ANDERSON	6-26-67	SC. IV	1" = 1"
DR. AL ARMSTRONG		P.I. G. NO.	66-6X
CKD.		DRAWING NO.	486

APPROVED BY CITY ENGR. *[Signature]*