

No.	BEARING	DISTANCE
L1	N00°31'01"E	4.02
L2	S06°13'50"W	26.50
L3	N36°26'38"W	22.00
L4	S53°33'16"W	15.78
L5	N36°26'38"W	16.00
L6	N44°41'02"W	16.16
L7	N47°39'43"W	16.16
L8	N83°45'52"W	16.00
L9	N06°13'50"E	10.40
L10	N83°45'52"W	4.91
L11	N78°22'10"W	15.95
L12	N06°13'50"E	4.95
L13	S36°26'38"E	15.82
L14	N53°33'16"E	15.88
L15	S53°33'16"W	16.00
L16	S36°26'38"E	18.16
L17	N36°26'38"W	5.77
L18	N53°33'22"E	16.00
L19	N53°33'22"E	14.00
L20	N36°26'38"W	6.00
L21	N23°48'27"E	13.88
L22	N23°48'27"E	14.00
L23	N53°33'22"E	4.48
L24	S36°26'38"E	20.41
L25	N36°26'38"W	4.00
L26	N53°33'22"E	5.00
L27	N53°33'27"E	5.00
L28	N36°26'38"W	20.69
L29	S36°26'38"E	7.00
L30	N36°26'38"W	2.58
L31	S36°26'41"E	7.02
L32	N36°26'50"W	4.00
L33	S53°33'10"W	5.00
L34	N53°33'22"E	4.98
L35	N36°26'38"W	7.08
L36	S00°31'01"W	19.76
L37	N89°28'59"W	16.00
L38	N00°31'01"E	16.78
L39	N89°28'59"W	4.38
L40	N00°31'01"E	16.00
L41	N36°26'44"W	16.00
L42	S36°26'44"E	15.96
L43	S36°26'44"E	15.82
L44	N00°31'01"E	7.76
L45	N00°31'01"E	4.00
L46	N89°28'59"W	15.74
L47	N55°49'30"W	7.00
L48	S34°10'30"W	16.00
L49	S33°50'31"W	3.08
L50	N83°46'10"W	15.83
L51	N83°46'10"W	15.95
L52	N83°46'10"W	15.82
L53	N55°49'30"W	8.51
L54	N55°49'30"W	9.51
L55	N06°13'50"E	29.34
L56	S89°28'59"E	15.34
L57	N00°31'01"E	3.42
L58	S89°28'59"E	1.75
L59	S89°28'59"E	6.17
L60	N00°31'01"E	20.62
L61	N89°28'59"W	6.15
L62	S00°31'01"W	15.72
L63	N89°28'59"W	1.50
L64	N89°28'59"W	5.92
L65	N00°31'01"E	12.21
L66	N00°31'01"E	3.00
L67	S89°28'59"E	15.97
L68	S83°45'52"E	4.02
L69	N00°31'01"E	10.64
L70	S83°45'52"E	19.16
L71	S83°48'10"E	19.27
L72	S03°17'31"E	3.00
L73	S06°14'08"W	5.00
L74	S83°45'52"E	21.54
L75	S83°45'52"E	2.33
L76	S83°45'52"E	1.74
L77	S83°45'52"E	28.84
L78	S06°14'08"W	5.00
L79	N83°45'52"W	3.00
L80	S06°14'08"W	16.01
L81	S06°13'50"W	4.00
L82	S83°45'52"E	9.32
L83	N06°13'50"E	15.96
L84	N06°14'08"E	28.08
L85	N00°31'01"E	7.77
L86	N00°31'01"E	8.29
L87	N83°45'52"W	14.18
L88	N89°19'04"W	15.75
L89	N89°28'59"W	6.00
L90	S89°28'59"E	11.00
L91	N00°31'01"E	25.00
L92	N89°28'59"W	4.38
L93	S89°28'59"E	4.61
L94	S89°28'59"W	28.76
L95	S00°31'01"W	15.60
L96	S89°28'59"E	5.00
L97	N00°31'01"E	8.65
L98	N89°28'59"W	15.82
L99	S00°31'01"W	15.82
L100	S00°31'01"W	15.93
L101	N89°28'59"W	6.19
L102	N00°31'01"E	15.88
L103	N00°31'01"E	14.00
L104	S83°45'52"E	9.32
L105	N06°13'50"E	13.87
L106	S06°13'50"W	29.18
L107	S89°28'59"E	16.93
L108	N83°45'52"W	14.18
L109	S00°31'01"W	8.29
L110	N89°28'59"W	43.21
L111	S00°31'01"E	14.00
L112	N89°28'59"W	4.99
L113	S89°28'59"E	76.92
L114	S89°28'59"E	76.92
L115	N00°31'01"E	608.16
L116	S00°31'01"W	595.21
L117	N83°41'06"W	48.06
L118	N73°28'38"W	45.82
L119	S81°55'22"E	115.10
L120	N30°01'10"E	121.57
L121	S83°41'06"E	156.36
L122	S83°41'06"E	156.36

No.	RADIUS	DELTA	LENGTH	TANGENT
C1	40.50	62°03'20"	43.86	24.36
C2	40.50	56°20'31"	39.83	21.69
C3	40.50	53°02'15"	37.49	20.21
C4	22.50	84°16'53"	33.10	20.36
C5	22.50	95°43'07"	37.59	24.87
C6	22.50	90°00'18"	35.34	22.50
C7	100.00	47°19'32"	82.60	43.82
C8	1800000.00	101°14'49"	115.77	---
C9	125.00	29°55'37"	65.29	33.41
C10	100.00	29°55'37"	52.23	26.73
C11	40.50	53°02'21"	37.49	20.21
C12	40.50	181°01'29"	127.96	---
C13	3.00	90°00'00"	4.71	3.00
C14	3.00	95°46'33"	5.01	3.32
C15	112.50	26°27'37"	51.95	26.45
C16	112.50	13°55'48"	27.35	13.74
C17	93.50	101°23'54"	116.67	8.36
C18	3.00	97°40'06"	5.11	3.43
C19	28.00	82°20'00"	40.24	24.48
C20	131.50	08°14'24"	18.91	9.47
C21	3.00	177°01'13"	9.27	115.34
C22	131.50	26°05'21"	82.67	42.86
C23	3.00	89°59'42"	4.71	3.00
C24	87.50	03°21'56"	5.14	2.57
C25	3.00	92°02'05"	4.82	3.11
C26	66.50	39°57'42"	47.88	24.91
C27	3.00	98°33'32"	5.07	3.38
C28	28.00	77°35'12"	37.92	22.51
C29	3.00	95°31'11"	5.00	3.30
C30	3.00	90°00'06"	4.71	3.00
C31	50.00	32°14'19"	28.13	14.45
C32	40.50	108°25'02"	76.64	56.17
C33	19.50	61°05'48"	20.79	11.51
C34	25.00	47°19'14"	20.65	10.95
C35	50.00	25°17'19"	22.07	11.22
C36	3.00	180°00'00"	3.42	---
C37	156.50	15°36'26"	42.63	21.45
C38	156.50	13°35'15"	37.11	18.64
C39	154.50	02°13'32"	6.00	3.00
C40	66.50	29°55'37"	35.78	18.31
C41	3.00	97°14'49"	5.09	3.41
C42	3.00	101°12'44"	5.30	3.65
C43	3.00	100°48'20"	5.28	3.63
C44	3.00	100°48'25"	5.28	3.63
C45	3.00	87°57'04"	4.61	2.89
C46	28.00	85°02'56"	44.98	29.02
C47	28.00	36°57'45"	18.06	9.36
C48	28.00	83°06'34"	40.61	24.82
C49	28.00	86°43'56"	42.39	26.45
C50	3.00	93°15'59"	4.88	3.18
C51	28.00	53°02'15"	25.92	13.97
C52	3.00	98°13'23"	5.14	3.46
C53	28.00	48°07'07"	23.52	12.50
C54	3.00	86°19'59"	4.52	2.81
C55	72.00	50°23'19"	73.37	40.83
C56	28.00	55°09'48"	26.98	14.63
C57	10.00	101°33'37"	17.73	12.25
C58	10.00	62°03'20"	10.83	6.02
C59	10.00	103°27'53"	17.71	12.23
C60	3.00	87°59'39"	4.61	2.90
C61	28.00	83°23'09"	40.75	24.94
C62	3.00	98°37'12"	5.16	3.49
C63	28.00	90°00'00"	43.98	28.00
C64	3.00	94°35'27"	4.93	3.25
C65	28.00	79°41'26"	38.94	23.37
C66	3.00	100°31'50"	5.28	3.61
C67	3.00	84°16'53"	4.41	2.71
C68	3.00	100°46'21"	5.28	3.62
C69	3.00	97°00'00"	4.71	3.00
C70	3.00	100°39'52"	5.27	3.62
C71	3.00	101°07'35"	5.29	3.65
C72	3.00	93°43'12"	4.91	3.20
C73	28.00	86°17'06"	42.17	26.24
C74	28.00	83°12'47"	40.67	24.87
C75	10.00	95°43'07"	16.71	11.05
C76	10.00	84°16'53"	14.71	9.05
C77	10.00	90°00'18"	15.71	10.00
C78	10.00	89°59'42"	15.71	10.00
C79	3.00	90°00'18"	4.71	3.00
C80	35.00	21°44'07"	13.28	6.72
C81	35.00	21°43'49"	13.27	6.72
C82	35.00	34°20'05"	20.97	10.81
C83	20.00	34°20'05"	11.99	6.18
C84	15.00	95°43'07"	25.06	16.58
C85	15.00	95°00'00"	23.56	15.00
C86	3.00	101°35'27"	5.32	3.68
C87	15.00	76°34'28"	20.57	12.27
C88	3.00	94°35'27"	4.93	3.23
C89	28.00	85°47'08"	41.92	26.01
C90	25.00	90°00'00"	39.27	25.00
C91	5.00	180°00'00"	15.71	---
C92	28.00	76°12'57"	37.23	21.96
C93	3.00	94°08'59"	4.93	3.23
C94	28.00	48°53'21"	23.89	12.73
C95	72.00	53°02'21"	66.65	35.93
C96	3.00	97°57'52"	5.13	3.45
C97	15.00	82°02'08"	21.48	13.05
C98	28.00	83°06'28"	40.61	24.82
C99	30.00	95°47'53"	50.18	33.20
C100	3.00	90°00'18"	4.71	3.00
C101	3.00	84°16'53"	4.41	2.71
C102	28.00	86°25'10"	43.21	27.24
C103	3.00	91°58'00"	4.88	3.08
C104	3.00	90°00'00"	4.71	3.00
C105	200.67	1°45'02"	6.13	3.07
C106	256.67	14°05'09"	61.63	30.97
C107	189.33	18°34'57"	64.51	32.61
C108	249.33	14°02'08"	61.08	30.69
C109	200.67	16°49'13"	58.91	29.67
C110	1.33	180°23'38"	4.19	---
C111	25.00	101°23'54"	4.45	2.23
C112	30.00	95°47'53"	51.67	33.20
C113	25.00	90°00'00"	39.27	25.00
C114	25.00	90°00'00"	39.27	25.00

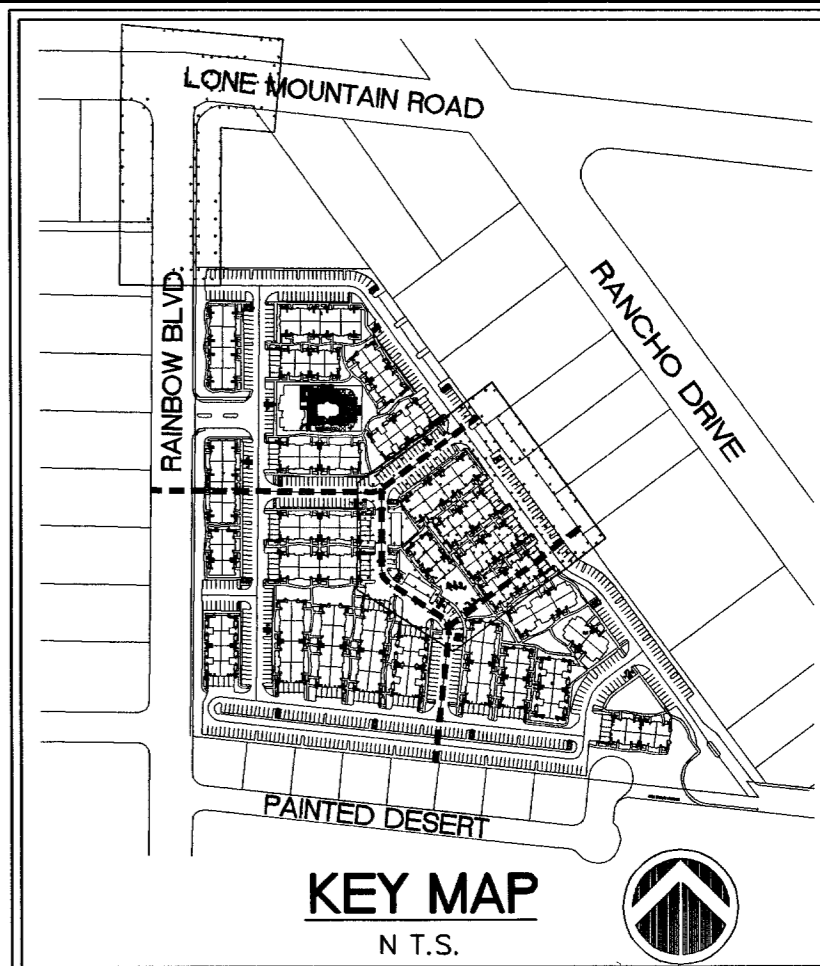

BASIS OF BEARINGS:
 THE BASIS OF BEARING FOR THIS SURVEY IS THE WESTERLY LINE OF THE NORTHWEST QUARTER (NW 1/4) OF SECTION 2, TOWNSHIP 20 SOUTH, RANGE 60 EAST, M.D.M., CITY OF LAS VEGAS, COUNTY OF CLARK, STATE OF NEVADA, WHICH BEARS NORTH 00°31'01" EAST, AS PER MAP RECORDED IN BOOK 105, PAGE 58 OF PLATS IN THE OFFICE OF THE COUNTY RECORDER OF SAID COUNTY.

CAUTION TO CONTRACTOR !
 EXISTING UTILITY LOCATIONS SHOWN HEREON ARE APPROXIMATE ONLY. IT SHALL BE THE CONTRACTOR'S RESPONSIBILITY TO DETERMINE THE EXACT VERTICAL AND HORIZONTAL LOCATION OF ALL EXISTING UNDERGROUND UTILITIES PRIOR TO COMMENCING CONSTRUCTION. NO REPRESENTATION IS MADE THAT ALL EXISTING UTILITIES ARE SHOWN HEREON. THE ENGINEER ASSUMES NO RESPONSIBILITY FOR UTILITIES NOT SHOWN OR UTILITIES NOT SHOWN IN THEIR PROPER LOCATION.

CALL BEFORE YOU DIG.
 1-800-227-2600
 UNDERGROUND SERVICE (USA)

BENCH MARK:
 CITY OF LAS VEGAS BENCH MARK 11V00 3NE6
 CITY OF LAS VEGAS PIN AND PLATE IN THE TOP OF CURB, SOUTHWEST CORNER OF RAINBOW BOULEVARD AND RED COACH AVENUE NEAR THE PT OF RED COACH AVENUE
 NAVD '88 DATUM
 ELEVATION = 2319.021 U.S. SURVEY FEET
 ELEVATION = 706.839 METERS

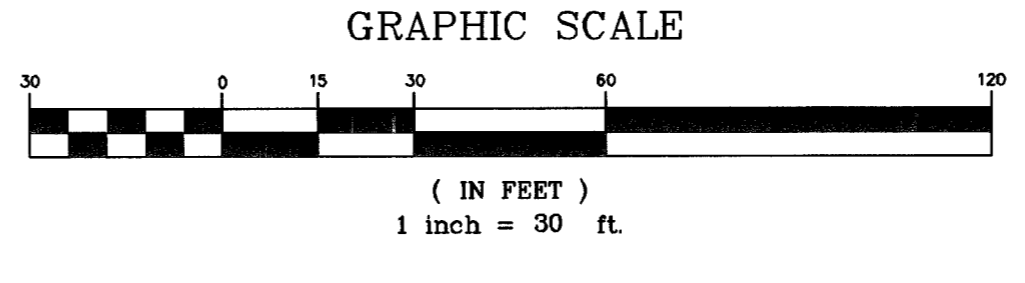

No.	BEARING	DISTANCE
L1	N00°31'01"E	4.02
L2	S06°13'50"W	26.50
L3	N36°26'38"W	22.00
L4	S53°33'16"W	15.78
L5	N36°26'38"W	16.00
L6	N44°41'02"W	16.16
L7	N47°39'43"W	16.16
L8	N83°45'52"W	16.00
L9	N06°13'50"E	10.40
L10	N83°45'52"W	4.91
L11	N78°22'10"W	15.95
L12	N06°13'50"E	4.95
L13	S36°26'38"E	15.82
L14	N53°33'16"E	15.88
L15	S53°33'16"W	16.00
L16	S36°26'38"E	18.16
L17	N36°26'38"W	5.77
L18	N53°33'22"E	16.00
L19	N53°33'22"E	14.00
L20	N36°26'38"W	6.00
L21	N23°48'27"E	13.88
L22	N	