

# IMPROVEMENT PLANS

FOR

## *Bullseye*

Commercial Real Estate

AT

# LAKE MEAD BLVD AND TORREY PINES DRIVE

CITY OF LAS VEGAS  
STATE OF NEVADA  
APN: 138-23-201-008

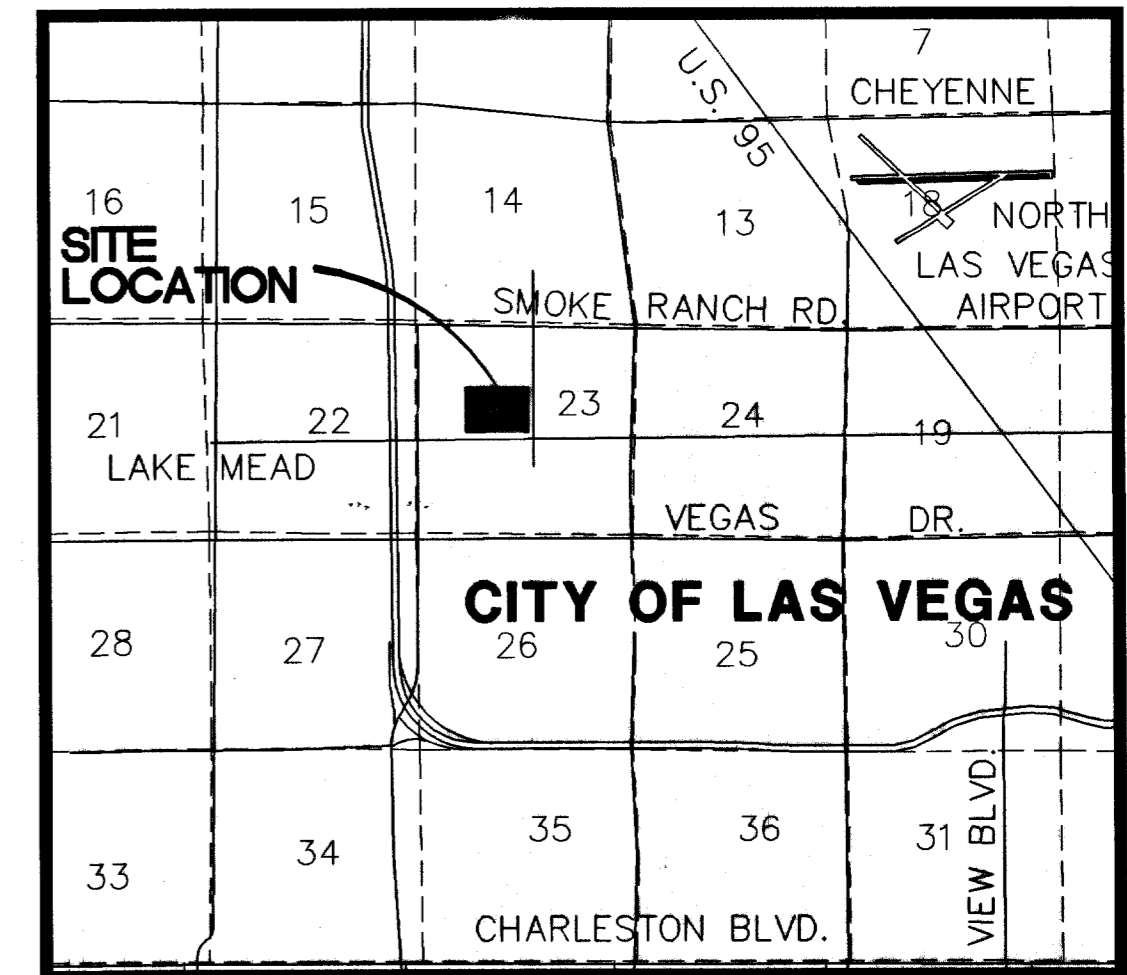

VICINITY MAP  
NOT TO SCALE

### SHEET INDEX

1. C1 COVER SHEET
2. C2 GENERAL NOTES & LEGEND
3. C3 HORIZONTAL CONTROL PLAN
4. C4 GRADING PLAN
5. C5 UTILITY PLAN & STREET LIGHTING
6. C6 DETAIL SHEET

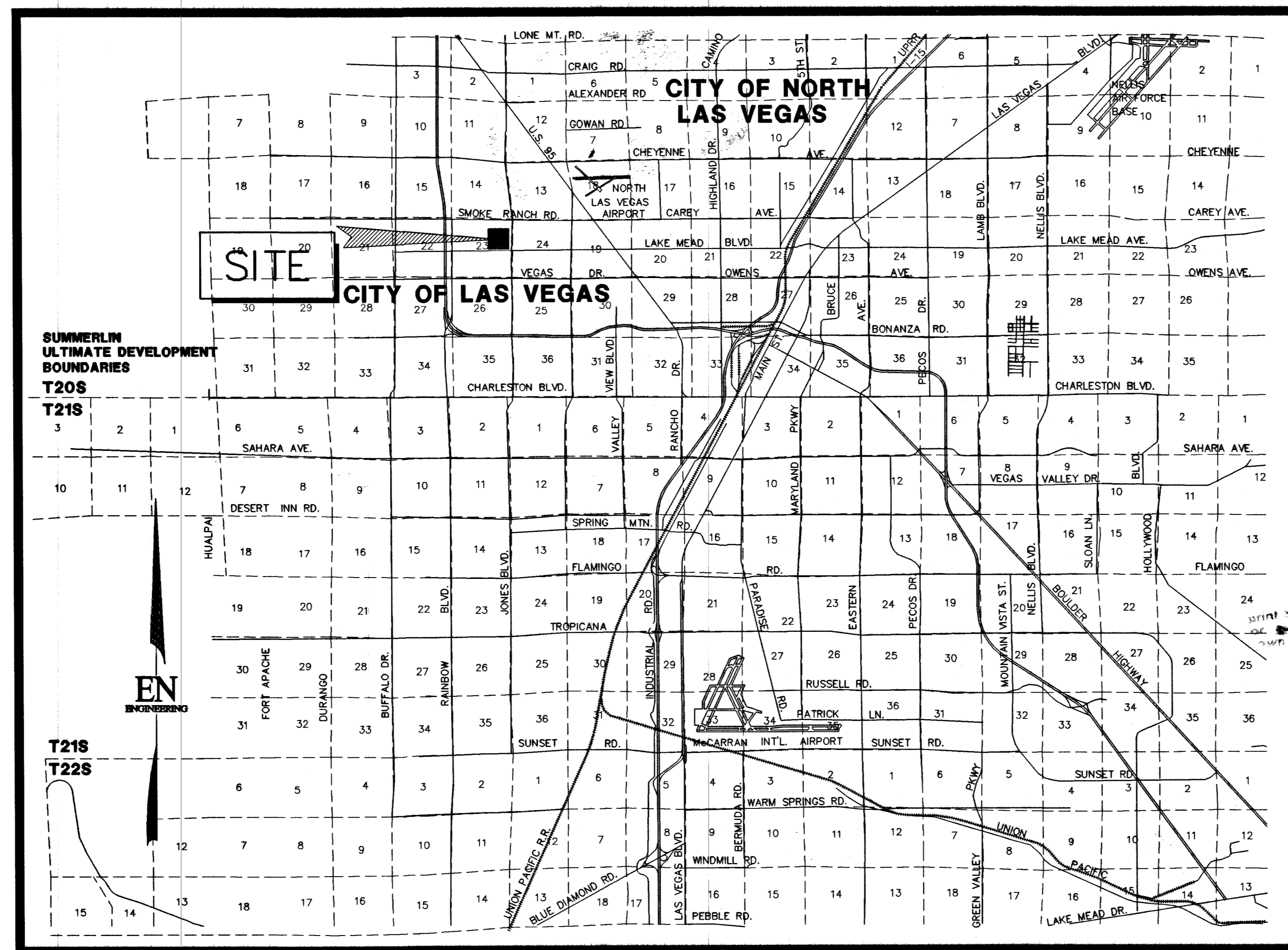

REGIONAL MAP  
NOT TO SCALE

### BENCHMARK-

CITY OF LAS VEGAS BENCHMARK ID #7C0023C4  
RIVET & PLATE IN TOP OF CURB AT THE SOUTHWEST  
QUADRANT OF LAKE MEAD AND TORREY PINES  
NAVD 88 ELEVATION = 2304.74 FEET  
702.4849 METERS

### BASIS OF BEARING-

SOUTH 89°13'45" EAST BEING THE SOUTH LINE OF THE SOUTHEAST QUARTER (SE ¼) OF  
THE NORTHEAST QUARTER (NW ¼) OF SECTION 23, TOWNSHIP 20 SOUTH, RANGE 60  
EAST, M.D.M., CITY OF LAS VEGAS, CLARK COUNTY, NEVADA, AS SHOWN ON THE PARCEL  
MAP ON FILE IN THE OFFICE OF THE COUNTY RECORDER, CLARK COUNTY, NEVADA, IN  
FILE 82 OF PARCEL MAPS, AT PAGE 79.

"The affixed Sprint Nevada approval does not assume or guarantee liability for known or unknown conflicts with existing or proposed improvements. Resolution of any conflict will be accomplished pursuant to Local Ordinances, Nevada Revised Statutes and/or Public Utility Commission Rules and Regulations."

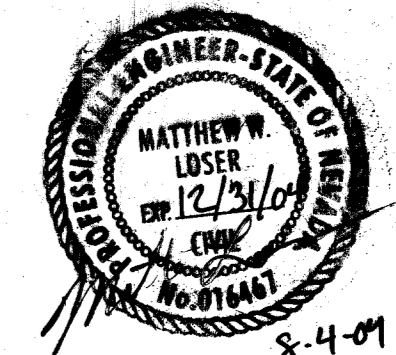

### APPROVALS

*Wagner B. Karkowski* 8-5-2004  
For CHARLES KARKOWSKI, JR., PE #4784  
CITY ENGINEER

*M. Margo Wheeler* 7/22/04  
M. MARGO WHEELER, AICP, CURRENT PLANNING MANAGER  
DATE  
THIS PLAN MEETS THE APPLICABLE STANDARDS OF THE PLANNING AND DEVELOPMENT DEPARTMENT

*John M. Marshall* 8/2/04  
CITY FIRE MARSHAL  
DATE

LAS VEGAS VALLEY WATER DISTRICT (SHEETS 1,2,5 ) PROJECT NO: 29562 DATE  
H-107024-008

*Ron Castle* 7-15-04  
SOUTHWEST GAS CORPORATION  
DATE

*Sandy Larsen* 7/7/04  
LAS VEGAS INC  
COX COMMUNICATIONS LAS VEGAS INC  
DATE

*Shel Gonzalez* 7/7/04  
NEVADA POWER COMPANY  
DATE

NEVADA POWER COMPANY ACKNOWLEDGES THAT WE HAVE RECEIVED YOUR PLANS AND WILL PROVIDE SERVICE TO ALL ELECTRICAL NEEDS ASSOCIATED WITH THIS PROJECT. NEVADA POWER COMPANY RESERVES THE RIGHT TO ADDRESS ANY EXISTING OR FUTURE CONFLICTS ONCE THE FINAL DESIGN IS COMPLETED. SERVICE AND THE RESOLUTION OF ANY CONFLICTS WILL BE ACCOMPLISHED PURSUANT TO THE NEVADA PUBLIC UTILITY COMMISSION'S RULES AND REGULATIONS.

<b>Bullseye</b> Commercial Real Estate 29100 Old Mill Creek Lane Agoura, CA 91301 (702) 380-4250		1920 Main Street, Suite 850 Irvine, CA 92614 (949) 486-0777 245 East Warm Springs Road, Suite 100 Las Vegas, NV 89119 (702) 886-8604	
<b>EN</b> ENGINEERING Planners Surveyors		TITLE: LAKE MEAD PROMENADE LAKE MEAD AND TORREY PINES LAS VEGAS, NEVADA	
DRAWN BY: BCK	DESIGNED BY: BCK	CHECKED BY: BCK	PROJECT NO: 03-538
DATE: 04/15/04	DATE: 04/15/04	DATE: 04/15/04	SCALE: NTS
SHEET COVER SHEET		SHEET C1	
1 of 6 SHEETS		CLV PROJECT NO. 1074080	

Call before you OVERHEAD 1-702-227-2929

Call before you Dig. 1-800-227-2600

