

CONSTRUCTION NOTES

- 4" CONCRETE SIDEWALK PER USD #234 (NOTE: REMOVE AND REPLACE EXISTING SIDEWALK TO PROVIDE ADEQUATE DRAINAGE)
- CONSTRUCT "L" TYPE CURB (USD #216)
- COMMERCIAL DRIVEWAY PER USD #222A
- CONSTRUCT 8'-WIDE CONCRETE VALLEY GUTTER
- INSTALL (2) 6" PVC CONDUITS WITH PULL LINE
- EXISTING POWER POLES TO BE REMOVED BY NEVADA POWER COMPANY NEVADA POWER COMPANY PROJECT NO: 172742

LEGEND

DESIGN ELEVATION	10.00
EXISTING ELEVATION	(10.00)
SCARP (SLOPE VARIES)	
EXISTING CONTOUR (1' INTERVAL)	
EXISTING CONTOUR (5' INTERVAL)	
DIRECTION OF FLOW	0.00%
RETAINING WALL	
CENTERLINE	
RIGHT-OF-WAY	
CUT LINE-ASPHALT	
EASEMENT	
ROUGH GRADE HINGE LINE	
LOT NUMBER & BLOCK NUMBER	

PROPOSED CONCRETE PAVEMENT

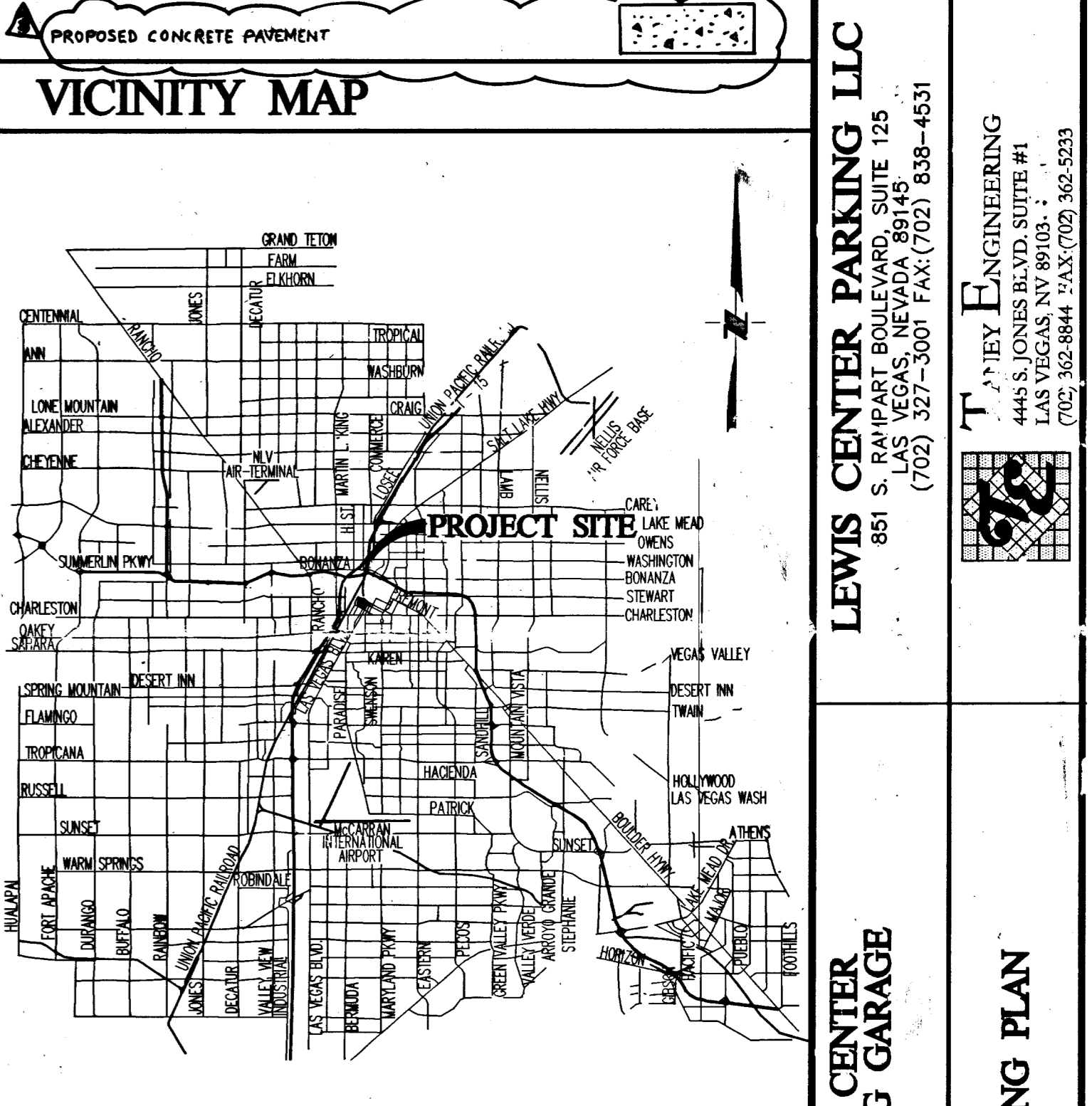

ABBREVIATIONS

AC	ASPHALTIC CONCRETE	NTS	NOT TO SCALE
BC	BACK OF CURB	OC	ON CENTER
BOR	BACK OF RADIUS	PI	POINT OF INTERSECTION
BVC	BEGINNING OF VERTICAL CURVE	PRC	POINT OF REVERSE CURVE
BM	BENCH MARK	PC	POINT OF CURVE
CATV	CABLE TELEVISION	PT	POINT OF TANGENCY
CC	CENTERLINE	PTC	PROP. TOP OF CURB
CCB	CITY OF BOULDER CITY	PPF	PROP. 'HIST' GRADE
CCCL	CLARK COUNTY	PL	PROPERTY LNL
CCO	CLEAN OUT	PB	PULL BOX
CCY	CURB YARD	R	RADIUS
CC6	DROP INLET	RC6	REINFORCED CONCRETE BOX
DC	DESIGN GRADE	RCP	REINFORCED CONCRETE PIPE
DP	EDGE OF PAVEMENT	RT	RIGHT
DG	END OF CURVE	R/W	RIGHT-OF-WAY
ED	END OF VERTICAL CURVE	SD	SANITARY SEWER
EX	EXISTING	SS	STANDARD
FF	FINISH GRADE	STA	STATION
FFL	FINISH FLOOR ELEVATION	STD	STANDARD
FE	FEET	STD	STANDARD
FI	FIRE HYDRANT	STL	STREET LIGHT
FL	FLOW LINE	STP	TOP OF CURB
FB	GRADE BREAK	TOB	TOP OF BERM
HP	HIGH POINT	TYP	TYPICAL
IN	INVERT	VER1	VERTICAL CURVE
LFE	LOWER FINISH FLOOR ELEVATION	VC	VERTICAL CURVE
LF	LINEAR FEET	VG	VALLEY GUTTER
LVWD	LAS VEGAS VALLEY WATER DISTRICT	VCP	VERTIFIED CLAY PIPE
MH	MANHOLE	W	WATER
MAX	MAXIMUM	WM	WATER METER
MIN	MINIMUM		

SCALE	LEGAL DESCRIPTION	BENCHMARK
GRAPHIC SCALE (IN FEET) 1 inch = 20 ft.	EARTHWORK CUT = 00.000 CUBIC YARDS FILL = 0.000 CUBIC YARDS OVEREXCAVATION @ 00.0% SHRINKAGE = 00.000 CY's SHRINKAGE @ 00.0% = 0.000 CUBIC YARDS NET = 00.000 CUBIC YARDS IMPORT	BASIS OF BEARING NORTH 27°54'33" EAST BEING THE BEARING OF THE CENTERLINE OF THIRD STREET AS SHOWN ON THAT CERTAIN RECORD OF SURVEY ON FILE IN THE CLARK COUNTY, NEVADA RECORDER'S OFFICE AS FILE 67, PAGE 79 OF SURVEYS.

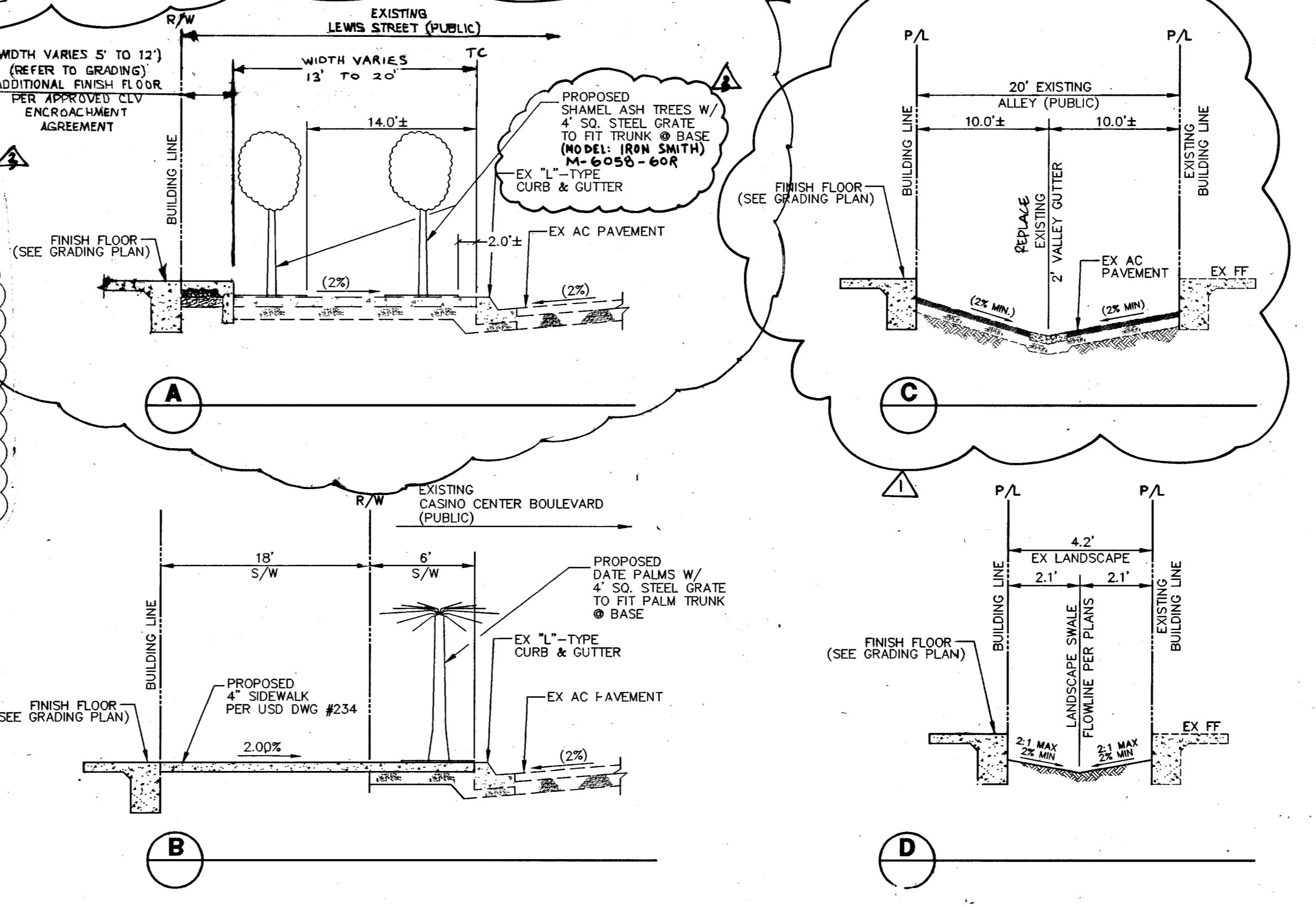

Call before you Dig
1-800-227-2600

Call before you Overhead
1-702-393-6111

UnderGround
1-702-455-7511
1-702-229-6611

CLARK COUNTY UTILITIES DEPARTMENT
LAS VEGAS VALLEY WATER DISTRICT
TRAFFIC SIGNAL SYSTEMS
AND STREET LIGHT SYSTEMS
CONDUITS. IT'S COSTLY.

Call before you Dig

DATE: **DEC-03**
SCALE: **NTS**
JOB NO: **DYS-02-03**
DESIGNED BY: **EFT**
DRAWN BY: **EL**
SHEET NAME: **G1**
SHEET: **4 OF 5**

LEWIS CENTER PARKING GARAGE
851 S. RAMPART BOULEVARD, SUITE 125
LAS VEGAS, NEVADA 89145
(702) 327-3001 FAX: (702) 838-4531

LEWIS CENTER PARKING GARAGE
851 S. RAMPART BOULEVARD, SUITE 125
LAS VEGAS, NEVADA 89145
(702) 327-3001 FAX: (702) 838-4531

GRADING PLAN

EDWARD TANEY
Exp. 6-30-07
CIVIL ENGINEER
4445 S. JONES BLVD. SUITE #1
LAS VEGAS, NV 89103
(702) 362-8844 FAX: (702) 362-5233

ENGINEER'S SEAL

REVISIONS

NO.	DESCRIPTION	DATE	BY	APPR.
1	CONSTRUCT 4" CONCRETE SIDEWALK PER USD #234 (NOTE: REMOVE AND REPLACE EXISTING SIDEWALK TO PROVIDE ADEQUATE DRAINAGE)	12-15-07	EL	APPR.
2	CONSTRUCT "L" TYPE CURB (USD #216)	12-15-07	EL	APPR.
3	COMMERCIAL DRIVEWAY PER USD #222A	12-15-07	EL	APPR.
4	CONSTRUCT 8'-WIDE CONCRETE VALLEY GUTTER	12-15-07	EL	APPR.
5	INSTALL (2) 6" PVC CONDUITS WITH PULL LINE	12-15-07	EL	APPR.
6	EXISTING POWER POLES TO BE REMOVED BY NEVADA POWER COMPANY NEVADA POWER COMPANY PROJECT NO: 172742	12-15-07	EL	APPR.