

FED. RD. REG. NO.	STATE	PROJECT NO.	COUNTY	SHEET NO.
9	NEVADA	M-610(5)	CLARK	SS-1

CONTROL POINT DATA
 STATION: 213.221L 571.26185 W 648.78147 E

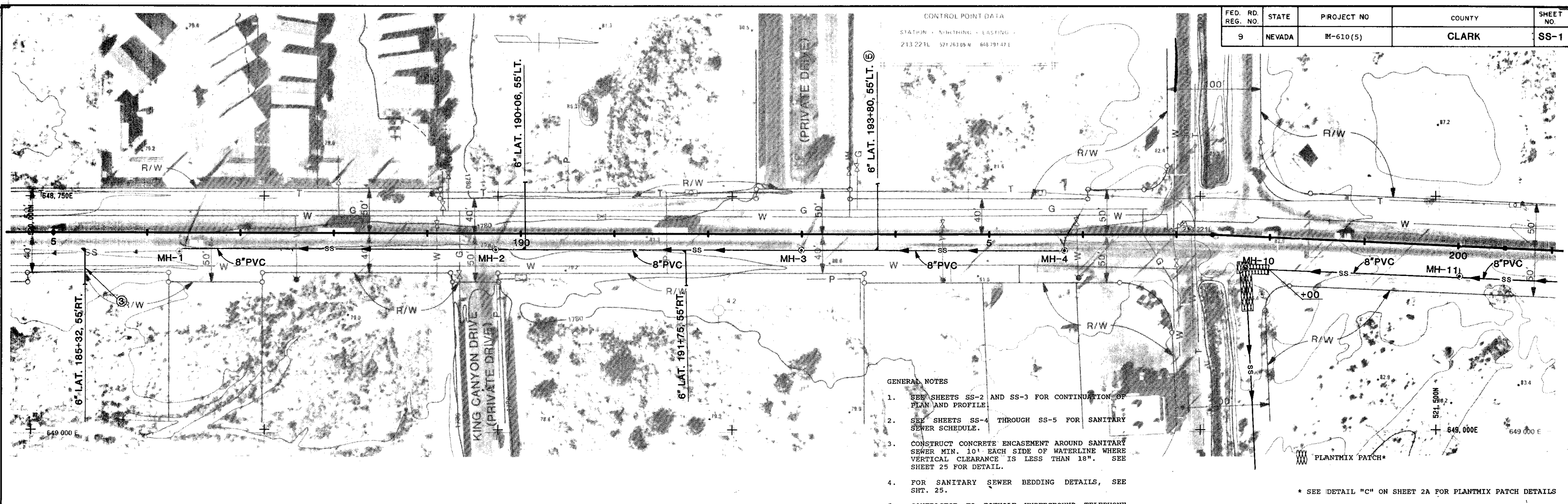

- GENERAL NOTES**
- SEE SHEETS SS-2 AND SS-3 FOR CONTINUATION OF PLAN AND PROFILE.
 - SEE SHEETS SS-4 THROUGH SS-5 FOR SANITARY SEWER SCHEDULE.
 - CONSTRUCT CONCRETE ENCASUREMENT AROUND SANITARY SEWER MIN. 10" EACH SIDE OF WATERLINE WHERE VERTICAL CLEARANCE IS LESS THAN 18". SEE SHEET 25 FOR DETAIL.
 - FOR SANITARY SEWER BEDDING DETAILS, SEE SHT. 25.
 - CONTRACTOR TO POTHOLE UNDERGROUND TELEPHONE FACILITIES PRIOR TO CONSTRUCTION OF SEWER LATERAL TO VERIFY THAT ADEQUATE SEPARATION BETWEEN TELEPHONE AND SEWER WILL BE OBTAINED.

* SEE DETAIL "C" ON SHEET 2A FOR PLANTMIX PATCH DETAILS

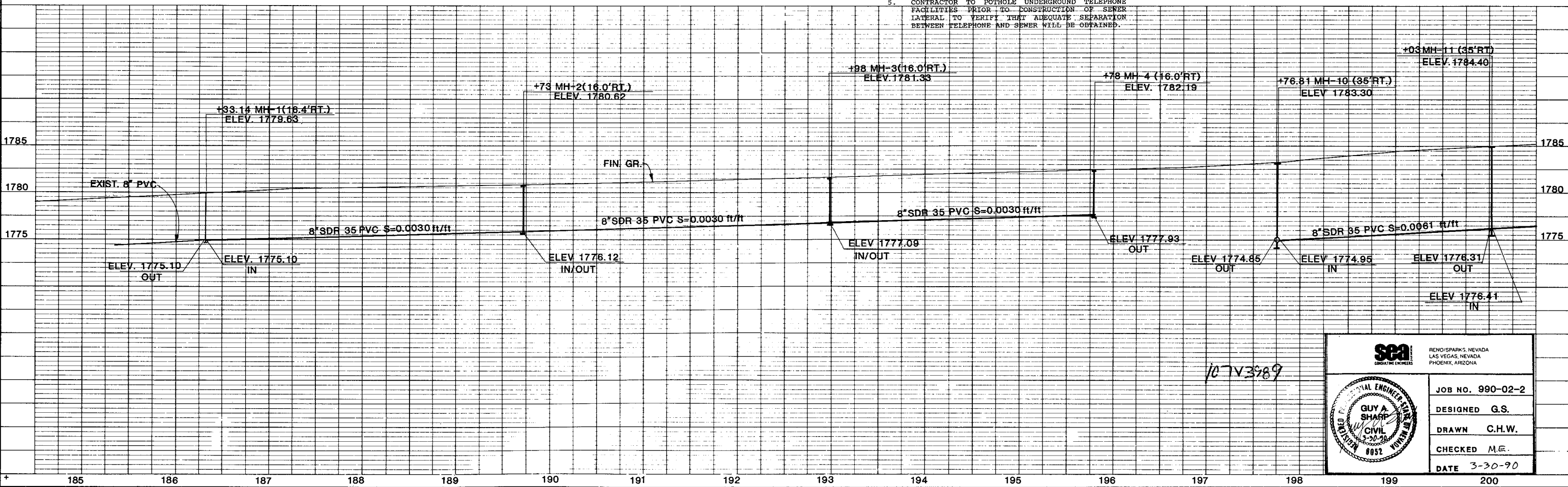

107V3989

sea
 CONSULTING ENGINEERS
 RENO/SPIRKS, NEVADA
 LAS VEGAS, NEVADA
 PHOENIX, ARIZONA

PROFESSIONAL ENGINEER
GUY A. SHARP
 CIVIL
 3-30-90
 8052

JOB NO. 990-02-2
DESIGNED G.S.
DRAWN C.H.W.
CHECKED M.E.
DATE 3-30-90

67017