

CONTROL POINT DATA
 STATION - NORTHING - EASTING
 213-221L 571 253 95 N 648 751 47 E

FED. RD. REG. NO.	STATE	PROJECT NO.	COUNTY	SHEET NO.
9	NEVADA	M-610(5)	CLARK	SD-6

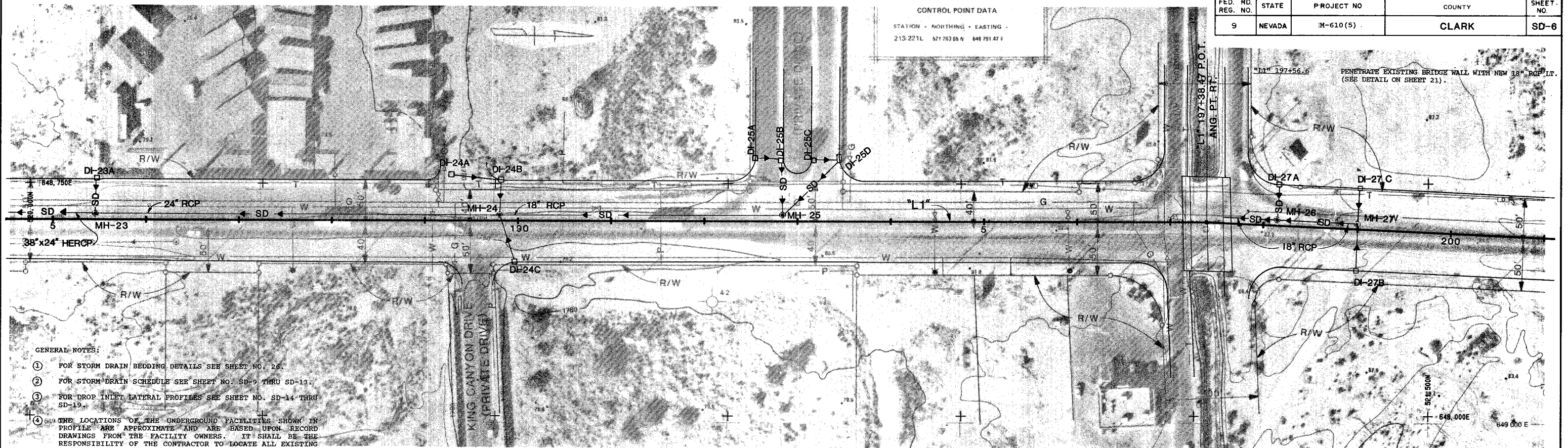

- GENERAL NOTES:
- FOR STORM DRAIN BEDDING DETAILS SEE SHEET NO. 26.
 - FOR STORM DRAIN SCHEDULE SEE SHEET NO. SD-9 THRU SD-13.
 - FOR DROP INLET LATERAL PROFILES SEE SHEET NO. SD-14 THRU SD-19.
 - THE LOCATIONS OF THE UNDERGROUND FACILITIES SHOWN IN PROFILE ARE APPROXIMATE AND ARE BASED UPON RECORD DRAWINGS FROM THE FACILITY OWNERS. IT SHALL BE THE RESPONSIBILITY OF THE CONTRACTOR TO LOCATE ALL EXISTING UNDERGROUND FACILITIES WHETHER SHOWN OR NOT, AND TO NOTIFY ALL FACILITY OWNERS TO VERIFY IN THE FIELD THE LOCATION OF THEIR INSTALLATIONS PRIOR TO CONSTRUCTION.
 - ADJUST WATERLINE PER SHEETS W-1 THRU W-8

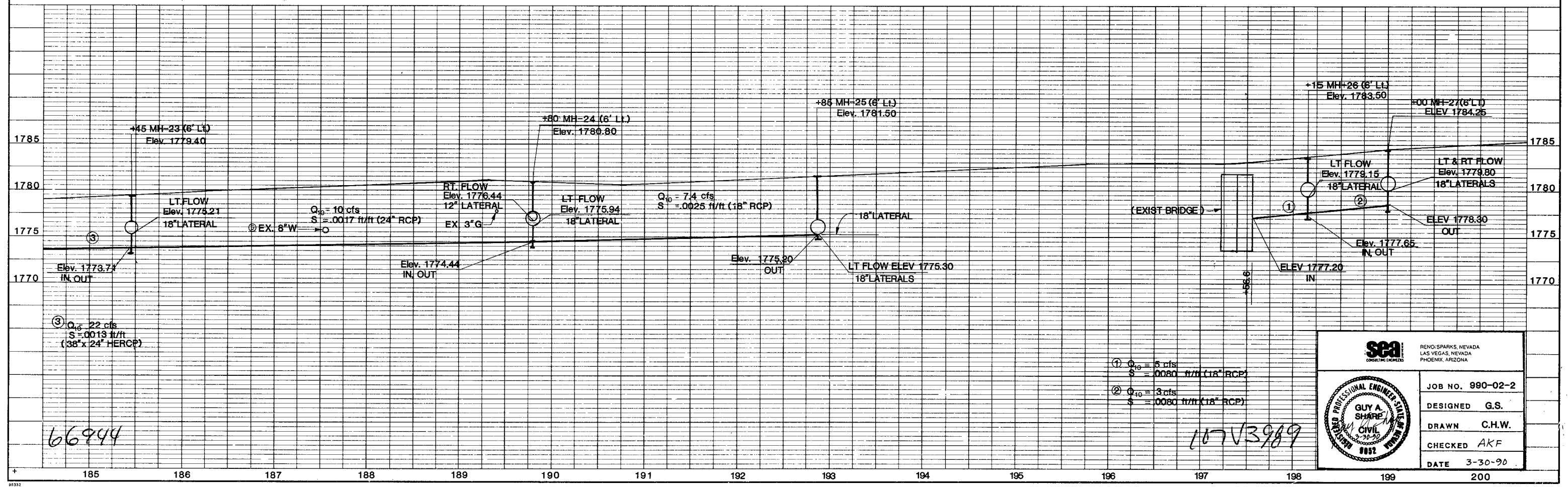

- ① $Q_{10} = 5 \text{ cfs}$
 $S = .0080 \text{ ft/ft (18\" RCP)}$
- ② $Q_{10} = 3 \text{ cfs}$
 $S = .0080 \text{ ft/ft (18\" RCP)}$

SEA
 CONSULTING ENGINEERS
 RENO, SPARKS, NEVADA
 LAS VEGAS, NEVADA
 PHOENIX, ARIZONA

PROFESSIONAL ENGINEER
GUY A. SHARE
 CIVIL
 3-20-90
 8852

JOB NO. 990-02-2
 DESIGNED G.S.
 DRAWN C.H.W.
 CHECKED AKF
 DATE 3-30-90

66944

107V3989