

FED. RD. REG. NO.	STATE	PROJECT NO.	COUNTY	SHEET NO.
9	NEVADA	M-610(5)	CLARK	T-2

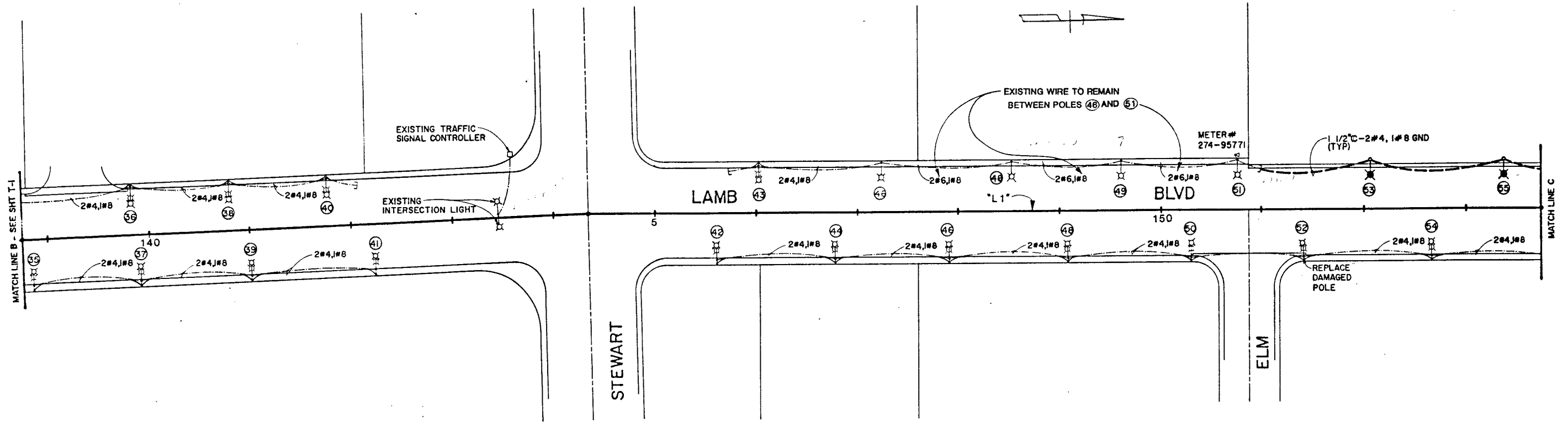

- NOTES:
1. ALL NUMBERED ELECTROLIERS SEE SHEET T-5 FOR CIRCUIT SCHEDULE AND ELECTROLIER SCHEDULE.
 2. WHERE EVER PRACTICAL INSTALL NEW CONDUIT UNDER THE SIDEWALK. WHERE NEW CONDUIT IS REQUIRED AND EXISTING SIDEWALK IS TO REMAIN IN PLACE, INSTALL NEW CONDUIT UNDER ROADWAY PAVEMENT.
 3. ALL NEW POLE BASES TO BE LOCATED AT BACK EDGE OF SIDEWALK.
 4. SEE SHEET T-5 FOR TYPICAL POLE BASE WIRING DIAGRAM.

SCALE: 1" = 50'

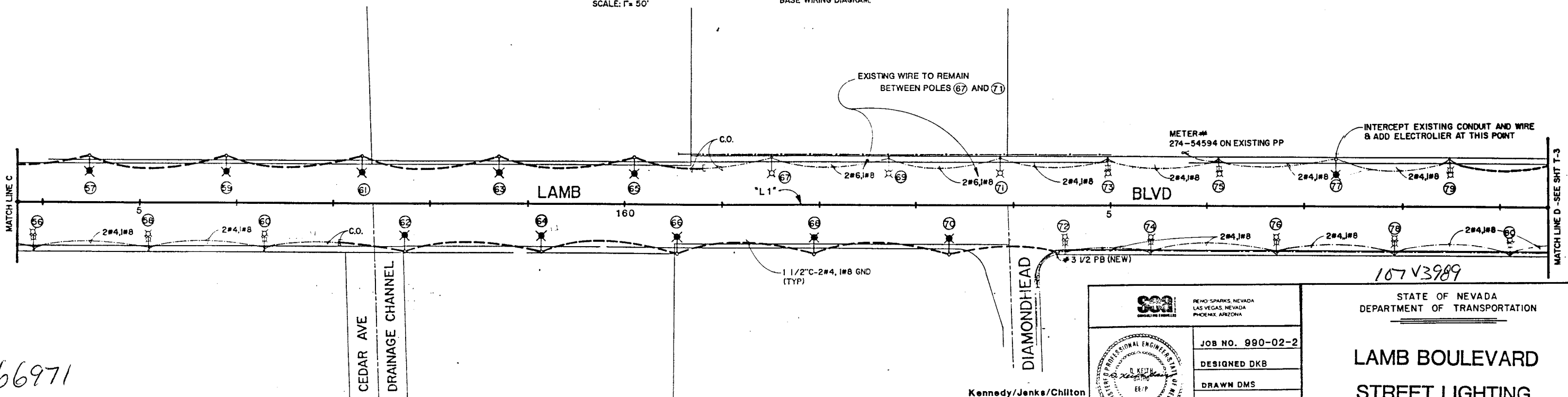

66971

Kenney/Jenks/Chilton
 Consulting Engineers
 3233 West Charleston Boulevard, Suite 110
 Las Vegas, Nevada 89102
 702-870-7502

RENO, SPARKS, NEVADA
 LAS VEGAS, NEVADA
 PHOENIX, ARIZONA

PROFESSIONAL ENGINEER
 STATE OF NEVADA
 No. 08398
 12-13-89

JOB NO. 990-02-2
DESIGNED DKB
DRAWN DMS
CHECKED HDW
DATE 12/13/89

STATE OF NEVADA
 DEPARTMENT OF TRANSPORTATION

**LAMB BOULEVARD
 STREET LIGHTING**

107V3989

STREET LIGHTING T-2