

FED. RD. REG. NO.	STATE	PROJECT NO.	COUNTY	SHEET NO.
9	NEVADA	M-610(5)	CLARK	TC-6

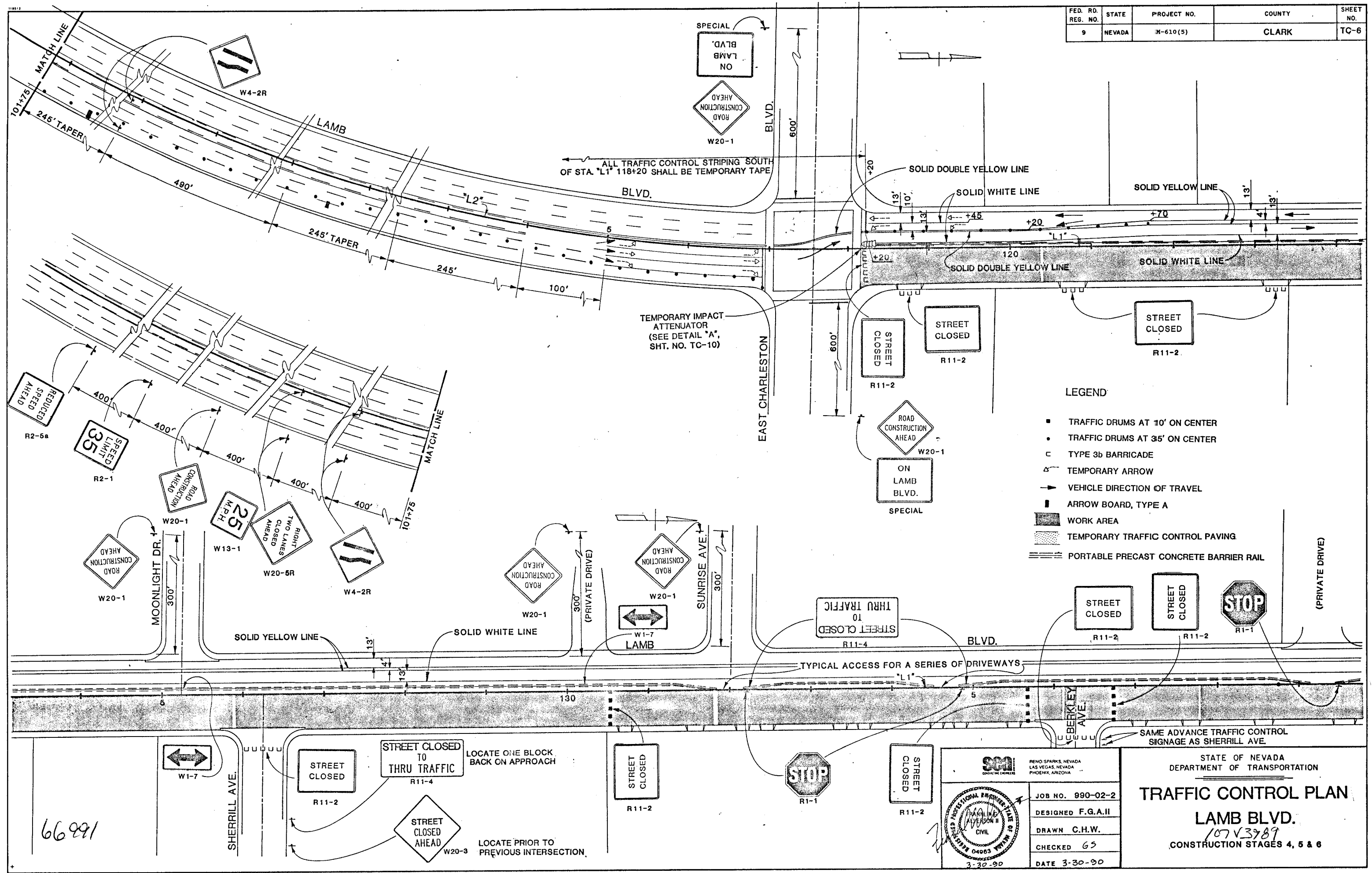

- LEGEND**
- TRAFFIC DRUMS AT 10' ON CENTER
 - TRAFFIC DRUMS AT 35' ON CENTER
 - ⊢ TYPE 3b BARRICADE
 - TEMPORARY ARROW
 - VEHICLE DIRECTION OF TRAVEL
 - ▬ ARROW BOARD, TYPE A
 - ▨ WORK AREA
 - ▨ TEMPORARY TRAFFIC CONTROL PAVING
 - ▨ PORTABLE PRECAST CONCRETE BARRIER RAIL

66991

RENO, SPARKS, NEVADA
 LAS VEGAS, NEVADA
 PHOENIX, ARIZONA

JOB NO. 990-02-2
 DESIGNED F.G.A.II
 DRAWN C.H.W.
 CHECKED GS
 DATE 3-30-90

STATE OF NEVADA
 DEPARTMENT OF TRANSPORTATION
TRAFFIC CONTROL PLAN
LAMB BLVD.
 107 V3789
 CONSTRUCTION STAGES 4, 5 & 6

STREET CLOSED TO THRU TRAFFIC R11-4
 LOCATE ONE BLOCK BACK ON APPROACH

STREET CLOSED AHEAD W20-3
 LOCATE PRIOR TO PREVIOUS INTERSECTION.