

SWITCHING ORDERS

LMT12N1
 CLOSE SW7222(FC-4504)LOCATED ON THE CORNER OF GOWAN RD.AND HUALAPAI WY.
 OPEN SW3892 (FC-3108)LOCATED ON THE NORTHEAST CORNER OF GOWAN RD.AND
 GRAND CANYON DR.
 CLOSE SW5265 (FC-3725)LOCATED ON THE NORTHEAST CORNER OF CHEYENNE AVE.
 AND SHADY TIMER ST.
 CLOSE SW2695 (FC-2460)LOCATED ON THE SOUTH SIDE OF CHEYENNE AVE.WEST OF
 SHADY TIMER ST.
 OPEN SW2674 (FC-2398)LOCATED ON THE WEST SIDE OF THOMAS W.RYAN BLVD.
 SOUTH OF CHILDRESS DR.

LMT12W1
 INSTALL A LB OVERHEAD SWITCH (IN NORMALLY OPEN POSITION)
 ON THE NORTH CIRCUIT (CHN1207) AT TRANSMISSION POLE X0994
 CLOSE SW2288 (FC-2154) LOCATED ON THE EAST SIDE OF FORT APACHE RD.AND
 SOUTH OF GOWAN RD.
 OPEN SW2291 (FC-2103)LOCATED ON THE EAST SIDE OF FORT APACHE RD. NORTH
 OF GOWAN RD.

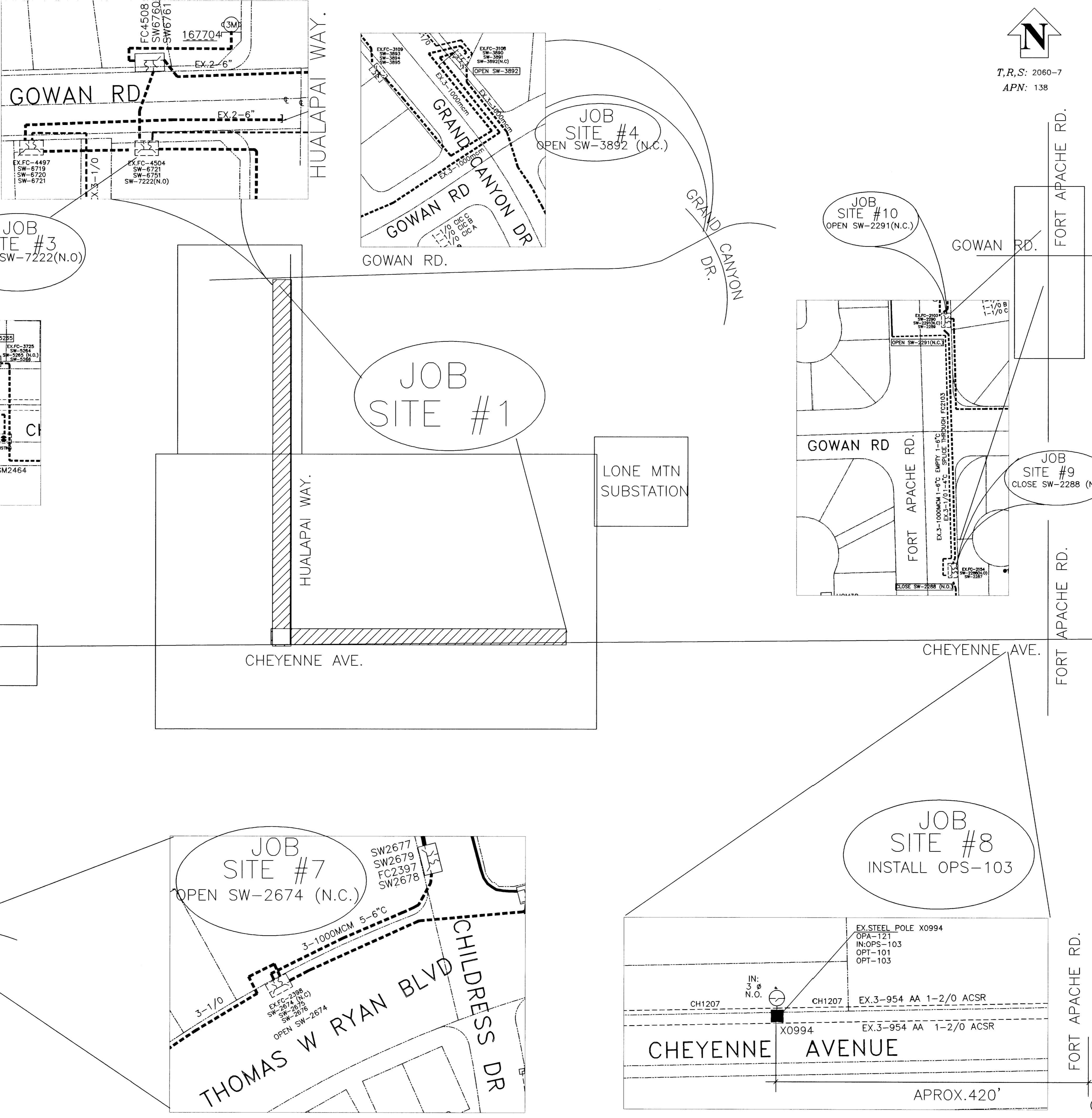

T,R,S: 2060-7
 APN: 138

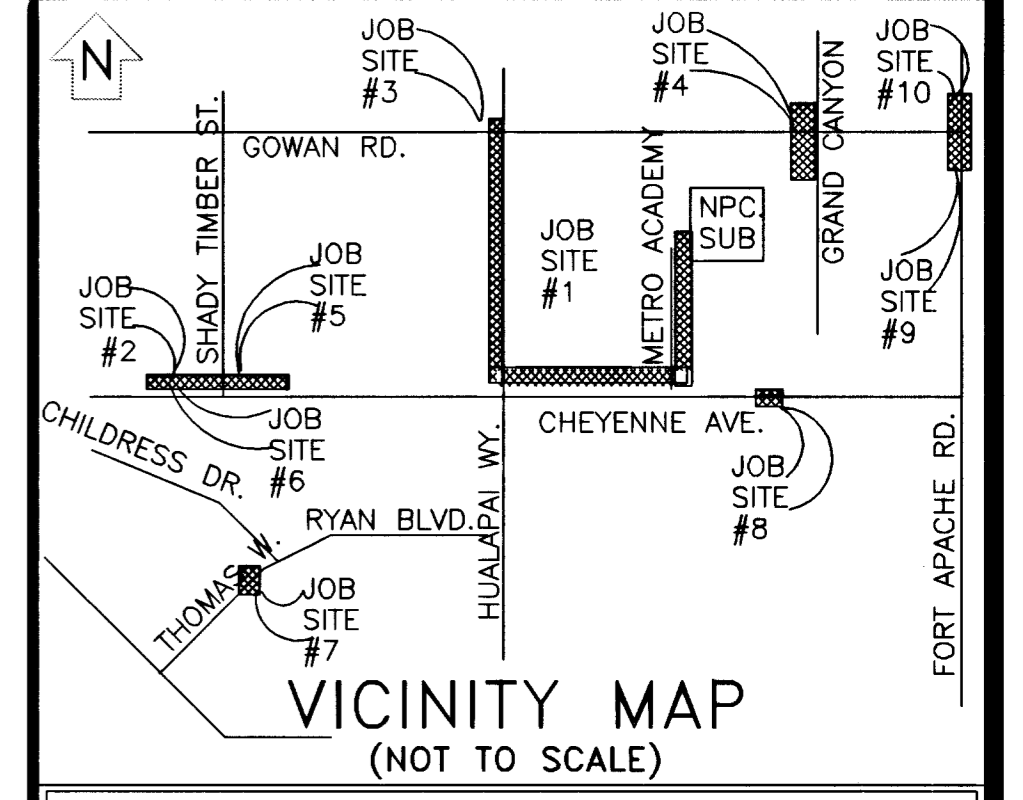

EVERY EFFORT HAS BEEN MADE TO IDENTIFY ALL NPC FACILITIES. THE CUSTOMER SHALL CONFIRM THE EXISTENCE AND LOCATION OF THESE FACILITIES.

AVOID HITTING OVERHEAD POWER LINES. IT'S COSTLY.
 CALL BEFORE YOU DO OVERHEAD

AVOID CUTTING UNDERGROUND UTILITY LINES. IT'S COSTLY.
 Call before you Dig.

1-800-227-2600
 UNDERGROUND SERVICE (USA)

REVISIONS			
NO.	DESCRIPTION	DATE	G.A.

TYPE OF EASEMENT: AERIAL STANDARD R/W-31 UNDERGROUND AS BUILT UNDERGROUND R.O.E./R/W-5-COM 3rd PARTY UNDERGROUND BY EXHIBIT (N-DOT) PERMIT (BLM) PERMIT RAILROAD-UPRR-PERMIT SO. NEVADA WATER PERMIT NOT REQUIRED Misc. Info.

JPA NOTES:
 SPRINT CONTACT: N/A
 PHONE NUMBER: _____
 DATE OF CONTACT: _____
 TO SET NEW POLES
 TO STAKE NEW POLES
 TO PROVIDE _____ POLES
 FT. CLASS _____
 FT. CLASS _____
 FT. CLASS _____
 TO DIG POLE HOLES
 TO REMOVE EX. POLES
 N/A
 JPA#: _____

NPC INFORMATION:
 COORDINATOR: MARRITTA PEREA
 PHONE: 657-4311
 DESIGNER: JORGE NAJERA
 DCA: _____
 INSPECTOR: 378-3725
 SCHEDULING: 657-4114, 657-4116, 657-4118
 DISTRICT: LAS VEGAS

CUSTOMER INFORMATION:
 DEVELOPER: NPC
 ENGINEER: NPC
 CONTACT: NPC
 APPROVAL DATE: _____

GOVERNMENT INFORMATION:
 AGENCY: CITY OF LAS VEGAS
 APPROVAL DATE: *2/24/14*

NEVADA POWER COMPANY

LONE MOUNTAIN 12W1 AND 12N1
 HUALAPAI AND CHEYENNE AVE
 107V3908-NPC

PROJ. ID: 173635 SCALE: 1" = 50'

64775