

FOR THE OFFICES OF  
**JIMMERSON HANSEN ATTORNEYS AT LAW, et al**  
**GUEST PARKING LOT**

**City of Las Vegas**  
**State of Nevada**

**SHEET INDEX**

- C1 - COVER SHEET
- C2 - GENERAL NOTES
- C3 - HORIZONTAL CONTROL PLAN
- C4 - GRADING PLAN
- C5 - UTILITY PLAN
- C6 - STRIPING PLAN

**OWNER/DEVELOPER**  
**JAMES JIMMERSON**  
 421 SOUTH 6TH STREET  
 LAS VEGAS, NV 89101

**ASSESSORS PARCEL NO.**  
 139-34-710-010

**PROJECT CONTROL NOTE**  
 REFER TO SHEET C3 FOR HORIZONTAL  
 PROJECT CONTROL

**GRADING NOTE**  
 \*\*ADD 2000 TO ALL SPOT ELEVATIONS\*\*

**REMOVAL NOTE**  
 REFER TO ARCHITECTURAL DEMOLITION  
 PLAN FOR ALL ONSITE REMOVAL ITEMS.

QUANTITIES			
ON SITE	QTY.	OFF SITE	QTY.
TYPE II AGGREGATE BASE	116 CY	TYPE II AGGREGATE BASE	2 CY
2 1/2" AC PAVEMENT	463 SY	2 1/2" AC PAVEMENT	6 SY
STRUCTURAL FILL	72 CY	STRUCTURAL FILL	1 CY
CONSTRUCT CMU VIEW WALL (3.5' MAX HEIGHT)	158 LF	CONSTRUCT CONCRETE DRIVEWAY	234 SF
BUMPER BLOCKS	8 EA	CONSTRUCT L-TYPE CURB AND GUTTER	4 LF
CONSTRUCT L-TYPE CURB & GUTTER	166 LF	CONSTRUCT "A" TYPE CURB	4 LF
CONSTRUCT "A" TYPE CURB	256 LF	INSTALL 1" COPPER WATER LINE	14 LF
4" WHITE PAVEMENT MARKINGS	353 LF	REMOVE AND RELOCATE EX. 5/8" WATER METER	1 LS
INSTALL 1" RPPA	1 EA	LANDSCAPING & INTEGRATION OF IRRIGATION SYS.	1 LS
INSTALL 1" PVC WATER LINE	8 LF	REMOVE EXISTING PARKING METERS	3 EA
REMOVE EX. SHRUBS & REWORK IRRIGATION SYS.	1 LS	REMOVE EXISTING SIDEWALK	110 SF
REMOVE EXISTING SIDEWALK	112 SF	REMOVE EXISTING CONCRETE DRIVEWAY	64 SF
CONSTRUCT SPECIAL CURB	14 LF	REMOVE EXISTING L-TYPE CURB & GUTTER	41 LF
		ABANDON EXISTING WATER METER SERVICE	1 EA
		PAINT CURB RED (NO PARKING AREA)	30 LF
		CONSTRUCT SPECIAL CURB	3 LF

**CAUTION:**  
 EXISTING UTILITY LOCATIONS SHOWN HEREIN ARE APPROXIMATE ONLY. IT SHALL BE THE CONTRACTOR'S RESPONSIBILITY TO DETERMINE THE EXACT VERTICAL AND HORIZONTAL LOCATIONS OF ALL EXISTING UNDERGROUND UTILITIES PRIOR TO COMMENCING CONSTRUCTION. NO REPRESENTATION IS MADE THAT ALL EXISTING UTILITIES ARE SHOWN HEREON. THE ENGINEER ASSUMES NO RESPONSIBILITY FOR UTILITIES NOT SHOWN IN THEIR PROPER LOCATIONS. CALL BEFORE YOU DIG: (800)227-2600.

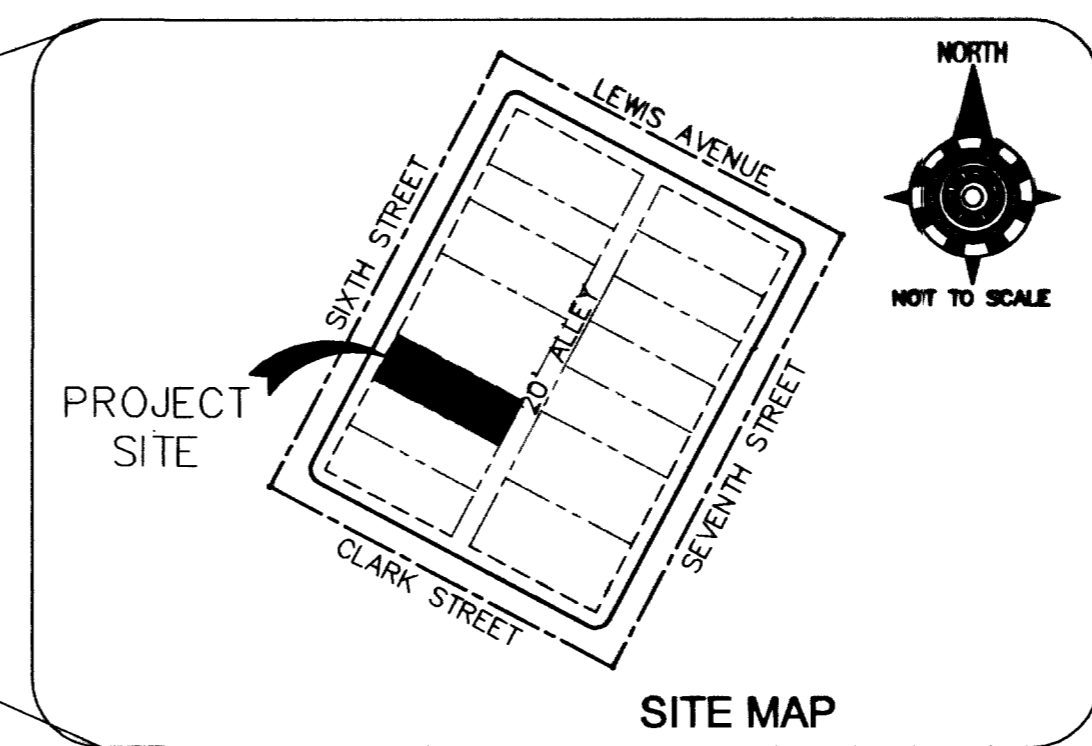
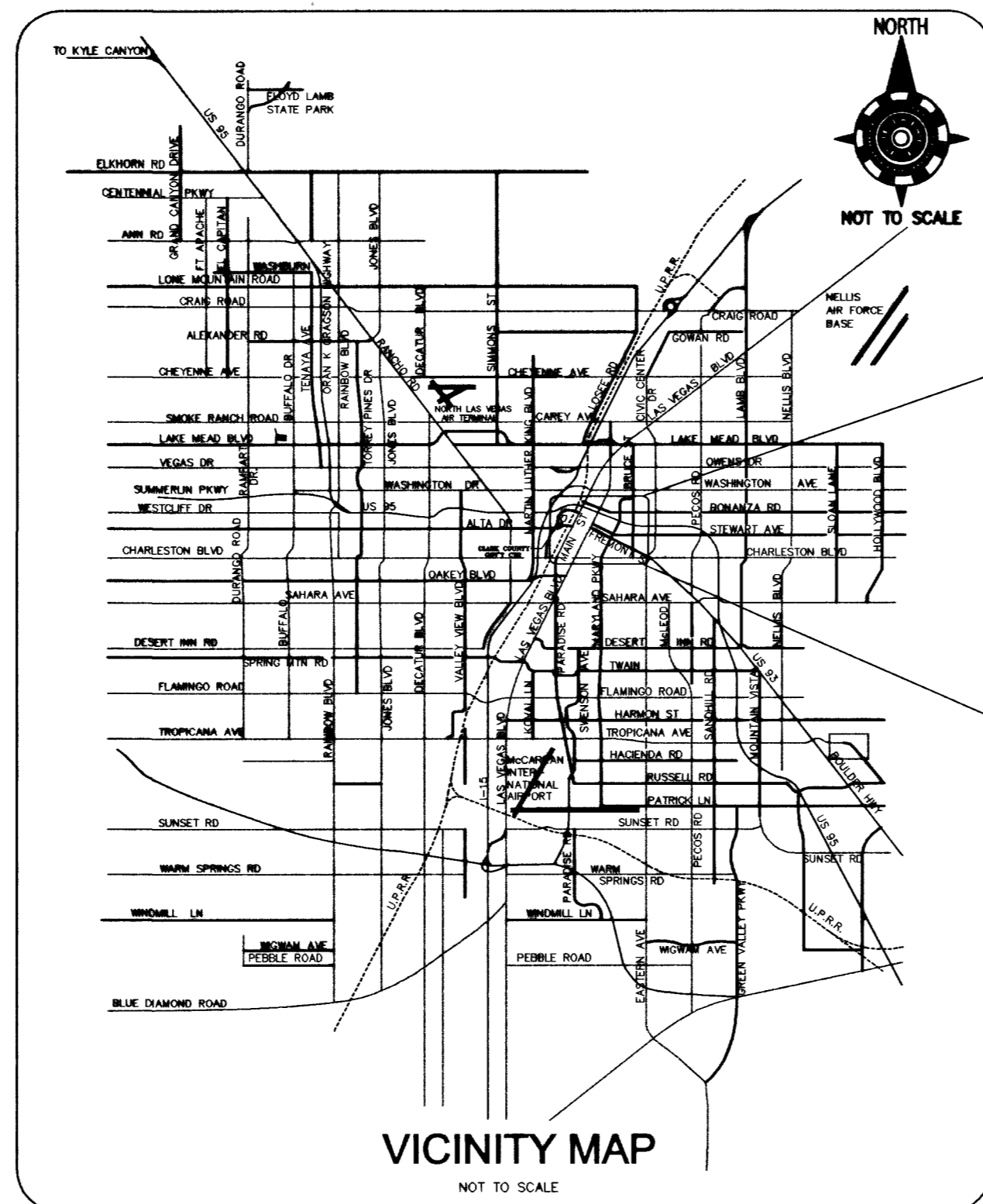

The affixed Sprint Nevada approval does not assume or guarantee liability for known or unknown conflicts with existing or proposed improvements. Resolution of any conflict will be accomplished pursuant to Local Ordinances, Nevada Revised Statutes and/or Public Utility Commission Rules and Regulations.

**DRAINAGE COMPLIANCE**  
 DRAINAGE COMPLIANCE REPORT WILL BE SIGNED BY ENGINEER ONLY AFTER CONTRACTOR HAS VERIFIED THAT THE SITE DRAINS ACCORDING TO PLAN. IF THE ENGINEER IS NOT SATISFIED WITH THE GRADING, THE CONTRACTOR WILL REGRADE TO THE ENGINEER'S SATISFACTION.

**HANDICAP ACCESS NOTE**  
 MAXIMUM GRADE FOR ALL HANDICAP ACCESSIBILITY ROUTES SHALL NOT EXCEED 5% LONGITUDINAL AND 2% TRANSVERSE.

**STRUCTURAL FILL NOTE**  
 STRUCTURAL FILL SHALL BE MOISTENED AND COMPACTED TO 90% MAX DENSITY AND SHALL BE APPLIED IN 6-INCH LIFTS.

Call before you Dig  
 1-800-227-2600  
 UNDERGROUND SERVICE (USA)

CALL BEFORE YOU DO OVERHEAD  
 1-702-593-6111

**APPROVALS**

*Charles Kajkowski* 10/20/2003  
 CHARLES KAJKOWSKI, JR., P.E. #4784  
 CITY ENGINEER DATE

APPROVAL OF THESE PLANS IS LIMITED TO THOSE IMPROVEMENTS CONSTRUCTED IN THE DEDICATED RIGHT-OF-WAY AND/OR DEDICATED EASEMENTS. THIS APPROVAL DOES NOT AUTHORIZE THE CONSTRUCTION OF ANY IMPROVEMENTS THAT DEVIATE FROM ADOPTED STANDARDS AND/OR SPECIFICATIONS, EXCEPT THOSE SPECIFICALLY LISTED UNDER DEVIATIONS FROM STANDARD. THE ENGINEER SHALL RESOLVE ANY DEVIATION OTHER THAN THOSE LISTED IN DEVIATIONS FROM STANDARDS IN FAVOR OF THE UNIFORM STANDARD DRAWINGS AND SPECIFICATIONS CLARK COUNTY AREA NEVADA.

*Don Bull* 9-26-03  
 CITY OF LAS VEGAS FIRE MARSHAL DATE

*M. Marg Wheeler* 9/26/03  
 M. MARG WHEELER, AICP CURRENT PLANNING MANAGER DATE  
 THIS PLAN MEETS THE APPLICABLE STANDARDS OF THE PLANNING AND DEVELOPMENT DEPARTMENT

*Las Vegas Valley Water District* 9/26/03  
 LAS VEGAS VALLEY WATER DISTRICT DATE

*Bryan F. Thibault* 9-25-03  
 SOUTHWEST GAS CORPORATION DATE

*Quanita Oddie* 9/25/03  
 NEVADA POWER COMPANY DATE

*Paul G. ...* 9/25/03  
 SPRINT TELEPHONE COMPANY DATE

*Mania S. Tapia* 9/25/03  
 COX COMMUNICATIONS, LAS VEGAS INC. DATE

**BENCHMARK**  
 CITY OF LAS VEGAS VERTICAL CONTROL #0LV01 3456  
 BEING A NDOT MONUMENT IN THE TOP OF CURB AT THE NORTHWEST CORNER OF BONNEVILLE AND LAS VEGAS BOULEVARD STAMPED (STA: 1131+94.74 DIST: 46.73)  
 ELEVATION: 2009.07 FEET NAVD88  
 612.3648 METERS NAVD88

**BASIS OF BEARING**  
 NORTH 27°45'00" EAST, BEING THE CENTERLINE OF SIXTH STREET AS SHOWN BY MAP THEREOF ON FILE IN BOOK 33, OF PLATS, PAGE 10, OFFICIAL RECORDS OF THE COUNTY RECORDER'S OFFICE, CLARK COUNTY NEVADA AND LYING WITHIN THE SOUTHEAST QUARTER (SE1/4) OF SECTION 34, TOWNSHIP 20 SOUTH, RANGE 61 EAST, M.D.M.

PROJ NO: A203053  
 DESIGN: GJR/RAS  
 DATE: 9/25/03  
 SCALE: N/A  
 CADFILE: JM-C1.DWG

PROFESSIONAL ENGINEER STATE OF NEVADA  
 RANDOLPH A. SKORPINSKI  
 CIVIL  
 LICENSE NO. 14585

STAMP DATE: 9-25-03  
 EXP. DATE: 8/30/04

3320 N. Buffalo Drive  
 Suite 108  
 Las Vegas, NV 89129-7410  
 Tel: 702-396-3426  
 Fax: 702-396-3758  
 Web: aztec.com

**AZTEC**

JIMMERSON HANSEN ATTORNEYS AT LAW, et al  
 GUEST PARKING LOT  
 COVER SHEET

SHEET  
 C1  
 1 of 6  
 PROJECT ID  
 107V-3836