

WATER CONSTRUCTION NOTES

Table with 2 columns: No. and ITEM. Lists 21 water construction items including pipe installation, hydrant installation, and meter installation.

SEWER CONSTRUCTION NOTES

Table with 2 columns: No. and ITEM. Lists 4 sewer construction items including wye installation, sewer lateral, clean out, and invert.

QUANTITIES SEE SHEET C-3 FOR QUANTITIES
SEWER CONTRIBUTION AVERAGE FLOW = 0.003 MGD PEAK FLOW = 0.010 MGD

ABANDONMENT OF VAULT STRUCTURES

THE CONTRACTOR WILL REMOVE THE TOP OF THE EXISTING VAULT AND REMOVE THE EXISTING WATER FACILITIES. THE OLD VAULT MAY BE ABANDONED IN PLACE. THE EXISTING METER(S) SHALL BE REMOVED AND DELIVERED TO THE DISTRICT. THE CONTRACTOR SHALL THEN REMOVE AND/OR BACKFILL THE ABANDONED VAULT.

REDUCED PRESSURE PRINCIPLE ASSEMBLY (2-2)

APPROVED REDUCED PRESSURE PRINCIPLE ASSEMBLY(S) SHALL BE INSTALLED PER THE UDACS PLATE NO. 11A. NO WATER SHALL BE TAKEN FROM THE SERVICE REQUIRING BACKFLOW PREVENTION UNTIL THE REDUCED PRESSURE ASSEMBLY HAS BEEN SUCCESSFULLY TESTED BY THE LVWD.

ANY BLOCK WALL OR OTHER FENCE MATERIAL SHALL BE DESIGNED AND CONSTRUCTED AROUND THE OUTSIDE OF THE EASEMENT(S), SO AS TO ALLOW THE DISTRICT DIRECT ACCESS FROM THE ADJACENT RIGHT-OF-WAY. EASEMENT TO BE CLEARLY STAKED PRIOR TO CONSTRUCTION.

DOUBLE CHECK DETECTOR ASSEMBLY (1) 8" (1) 6"

THE DOUBLE CHECK DETECTOR ASSEMBLY SHALL BE INSTALLED IN ACCORDANCE WITH THE UDACS PLATE 20B.

ANY BLOCK WALL OR OTHER FENCE MATERIAL SHALL BE DESIGNED AND CONSTRUCTED AROUND THE OUTSIDE OF THE EASEMENT(S), SO AS TO ALLOW THE DISTRICT DIRECT ACCESS FROM THE ADJACENT RIGHT-OF-WAY.

LAS VEGAS FIRE DEPARTMENT

FIRE FLOW REQUIREMENT IS: 2,375 GPM AT 20 PSI RESIDUAL PRESSURE.

Table comparing Phase I and Phase II fire flow requirements, square footage, building height, and other fire department specifications.

** INFORMATION NOT AVAILABLE AT THIS TIME

ABANDONMENT OF EXISTING SERVICES - LARGER THAN 2"
THE CONTRACTOR SHALL NOTIFY THE INSPECTION DIVISION AT THE LVWD 702-258-3227 48 HOURS PRIOR TO THE REQUESTED REMOVAL TIME TO ALLOW THE DISTRICT TO TAKE THE FINAL METER READING OF THE METER. AFTER THE FINAL READING, THE CONTRACTOR MAY THEN BEGIN REMOVAL PROCEDURES

LVWD NOTE
THE DISTRICT CAN NOT GUARANTEE A WATER-TIGHT SHUTDOWN WHERE CONNECTIONS OR REPAIRS TO EXISTING FACILITIES ARE REQUIRED. THE CONTRACTOR SHALL ENSURE ALL LABOR AND EQUIPMENT IS AVAILABLE TO REMOVE FUGITIVE WATER WHICH MAY IMPEDE CONSTRUCTION AT ALL TIMES. COORDINATION WITH INSPECTION DIVISION CONTRACTOR TO INSTALL TEMPORARY SERVICE TO ENSURE PROPER SHUTDOWN IN THE EVENT NO OTHER APPURTENANCES ARE AVAILABLE.

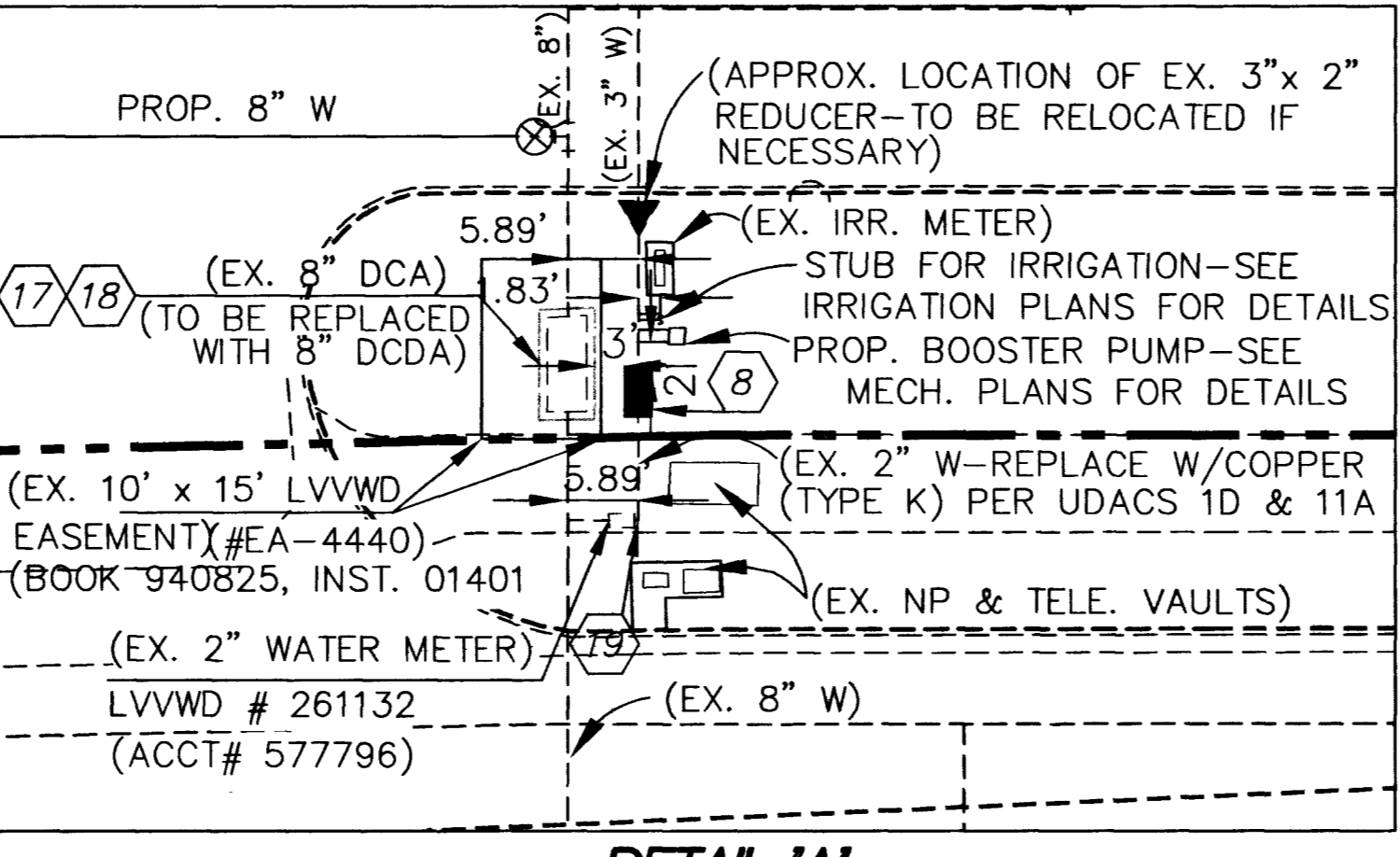
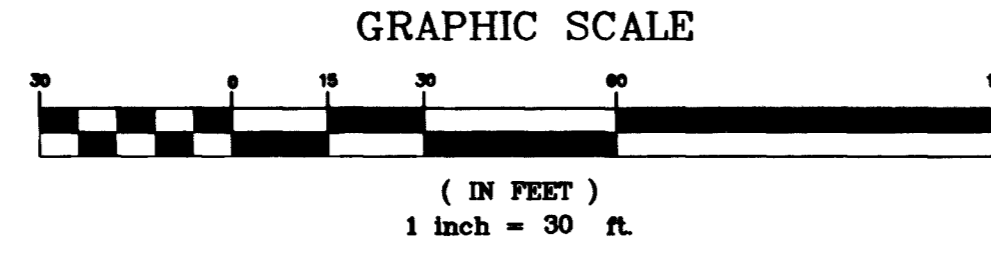

NOTE
1) ALL DIMENSIONS TO UTILITIES ARE TO CENTERLINE OF PIPES UNLESS INDICATED OTHERWISE.
2) CONTRACTORS SHALL VERIFY HORIZONTAL AND VERTICAL ALIGNMENT OF EXISTING UTILITIES AND TO NOTIFY THE DESIGN ENGINEER IMMEDIATELY ON ANY DISCREPANCIES PRIOR TO CONSTRUCTION.

BASIS OF BEARINGS
N42°00'00"E BEING THE CENTERLINE OF TOWN CENTER DRIVE AS SHOWN ON THE CROSSINGS AT SUMMERLIN VILLAGE 8 UNIT NO. 1, PHASE 1 SUBDIVISION PLAT, RECORDED IN BOOK 58, PAGE 84 OF PLATS IN THE OFFICE OF THE CLARK COUNTY, NEVADA RECORDER.

BENCHMARK
"SEA HAG" CONTROL MONUMENT AS SHOWN ON THE VILLAGE 8 SUMMERLIN CENTERLINE & MONUMENT CONTROL MAP, PREPARED BY G.C. WALLACE, ELEVATION BEING 2851.63 USFT (NGVD 29). CLV BENCHMARK IS OLVOO 30W4, ELEVATION BEING 869.866 METERS=2853.89 USFT (NAVD 88). TO OBTAIN CLV BM OLVOO 30WR NAVD 88 ELEVATIONS, ADD 2.26 FT TO "SEA HAG" ELEVATION.

CONSTRUCTION NOTE
ALL EXISTING UTILITY STRUCTURES WITHIN CONSTRUCTION AREA SHALL BE ADJUSTED TO MATCH FINISHED GRADE (I.E. WV, BOX, WMH, ANNODE BOX, FH, TEL BOX, ETC.)

Call before you Dig. 1-800-227-2800

Call before you Overhead. 1-702-593-6111

APPROVED FOR CONSTRUCTION
LAS VEGAS VALLEY WATER DISTRICT DATE
SHEETS 1, 2, 4
FIRE MARSHAL DATE

Approval table with columns for DATE, APPROVAL, and DESCRIPTION. Includes entries for 7-23-03 and 7/16/03.

TKC The Keith Companies logo and contact information: 444 East Warm Springs Road, Suite 110, Las Vegas, Nevada 89119. Phone (702) 263-4208. Fax (702) 263-4209. Email: tkc@tkc.com

KLOEHN COMPANY, INC.
PHASE II
MASTER UTILITY PLAN
FEBRUARY 6, 2003

JOB # 51649.00
SHEET NO.:
C4
4 OF 6 SHEETS
CLV# 107-3 (6010)
107-V-3-78