

**BENCHMARK**  
 CLV BM "01V00 32556"  
 BEING A RIVET AND PLATE IN TOP OF CURB.  
 @ NE CORNER OF CHARLESTON AND MERALDO  
 ELEV=2694.75 FEET (821.3617 METERS) (NAVD88)  
 AS OF JUNE 03, 2002

**BASIS OF BEARINGS**  
 N89°40'03"E - THE NORTH LINE OF SECTION 5, T21S, R60E,  
 M.D.M., CLARK COUNTY, NEVADA PER CHARLESTON-DURANGO  
 COMMERCIAL CENTER AS FILED IN BOOK 72, PAGE 90 OF PLATS  
 IN THE OFFICE OF THE RECORDER OF CLARK COUNTY, NEVADA.

**LEGAL DESCRIPTION**  
 ALL OF PAD "E" PER RECORD OF SURVEY FILE 122 PAGE 23,  
 ON FILE IN THE OFFICE OF THE CLARK COUNTY RECORDER,  
 CLARK COUNTY, NEVADA.

**CONSTRUCTION NOTES**

- CONSTRUCT THREE (3) STEPS, 7" RISER, 12" TREAD
- CONSTRUCT 2" CONCRETE WATERWAY
- CONSTRUCT 2" "L" TYPE CURB & GUTTER
- INSTALL 26"x26" DROP INLET (JENSEN PRECAST #011624 OR EQUAL) WITH SUMP PUMP (BY OTHERS)
- REMOVE EXISTING DRIVEWAY AND HC RAMPS FROM STA 11+87.38 TO STA 12+59.23, AND REPLACE WITH 2" "L" TYPE CURB, GUTTER & 5' SIDEWALK
- REMOVE AND REPLACE EXISTING ASPHALT. LIMITS AS SHOWN
- INSTALL EROSION CONTROL BLANKET AT A MIN 1" ABOVE TOP OF CURB (BONTERRA AMERICA SFB 10 oz/sy OR EQUAL) (PH: 800-882-9489)
- INSTALL HANDRAIL \_\_\_\_\_ 25 LF
- CONSTRUCT 18" CONCRETE WATERWAY THRU CURB PER DETAIL SHEET C9
- CONSTRUCT TEMPORARY 6" AC CURB
- CONSTRUCT DRIVEWAY, CROSS GUTTER AND HANDICAP RAMPS PER USDOCCA STD DWG #222A AND 225, #228 AND #235-CASE 1.

**GRADING NOTES**

- ALL GRADING AND PAVING TO BE COMPLETED IN STRICT ACCORDANCE WITH OWENS GEOTECHNICAL INC. SOILS REPORT NO. E-02-060, UPDATED MAY 6, 2002
- PAVING SECTION TO BE A MINIMUM OF TWO (2") INCHES ASPHALT ON A MINIMUM OF 4 INCHES (4") TYPE II FOR STANDARD DUTY AND A MINIMUM OF THREE (3") INCHES ASPHALT ON A MINIMUM OF 4 INCHES (4") TYPE II FOR HEAVY DUTY
- PAD ELEVATION IS BASED ON 4 INCHES (4") TYPE II OVERLAY BY A 6 MIL. VISQUEEN MEMBRANE COVERED WITH 2 INCHES (2") OF SAND ALL UNDER A 4 INCH (4") CONCRETE FLOOR \*\*\*\*\* SEE SOILS REPORT FOR ALTERNATIVE \*\*\*\*\*

**CURVE TABLE**

CURVE	DELTA	RADIUS	LENGTH	TANGENT
C1 BC	90°00'00"	15.00'	23.56'	15.00'
C2 BC	90°00'00"	25.00'	39.27'	25.00'
C3 BC	88°54'36"	15.00'	23.28'	14.72'
C4 BC	64°34'14"	25.00'	28.17'	15.80'
C5 BC	26°27'09"	40.50'	18.70'	9.52'
C6 BC	13°11'49"	40.50'	9.33'	4.68'
C7 BC	90°00'00"	25.00'	39.27'	25.00'
C8 BC	90°00'00"	15.00'	23.56'	15.00'

**HANDICAP RAMP TABLE**  
 USDOCCA DWG 235 - CASE 1

RAMP	A	B
1	8.00 FT	N/A
2	N/A	8.00 FT
3	8.00 FT	N/A
4	N/A	8.00 FT
5	8.00 FT	N/A
6	N/A	8.00 FT

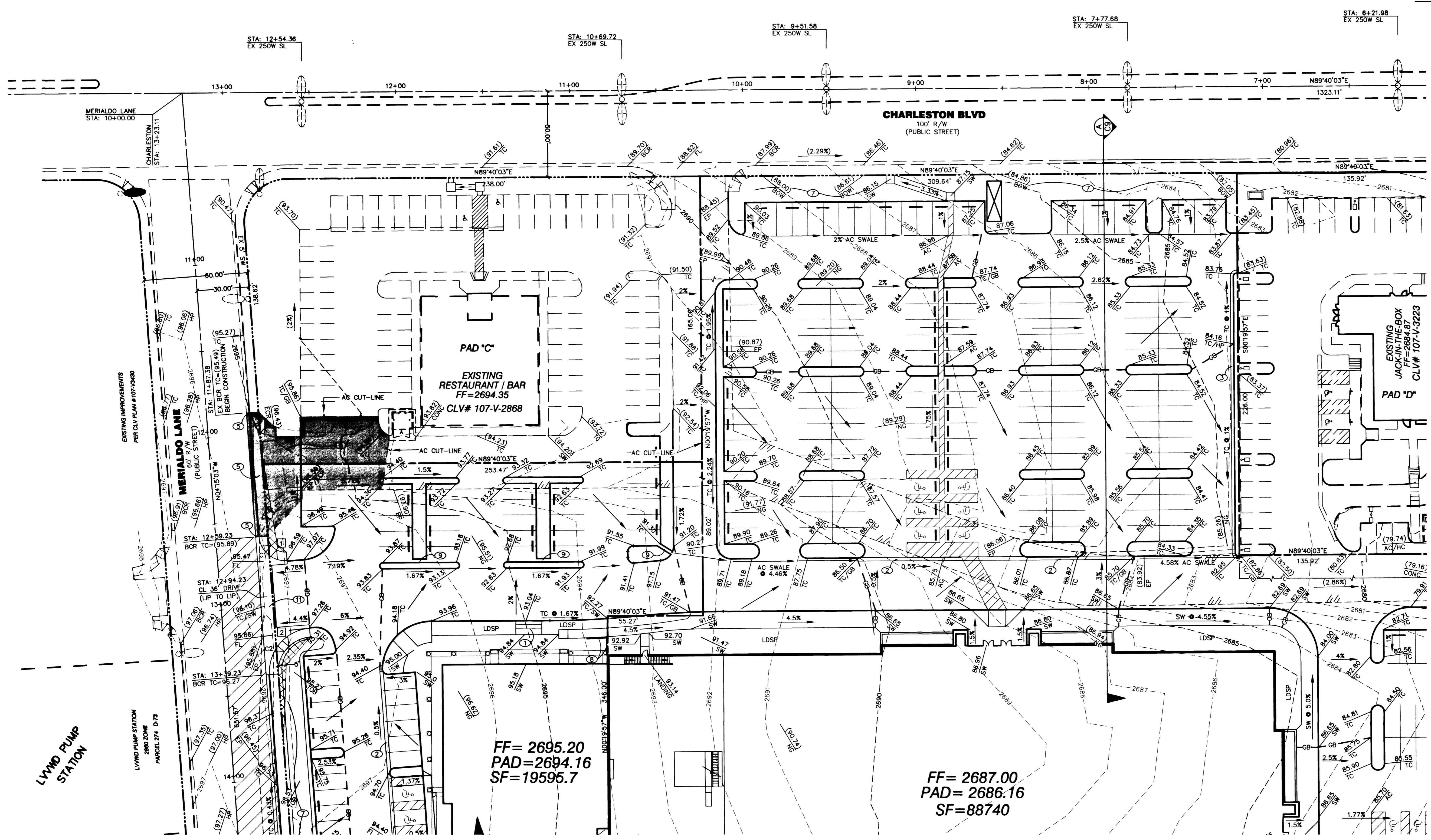
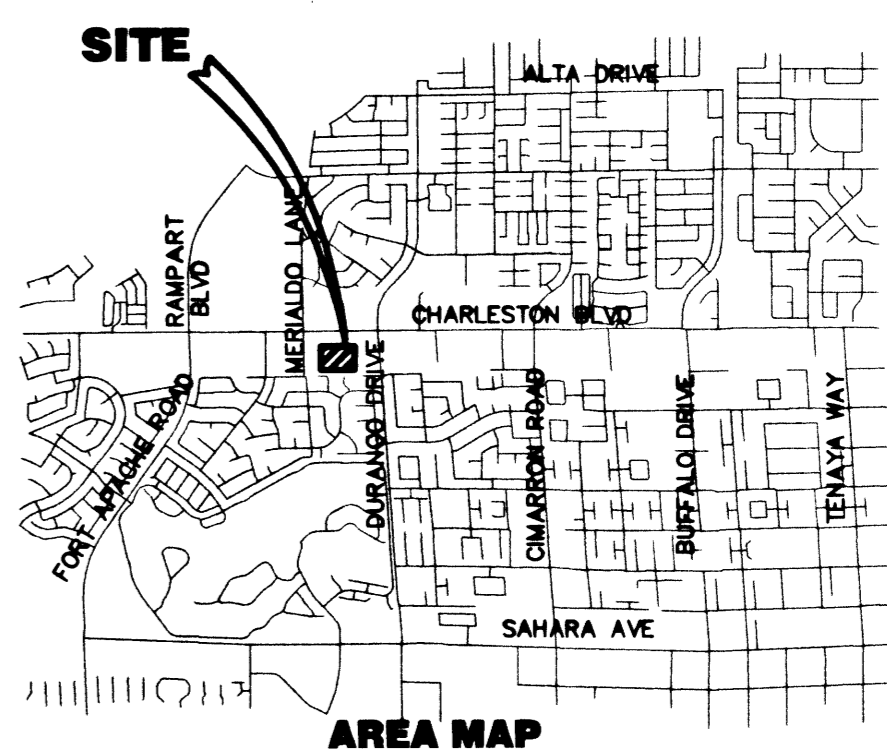

- LEGEND**
- PROPERTY LINE
  - RIGHT OF WAY
  - CENTERLINE
  - EXISTING CURB
  - PROPOSED CURB
  - EDGE OF PAVEMENT
  - EXISTING BLOCK WALL
  - ASPHALTIC CONCRETE
  - BLOCK WALL
  - CURB & GUTTER
  - CENTERLINE
  - DRIVEWAY
  - EDGE OF PAVEMENT
  - EXISTING
  - FINISH GRADE
  - FIRE HYDRANT
  - FLOW LINE
  - GRADE BREAK
  - HIGH POINT
  - PROPERTY LINE
  - STREET LIGHT
  - MANHOLE
  - STATION
  - SIDEWALK
  - TOP BACK OF CURB
  - TOP OF CURB
  - TOP OF MANHOLE
  - TOP OF BERM
  - VALLEY GUTTER
  - SIGHT VISIBILITY RESTRICTION ZONE

REV	DATE	BY	DESCRIPTION

**PECCOLE ENTERPRISES, LTD**  
 8238 W. CHARLESTON BLVD., LAS VEGAS, NEVADA 89117  
 CONTACT: ROB PECCOLE, JR. PHONE: 366-9140 FAX: 366-9217

**JFR Associates Ltd.**  
 4880 W. UNIVERSITY, SUITE B-2 PH (702) 876-2341  
 LAS VEGAS, NEVADA 89103 FAX (702) 876-8395

**GRADING PLAN - A -**

**KOHL'S DEPARTMENT STORE**  
 CHARLESTON DURANGO COMMERCIAL CENTER  
 CITY OF LAS VEGAS, NEVADA

**ENGINEER'S CERTIFICATE**  
 I CERTIFY THAT THIS GRADING PLAN IS IN CONFORMANCE WITH THE APPROVED DRAINAGE STUDY ON FILE AT THE CITY OF LAS VEGAS.

REESE P. JARRELL, P.E. #7867 DATE 10/10/02

**GRAPHIC SCALE**  
 30 15 0 30 90  
 (IN FEET)  
 1 inch = 30ft.

**SEE SHEET G2**

**SEE SHEET G3**

**PRIVATE FLOOD CONTROL QUANTITIES**  
 EROSION CONTROL BLANKET \_\_\_\_\_ 3,330 SF  
 FLOOD WALL \_\_\_\_\_ 60 LF  
 DECORATIVE ROCK  
 (MERALDO LANE D50=3 INCHES) \_\_\_\_\_ 20 CY  
 (CHARLESTON BLVD D50=6 INCHES) \_\_\_\_\_ 12 CY

**CALL BEFORE YOU DIG**  
 1-800-227-2800  
 (48 hrs. Advance Notice Required)

**CALL BEFORE YOU OVERHEAD**  
 1-702-693-6111  
 NEVADA POWER ENVIRONMENT AND SAFETY SERVICES DEPARTMENT

**RECEIVED FOR RECORD**  
 REESE P. JARRELL  
 REGISTERED PROFESSIONAL ENGINEER STATE OF NEVADA  
 NO. 7867 NOV 10 2002

EXP. 6/30/03  
 SHEET **G1**  
 SHEET 4 OF 11 SHEETS  
 107-V-3630