

NOTE: WHERE WATER AND SEWER ARE CROSSING, THE CONTRACTOR SHALL ENSURE COMPLIANCE WITH LVVWD GENERAL NOTE 8 AS SHOWN ON SHEET C2. CONTRACTOR IS RESPONSIBLE TO QUANTIFY ANY ADDITIONAL REQUIREMENTS THIS NOTE REQUIRES PRIOR TO BIDDING. IF ANY CONFLICT TO EXIST, THE CONTRACTOR IS TO NOTIFY THE ENGINEER IMMEDIATELY.

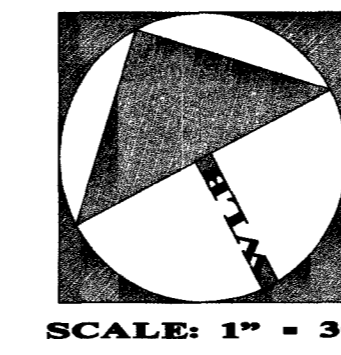

NOTE: QUANTITIES SHOWN ON THIS SHEET ARE FOR INFORMATIONAL PURPOSES ONLY. OTHER QUANTITIES MAY EXIST. THE CONTRACTOR SHALL VERIFY ALL QUANTITIES PRIOR TO BIDDING.

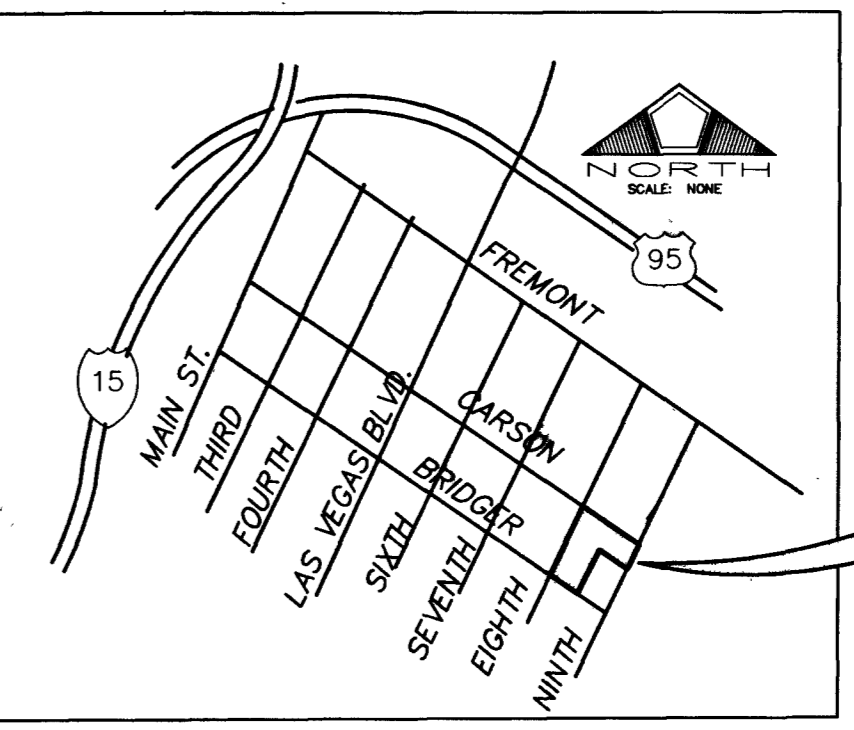
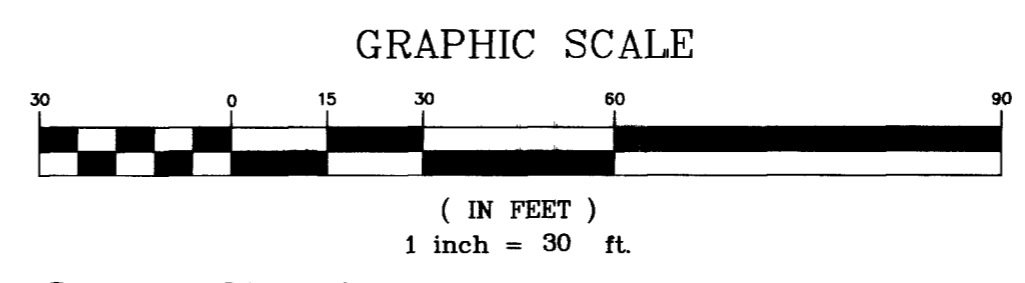

PROJECT SITE

VICINITY MAP

FIRE DEPARTMENT

FIRE FLOW REQUIREMENT IS 3500 GALLONS PER MINUTE AT 20 POUNDS PER SQUARE INCH RESIDUAL.
 BASED ON:
 SQUARE FOOTAGE 146,297 SF
 LARGEST AREA BETWEEN 4-HOUR AREA SEPARATION WALLS N/A
 HEIGHT FOUR (4) STORIES
 TYPE OF CONSTRUCTION V - ONE HOUR
 EXPOSURES
 SPRINKLER SYSTEM YES
 OCCUPANCY RESIDENTIAL (R-1)
 ROOF CONSTRUCTION

REVIEWED BY: [Signature]
 DATE: 3.5.02

APPROVAL OF THESE PLANS SHALL NOT BE CONSTRUED TO BE A PERMIT FOR NOR AN APPROVAL OF ANY VIOLATION OF ANY OF THE PROVISIONS OF THE STATE OR COUNTY LAWS.
 *BASED ON 50% REDUCTION

FIRE DEPARTMENT APPROVAL
 APPROVAL BY THE FIRE DEPARTMENT HAVING JURISDICTION IS REQUIRED PRIOR TO OBTAINING FINAL APPROVAL FROM THE LVVWD.

NOTE: THESE PLANS SHALL NOT, IN PART OR IN WHOLE, BE USED FOR CONSTRUCTION UNTIL APPROVED AND SIGNED BY THE GOVERNING AGENCIES.

WATER CONSTRUCTION NOTES

DESCRIPTION	QUANTITY	PRIVATE	PUBLIC	EA
1. INSTALL 6" DCCA PER UDACS PLATE NO. 11D	0	1		EA
2. INSTALL 2" RPPA PER UDACS PLATE NO. 11A	0	3		EA
3. INSTALL 2" WATER METER AND SERVICE PER UDACS PLATE NO. 1D	0	3		EA
4. INSTALL 8" x 6" WET TAP AND 6" GATE VALVE	0	2		EA
5. INSTALL PUBLIC FIRE HYDRANT PER UDACS PLATE NO. 7	0	3		EA
6. REMOVE EXISTING CAP.	0	1		EA
7. INSTALL 8" GATE VALVE	0	1		EA
8. INSTALL 8" CAP	0	1		EA
9. INSTALL 1" RPPA PER UDACS PLATE NO. 11A	0	1		EA
10. INSTALL 1" WATER METER AND SERVICE PER UDACS PLATE NO. 1D	0	1		EA
11. INSTALL 1" BLOWOFF VALVE AND CAP	0	1		EA
12. INSTALL 2"x5" REDUCER (OR EQUIVALENT)	3	0		EA
13. INSTALL 5" 90 BEND	2	0		EA
14. INSTALL 4" CROSS	0	0		EA
15. INSTALL 6" 90° BEND	2	0		EA
16. FOR CONTINUATION SEE PLUMBING PLANS	2	0		EA
17. INSTALL 5" TEE	3	0		EA
18. INSTALL 8" x 8" M.J. TAPPING TEE AND VALVE	0	1		EA
19. TRENCH PER CC STD. DWG. NO. 504 EXACT LIMITS TO BE DETERMINED BY CLV INSPECTOR.				

SEWER CONSTRUCTION NOTES

DESCRIPTION	QUANTITY	PRIVATE	PUBLIC	EA
1. INSTALL 60" SSMH PER C.C.S.D. STD. DWG. NO. SD-1	0	2		EA
2. INSTALL 10" PVC SEWER LATERAL	30	0		LF
3. SEE PLUMBING PLANS FOR CONNECTION				
4. INSTALL 6" PVC SEWER LATERAL ~	25	0		LF
5. SEE PLUMBING PLANS FOR CONNECTION				

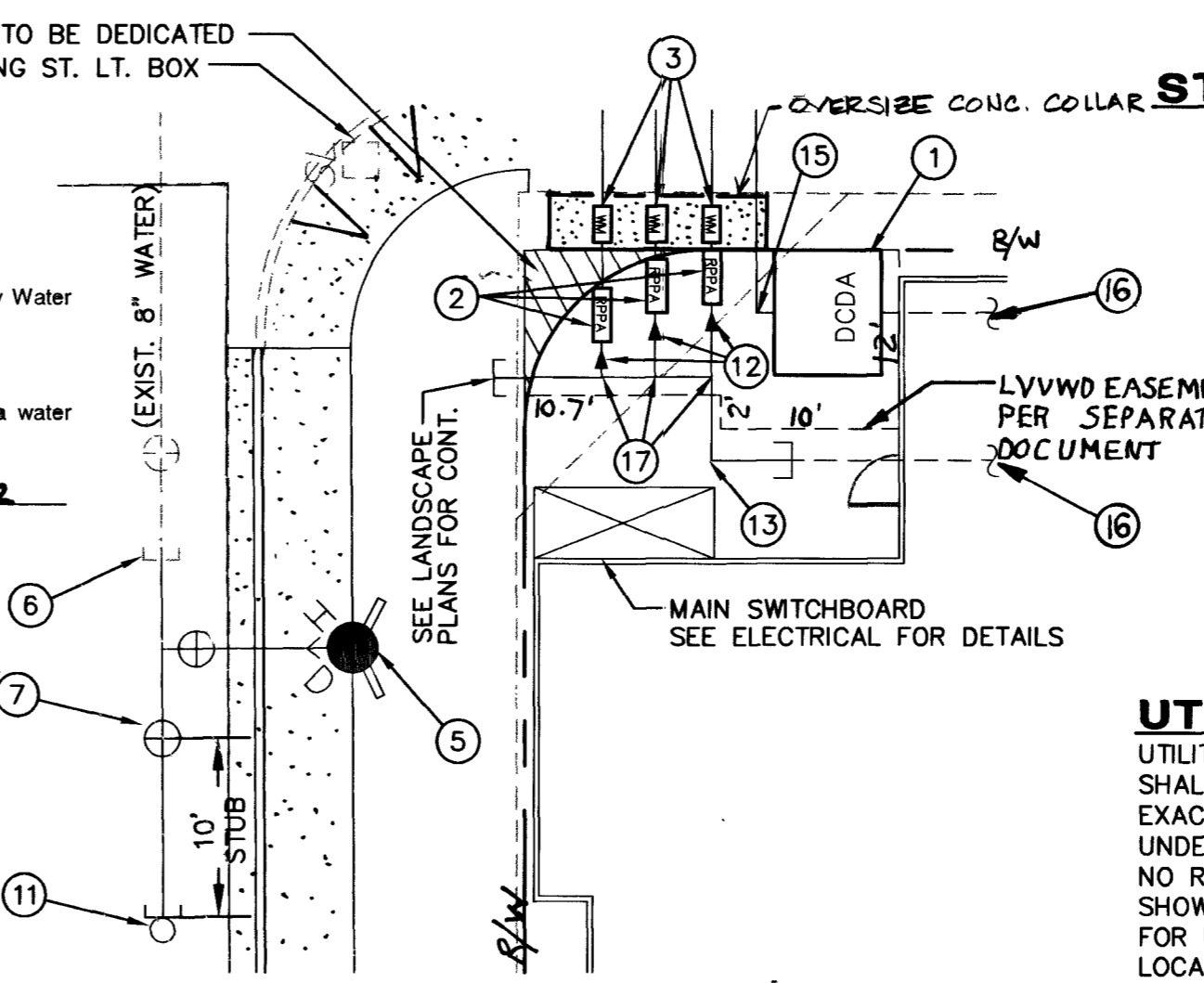

BASIS OF BEARINGS

BASIS OF BEARINGS: BEING THE CENTER LINE OF CARSON AVENUE BETWEEN EIGHTH AND NINTH STREETS, AS SHOWN ON RECORD OF SURVEY IN FILE 67, PAGE 79, SHEET 5, OFFICIAL RECORDS, CLARK COUNTY, NEVADA, WHICH BEARS: SOUTH 62°04'42" EAST.

BENCHMARK

RIVET AND PLATE IN TOP OF CURB 9 FEET EAST OF PT AT FREMONT STREET AND 7TH STREET.
 NAVD88 ELEVATION = 610.3011 METERS; 2002.30 FEET.

UTILITY NOTE

UTILITY LOCATIONS SHOWN HEREON ARE APPROXIMATE ONLY. IT SHALL BE THE CONTRACTORS RESPONSIBILITY TO DETERMINE THE EXACT VERTICAL AND HORIZONTAL LOCATION OF ALL EXISTING UNDERGROUND UTILITIES PRIOR TO COMMENCING CONSTRUCTION. NO REPRESENTATION IS MADE THAT ALL EXISTING UTILITIES ARE SHOWN HEREON. THE ENGINEER ASSUMES NO RESPONSIBILITY FOR UTILITIES NOT SHOWN OR UTILITIES NOT SHOWN IN THEIR PROPER LOCATION, HEREON.

APPROVED FOR CONSTRUCTION
 [Signature]
 LAS VEGAS VALLEY WATER DISTRICT
 DATE: 4.18.02

MANHOLE NUMBER	RIM	INV IN	INV OUT
EX-SSMH #1	(97.48)	(91.78)	(91.78)
EX-SSMH #2	(96.60)	(90.78)	(90.68)
EX-SSMH #3	(96.78)	(90.45)	(90.25)
EX-SSMH #4	(96.77)	(88.87)	(87.82)
EX-SSMH #5	(96.86)	(91.01)	(90.81)
EX-SSMH #6	(96.76)	(84.71)	(84.51)
EX-SSMH #7	(98.90)	(90.20)	(90.00)
SSMH #1	97.12±	86.42 (10")	85.50

NOTE: PLEASE SEE SHEET C4 FOR INFORMATION REGARDING ABANDONING EXISTING SERVICES.

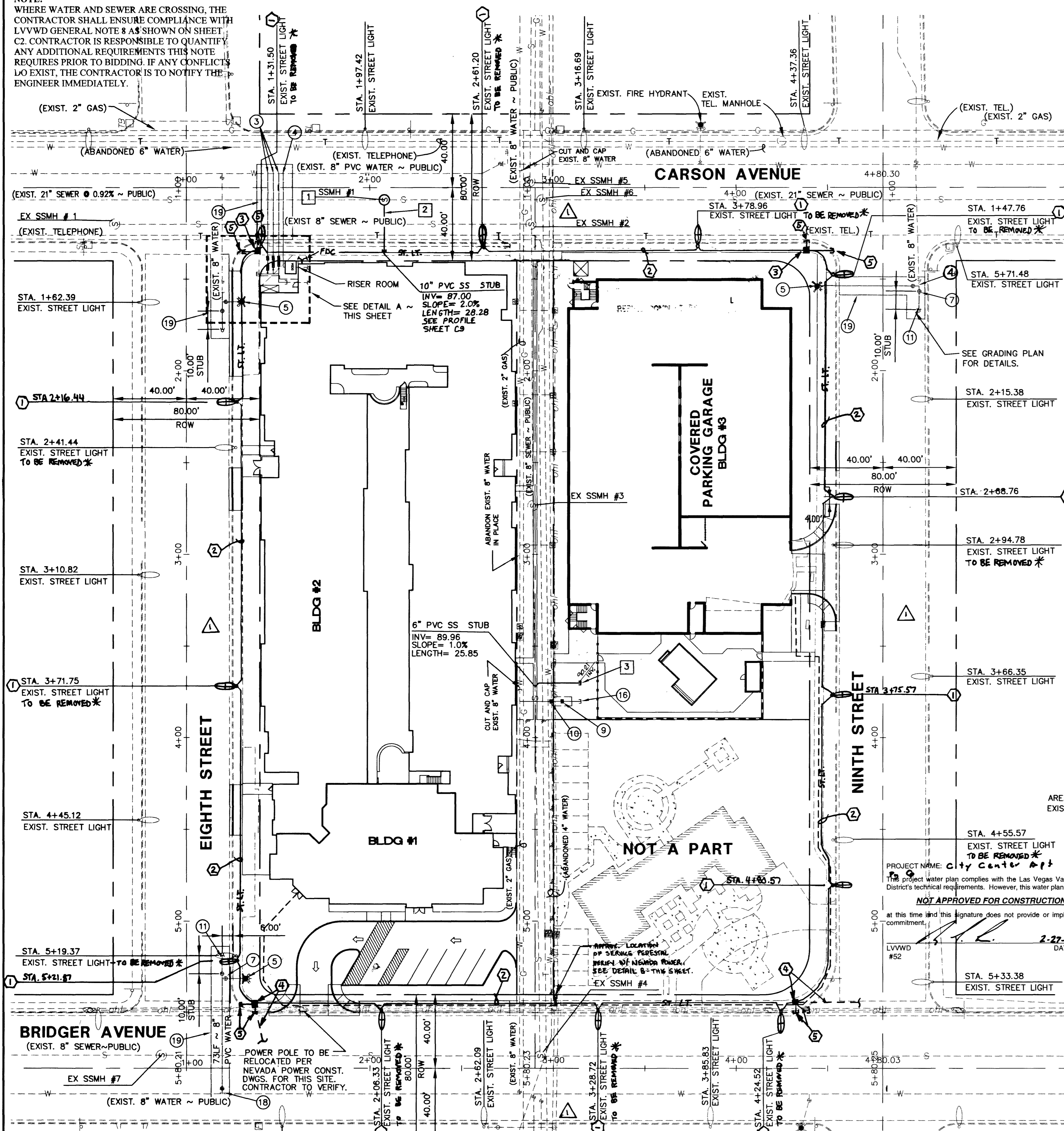

NOTE *
 REMOVE AND RETURN STREET LIGHT POLES TO CITY OF LAS VEGAS YARDS @ 3104 E. BONANZA ROAD. CALL 24 HOURS BEFORE RETURNING @ 225-6931.

NUMBER OF UNITS = SEWER CONTRIBUTION RATE
 300
 AVG. DAILY FLOW PER UNIT = 175 (GPD) 0.000175 (MGD)
 TOTAL AVG. DAILY FLOW = 52500.0 (GPD) 0.0525 (MGD)
 PEAK FACTOR = 3.4
 TOTAL PEAK DAILY FLOW = 178500 (GPD) 0.1785 (MGD)

ST. LT. CONSTRUCTION NOTES

1. INSTALL 2500V HPS ST. LT. PER DETAILS ON SHEET C9 OF C9.
2. INSTALL 2" ST. LT. CONDUIT UNDER SIDEWALK.
3. INSTALL #3/2 PULL BOX.
4. INTERCEPT EXIST. ST. LT. CIRCUIT. INSTALL #3/2 PULL BOX. REPAIR CONDUCTORS.
5. STUB AND CAP CONDUIT.

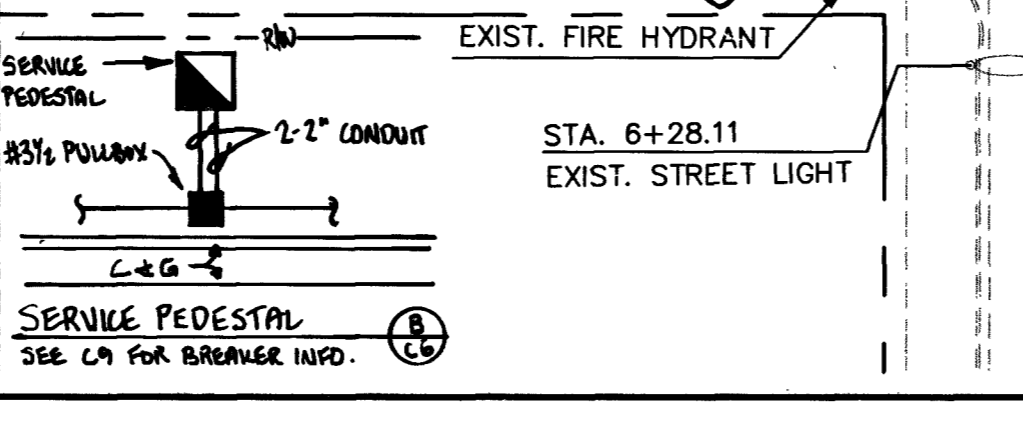

REVISION BY: [Blank]
 REV. DATE: [Blank]

SDA
 6555 DTC HWY. SITE B-2660
 ENGINEERED COLORADO 80M
 (303) 220-0500 EXT. 21

PROJECT: LAS VEGAS VALLEY WATER DISTRICT
 PROJECT NO.: 400074-A-001

DESIGNED BY: OF/JG
 CHECKED BY: JPM
 ANS.
 Scale: AS SHOWN
 AS SHOWN

DATE: 01/12/01

SHEET TITLE: UTILITY PLAN
 PROJECT: LAS VEGAS VALLEY WATER DISTRICT
 CITY CENTER APARTMENTS

Scale: AS SHOWN
 AS SHOWN

Professional Engineer Seal: [Seal of Neilson Stone & Associates, Inc., License No. 6749, State of Nevada]

SHEET C6
 C6 OF C9
 DRAWING NO. 107-V3566