

FOR CONTINUATION - SEE SHEET C5.01

GRAPHIC SCALE

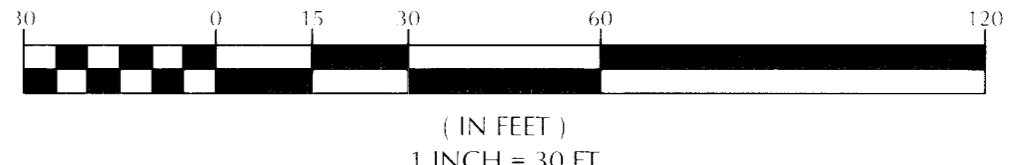

BASIS OF BEARING
NORTH 89°42'50" EAST BEING THE NORTH LINE OF THE NORTHWEST QUARTER OF SECTION 29, TOWNSHIP 19 SOUTH, RANGE 60, EAST, M.D.M., CITY OF LAS VEGAS, CLARK COUNTY, NEVADA, AS SHOWN, BY MAP THEREOF ON FILE 79 PAGE 08 OF PARCEL MAPS IN THE CLARK COUNTY RECORDER'S OFFICE, CLARK COUNTY, NEVADA.

BENCHMARK
CLV BENCHMARK 0LV90-29 NES-2002 RIVET AND PLAT IN CONCRETE PAD (BLOW-OFF) SOUTHWEST CORNER OF CENTENNIAL AND DURANGO. EL=2490.26 FEET, 759.0341 METERS (NAVD 88).

- WATER CONSTRUCTION NOTES
1. INSTALL 1 1/2" WATERLINE UDACS 3.18.12 POLYETHYLENE SCHEDULE 40 AND PER UDACS PLATE NO. 6A & 6B FOR (PRIVATE), AND INSTALL 1 1/2" WATERLINE UDACS 3.18.13 COPPER TUBING TYPE K AND PER UDACS PLATE NO. 6A & 6B (PUBLIC).

- SEWER CONSTRUCTION NOTES
1. INSTALL CLEAN OUT PER UPC SECTION 707 (CLEAN OUT SIZE SAME AS LINE SIZE) WHERE CLEANOUT OCCURS IN PAVEMENT INSTALL A TRAFFIC BEARING LID

FIRE FLOW CALCULATIONS

Table with columns for FUTURE, EXISTING, and PROPOSED. Rows include: SQUARE FOOTAGE (TOTAL) 43,728; LARGEST AREA BETWEEN 4-HOUR AREA SEPARATION WALLS; BUILDING HEIGHT; NUMBER OF STORIES; TYPE OF CONSTRUCTION; OCCUPANCY; FULL AUTOMATIC FIRE SPRINKLER SYSTEM; REVIEW BY; DATE.

NOTE: CALL SOUTHWEST GAS AT 365-2296 FOR STANDBY WHEN EXCAVATING OVER OR NEAR HIGH PRESSURE GAS LINES.
NOTE: ON-SITE WATER LINES AND APPURTENANCES ARE PRIVATE FACILITIES NOT TO OPERATED OR MAINTAINED BY THE CITY OF LAS VEGAS.

SANITARY SEWER ESTIMATED FLOW RATES
DAILY AVERAGE PEAK FLOW: 7,800 GPD / 19,500 GPD

SEE BLOW UP DETAIL "A", THIS SHEET FOR DCDA, RPPA, AND METER LOCATION.

LEGEND

Legend table defining symbols for FUTURE, EXISTING, and PROPOSED lines for WATER LINE, SANITARY SEWER LINE, GAS LINE, STORM DRAIN, POWER LINE/POLE, TELEPHONE LINE, FIRE HYDRANT, FIRE DEPARTMENT CONNECTION, WATER VALVE, GAS VALVE, METERS/PULL BOXES, REDUCER, MANHOLE, CLEANOUT, SEWER MANHOLE, STORM MANHOLE, UTILITY POLE, DRAIN INLET, AREA LIGHT, SAWCUT LINE, GRADE BREAK, LANDSCAPING, SITE VISIBILITY.

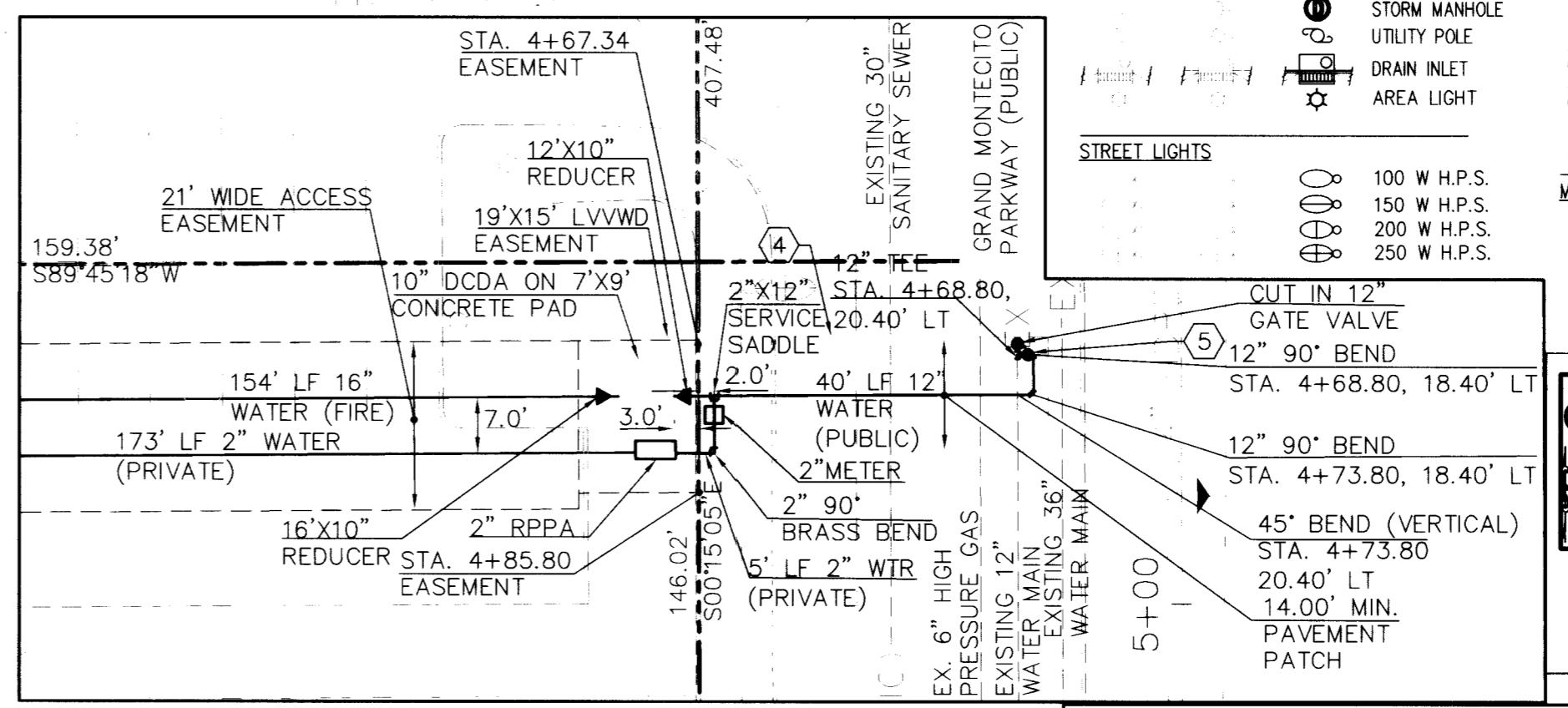

PROPOSED DCDA, RPPA, & METER LOCATION BLOW UP DETAIL "A" SCALE: 1" = 20'

REDUCED PRESSURE PRINCIPLE ASSEMBLY (1) 2" & (1) 1 1/2" RPPA
APPROVED REDUCED PRESSURE PRINCIPLE ASSEMBLY(S) SHALL BE INSTALLED PER THE UDACS PLATE NO. 11A. NO WATER SHALL BE TAKEN FROM A SERVICE REQUIRING BACKFLOW PREVENTION UNTIL THE REDUCED PRESSURE PRINCIPLE ASSEMBLY HAS BEEN SUCCESSFULLY TESTED BY THE LVVWD.

ALL SEWER/STORM DRAINS CROSSING WATER LINES MUST CONFORM TO SECTION 2.19 OF THE UNIFORM DESIGN AND CONSTRUCTION STANDARDS FOR POTABLE WATER SYSTEMS (UDACS) FOR WATER AND STORM MAIN CROSSINGS AND CLEARANCES.
DOUBLE CHECK DETECTOR ASSEMBLY (DCDA) (1) 10" DCDA
THE DOUBLE CHECK DETECTOR ASSEMBLIES SHALL BE INSTALLED IN ACCORDANCE WITH THE UDACS PLATE NO. 11C. ANY BLOCK WALL OR OTHER FENCE MATERIAL SHALL BE DESIGNED AND CONSTRUCTED AROUND THE OUTSIDE OF THE EASEMENT(S) SO AS TO ALLOW THE DISTRICT DIRECT ACCESS FROM THE ADJACENT RIGHT-OF-WAY. EASEMENTS SHALL BE CLEARLY MARKED OR STAKED PRIOR TO THE START OF CONSTRUCTION.

NOTE (UTILITIES)
AS OF THE SUBMITTAL DATE ON THESE WATER AND/OR SEWER IMPROVEMENT PLANS, THE DOWNSTREAM CONNECTION POINT AS SHOWN ON THESE DRAWINGS HAS NOT BEEN CONSTRUCTED BY "OTHERS" AND/OR THE WATER/SEWER CONSTRUCTION BY "OTHERS" HAS NOT BEEN ACCEPTED BY THE CITY. FOR THIS PROJECT, THE DEVELOPER HAS CHOSEN TO DEPEND ON THE WORK BY "OTHERS" AT SOLE RISK. THE DEVELOPER MAY CONSTRUCT THEIR UTILITIES AS SHOWN ON THESE APPROVED PLANS PRIOR TO THE COMPLETION OF WORK BY "OTHERS", BUT OCCUPANCY PERMIT RELEASE WILL NOT BE GIVEN BY THE CITY UNTIL THE UTILITY BY "OTHERS" HAS BEEN CONSTRUCTED AND ACCEPTED BY THE CITY. IF THE WORK BY "OTHERS" IS ABANDONED OR NOT COMPLETED FOR ANY REASON, THIS PROJECT SHALL BE RESPONSIBLE FOR ANY OR ALL OF THE FOLLOWING: (1) PROVIDING RESUBMITTED AND APPROVED MAIN LINE EXTENSION DESIGN PLANS; (2) THE CONSTRUCTION OF ADDITIONAL MAIN LINE UTILITIES TO CONNECT TO AND EXISTING ACCEPTED PUBLIC UTILITY HAVING CAPACITY TO SERVE THIS PROJECT; (3) PROVIDING RIGHT-OF-WAY OR EASEMENTS AS NEEDED.

WATER CROSSING NOTE
WHEN PROTECTION OF THE WATERLINE IS CONSIDERED, THE MINIMUM VERTICAL DISTANCE OF EIGHTEEN INCHES (18") MUST BE MAINTAINED WHEN THE WATER LINE IS INSTALLED OVER THE SEWER/STORM LINE. IF THIS DISTANCE CANNOT BE MAINTAINED BECAUSE OF PHYSICAL OBSTRUCTIONS OR THE WATER LINE MUST BE PLACED UNDER THE STORM/SEWER LINE, THE STORM/SEWER LINE MUST BE CONSTRUCTED WITH ANY OF THE FOLLOWING:
A. EXTRA HEAVY CAST IRON OR DUCTILE IRON PIPE
B. WATER SUPPLY QUALITY
C. ENCASEMENT WITH 4 INCHES MINIMUM OF CONCRETE OR SLEEVING WITH WATER QUALITY PIPE.
EACH OF THESE PROVISIONS MUST BE EXTENDED FOR TEN FEET (10') ON BOTH SIDES OF THE WATER LINE AT 90 DEGREES TO THE CROSSING.

APPROVED FOR CONSTRUCTION
LAS VEGAS VALLEY WATER DISTRICT PROJECT #113541 DATE

Call before you dig logo with phone numbers: 1-800-227-2600, 1-702-227-2929

MARTIN & MARTIN ASSUMES NO RESPONSIBILITY FOR EXISTING UTILITY LOCATIONS AND ELEVATIONS. THE UTILITIES SHOWN ON THIS DRAWING HAVE BEEN PLOTTED FROM THE BEST AVAILABLE INFORMATION. IT IS, HOWEVER, THE CONTRACTOR'S RESPONSIBILITY TO FIELD VERIFY THE LOCATION AND ELEVATION OF ALL UTILITIES PRIOR TO THE COMMENCEMENT OF ANY CONSTRUCTION. CONTRACTOR TO FIELD VERIFY ALL EXISTING SITE CONDITIONS PRIOR TO CONSTRUCTION. IF A CONFLICT EXISTS BETWEEN WHAT IS SHOWN ON THESE DRAWINGS AND WHAT EXISTS IN THE FIELD, THE CONTRACTOR IS TO NOTIFY THE ARCHITECT OR ENGINEER IMMEDIATELY.

Table with columns: NO., DESCRIPTION OF REVISIONS, DATE, INITIALS. Includes revisions for WATERLINE AND NOTE #1, ARCHITECT REQUESTED REV., and ARCHITECT REQUESTED REV.

JIM MARSH
8555 W. CENTENNIAL PARKWAY
LAS VEGAS, NEVADA 89149
(702) 990-3532 FAX (702) 990-3531
MARTIN & MARTIN
CIVIL ENGINEERS
SUITE 120
LAS VEGAS, NV 89101
PHONE (702) 248-8000
FAX (702) 248-8070

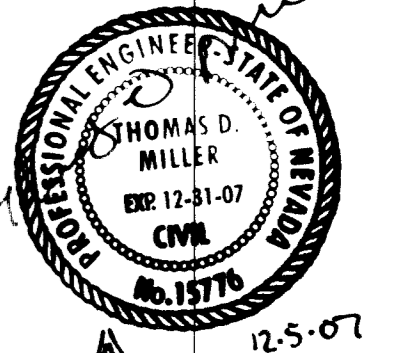

UTILITY PLAN
JIM MARSH CHRYSLER JEEP
AUTO BODY SHOP

DATE: 10/24/06
JOB NUMBER: 2130.00
DESIGN BY: J. PATCHETT, E.I.
DRAWN BY: R. MOORE
CHECKED BY: T. MILLER, P.E.

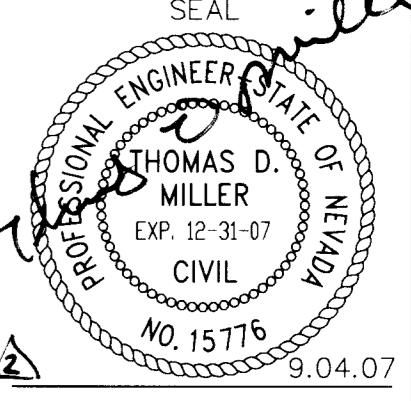

C5.02
107V 3292-AB
SHEET 15 OF 24