

NOTE: POSITIVE DRAINAGE AWAY FROM THE STRUCTURES SHOULD BE PROVIDED DURING CONSTRUCTION AND MAINTAINED THROUGHOUT THE LIFE OF THE STRUCTURES. ANY DOWNSPOUTS, ROOF DRAINS OR SCUPPERS SHOULD DISCHARGE INTO SPLASH BLOCKS OR EXTENSIONS AND AWAY FROM THE STRUCTURES. BACKFILL AGAINST FOOTINGS, EXTERIOR WALLS AND IN UTILITY TRENCHES SHOULD BE PROPERLY COMPACTED AND FREE OF ALL CONSTRUCTION DEBRIS TO REDUCE THE POSSIBILITY OF MOISTURE INFILTRATION.

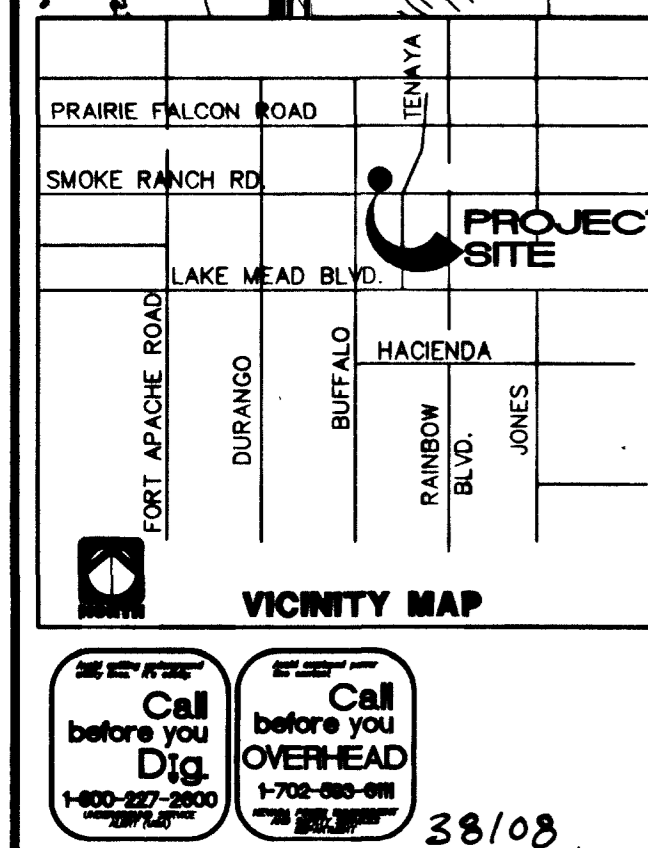
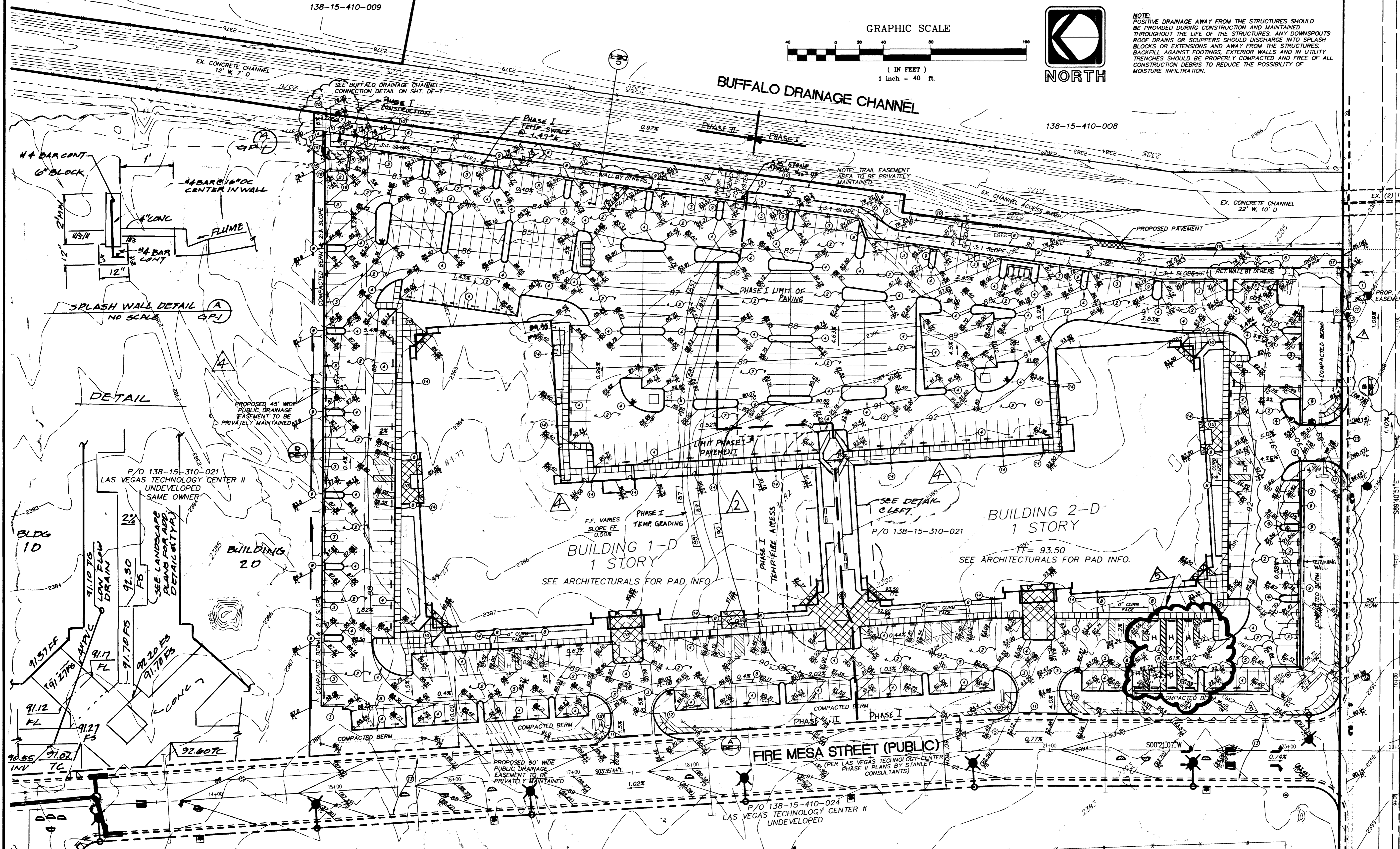
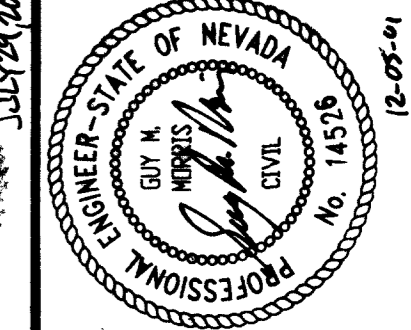
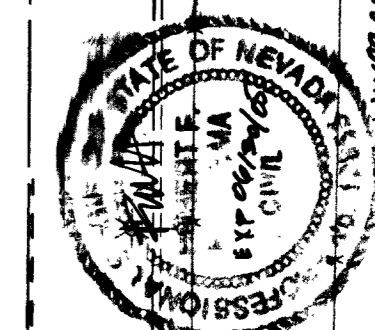

LEGEND table with columns for EXISTING and PROPOSED, listing symbols for property lines, curbs, storm drains, contours, sidewalks, and street signs.

SOILS REPORT: ALL CONSTRUCTION SHALL CONFORM WITH THE SOILS REPORT PREPARED BY CONVERSE CONSULTANTS. DATE: OCTOBER 30, 00; CONVERSE PROJECT NO. 98-33343-02.

BENCHMARK: CITY OF LAS VEGAS BENCHMARK NO. 0LVD0 1554- RIVET AND PLATE IN TOP OF CURB, NE RETURN OF SMOKE RANCH ROAD AND TENAYA WAY. NAVD, 1988. ELEVATION: 721.3739M (2366.7075 US FT.).

BASIS OF BEARING: SOUTH 08° 00' 03" WEST, BEING THE CENTERLINE OF CRIMSON CANYON DRIVE AS SHOWN BY THE RECORD OF SURVEY RECORDED IN FILE 79, PAGE 58 IN THE OFFICE OF THE CLARK COUNTY, NV RECORDER.

LEGAL DESCRIPTION: LOCATED WITHIN THE SOUTHWEST QUARTER OF SECTION 15, TOWNSHIP 20 SOUTH, RANGE 60 EAST, M.D.M., CITY OF LAS VEGAS, CLARK COUNTY, NV, BEING A PORTION OF LOT 1 OF BLOCK 5 OF THE LAS VEGAS TECHNOLOGY CENTER, RECORDED IN BOOK 47, PAGE 35 OF PLATS IN THE CLARK COUNTY, NEVADA RECORDER'S OFFICE.

CONSTRUCTION KEY table with columns for ITEM, QNTY (PRVT), and QNTY (PUBL). Lists items like curb and gutter, sidewalk, and ramp.

DISCLAIMER NOTE: UTILITY LOCATIONS SHOWN HEREON ARE APPROXIMATE ONLY. IT SHALL BE THE CONTRACTOR'S RESPONSIBILITY TO DETERMINE THE EXACT HORIZONTAL AND VERTICAL LOCATION OF ALL EXISTING UNDERGROUND AND OVERHEAD UTILITIES PRIOR TO COMMENCING CONSTRUCTION.

RAMP TABLE with columns for GRADE (%), MIN. (FT), and MAX. (FT). Lists ramp grades and their corresponding minimum and maximum lengths.



THOMAS & MACK DEVELOPMENT GROUP logo and project information.

Revision table with columns for NO., DATE, and DESCRIPTION. Lists revisions to the plan.

TKC The Keith Companies logo and address: 444 East Warm Springs Road, Suite 100, Las Vegas, Nevada 89119.

THOMAS AND MACK DEVELOPMENT GROUP LAS VEGAS TECHNOLOGY CENTER II BUILDINGS 1-D and 2-D GRADING PLAN

JOB # 51581.00 SHEET NO.: GP-1 4 OF 7 SHEETS 107-V3116-3