

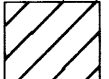

HATCH LEGEND

-  LIMITS OF CURB AND GUTTER REMOVAL
-  LIMITS OF NEW AC PAVEMENT CONSTRUCTION
-  LIMITS OF CURB AND GUTTER CONSTRUCTION
-  LIMITS OF TEMPORARY 2' AC OVERPAVE

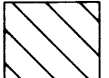
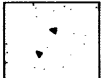

CURVE TABLE

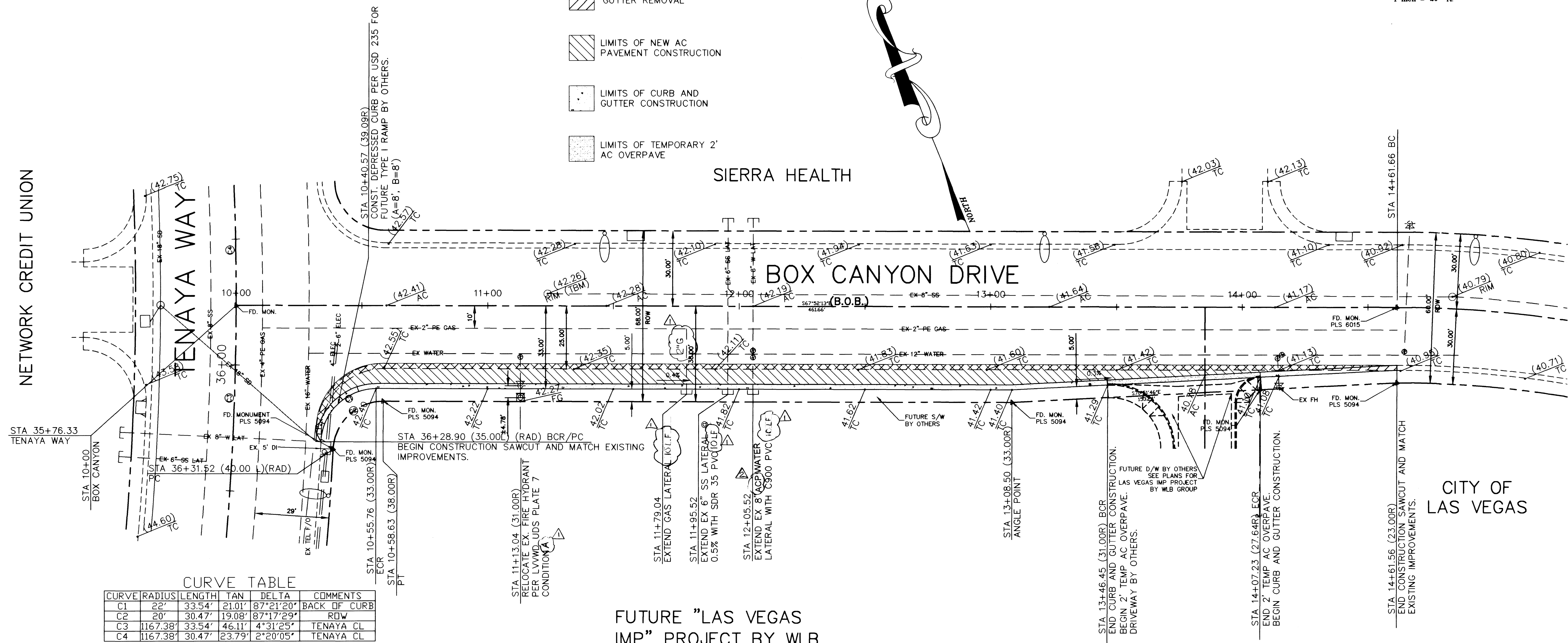
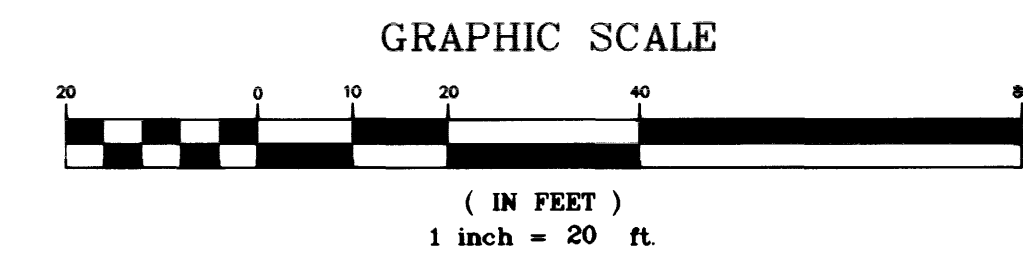
CURVE	RADIUS	LENGTH	TAN	DELTA	COMMENTS
C1	22'	33.54'	21.01'	87°21'20"	BACK OF CURB
C2	20'	30.47'	19.08'	87°17'29"	ROW
C3	1167.38'	33.54'	46.11'	4°31'25"	TENAYA CL
C4	1167.38'	30.47'	23.79'	2°20'05"	TENAYA CL

FUTURE "LAS VEGAS IMP" PROJECT BY WLB GROUP, INC.

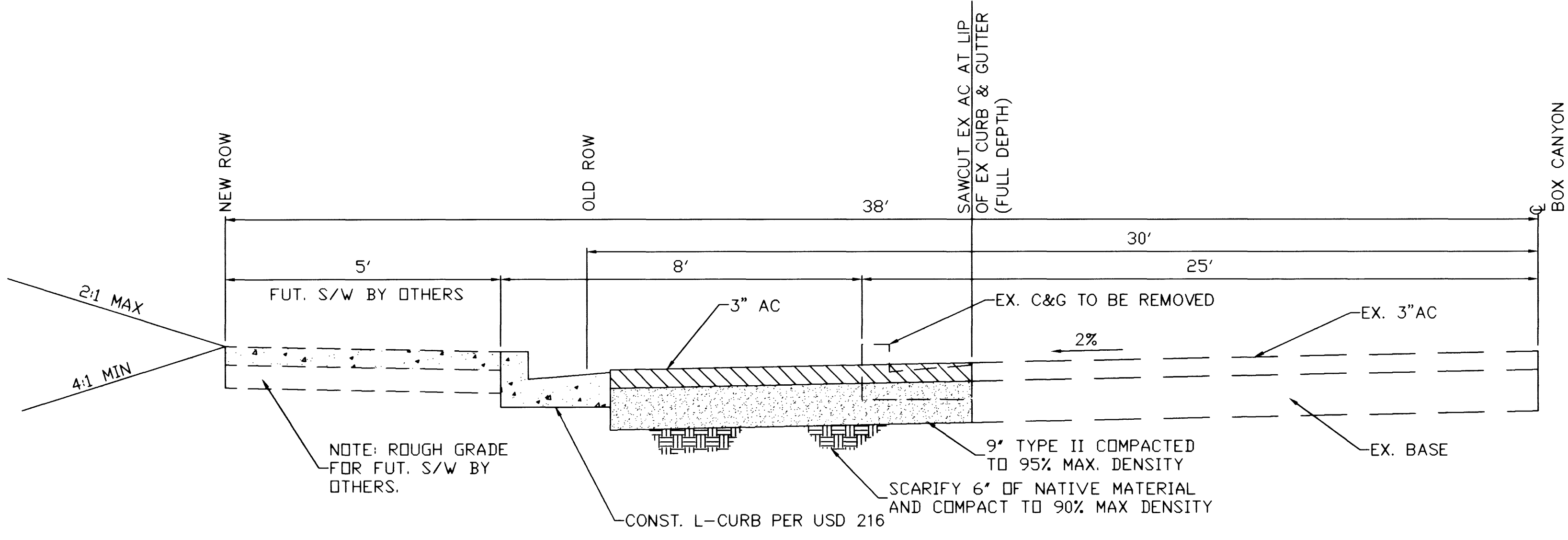

PAVEMENT SECTION DETAIL

RELOCATION OF FIRE HYDRANTS
(Extension of Existing Lateral)
The Contractor shall remove and relocate both the upper and lower barrels of the existing fire hydrant(s) where shown, extend the existing lateral as required, and reinstall such hydrant(s) at the new location(s) indicated. Relocations where the lateral cannot be extended shall be treated as new installations.

TOPO SURVEY PROVIDED BY THE WLB GROUP, INC. FOR LAS VEGAS IMP PROJECT DATED 4-21-98

APPROVED BY
Armin C. Pitt
LAS VEGAS VALLEY WATER DISTRICT
DATE: 2-24-99

Avoid cutting underground utility lines. It's costly.
Call before you Dig.
1-800-227-2600

CITY OF LAS VEGAS DEPARTMENT OF PUBLIC WORKS
BOX CANYON DRIVE EXPANSION
LAS VEGAS TECH. CENTER IMPROVEMENTS

ENGINEERING DESIGN SECTION
CITY ENGINEER: DENNIS ANDERSON, P.E.
PROJECT MANAGER: ED NETTENSTROM, P.E.

DESIGNED BY: [Signature]
CHECKED BY: [Signature]
PROJECT NO.: W-300X
SCALE: 1/4" = 1'-0"

3 OF 4 SHEETS
DRAWING NO. 107-V3011

L:\DEPT\DESIGN\LAS VEGAS TECHNOLOGY CENTER\BOX CANYON\SHEET03-CURRENT.dwg Thu Dec 17 15:44:20 1998 NST:URD