

Call before you Dig
Avoid cutting underground utility lines. It's costly.

811
OR
1-800-227-2600

Avoid overhead power line contact. It's costly.

Call before you Overhead
1-702-227-2929

FAST
Call before you Underground
1-702-432-5300

BASIS OF BEARING
NORTH 89°07'00" WEST, BEING THE BEARING OF THE SOUTH LINE OF THE SOUTHWEST QUARTER (SW 1/4) OF THE SOUTHWEST QUARTER (SW 1/4) OF SECTION 18, TOWNSHIP 19 SOUTH, RANGE 60 EAST, M.D.M., CITY OF LAS VEGAS, CLARK COUNTY, NEVADA, AS SHOWN ON THAT CERTAIN MAP ON FILE IN THE CLARK COUNTY RECORDER'S OFFICE IN BOOK 146, PAGE 17 OF PLATS.

BENCHMARK
CITY OF LAS VEGAS BENCHMARK STATION: 6LV90 18SW66
RIVET & PLATE ON TOP OF CURB AT THE NORTHEAST CORNER OF SEVERENCE LANE AND HUALAPAI WAY.
ELEVATION=870.872 Meters (NAV'D'88)
ELEVATION=2857.19 U.S. Survey Feet (NAV'D'88)

REDUCED PRESSURE PRINCIPLE ASSEMBLY (1) †
APPROVED REDUCED PRESSURE PRINCIPLE ASSEMBLY(S) SHALL BE INSTALLED PER THE UDACS PLATE NO. 8. NO WATER SHALL BE TAKEN FROM A SERVICE REQUIRING BACKFLOW PREVENTION UNTIL THE REDUCED PRESSURE PRINCIPLE ASSEMBLY HAS BEEN SUCCESSFULLY TESTED BY THE LVWMD. ANY BLOCK WALL OR OTHER FENCE MATERIAL SHALL BE DESIGNED AND CONSTRUCTED AROUND THE OUTSIDE OF THE EASEMENT(S) TO ALLOW THE DISTRICT DIRECT ACCESS FROM THE ADJACENT RIGHT-OF-WAY. EASEMENTS SHALL BE CLEARLY MARKED OR STAKED PRIOR TO THE START OF CONSTRUCTION.

UTILITY LEGEND

EX. GAS	EXISTING GAS
EX. 10" S	EXISTING SEWER MAIN
8" S	PROPOSED SEWER MAIN
EX. 36" SD	EXISTING STORM DRAIN
36" SD	PROPOSED STORM DRAIN
EX. 8" W	EXISTING WATER MAIN
8" W	PROPOSED WATER MAIN
	PROPOSED WATER LATERAL WITH 5/8" METER
	EXISTING UTILITY MANHOLE
	PROPOSED UTILITY MANHOLE
	EXISTING VALVE
	PROPOSED VALVE
	PROPOSED REDUCER
	PROPOSED STANDARD FIRE HYDRANT WITH 6" LATERAL, 6" GATE VALVE AND TEE
	BACK WATER VALVE
	PRESSURE REDUCING VALVE
	EXISTING STREET LIGHT
	FUTURE STREET LIGHT
	PROPOSED 100w HPS STREET LIGHT
	PROPOSED 150w HPS STREET LIGHT
	PROPOSED 200w HPS STREET LIGHT
	PROPOSED 250w HPS STREET LIGHT
	PROPOSED 400w HPS STREET LIGHT
	PROPOSED CONCRETE DRIVEWAY

WATER MAIN JOINT DEFLECTION (PVC, 4"-24")
PVC PIPE SHALL BE DEFLECTED AT THE JOINT ONLY. THE MAXIMUM ALLOWABLE DEFLECTION SHALL BE ONE (1) DEGREE PER JOINT WITH A MAXIMUM RADIUS OF CURVATURE OF 1,150 FEET, PER UDACS 2.07.01 AND 2.07.02. FOR CHANGES IN DIRECTION EXCEEDING THE MAXIMUM ALLOWABLE JOINT DEFLECTION, FITTINGS SHALL BE USED.

UTILITY CROSSING NOTE
ALL SEWER/STORM DRAINS CROSSING WATER LINES MUST CONFORM TO SECTION 2.22 OF THE UNIFORM DESIGN AND CONSTRUCTION STANDARDS OF POTABLE WATER SYSTEMS (UDACS) FOR WATER AND STORM MAIN CROSSINGS AND CLEARANCES.

FOR ALL DRY AND UTILITY CROSSINGS
MAINTAIN MINIMUM 12" VERTICAL SEPARATION AT ALL POINTS OF CROSSING.
MAINTAIN A MINIMUM 3' PARALLEL SEPARATION.
ANY EXCAVATION AT BACK OF CURB MUST REMAIN OPEN FOR INSPECTION OF COPPER SERVICE LATERALS. ANY COPPER SERVICE LATERAL KINKED, BENT OR OTHERWISE DAMAGED MUST BE REPLACED FROM THE MAIN TO THE ANGLE METER STOP.

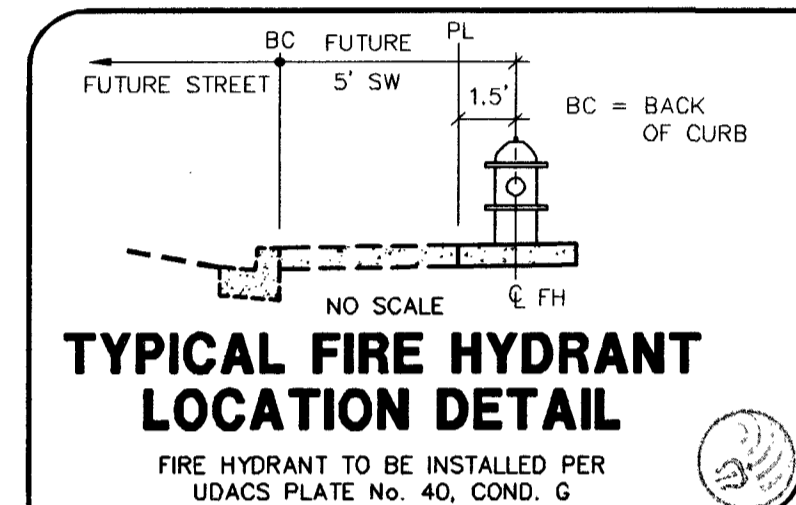
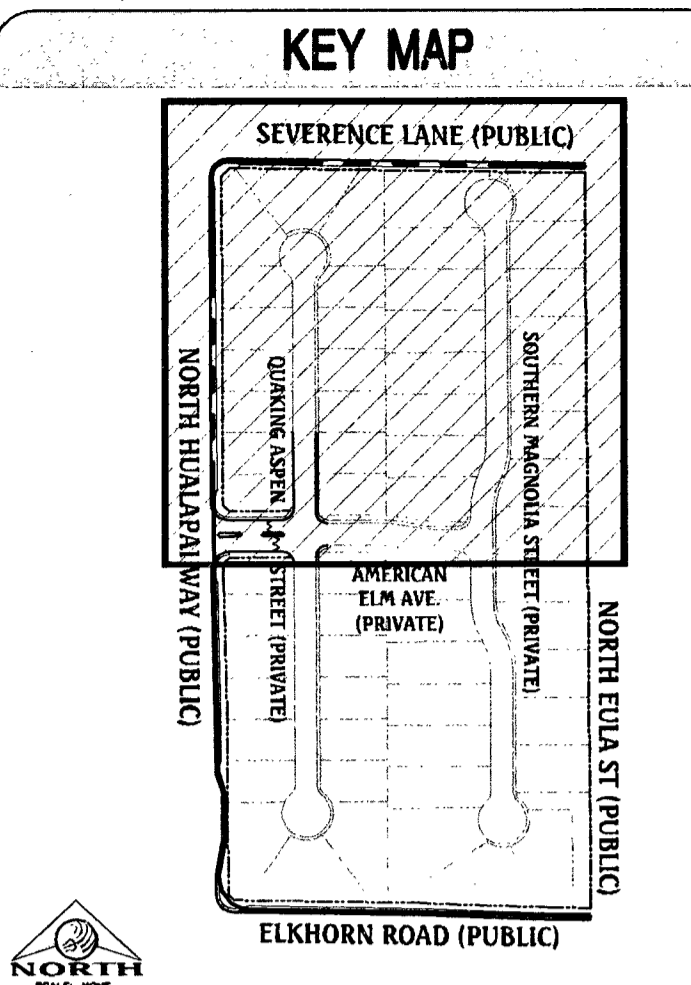
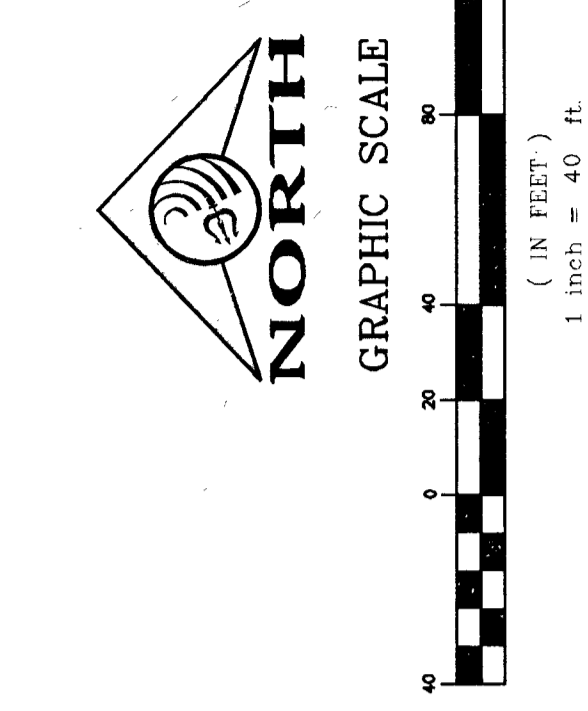

PRESSURE REDUCING VALVE
This property may have static water pressure in excess of 80 psi. The Uniform Plumbing Code requires that individual, on-site (private), pressure-reducing valves be installed whenever the pressure exceeds 80 psi. PRVs are the Developer's responsibility and will not be inspected or included in the acceptance of LVWMD facilities.
LOTS WITHIN 2975 ZONE WITH A FINISH FLOOR ELEVATION LESS THAN 2790.4 WILL REQUIRE A PRV
NO PRVs ARE REQUIRED

BACK WATER VALVE
BACKWATER VALVES REQUIRED PER U.P.C., LATEST EDITION, SECTION 710.0.
LOT 14 DOES NOT REQUIRE A BWV.
TOTAL LOTS REQUIRING BACKWATER VALVES = 0

UTILITY APPURTENANCES
ALL ABOVE GROUND UTILITY APPURTENANCES SHALL CONFORM TO THE REQUIREMENTS OF TITLE 19.06 AND 19.08.

- WATER & SEWER CONSTRUCTION NOTES**
- POC (2975 PZ) - INSTALL 12" 45' BEND PER UDACS PLATE NO. 31.
 - INSTALL 12" 90' BEND PER UDACS PLATE NO. 31.
 - INSTALL 8" CROSS PER UDACS PLATE NO. 31.
 - INSTALL 8" GATE VALVE PER UDACS PLATE NO. 30 AND 38.
 - INSTALL 2" BLOW OFF ASSEMBLY WITH CAP PER UDACS PLATE NO. 36.
 - INSTALL FIRE HYDRANT ASSEMBLY WITH 6" GATE VALVE AND 8" 6" TEE PER UDACS PLATE NO. 40.
 - INSTALL 1" COPPER WATER SERVICE W/ 3/4" METER PER UDACS PLATE NO. 4.
 - INSTALL 3/4" BRASS RIGORATION METER W/ 1" RPPA PER UDACS PLATE NO. 4 & B (BRASS BETWEEN METER & RPPA)
 - INSTALL 8" PVC WATER PIPE PER UDACS PLATE NO. 17.
 - POC - EX. 15" PVC SEWER - INSTALL 60" MANHOLE PER DCSWCS SD-1A, SD-18, SD-4 WITH PRECAST BASE. CORROSION PROTECTION PER DCSWCS 3.16.B.B
 - INSTALL 48" MANHOLE PER DCSWCS SD-1A, SD-18, SD-4 WITH PRECAST BASE, WITH SINGLE COVER
 - INSTALL STUB & CAP WITH 1 CURB-FT THRUST BLOCK
 - INSTALL 4" PVC SEWER LATERAL WITH MARKER BALL & CURB MARKING, PER DCSWCS SD-22 AND SD-25
 - INSTALL 8" PVC SEWER PIPE PER DCSWCS SD-16
 - EX. SEWER MANHOLE, PROTECT IN PLACE, ADJUST RIM PER DCSWCS SD-4 & SD-5 IF APPLICABLE.
 - EX. 6" BLOW OFF, PROTECT IN PLACE, ADJUST RIM PER UDACS PLATE NO. 37
 - EX. WATER GATE VALVE, PROTECT IN PLACE, ADJUST/REPLACE CONCRETE COLLAR PER UDACS PLATE NO. 39
 - EX. AIR VALVE ASSEMBLY, TO BE RELOCATED PER UDACS PLATE NO. 38
 - EX. STORM DRAIN CROSSING PER UDACS PLATE NO. 22 & 23
 - INSTALL 12"x8" REDUCER PER UDACS PLATE NO. 30.
 - INSTALL 12" 45' BEND PER UDACS PLATE NO. 31.
 - INSTALL 12" PVC WATER PIPE PER UDACS PLATE NO. 17
 - EX. WATER GATE VALVE WITHIN PROPOSED "L" CURB, SEE DETAIL E/5 FOR CURB MODIFICATION

FIRE FLOW CALCULATIONS

THE FIRE FLOW REQUIREMENT IS: 1,500 GALLONS PER MINUTE 20 PSI RESIDUAL PRESSURE.

BASED ON:	
SQUARE FOOTAGE:	3,450 SQUARE FEET
LARGEST AREA BETWEEN 4-HOUR AREA SEPARATION WALLS:	N/A SQUARE FEET
BUILDING HEIGHT:	29 FEET-3 INCHES
NUMBER OF STORIES:	2 FLOORS
TYPE OF CONSTRUCTION:	V-NON RATED
OCCUPANCY:	RESIDENTIAL
FULL AUTOMATIC FIRE SPRINKLER SYSTEM:	NO

FIRE DEPARTMENT APPROVAL
APPROVAL BY THE FIRE DEPARTMENT HAVING JURISDICTION IS REQUIRED PRIOR TO OBTAINING FINAL APPROVAL FROM THE LVWMD.

APPROVED FOR CONSTRUCTION
LAS VEGAS VALLEY WATER DISTRICT ENGINEERING SERVICES MANAGER
DATE: 01/06/16 PROJECT NO.: 124150
LVWMD APPROVED FIRE FLOW 1,500 GPM @ 20 PSI RESIDUAL

PROFESSIONAL ENGINEER - STATE OF NEVADA
KELLY J. WITTEWER
Exp. 8-30-16
CIVIL
No. 10625
5/11/16
FOR REVIEW ONLY

APPROVALS
LAS VEGAS FIRE AND RESCUE
123015
#61808

NO.	DESCRIPTION	DATE	APPROVAL
2	ADDING LEFT TURN LANE IN HUALAPAI WAY	5/12/16	J.M.

DATE: 12/21/2015
DRAWN BY: J. PEARCE
DESIGNED BY:
CHECKED BY: ADA
JOB NO.: 007026
SCALE: 1" = 40'

Triton Engineering
Office: (702) 254-1480
www.tritoneng.com
6752 W. Charleston Blvd., Suite B, Las Vegas, Nevada 89146

DR HORTON
HUALAPAI / SEVERENCE
UTILITY PLAN 1

PROFESSIONAL ENGINEER - STATE OF NEVADA
JAMES M. PEARCE
Exp. 12-31-15
CIVIL
No. 9552
12-30-15

SHEET 16 OF 20
C.L.V. DWG.# 107V6546
HTE #15-64198