

- ### CONSTRUCTION NOTES
- CONSTRUCT 7" AC PAVEMENT WITH 4" TYPE II AGGREGATE BASE
 - CONSTRUCT 4" AC PAVEMENT WITH 5" TYPE II AGGREGATE BASE
 - CONSTRUCT 6" AC PAVEMENT WITH 6" TYPE II AGGREGATE BASE
 - CONSTRUCT DEPRESSIONED CURB AND DRIVEWAY APRON PER CAUSD NO. 224
 - EXISTING RCB TO BE ABANDONED IN PLACE. BRICK & MORTAR PLUS ENDS PER DETAIL 16 ON SHEET D-2
 - CONSTRUCT 6" CROSS GUTTER PER CAUSD NO. 228
 - CONSTRUCT "I" TYPE CURB AND GUTTER PER CAUSD NO. 216
 - CONSTRUCT 4.0' WIDE SIDEWALK PER CAUSD NO. 234
 - CONSTRUCT 6' WIDE SIDEWALK PER CAUSD NO. 234
 - CONSTRUCT 10' WIDE SIDEWALK/MULTI USE TRAIL PER CAUSD NO. 234
 - CONSTRUCT MULTI-USE EQUESTRIAN TRAIL WITH 4" DECOMPOSED GRANITE OVER 2" TYPE II AGGREGATE BASE (PER SIK46293 CONDITION #16)
 - CONSTRUCT SIDEWALK RAMPS USING ARMOR TILE TRUNCATED DOMES OR EQUIVALENT PER CAUSD NO. 235, CASE 1
 - CONSTRUCT SIDEWALK RAMPS USING ARMOR TILE TRUNCATED DOMES OR EQUIVALENT PER CAUSD NO. 235, CASE 3
 - REMOVE ABANDONED WOOD UTILITY POLE TYP.
 - INSTALL REMOVABLE BOLLARDS SPACED 4.5' (MAX) O.C. PER DETAIL ON SHEET D-2
 - CONSTRUCT SIDEWALK DRAIN PER CAUSD NO. 236
 - RIP RAP D50-12" OVER M275 8 OZ. NON-WOVEN FILTER FABRIC OR APPROVED EQUIVALENT (THICKNESS PER PLAN OR SECTION)
 - CONSTRUCT DRIVEWAY ACCESS ROAD WITH 6" TYPE II AGGREGATE COMPACTED TO 95%
 - ADJUST EXISTING UTILITY STRUCTURE TO GRADE (SEE UTILITY PLAN FOR STRUCTURE IDENTIFICATION)
 - INSTALL 18" RCP SD (PUBLIC)
 - INSTALL 24" RCP SD (PUBLIC)
 - INSTALL 30" RCP SD (PUBLIC)
 - INSTALL 42" RCP SD (PUBLIC)
 - INSTALL 48" TYPE I SDMH PER CAUSD NO. 403
 - INSTALL 60" TYPE II SDMH PER CAUSD NO. 405
 - INSTALL 60" TYPE III SDMH PER CAUSD NO. 407
 - INSTALL 40" MODIFIED RCP END SECTION PER STRUCTURAL DESIGN BY OTHERS
 - INSTALL TYPE CM-2 DROP INLET PER CAUSD NO. 412.1 AND 421 (SIZE PER PLAN)
 - INSTALL 6" HIGH WROUGHT IRON FENCE WITH VEHICULAR ACCESS GATE PER DETAIL ON SHEET D-3
 - INSTALL 6" HIGH WROUGHT IRON FENCE
 - CONSTRUCT "A" TYPE ISLAND CURB AND GUTTER PER CAUSD NO. 219
 - ADJUST EXISTING STORM DRAIN MANHOLE RIM TO GRADE (SEE PROFILE FOR PROPOSED RIM ELEVATION)
 - CONCRETE AMENITY ZONE PER TOWN CENTER DESIGN DEVELOPMENT STANDARDS PD-007-05-2012RS SEE FIGURE 14
 - EXISTING POWER POLE TO REMAIN
 - INSTALL PORTABLE PRECAST BARRIER RAIL PER NDOT R-8.7.1 AND R-8.7.1.1 (SEE DETAIL ON SHEET D-3)
 - ADJUST EXISTING MANHOLE RIM/PULLBOX TO GRADE
 - REMOVE AND REPLACE EXISTING RR/PAV AS NECESSARY (MATCH EXISTING SIZE AND DEPTH)
 - REMOVE 21" OF EXISTING ABANDONED 18" RCP STORM DRAIN AND CAP ENDS (10.5' EITHER SIDE OF PROPOSED W.I.) FROM STA. 17+34.62 TO 17+55.62
 - INSTALL 18" RCP END SECTION PER NDOT R-2.3.1 (SEE DETAIL ON SHEET D-3)
 - PIPE PENETRATION INTO EXISTING RCB PER STRUCTURAL DESIGN BY OTHERS
 - SAWCUT AND MATCH EXISTING AC PAVEMENT PER CAUSD NO. 500.3
 - SAWCUT AND MATCH EXISTING AC PAVEMENT PER CAUSD NO. 500.5
 - CONSTRUCT RESIDENTIAL DRIVEWAY PER CAUSD NO. 222 AND 223
 - INSTALL DROP INLET WITH WATER-TIGHT JOINTS USING RUBBER GASKETS IN JOINTS
 - CONSTRUCT NDOT DROP INLET TYPE 3 PER NDOT PLAN R-4.2.3 SEE SHEET D-4 WITH 2.5' GRATES AND CURB OPENING

AVOID HITTING UNDERGROUND TRAFFIC SIGNAL SYSTEMS AND STREET LIGHT SYSTEMS. IT'S COSTLY.

Call before you do Underground
1-702-455-6000
CLARK COUNTY TRAFFIC OPERATIONS
1-702-432-5300
FREEMAN AND ARTERIAL SYSTEM OF TRANSPORTATION

AVOID HITTING OVERHEAD POWER LINES. IT'S COSTLY.

CALL BEFORE YOU DO OVERHEAD
1-702-227-2929

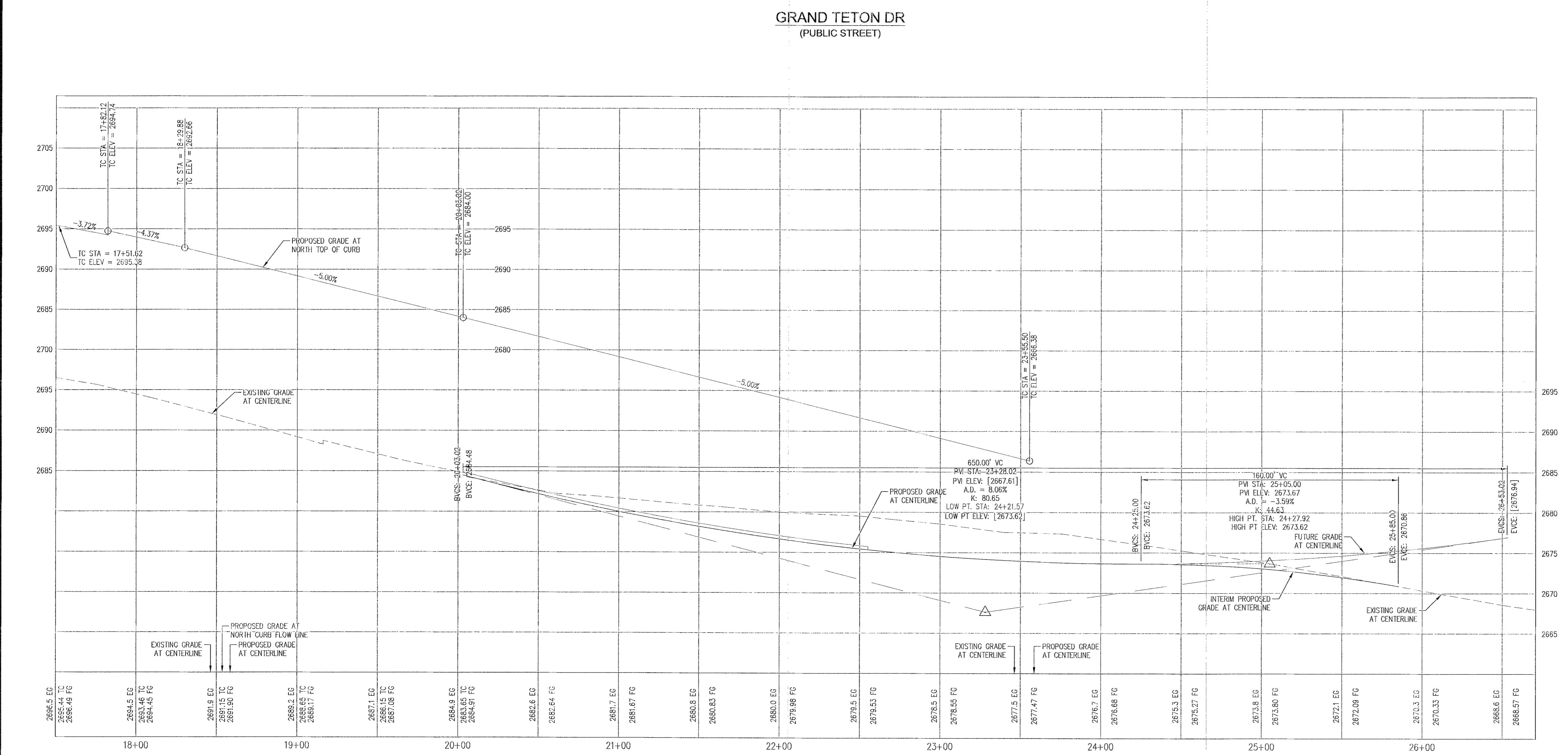

PROFILE
HOR. : 1"=40'
VERT. : 1"=8'

BENCHMARK
RIVET & PLATE ON NORTHEAST OF HEADWALL ON THE WEST SIDE OF BLANCA RD, 200' SSE OF FORT APACHE & RACEL, 7LW9085W6
NAVD 88 ELEV=814.651 METERS=2672.73 FEET

BASIS OF BEARING
NORTH 00°48'23" WEST, BEING THE BEARING OF THE WEST LINE OF THE NORTHWEST QUARTER (NW/4) OF THE SOUTHWEST QUARTER (SW/4) OF SECTION 7, TOWNSHIP 19 SOUTH, RANGE 60 EAST, M.D.M., CITY OF LAS VEGAS, CLARK COUNTY, NEVADA, AS SHOWN BY MAP THEREOF IN BOOK 122, PAGE 37 OF PLATS IN THE CLARK COUNTY RECORDER'S OFFICE, NEVADA.

Call before you Dig
Avoid hitting underground utility lines. It's costly.

Call 811

1-800-227-2600
CLARK COUNTY TRAFFIC OPERATIONS
1-702-455-6000

SLATER HANFAN GROUP
CONSULTING ENGINEERS & PLANNERS
5740 S. ARVILLE STREET #216, LAS VEGAS, NV 89118
PHONE (702) 284-5300 FAX (702) 284-5399

DR. HORION
GRAND TETON DR STA 17+50 TO 26+70
STREET PLAN AND PROFILE

CITY OF LAS VEGAS, NV

DATE: 07/18/13
DRAFTER: DSP
DESIGNER: DSP
CHECKED: DJP
PROJECT NO. DRH1213-000

PROFESSIONAL ENGINEER - STATE OF NEVADA
DARRIN J. HORION
No. 15815

P-2
SHEET 27 OF 47

H# 48A80
1074986