

MATCHLINE SEE SHEET UT1

UTILITY DISCLAIMER NOTE
 EXISTING UTILITY LOCATIONS SHOWN HEREIN ARE APPROXIMATE ONLY. IT SHALL BE THE CONTRACTOR'S RESPONSIBILITY TO DETERMINE THE EXACT VERTICAL AND HORIZONTAL LOCATION OF ALL EXISTING UNDERGROUND UTILITIES PRIOR TO COMMENCING CONSTRUCTION. NO REPRESENTATION IS MADE THAT ALL EXISTING UTILITIES ARE SHOWN HEREON. THE ENGINEER ASSUMES NO RESPONSIBILITY FOR UTILITIES NOT SHOWN OR UTILITIES NOT SHOWN IN THEIR PROPER LOCATIONS. CALL BEFORE YOU DIG: 1-800-227-2600
 CALL BEFORE YOU OVERHEAD: 1-702-227-2929

UTILITY NOTES

1. ALL WATER FACILITIES CONSTRUCTION SHALL BE IN ACCORDANCE WITH THE "UNIFORM DESIGN AND CONSTRUCTION STANDARDS FOR WATER DISTRIBUTION SYSTEMS" (UDACS), LATEST EDITION.
2. FIRE, WATER, AND SEWER SERVICES, AS APPROVED ON THIS PLAN, ARE INTENDED SPECIFICALLY FOR THE LOT AND USE SHOWN, AND ARE NOT INTENDED TO SERVICE ADDITIONAL PARCELS OR STRUCTURES WHICH MAY BE CREATED IN THE FUTURE. IN THE EVENT THAT THE PARCELS AND/OR LOTS SHOWN ON THIS PLAN ARE FURTHER DIVIDED TO CREATE ADDITIONAL PARCELS OR LOTS, THE OWNER IS REQUIRED TO PROVIDE SEPARATE FIRE, WATER, & SEWER SERVICES TO EACH.
3. WATER AND SEWER LATERALS SHALL BE INSTALLED A MINIMUM OF 48" APART IN SEPARATE TRENCHES. WATER LATERALS SHALL BE A MINIMUM OF 18" ABOVE THE SEWER LATERAL. (REF. UNIFORM PLUMBING CODE)
4. LOCATOR RIBBON SHALL BE USED FOR ALL SERVICE LATERALS NOT PERPENDICULAR TO THE MAIN. (TYPICAL)
5. ALL SEWER/STORM DRAINS CROSSING WATER LINES MUST CONFORM TO SECTION 2.22 OF "UNIFORM DESIGN AND CONSTRUCTION STANDARDS FOR WATER DISTRIBUTION SYSTEMS" (UDACS) FOR WATER AND STORM MAIN CROSSINGS AND CLEARANCES.
6. ALL WORK TO BE PERFORMED OUTSIDE OF THE PROJECT BOUNDARY AND ON PRIVATE PROPERTY SHALL NOT BE PERFORMED UNTIL WRITTEN PERMISSION AND EASEMENTS HAVE BEEN OBTAINED FROM THE OFFSITE OWNER AND GIVEN TO CLARK COUNTY.
7. ALL ONSITE STREETS AND DRAINAGE EASEMENTS ARE TO BE PRIVATELY OWNED AND MAINTAINED.
8. INSTALL PIPELINE MARKER BALLS IN TRENCH ABOVE EACH HORIZONTAL ELBOW FITTING. (UDACS PLT 15.)

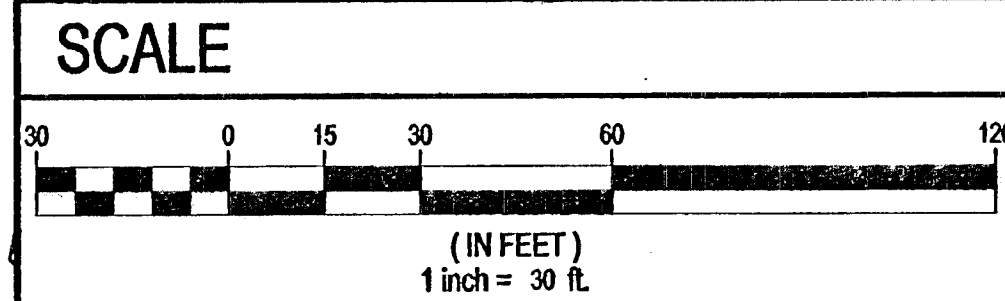

LEGAL DESCRIPTION
 THE WEST HALF (W1/2) OF THE SOUTHWEST QUARTER (SW1/4) OF THE SOUTHWEST QUARTER (SE1/4) OF THE NORTHWEST QUARTER (NW1/4) OF SECTION 14, TOWNSHIP 19 SOUTH, RANGE 60 EAST, M.D.B. & M. AND THE NORTH HALF (N 1/2) OF THE SOUTHWEST QUARTER (SE 1/4) OF THE SOUTHWEST QUARTER (SW 1/4) OF THE NORTHWEST QUARTER (NW 1/4) OF SECTION 14, TOWNSHIP 19 SOUTH, RANGE 60 EAST, M.D.B. & M., COUNTY OF CLARK, STATE OF NEVADA.

BASIS OF BEARINGS
 CLARK COUNTY BENCHMARK STATION 8LV90 14W6 719.03 METER (NAVD88) 2359.02 FEET CITY OF LAS VEGAS RIVET AND ROUND PLATE IN CONCRETE TELEPHONE PAD, 1/4 MILE EAST OF RAINBOW BLVD. ON NORTH SIDE OF FARM ROAD.

BENCHMARK
 S 89°28'06"E BEING THE CENTER LINE OF FARM ROAD AS SHOWN ON THE FINAL MAP OF BLUEGRASS HILLS ESTATES "A COMMON INTEREST COMMUNITY", RECORDED IN BOOK 119, PAGE 35, OFFICIAL RECORDS OF CLARK COUNTY, NEVADA. ALSO BEING THE SOUTH LINE OF THE NORTHWEST QUARTER (NW 1/4) OF SECTION 14, TOWNSHIP 19 SOUTH, RANGE 60 EAST, M.D.M., CLARK COUNTY, NEVADA.

APPROVAL BLOCK
 [Signature] 03/11/13 DATE
 LAS VEGAS VALLEY WATER DISTRICT ENGINEERING SERVICES MANAGER (PROJ# 117526) DATE APPROVAL OF THESE PLANS SHALL NOT BE CONSTRUED TO BE A PERMIT FOR, OR AN APPROVAL OF, ANY VIOLATION OF ANY OF THE PROVISIONS OF THE STATE OR COUNTY LAWS. FIRE FLOW = 1,750 G.P.M. AT 20 PSI RESIDUAL.

NO.	DESCRIPTION	REVISIONS	SHFTS.	APPR.	DATE

DR HORTON
 330 CAROUSEL PAVY
 HENDERSON, NV 89114
 (702) 636-3600 FAX: (800) 898-4681

TANEY ENGINEERING
 6003 S. JONES BLVD STEF 100
 LAS VEGAS, NV 89116
 (702) 366-8844 FAX: (702) 366-6533

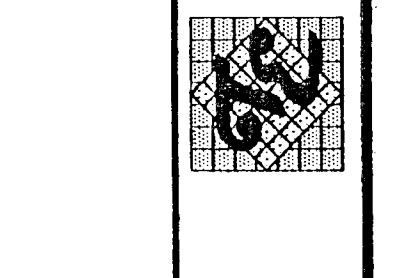

FARM & GAREHIME
 A RESIDENTIAL SUBDIVISION

UTILITY PLAN - EAST

DATE: 3/4/2013
SCALE: 1"=30'
JOB NO: DRH-12-031
DESIGNED BY: MC
CHECKED BY: RDC
SHEET NAME: UT2

SHEET: 12 OF 15
 301 V1061
 47830
 CC HTE# 12-49143

MATCHLINE SEE SHEET PP4 & PP5

Call Before You Dig
 1-702-227-2929

UnderGround
 1-702-455-7511
 1-702-229-6611

Call Before You Do Overhead
 1-800-227-2600

FILE NAME: 04.UT1.DWG

- CONSTRUCTION NOTES**
1. SAWCUT REMOVE AND REPLACE EXISTING AC PAVEMENT
 2. 8" X 8" WATERLINE TEE (UDACS PLT. 31)
 3. 1" WATER SERVICE W/ 1" METER (UDACS PLT. 4)
 4. 4" SEWER LATERAL PER CLV GENERAL NOTE #21 (UDACS SD-22) ALL SEWER LATERALS NEED TO BE WATER QUALITY
 5. FIRE HYDRANT ASSEMBLY W/ 6" GATE VALVE (UDACS PLT. 40) - PUBLIC
 6. 8" X 6" WATERLINE TEE (UDACS PLT. 31)
 7. 6" GATE VALVE (UDACS PLT. 30 & 39)
 8. 6" 11.25" WATERLINE BEND (UDACS PLT. 31)
 9. 6" 90° WATERLINE BEND (UDACS PLT. 31)
 10. INSTALL END CAP & 2" BLOW-OFF ASSEMBLY (UDACS PLT. 36)
 11. INSTALL 6" X 6" REDUCER (UDACS PLT. 30)
 12. INSTALL 24" X 8" TAPPING TEE SLEEVE W/ 6" TAPPING VALVE (UDACS 2.24.01 (B) PLT. 34 & 39)
 13. INSTALL SHALLOW MANHOLE (SD-13/GD1)
 14. INSTALL 24" X 6" TAPPING TEE SLEEVE W/ 6" TAPPING VALVE (UDACS 2.24.01 (B) PLT. 34 & 39)
 15. 6" 45° WATERLINE BEND (UDACS PLT. 31)

WATER MAIN JOINT DEFLECTION
 (PVC 4"-24")
 PVC PIPE SHALL BE DEFLECTED AT THE JOINT ONLY. THE MAXIMUM ALLOWABLE DEFLECTION SHALL BE ONE (1) DEGREE PER JOINT WITH A MAXIMUM RADIUS OF CURVATURE OF 1,150 FEET, PER UDACS 2.07.01 AND 2.07.02.
 FOR CHANGES IN DIRECTION EXCEEDING THE MAXIMUM ALLOWABLE JOINT DEFLECTION, FITTING SHALL BE USED.

FIRE FLOW CALCULATIONS
 FIRE FLOW REQUIREMENT IS 1,750 GALLONS PER MINUTE AT 20 POUNDS PER SQUARE INCH RESIDUAL.
 BASED ON:
 SQUARE FOOTAGE: 4200 SQ FT LARGEST AREA BETWEEN SEPARATE WALLS: N/A
 HEIGHT: 1 STORY TYPE OF CONSTRUCTION: V-B
 SPRINKLER SYSTEM: NO OCCUPANCY: R-3
 ROOF CONSTRUCTION: WOOD STORIES: 1 STORY
 HIGH PILED COMBUSTIBLE STORAGE: NO ESFR SYSTEM: NO

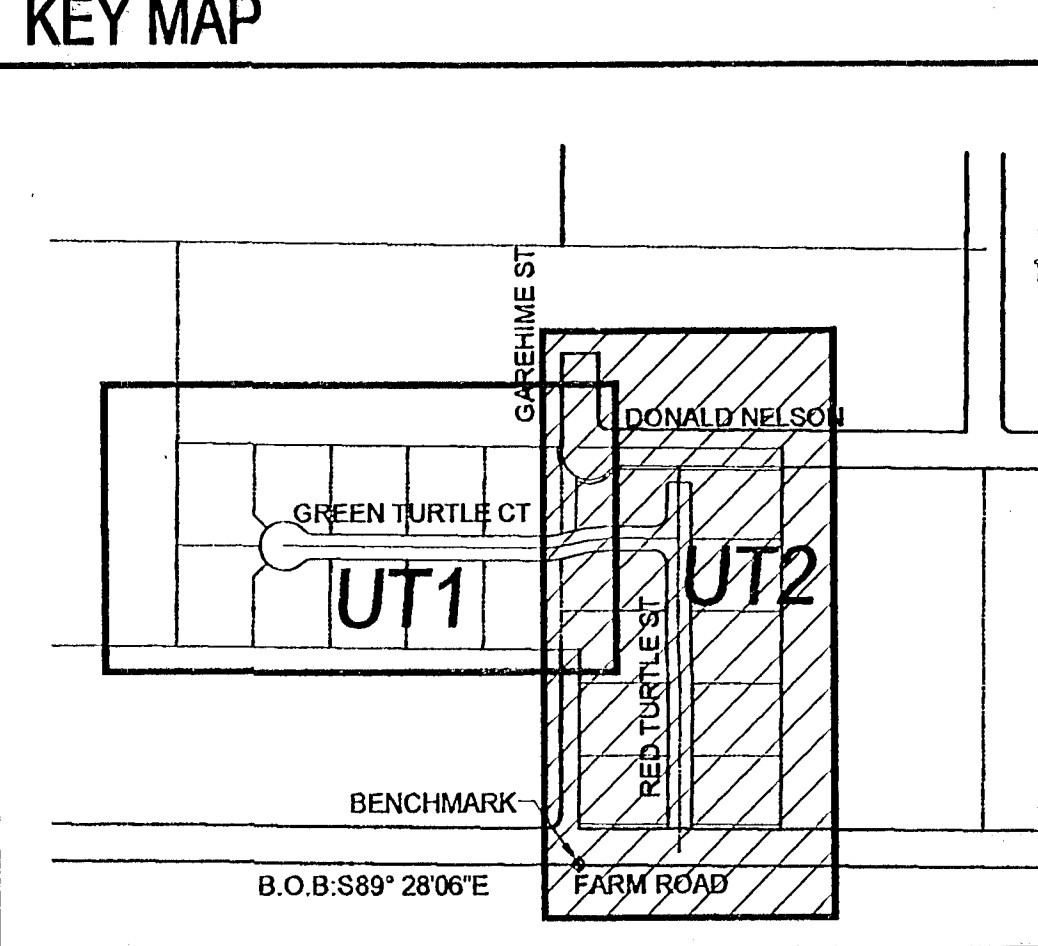
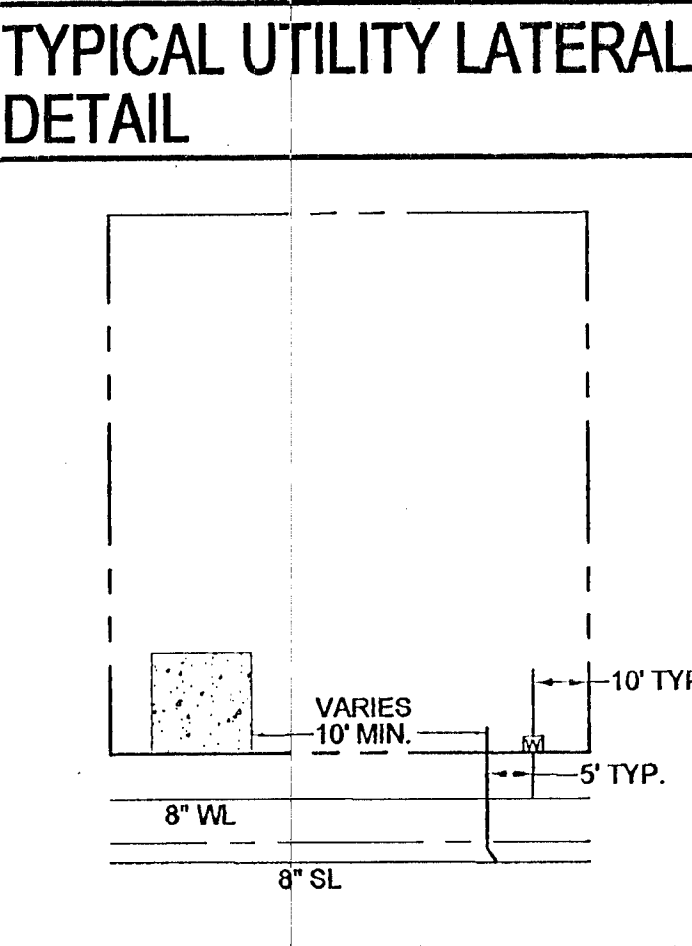

APPROVAL BLOCK
 [Signature] 03/11/13 DATE
 LAS VEGAS VALLEY WATER DISTRICT ENGINEERING SERVICES MANAGER (PROJ# 117526) DATE APPROVAL OF THESE PLANS SHALL NOT BE CONSTRUED TO BE A PERMIT FOR, OR AN APPROVAL OF, ANY VIOLATION OF ANY OF THE PROVISIONS OF THE STATE OR COUNTY LAWS. FIRE FLOW = 1,750 G.P.M. AT 20 PSI RESIDUAL.