

CONSULTANT

PROJECT / OWNER  
**Findlay Shack Honda**  
7494 W Azure Dr  
Las Vegas, NV 89130  
**Findlay Automotive Group**  
310 N. Gibson Rd  
Henderson, NV 89014  
P: 702.558.8850 F: 702.558.8818

REVISIONS	NUMBER	DESCRIPTION	DATE
1	1	DATE	4/22/06
2	2	DATE	4/22/06
3	3	DATE	4/22/06
4	4	DATE	4/22/06
5	5	DATE	4/22/06
6	6	DATE	4/22/06
7	7	DATE	4/22/06
8	8	DATE	4/22/06
9	9	DATE	4/22/06
10	10	DATE	4/22/06

SHEET TITLE  
**LANDSCAPE PLANTING PLAN**

PROJECT NO  
32-015 05  
DATE  
APRIL 11, 2006  
ISSUED FOR:  
PERMIT  
**ARCHITECTURAL**  
**L1.01**

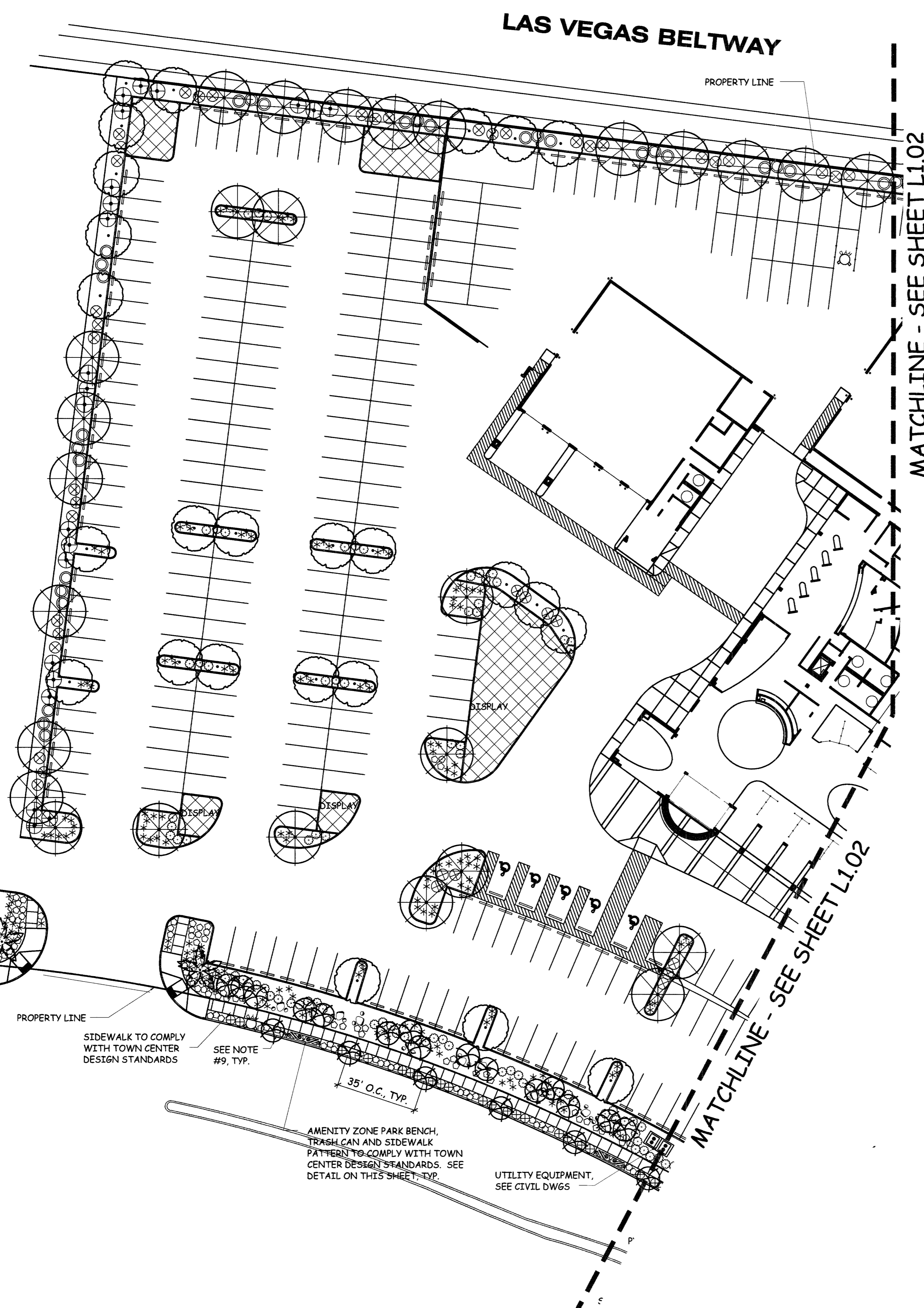
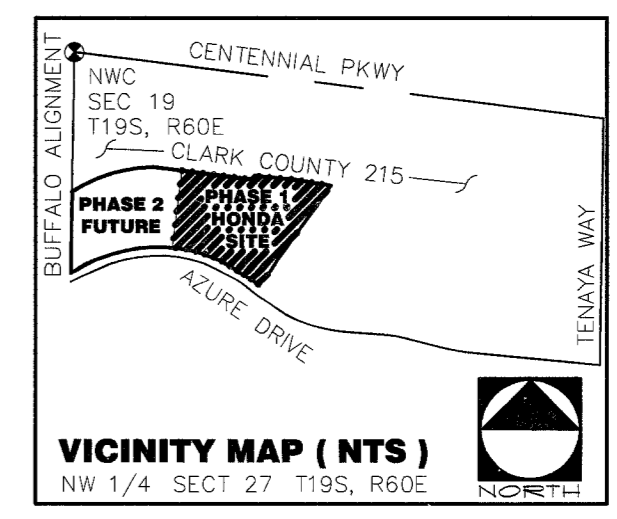

MATCHLINE - SEE SHEET L1.02

MATCHLINE - SEE SHEET L1.02

**PLANT SCHEDULE**

SYMBOL	BOTANICAL NAME	COMMON NAME	QTY.	SIZE	REMARKS
<b>TREES</b>					
⊗	CERCIDIMUM X 'DESERT MUSEUM'	DESERT MUSEUM PALO VERDE	55	24" BOX	
★	PHOENIX CANARIENSIS	CANARY DATE PALM	4	20" BTH	
⊙	RHUS LANCEA	AFRICAN SUMAC	51	24" BOX	
⊗	WASHINGTONIA ROBUSTA HYBRID	MEXICAN FAN PALM	28	20" BTH	
<b>SHRUBS</b>					
⊗	LEUCOPHYLLUM FRUTESCENS 'GREEN CLOUD'	GREEN TEXAS RANGER	43	5 GAL	
⊗	ROSMARINUS OFFICINALIS 'TUSCAN BLUE'	UPRIGHT ROSEMARY	112	5 GAL	
⊗	SENNA (CASSIA) OLIGOPHYLLA 'OUTBACK'	OUTBACK CASSIA	114	5 GAL	
⊗	SALVIA GREGGII 'SIERRA LINDA'	SIERRA LINDA SAGE	33	5 GAL	
<b>GROUND COVERS</b>					
⊕	ACACIA REDOLENS 'DESERT CARPET'	TRAILING ACACIA	22	5 GAL	
○	LANTANA MONTEVIDENSIS	TRAILING LANTANA	167	5 GAL	
<b>ACCENTS</b>					
*	HESPERALOE PARVIFLORA 'RED'	RED YUCCA	337	5 GAL	

**GENERAL NOTES:**

- CONTRACTOR IS RESPONSIBLE TO VERIFY ALL PLANT QUANTITIES. THE PLANT SCHEDULE IS INTENDED AS A REFERENCE ONLY.
- LANDSCAPE ARCHITECT IS TO APPROVE ALL PLANT MATERIAL PRIOR TO INSTALLATION WITH PRIOR NOTICE OF 48 HOURS.
- PLANT MATERIAL IS TO HAVE IDENTIFICATION TAGS ON 10% OF THE TOTAL QUANTITY OF EACH SPECIES, SHOWING GENUS, SPECIES, VARIETY, ETC.
- CONTRACTOR TO PROVIDE MATCHING SIZES AND FORMS OF LIKE SHRUB SPECIES AS SHOWN ON DRAWINGS.
- CONTRACTOR TO PROVIDE POSITIVE DRAINAGE AWAY FROM ALL STRUCTURES, WALLS, AND ON ALL SIDEWALKS ACCORDING TO ALL CODES, REGULATIONS, AND REQUIREMENTS.
- DECOMPOSED GRANITE, 1/2" SCREENED, COLOR: "MOJAVE GOLD", 2" DEPTH TYPICAL IN ALL PLANTING BEDS. CONTRACTOR TO RECEIVE VERIFICATION FROM ROCK SUPPLIER AND PRESENT VERIFICATION TO THE OWNER PRIOR TO ANY CONSTRUCTION.

WHOLESALE DEALER:  
KALAMAZOO MATERIALS, INC.  
6975 NORTH ORACLE ROAD  
TUSCON, AZ 85704  
TELEPHONE: (702) 246-9135  
CONTACT: CARRISA D'ALESSIO

- LANDSCAPE BOULDERS ARE TO BE GRANITE AND ROUND IN SHAPE. COLOR TO MATCH OR COMPLIMENT ROCK GROUND COVER. CONTRACTOR TO SET 1/4 OF ROCK DIAMETER INTO FINISH GRADE. BOULDERS TO BE 2' TO 4' IN DIAMETER, SIZED ACCORDING TO THE FOLLOWING PERCENTAGES:

20%	4' LARGEST DIAMETER	TOTAL QUANTITY OF BOULDERS: 48
40%	3' LARGEST DIAMETER	
40%	2' LARGEST DIAMETER	

- ALL PALM HEIGHTS ARE BROWN TRUNK HEIGHTS. ALL PALMS SHALL HAVE STRAIGHT TRUNKS WITH NO CURVES. ALL DATE PALMS SHALL BE SHOVEL CUT. ALL FAN PALMS SHALL BE SKINNED WITHIN 3 FEET OF THE LAST FROND. ALL PALM TREE HEIGHTS TO BE MEASURED FROM TOP OF ROOT BALL TO THE LOWEST GREEN FROND.
- WITHIN THE 4' AMENITY ZONE, DECOMPOSED GRANITE SHALL BE 3"-5" SCREENED, COLOR: "MOJAVE GOLD", 6" DEPTH TYPICAL. CONTRACTOR TO RECEIVE VERIFICATION FROM ROCK SUPPLIER AND PRESENT VERIFICATION TO THE OWNER PRIOR TO ANY CONSTRUCTION.

WHOLESALE DEALER:  
KALAMAZOO MATERIALS, INC.  
6975 NORTH ORACLE ROAD  
TUSCON, AZ 85704  
TELEPHONE: (702) 246-9135  
CONTACT: CARRISA D'ALESSIO

**Call before you OVERHEAD**  
1-702-593-6111  
SAFETY SERVICE DEPARTMENT

**Call before you Dig.**  
1-800-227-2600  
UNDERGROUND SERVICE ALERT (USA)

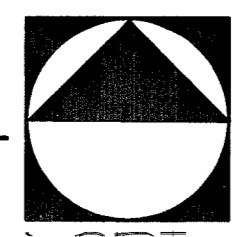
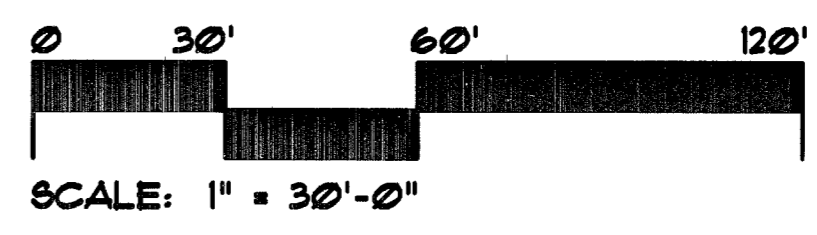

**JWZUNINO & ASSOCIATES**  
LANDSCAPE ARCHITECTURE  
LAND PLANNING

3791 South Jones Blvd.  
Las Vegas, Nevada 89146  
Phone (702) 253-8390  
Fax (702) 253-1016  
E-Mail jwz@jwzunino.com

**LANDSCAPE PLANTING PLAN**  
SCALE: 1" = 30'-0"

92040

107V4632