

Call before you Dig  
1-800-227-2600  
Hazardous Waste, Environment and Safety Services Department

Call Overhead  
1-702-593-6111  
Hazardous Waste, Environment and Safety Services Department

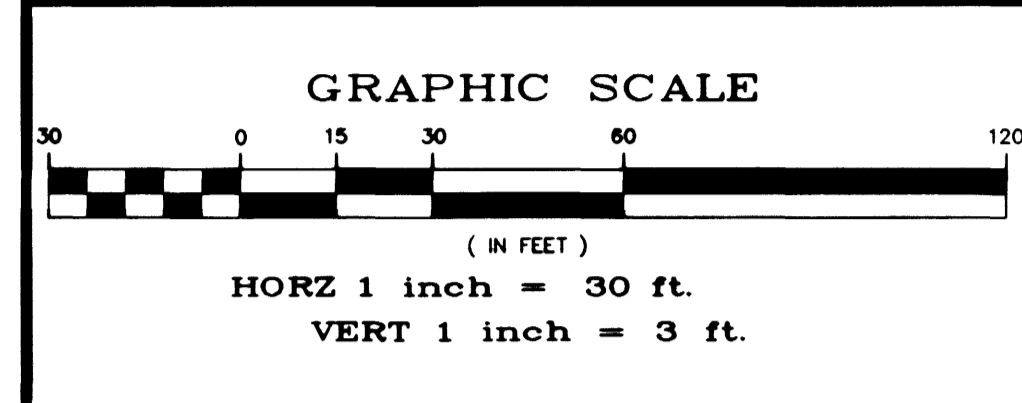
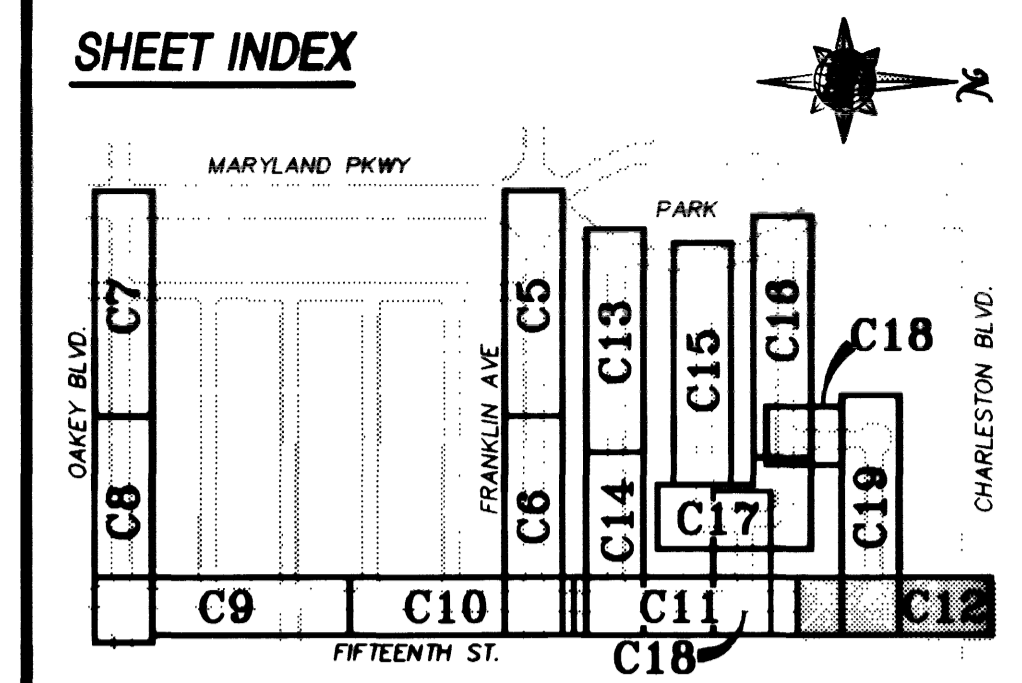

**BASIS OF BEARING**  
S00D558'E, BEING THE WEST LINE OF THE NW 1/4 OF SECTION 2, T.21S., R.61E., AS SHOWN ON RECORD OF SURVEY FILE 82, PAGE 84.

**BENCHMARK**  
ELEVATIONS ARE BASED ON THE FOLLOWING CLV BENCHMARKS:

STATION	NGVD88 ELEVATION (FT)	LOCATION
2LV11 02W6	1991.490	RIVET AND PLATE - T/C SE RETURN OF OAKLEY BLVD. & 15TH STREET
2LV11 02NW6	1992.994	RIVET AND PLATE - T/C NE RETURN OF MARYLAND PKWY. & FRANKLIN AVE.
2LV11 02W4	1997.410	RIVET AND PLATE - T/C NE RETURN OF OAKLEY BLVD. & MARYLAND PKWY.

**CAUTION:**  
EXISTING UTILITIES ARE LOCATED ON THE PLANS FROM A SEARCH OF AVAILABLE RECORDS. CONTRACTOR TO VERIFY LOCATIONS AND DEPTHS PRIOR TO CONSTRUCTION.

**REVISIONS**

NO.	DATE	DESCRIPTION	APPROVED

**STREET REHABILITATION DESIGN**  
DESIGNED BY: W.F. FORLACHER  
DRAWN BY: A.S. / L.S.B.  
JOB NO: 51451

DATE: AUG 28, 1998

**PROFESSIONAL ENGINEER - STATE OF NEVADA**  
WAYNE HERZOG  
No. 10,739

POST: BUCKLEY SCULLY & BERKMAN  
300 West Green Valley Pkwy.  
Las Vegas, NV 89102-2275  
Telephone: 702/333-7200  
Facsimile: 702/333-7200

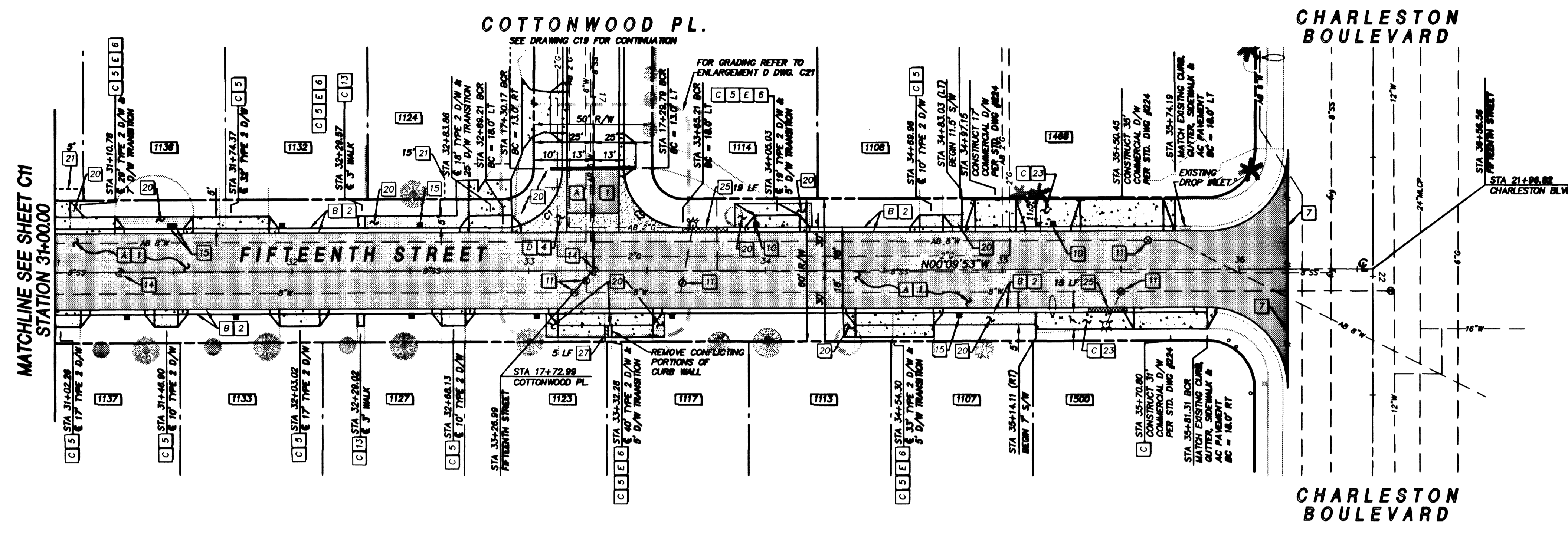

*Amiee Celft*  
LWWD DATE 8-31-98

**CURVE DATA**

No.	RADIUS	DELTA	LENGTH	TANGENT	BACK OF CURB
C1	25.00'	89°42'34"	38.14'	24.87'	
C2	25.00'	90°17'28"	38.40'	25.17'	

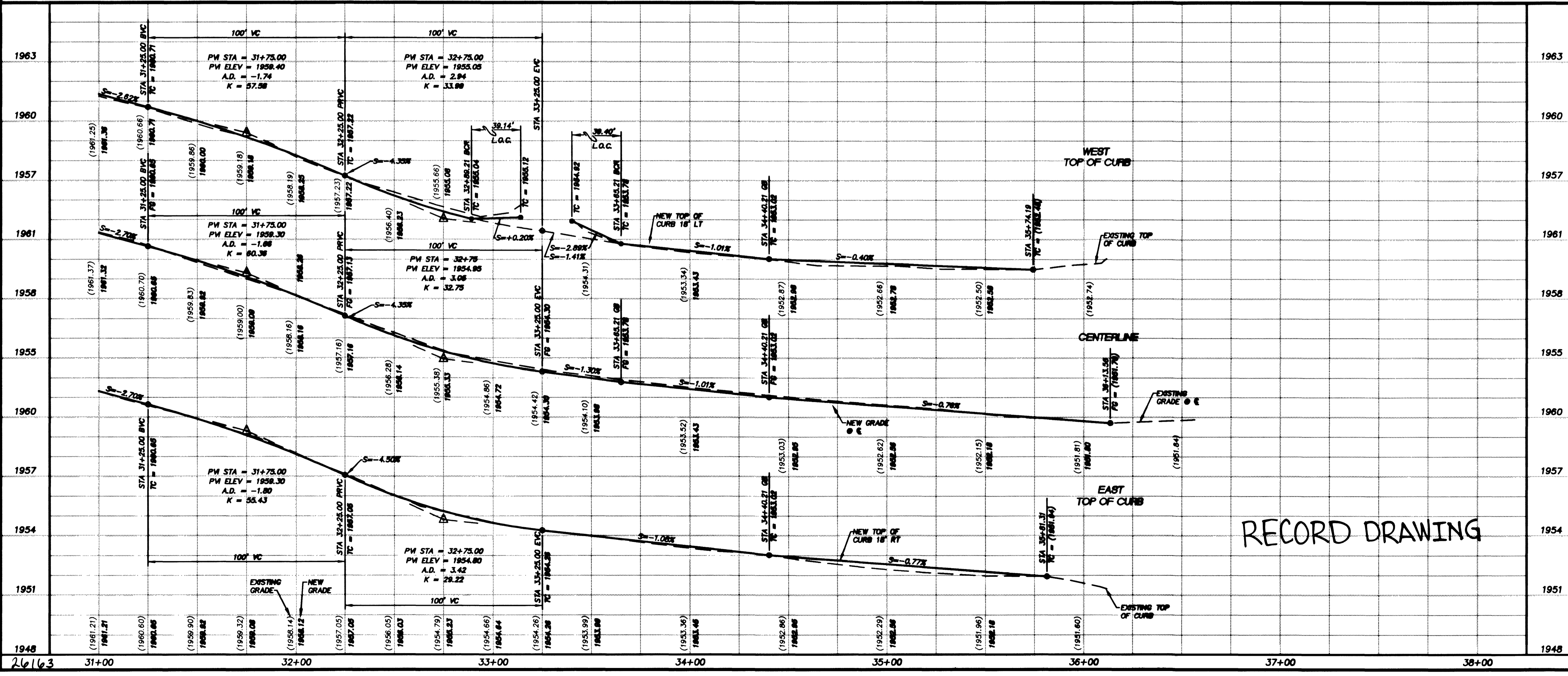

- KEY NOTES**
- REMOVAL ITEMS:**
- A REMOVE EXISTING AC PAVEMENT AND BASE COURSE.
  - B REMOVE EXISTING CURB & GUTTER.
  - C REMOVE EXISTING SIDEWALK & RESIDENTIAL DRIVEWAY.
  - D REMOVE EXISTING VALLEY GUTTER.
  - E REMOVE EXISTING CONCRETE DRIVEWAY TRANSITION.
  - F REMOVE EXISTING ROLL CURB & GUTTER.
  - G ABANDON EXISTING MANHOLE PER DETAIL "B" DWG C26.
- CONSTRUCTION ITEMS:**
- 1 CONSTRUCT STRUCTURAL SECTION PER TYPICAL SECTIONS, SEE DWG C3.
  - 2 CONSTRUCT 'L' TYPE CURB & GUTTER PER STD DWG #216.
  - 3 CONSTRUCT 5' SIDEWALK PER STD DWG #234.
  - 4 CONSTRUCT 'B' VALLEY GUTTER PER STD. DWG. #228 & DETAIL "A" DWG C26.
  - 5 CONSTRUCT RESIDENTIAL DRIVEWAY PER DETAIL "B" DWG C26.
  - 6 CONSTRUCT CONCRETE DRIVEWAY TRANSITION. (MATCH EXISTING THICKNESS - 4" MIN., AND EXISTING WIDTH).
  - 7 SAW CUT & MATCH EXISTING.
  - 8 CONSTRUCT SIDEWALK RAMP PER STD. DWG. #235.
  - 9 CONSTRUCT SIDEWALK RAMP PER DETAIL "E" DWG C26.
  - 10 INSTALL LVWD METER BOX & ADJUST SERVICE CONNECTION AS NEEDED PER UDACS STD. PLATE #18.
  - 11 ADJUST EXISTING VALVE BOX TO FG PER UDACS PLATE #8.
  - 12 CONSTRUCT SEWER REPAIR PER DETAIL "A" DWG C27.
  - 13 CONSTRUCT CONCRETE WALKWAY TRANSITION. (MATCH EXISTING THICKNESS - 4" MIN., AND EXISTING WIDTH).
  - 14 ADJUST MANHOLE RING TO FG PER STD. DWG. #408.
  - 15 ADJUST LVWD METER BOX & ADJUST SERVICE CONNECTION AS NEEDED PER UDACS STD. PLATE #18.
  - 16 NOT USED
  - 17 SET TYPE III MONUMENT PER STD. DWG. #241.
  - 18 PAINT CURB RED (LENGTH AS SHOWN).
  - 19 CONSTRUCT ASPHALT PATCH PER DETAIL "C" DWG C26.
  - 20 REGRADE TO DRAIN (IRRIGATION & LANDSCAPE REPAIR). REFER TO NOTE #7 DWG C2.
  - 21 CONSTRUCTION EASEMENT AS NOTED.
  - 22 CONSTRUCT STRUCTURAL SECTION PER SECTION 6 DWG C3.
  - 23 CONSTRUCT SIDEWALK PER STD. DWG. #234 (WIDTH PER PLANS)
  - 24 CONSTRUCT 4' SIDEWALK PER STD. DWG. #234.
  - 25 PAINT CURB RED 15' EACH SIDE OF FIRE HYDRANT EXCEPT FOR DRIVEWAYS.
  - 26 REMOVE AND RESET EXISTING SIGN.
  - 27 CONSTRUCT CURB WALL PER DETAIL "G" DWG C26.
  - 28 CONSTRUCT GEOGRID LAP PER DETAIL "B" DWG C27.

RECORD DRAWING

Department of Public Works

HUNTRIDGE NEIGHBORHOOD - PHASE 3  
FIFTEENTH STREET PLAN AND PROFILE  
STA 31+00.00 TO STA 37+00.00

**CITY OF LAS VEGAS**  
NEVADA

DRAWING No. 12  
C12  
PLAN# 107-V2813