

NOTE: CONTRACTOR TO FURNISH & INSTALL, METER PEDESTAL, ALL CONDUIT FOUNDATIONS FOR SIGNAL POLE, WIRE/CONDUIT FOR, STREETLIGHTS, & PULL BOXES, UNDER THIS CONTRACT.(UNDERGROUNDS ONLY) ABOVE GROUND SIGNAL POLES, HEADS, MAST ARMS & APPURTENCES TO BE INSTALLED BY OTHERS AT FUTURE DATE.

NOTE: CONTRACTOR TO PROVIDE AND INSTALL "L" TYPE FOUNDATION PER USD. 404.209 AND BASE PLATE ADAPTOR PER USD 404.409. MOUNT NEW STREET LIGHT ASSEMBLY (TYPICAL OF FOUR) 250W HPS.

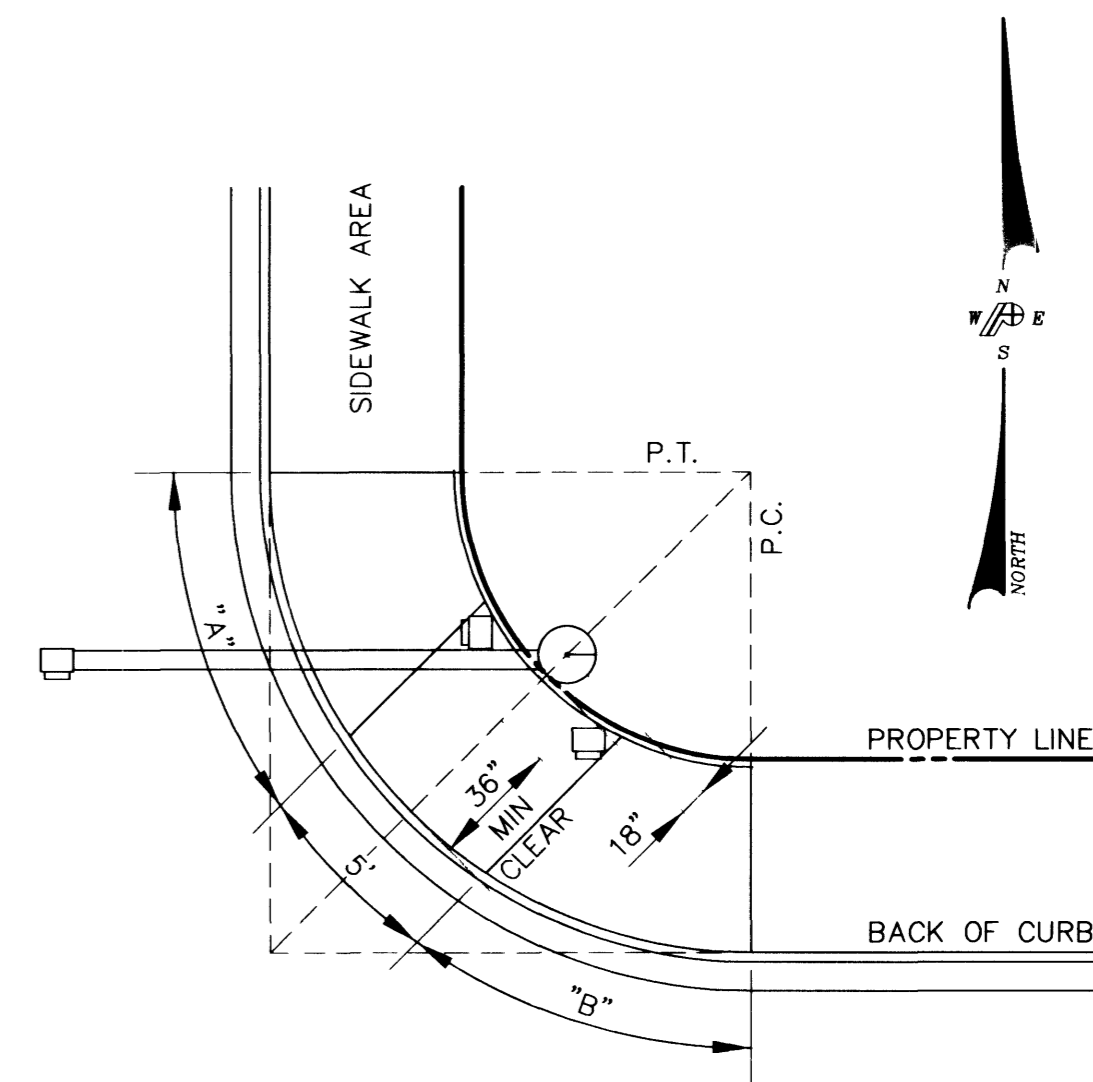

**TYPICAL FOUNDATION LOCATION**

CENTER OF FOUNDATION 18" FROM PROPERTY LINE  
TYPICAL SIDEWALK RAMP CASE 1  
REF TO C-5 FOR INSTALLATION.

CONTRACTOR TO INSTALL NEW NO. 5 PULLBOX AND STUB UP CONDUIT AND WIRE FOR FUTURE SIGNAL CABINET.

PROVIDE AND INSTALL 200 AMP SERVICE PEDESTAL (USD No 404.1412) ON NEW FOUNDATION WITH:  
 2 - 2 POLE 60 AMP CIRCUIT BREAKER/S  
 2 - 1 POLE 15 AMP CIRCUIT BREAKER/S  
 1 - 1 POLE 40 AMP CIRCUIT BREAKER/S  
 1 - 1 POLE 60 AMP CIRCUIT BREAKER/S  
 2 - 2 POLE 60 AMP CONTACTOR/S  
 1 - BY PASS SWITCH PER CONTACTOR

SERVICE POINT EXISTING NP POLE # 78393

**POLE SCHEDULE**

POLE	LOCATION STATION (OFFSET)
(A)	GOWAN 78+74.18 48.54' RT
(B)	JONES 78+64.18 50.26'
(C)	GOWAN 79+71.28 50.20' LT
(D)	JONES 79+65.70 49.15' RT

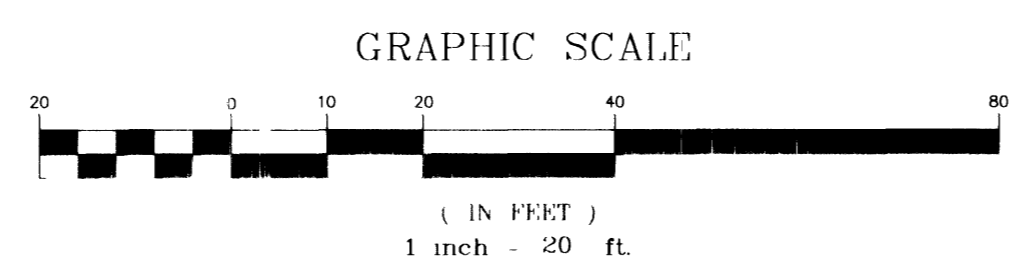

CONDUIT AND WIRE SCHEDULE		VIA CONDUIT																
WIRE & CABLE	FROM	TO	1	2	3	4	5	6	7	8	9	10	11	12	13	14	15	16
3-#4/0 AWG THW	N.P.Co. SERVICE PT.	SERVICE PEDESTAL	x															
3-#4, 1-#8 GRD.	SERVICE PED.	CONTROLLER	x															
25 C. #14, 2 #10 THW 2-#12, COAXIAL	CONTROLLER	POLE A		x	x													
20 C. #14, 2 #10 THW 2-#12, COAXIAL	CONTROLLER	POLE B		x		x	x											
25 C. #14, 2 #10 THW 2-#12, COAXIAL	CONTROLLER	POLE C		x		x						x						x
25 C. #14, 2 #10 THW 2-#2, COAXIAL	CONTROLLER	POLE D		x							x							
EMERGENCY VEHICLE PRIORITY CONTROL	CONTROLLER	POLE A		x	x													
EMERGENCY VEHICLE PRIORITY CONTROL	CONTROLLER	POLE D		x							x							
INTERCONNECT	CONTROLLER TORREY PINES	CONTROLLER JONES		x							x							x
CONDUIT SIZE			2"	2"	3-3"	3-3"	3-3"	3-3"			3"	2-3"	3"					3"

NOTE: SPOOL 25' OF INTERCONNECT WIRE IN CABINET (TYP.)

A NO. 8 GREEN GROUNDING WIRE SHALL BE RUN FROM THE CONTROLLER CABINET TO EACH SIGNAL POLE BASE

REVISION	
DATE	

**POGGEMEYER DESIGN GROUP**  
 ENGINEERS PLANNERS SURVEYORS  
 LANDSCAPE ARCHITECTS  
 2601 NORTH TENAYA WAY LAS VEGAS, NEVADA 89128 (702) 255-8100

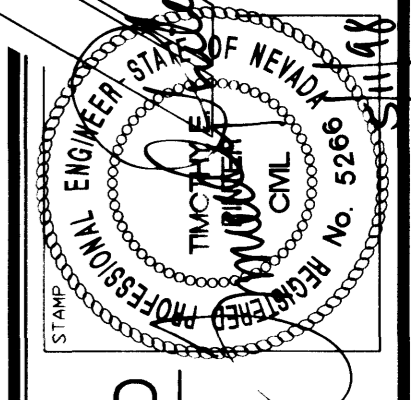

GOWAN ROAD IMPROVEMENT PROJECT  
 FROM US-95 TO DECATUR BOULEVARD  
**TRAFFIC INTERSECTION PLAN**  
**JONES BOULEVARD & GOWAN ROAD**

JOB NUMBER	1003003
DESIGNED BY	JJD
DRAWN BY	RCP
CHECKED BY	TEP
DATE	05.11.98

SHEET NUMBER  
**S-2**  
 56 OF 63

FILE NAME  
 SHEET NO.  
 DATE  
 38277