

PLAN - GOWAN ROAD

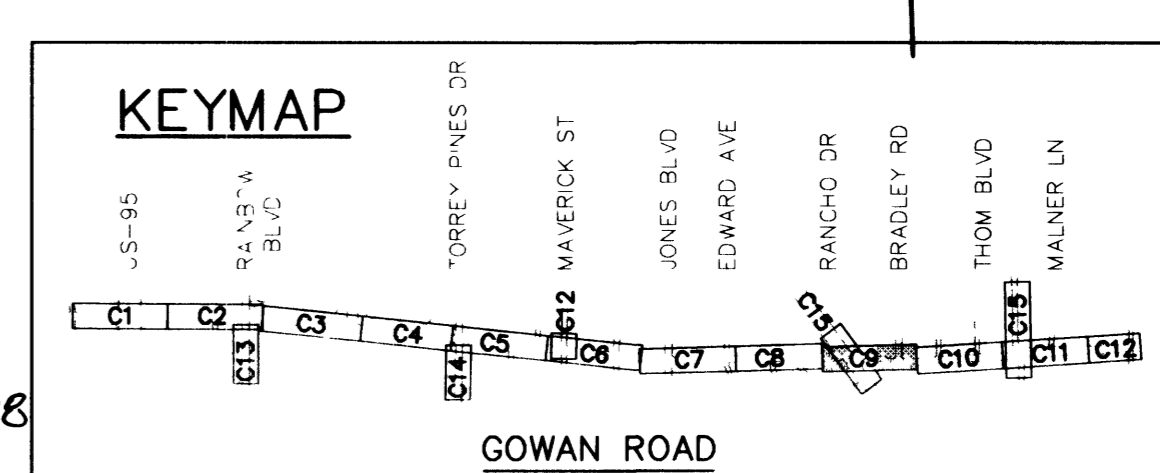

- CONSTRUCTION KEYNOTES**
- CONSTRUCT 6" ASPHALTIC CONCRETE OVER 16" TYPE II AGGREGATE BASE IN ACCORDANCE WITH DETAIL
 - CONSTRUCT 4" ASPHALTIC CONCRETE OVER 13" TYPE II AGGREGATE BASE IN ACCORDANCE WITH DETAIL
 - CONSTRUCT 2" ASPHALTIC CONCRETE OVERLAY
 - CONSTRUCT 3/4" OPEN GRADE
 - CONSTRUCT 3" ASPHALTIC CONCRETE OVER 10" TYPE II AGGREGATE BASE IN ACCORDANCE WITH DETAIL
 - CONSTRUCT MEDIAN CURB PER CLV STD DWG NO 221
 - ADJUST TO GRADE IN ACCORDANCE WITH USD NO 408 (MANHOLES) NO 517 (VALVE BOX) NO 506 (METER BOX)
 - CONSTRUCT SIDEWALK IN ACCORDANCE WITH USD NO 234
 - CONSTRUCT SIDEWALK RAMP CASE I, DATE 06-13-96, IN ACCORDANCE WITH USD NO 235, A & B = 8', UNLESS OTHERWISE NOTED
 - CONSTRUCT CROSS GUTTER IN ACCORDANCE WITH USD NO 228
 - CONSTRUCT "L" TYPE CURB AND GUTTER IN ACCORDANCE WITH USD NO 216
 - CONSTRUCT RESIDENTIAL DRIVEWAY IN ACCORDANCE WITH USD NO 223
 - CONSTRUCT OPTION B DRIVEWAY WITH CROSS GUTTER IN ACCORDANCE WITH USD NO 225

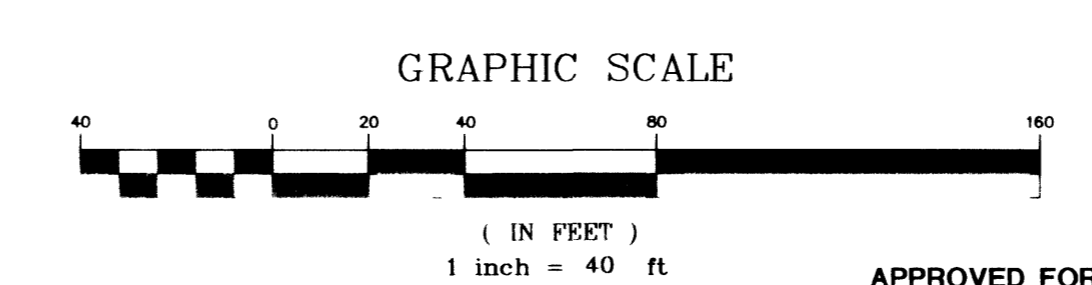
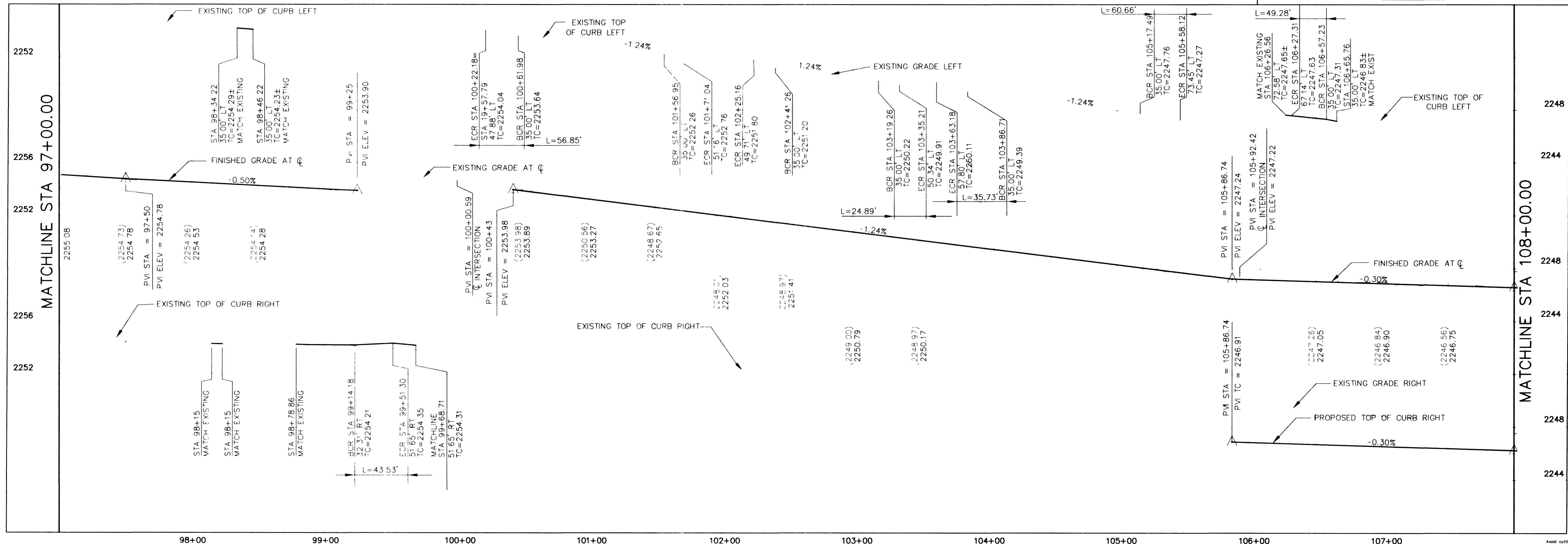

PROFILE

1" = 40' H
1" = 4' V

BACK OF CURB CURVE TABLE

CURVE	RADIUS	LENGTH	TANGENT	DELTA
C27	59.00'	56.85'	30.85'	55°12'37"
C28	59.00'	56.85'	30.85'	55°12'37"
C30	35.00'	60.66'	41.19'	99°17'42"
C75	15.00'	24.89'	16.40'	95°05'21"
C76	25.00'	35.73'	21.69'	81°53'47"
C31	30.00'	49.28'	32.24'	94°06'48"

Call before you Dig.
1-800-227-2600

REVISION

DATE	BY	REVISION
07/28/98	JJD	PER NDOT COMMENTS
08/15/98	JJD	ADDED UNPAID SIGNATURES, MISC. REPAIR REASONS.

POGGEMEYER DESIGN GROUP
ENGINEERS PLANNERS SURVEYORS
LANDSCAPE ARCHITECTS
LAS VEGAS, NEVADA 89128 (702) 255-8100

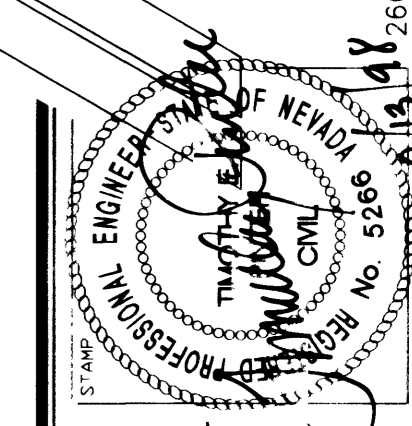

GOWAN ROAD IMPROVEMENT PROJECT
FROM US-95 TO DECATUR BOULEVARD
PLAN AND PROFILE
GOWAN RD.
STA 97+00 TO 108+00

JOB NUMBER	1003003
DESIGNED BY	JJD
DRAWN BY	RCP/DRF
CHECKED BY	TEP
DATE	05.11.98

SHEET NUMBER
C-9
24 of 63