

03-22-07 08:23:45 D:\johnson\03-22-07\08:23:45\1681\F:\112-627\dwg\improv\lgnc_R04.dwg

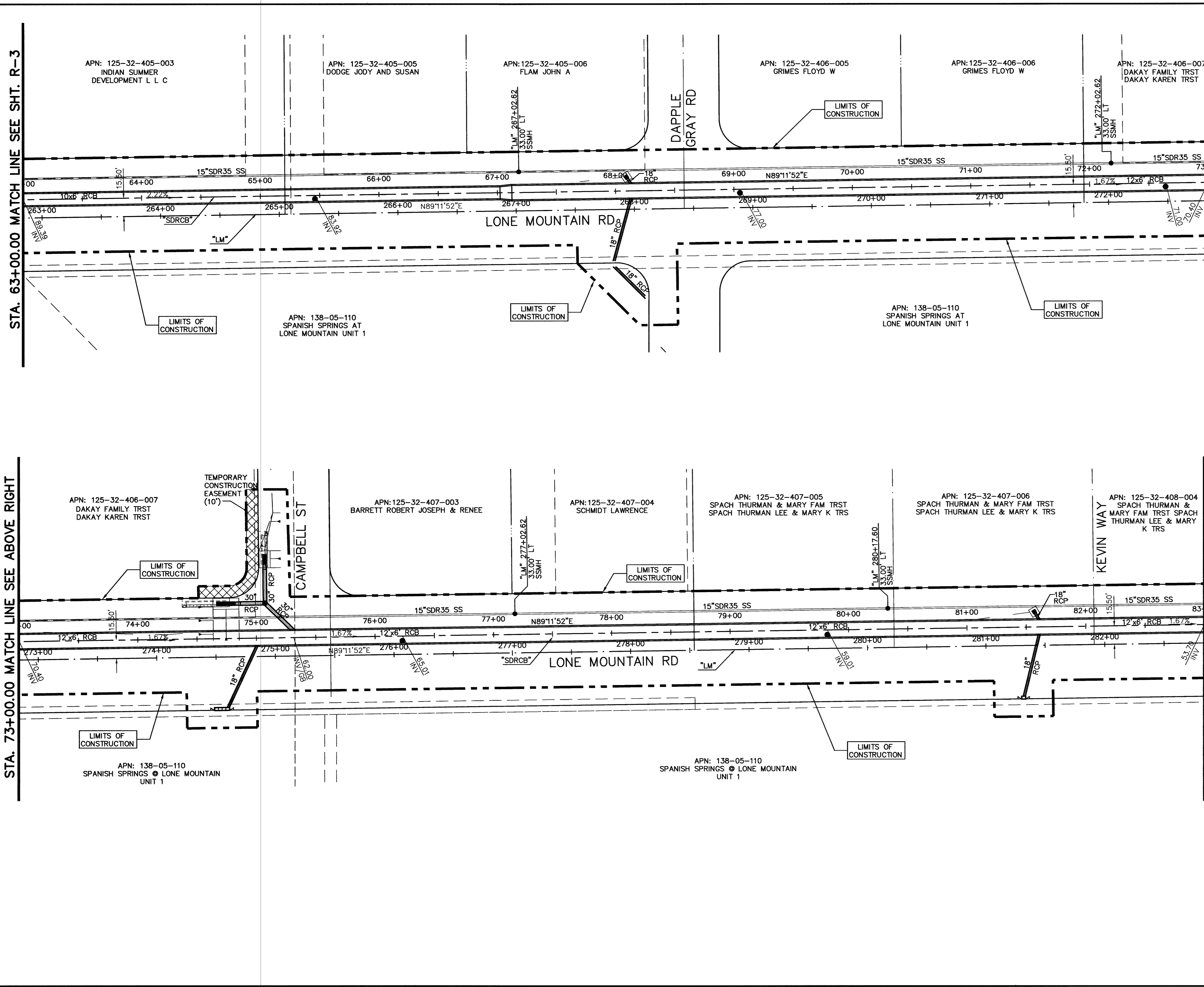

STA. 63+00.00 MATCH LINE SEE SHT. R-3
 STA. 73+00.00 MATCH LINE SEE BELOW LEFT
 STA. 73+00.00 MATCH LINE SEE ABOVE RIGHT
 STA. 83+00.00 MATCH LINE SEE SHT. R-5

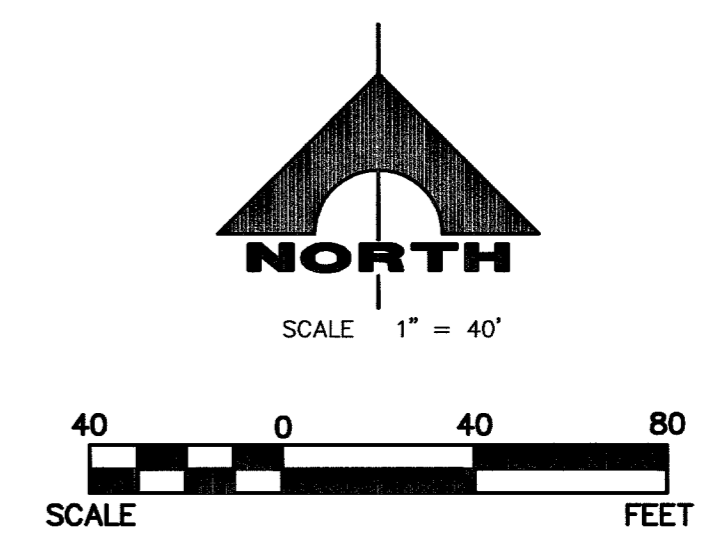

- LEGEND**
- BLM GRANT AMENDMENT
 - PRIVATE PARCEL DECLARATION OF UTILIZATION
 - TEMPORARY CONSTRUCTION EASEMENT
 - TEMPORARY CONSTRUCTION EASEMENT
 - LIMITS OF CONSTRUCTION
 - CENTERLINE

 DEPARTMENT OF PUBLIC WORKS EAST STEWART LAS VEGAS, NEVADA, NV 89101		 G.C. WALLACE, INC. Engineers/Planners/Surveyors 1559 SOUTH RAINBOW BLVD., LAS VEGAS, NEVADA 89146 TELEPHONE: (702) 804-2000 • FAX: (702) 804-2299	
SHEET RIGHT-OF-WAY EXHIBIT STA. 63+00.00 TO STA. 83+00.00 GOWAN NORTH CHANNEL PHASE IV		TITLE STA. 63+00.00 TO STA. 83+00.00 GOWAN NORTH CHANNEL PHASE IV	
DRAWN BY: DVJ	DESIGNED BY: CML	CHECKED BY: WEH	PROJECT NO: 412.627
SCALE: 1" = 40' HORIZ 1" = 4' VERT		SHEET R-4 12 OF 45 SHEETS DRAWING NO.	

GOWAN NORTH CHANNEL - PHASE IV