

- STORM DRAIN NOTES:**
(NOT ALL KEY NOTES ARE USED ON THIS DRAWING)
- INSTALL 72" STANDARD ECCENTRIC MANHOLE PER C.C.A.U.S.D. No. 403 WITH MANHOLE COVER AND RING PER C.C.A.U.S.D. No. 409.
 - INSTALL 48" STANDARD ECCENTRIC MANHOLE PER C.C.A.U.S.D. No. 403 WITH MANHOLE COVER AND RING PER C.C.A.U.S.D. No. 409.
 - INSTALL JENSEN PRECAST 36" X 36" DROP INLET (MODEL No. 4848-HD1) WITH STANDARD TRAFFIC GRATE PER DETAIL 23-C9.03.
 - INSTALL 12" ADS INLINE DRAIN INLET WITH 12" PEDESTRIAN H-10 RATED HINGED LOCKING GRATE PER DETAIL 21-C9.03.
 - INSTALL CLEANOUT PER PLAN WITH NEEHAH H-20 TRAFFIC LOAD RATED COVERS OR APPROVED EQUAL.
 - INSTALL 48" STANDARD ECCENTRIC MANHOLE PER C.C.A.U.S.D. No. 403 WITH NEEHAH MODEL R-2556-A FRAME AND GRATE.
 - INSTALL A PRECAST TRENCH CHANNEL UNIT EQUIPPED W/6" PVC PIPE VERTICAL OUTLET FOR CONNECTION W/STORM DRAIN PIPING PER DETAIL 22-C9.03. THE CHANNEL UNIT SHALL BE ACC DRAIN K100S CHANNEL W/TYPE 478 GRATE BY ACO POLYMER PRODUCTS OR APPROVED EQUAL.
 - CONNECT STORM DRAIN LATERAL TO BUILDING ROOF DRAIN. REFER TO MECHANICAL AND PLUMBING PLANS FOR CONTINUATION. WHERE BUILDING STUBS ARE 3", 4", AND 5" PROVIDE 6"x3" REDUCER FOR 3", 6"x4" REDUCER FOR 4", AND 6"x5" REDUCER FOR 5".
 - INSTALL 60" STANDARD ECCENTRIC MANHOLE PER C.C.A.U.S.D. No. 403 WITH MANHOLE COVER AND RING PER C.C.A.U.S.D. No. 409.
 - CONSTRUCT STORM DRAIN PIPE CONNECTION WITH CONCRETE CHANNEL WALL PER DETAIL "2" ON SHEET C9.06.
 - INSTALL JENSEN PRECAST 48" X 48" DROP INLET (MODEL No. 4848 HD1) WITH STANDARD TRAFFIC GRATE PER DETAIL 28-C9.03.
 - INSTALL 12.5" TYPE "CM" D.I. W/ 5 GRATES PER DETAIL 25-C9.03.
 - INSTALL 5" TYPE "CM" D.I. W/ 2 GRATES PER DETAIL 29-C9.03.

- GENERAL NOTES:**
- REFER TO THE MASTER SITE PLAN SHEET C2.00 FOR PROPERTY LINE INFORMATION ALONG RIGHT-OF-WAY.
 - FOR ADDITIONAL STORM DRAIN SYSTEM AND UTILITY INFORMATION, REFER TO UTILITY SHEETS C3.00 TO C3.04.
 - FOR CURVE/LINE DATA AND SIGHT VISIBILITY RESTRICTION ZONES, REFER TO SHEETS C2.01 TO C2.05.
 - REFER TO ARCHITECTURAL PLANS FOR CHAIN LINK FENCE HEIGHTS.
- DEMOLITION NOTES:**
- REMOVE EXISTING AC PAV., MATCH NEW AC PAV. TO EXISTING AC PAV. AT SAWCUT LINE.
- CONSTRUCTION NOTES:**
(NOT ALL KEY NOTES ARE USED ON THIS DRAWING)
- CONSTRUCT "L" TYPE CURB AND GUTTER PER C.C.A.U.S.D. #216.
 - CONSTRUCT "A" TYPE CURB PER C.C.A.U.S.D. #219.
 - CONSTRUCT COMMERCIAL/INDUSTRIAL DRIVEWAY PER C.C.A.U.S.D. #225 WITH GEOMETRIC PER C.C.A.U.S.D. #222A. CONSTRUCT 8" CROSS GUTTER PER C.C.A.U.S.D. #228.
 - CONSTRUCT CONCRETE SIDEWALK PER C.C.A.U.S.D. #234.
 - CONSTRUCT SIDEWALK RAMP CASE I PER C.C.A.U.S.D. #235 (DETECTABLE WARNINGS SHALL BE THE FULL DEPTH OF THE RAMP - YELLOW IN COLOR).
 - CONSTRUCT UNDER SIDEWALK DRAIN PER C.C.A.U.S.D. #236.
 - INSTALL PRECAST BUMPER BLOCK PER C.C.A.U.S.D. #238.
 - CONSTRUCT MOW CURB PER DETAIL 5-C9.01.
 - CONSTRUCT SIDEWALK RAMP PER DETAIL 6-C9.01.
 - CONSTRUCT FENCE WITH MOW CURB PER DETAIL 7-C9.01.
 - CONSTRUCT MODIFIED "L" CURB AND GUTTER PER DETAIL 8-C9.01.
 - CONSTRUCT MAZE PER DETAIL 9-C9.01.
 - CONSTRUCT CONCRETE IN AREA SHOWN SHADED PER DETAIL 12-C9.02.
 - CONSTRUCT CONCRETE SIDEWALK PER DETAIL 13-C9.02. REFER TO THE ARCHITECTURAL PLANS FOR CONTROL JOINT PATTERN.
 - CONSTRUCT LIGHT AC PAVEMENT PER DETAIL 14-C9.02.
 - REFER TO SHEET C9.04 FOR STREET SECTIONS.
 - CONSTRUCT TENNIS COURT AC PAVEMENT PER DETAIL 16-C9.02.
 - CONSTRUCT 2' WIDE CONCRETE FLUME PER DETAIL 19-C9.02.
 - CONSTRUCT SIDEWALK RAMP CASE II PER C.C.A.U.S.D. #235 (DETECTABLE WARNINGS SHALL BE THE FULL DEPTH OF THE RAMP - YELLOW IN COLOR).
 - REFER TO ARCHITECTURAL SITE DETAILS FOR PLANTER SECTIONS.
 - (NOT USED)
 - LANDSCAPE AREA, SEE LANDSCAPE ARCHITECT PLANS.
 - REFER TO COURTYARD GRADING PLAN ON SHEET C4.05.
 - CONSTRUCT MODIFIED "A" CURB PER DETAIL 20-C9.02.
 - CONSTRUCT 6" WIDE CONCRETE FLUME SIMILAR TO DETAIL 19-C9.02.
 - CONSTRUCT 3" VALLEY GUTTER PER DETAIL 17-C9.02.
 - INSTALL 72" STANDARD ECCENTRIC MANHOLE PER C.C.A.U.S.D. No. 403 WITH MANHOLE COVER AND RING PER C.C.A.U.S.D. No. 409.
 - INSTALL 48" STANDARD ECCENTRIC MANHOLE PER C.C.A.U.S.D. No. 403 WITH MANHOLE COVER AND RING PER C.C.A.U.S.D. No. 409.
 - INSTALL CLEANOUT PER PLAN WITH NEEHAH H-20 TRAFFIC LOAD RATED COVERS OR APPROVED EQUAL.
 - INSTALL 60" STANDARD ECCENTRIC MANHOLE PER C.C.A.U.S.D. No. 403 WITH MANHOLE COVER AND RING PER C.C.A.U.S.D. No. 409.
 - CONSTRUCT RETAINING WALL PER HORIZONTAL CONTROL PLANS C2.00 - C2.05 AND PER RETAINING WALL PROFILE SHEETS C10.00 - C10.04.
 - INSTALL 12" ADS INLINE DRAIN INLET WITH 12" PEDESTRIAN H-10 RATED HINGED LOCKING GRATE PER DETAIL 21-C9.03.
 - INSTALL A PRECAST TRENCH CHANNEL UNIT EQUIPPED W/6" PVC PIPE VERTICAL OUTLET FOR CONNECTION W/STORM DRAIN PIPING PER DETAIL 22-C9.03. THE CHANNEL UNIT SHALL BE ACC DRAIN K100S CHANNEL W/TYPE 478 GRATE BY ACO POLYMER PRODUCTS OR APPROVED EQUAL.
 - ADJUST WATER VALVE BOX TO FINISHED GRADE PER U.D.A.C.S. PLATE No. 8.
 - CONSTRUCT HEAVY AC PAVEMENT PER DETAIL 15-C9.02.
 - CONSTRUCT 8" CROSS GUTTER PER CCAUSD #228
 - CONSTRUCT SIDEWALK PER TOWN CENTER DEVELOPMENT STANDARDS.
 - NOT USED.
 - CONSTRUCT ROCK WALL PER LANDSCAPE ARCHITECTS PLANS.
 - REMOVE AND REPLACE EX AC PER TRENCH SECTION DETAIL 5-C9.04.
 - CONSTRUCT 5'-0" PVC FENCE PER ARCHITECT PLANS.
 - CONSTRUCT EQUESTRIAN TRAIL PER ARCHITECTS PLANS.

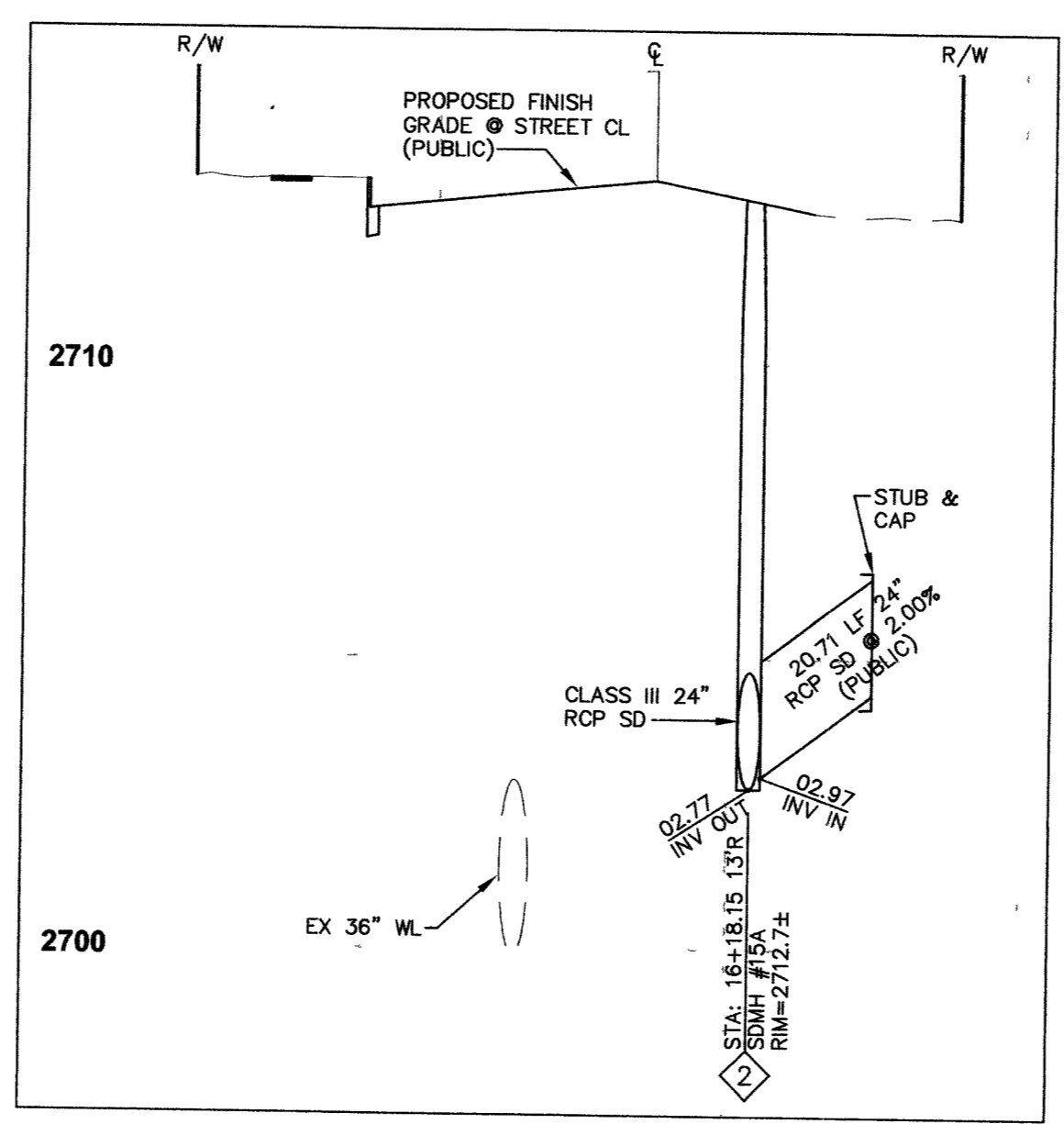
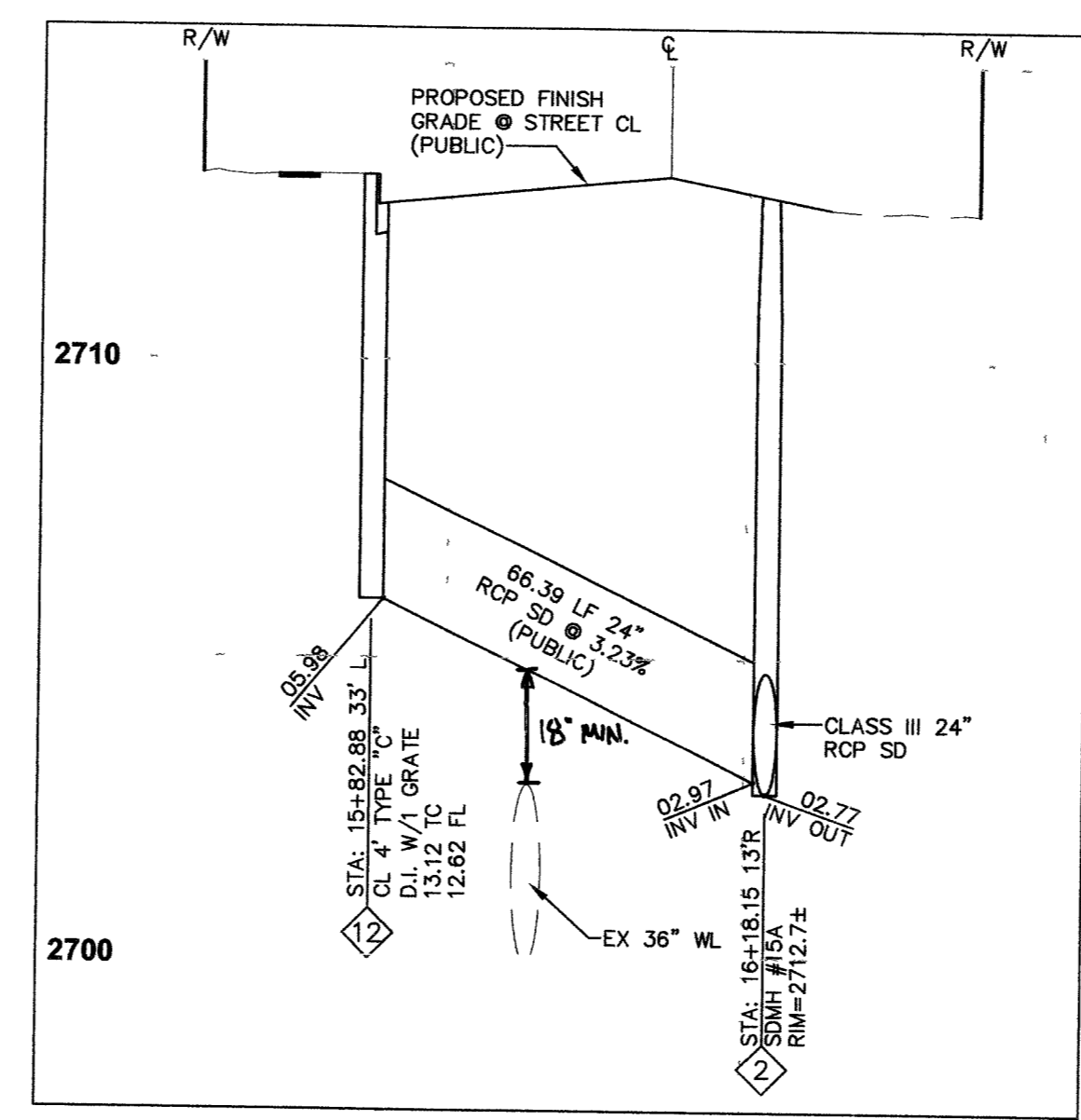

REVISIONS

REV.	DESCRIPTION	DATE	BY
1	REVISED GRATES & RISE VALUES TO PERMIOG 2% CROSS SLOPE ON STREET SECTION	5-24-07	RK

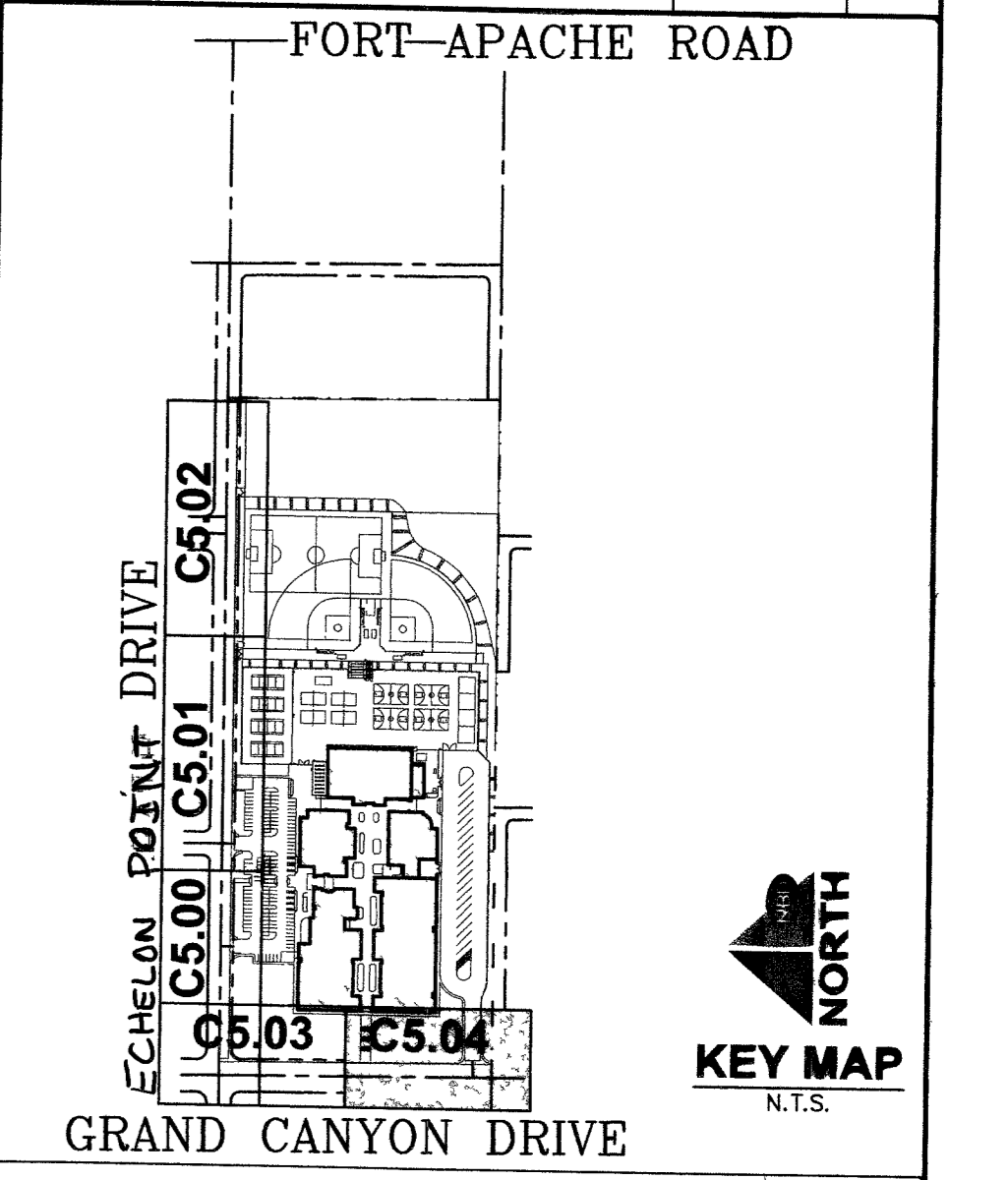

DO NOT SCALE DRAWINGS

STATE OF NEVADA	1512	01/18/06	JSG	MK	BID	02/99
CLAYTON LAYTON						
REGISTERED PROFESSIONAL ENGINEER						
NO. 12137						

Nevada By Design
3515 East Flamingo Ave. Suite 202
Las Vegas, NV 89121
www.nvbydesign.com

WELLES - PUGSLEY ARCHITECTS L.L.C.
2480 e. Tompkins Avenue, Suite 222, Las Vegas, Nevada 89121
ph. 702.431.1150 fax. 702.431.7899 e-mail. wlp@psaarchitect.com

CLARK COUNTY SCHOOL DISTRICT
CONSTRUCTION MANAGEMENT 4828 PEARL STREET LAS VEGAS, NEVADA 89121

GRAND CANYON / ROME MIDDLE SCHOOL
SOUTHEAST CORNER OF GRAND CANYON DRIVE AND ECHELON POINT DRIVE

GRAND CANYON DRIVE STA: 13+25 TO END STA:

APPROVED FOR CONSTRUCTION

N/A

Las Vegas Valley Water District - Proj. #111984 Date

BENCHMARK:
CLV BENCHMARK #8LV90-19C4
CITY OF LAS VEGAS PIN AND ROUND ALUMINUM PLATE IN CONCRETE PAD, ±200' NORTHWEST OF DEER SPRINGS AND GRAND CANYON DR.
ELEVATION = 832.7831 METERS, 2732.22 FEET (NAVD 88)

BASIS OF BEARINGS:
SOUTH 89°38'06" EAST BEING THE SOUTH LINE OF THE NORTHWEST QUARTER OF THE SOUTHWEST QUARTER OF SECTION 19, TOWNSHIP 19 SOUTH, RANGE 60 EAST, M.D.M., AS SHOWN PER RECORD OF SURVEY FILE 89, PAGE 3.

Call before you Dig
Call before you Dig
Call before you Dig

1-702-455-7511
1-702-229-6611

1-702-593-6111 1-800-227-2600

LEGEND

CL OR SURVEY LINE	EASEMENT LINE	HEAVY AC PV.	MANHOLES & DESCRIPTIONS	BO VALVE	CLEAN OUT	FDC	FIRE HYDRANT	GATE VALVE	REDUCER	100w HPS STREET LIGHT	150w HPS STREET LIGHT	200w HPS STREET LIGHT	250w HPS STREET LIGHT	400w HPS STREET LIGHT	5' CONTOUR LINE	1' CONTOUR LINE	EDGE OF PAVMT.	"A" TYPE CURBS	"L" TYPE CURBS	WALLS	FENCES	SPOT ELEVATIONS	SIGNS
---	---	---	⊙ = SANITARY SEWER ⊙ = STORM DRAIN ⊙ = ELECTRICAL ⊙ = TELEPHONE	⊙	⊙	⊙	⊙	⊙	⊙	⊙	⊙	⊙	⊙	⊙	---	---	---	---	---	---	---	---	---