

1 CMU BLOCK WALL DETAIL
NTS

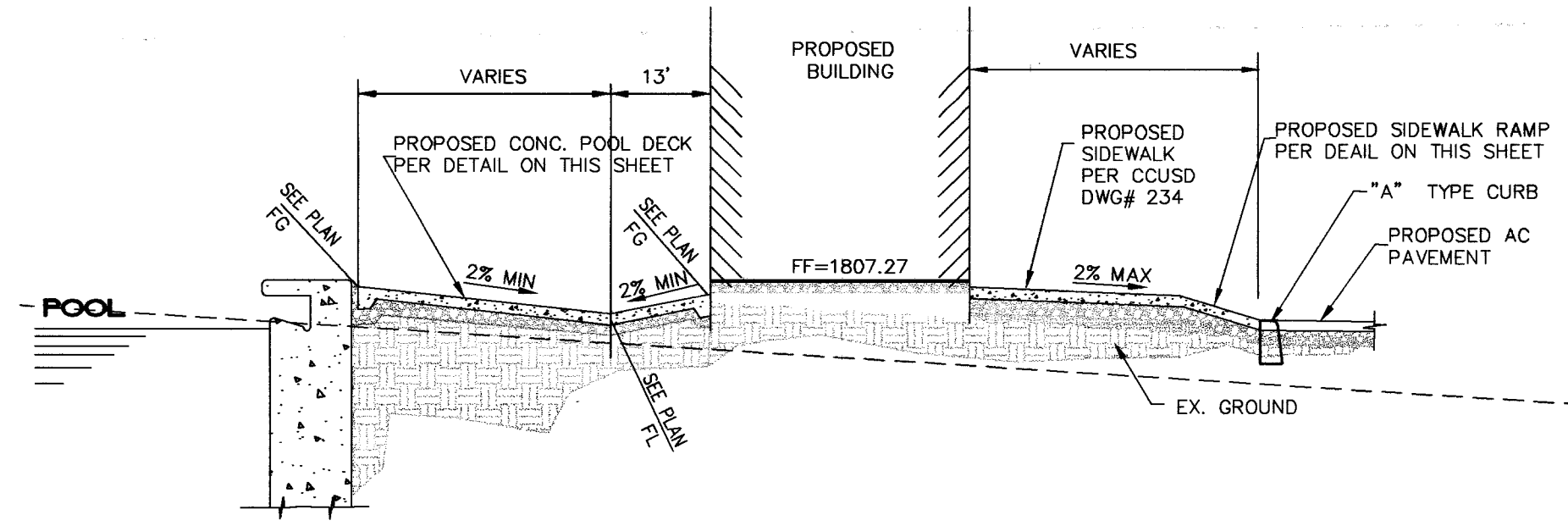

D SECTION D-D
NTS

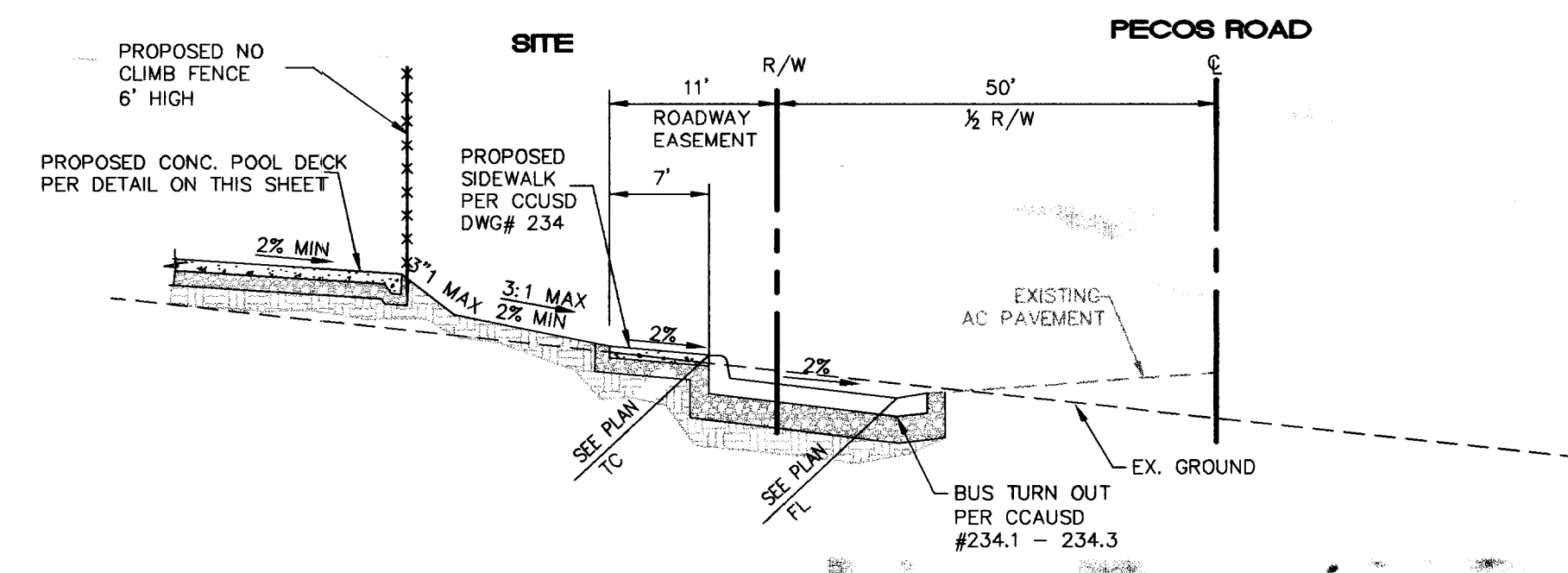

A SECTION A-A
NTS

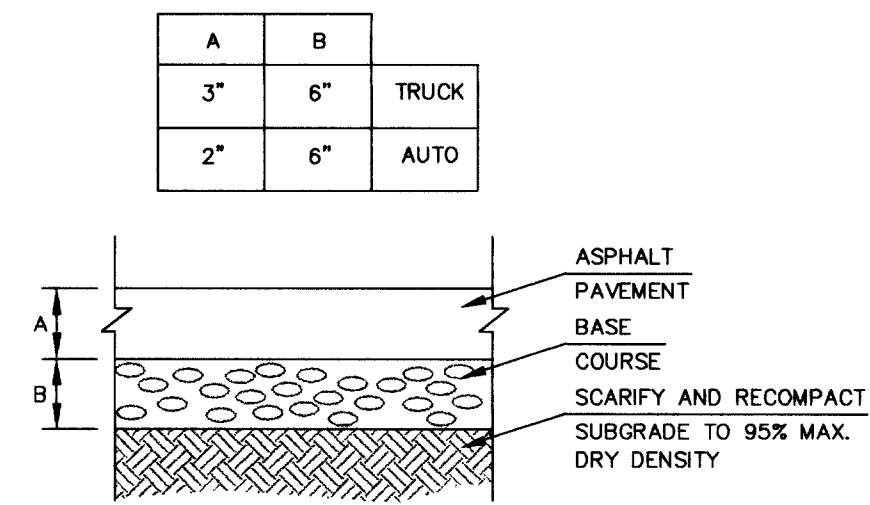

NOTE: 1- REFERENCE GEOTECHNICAL REPORT AND ALL ADDENDA INCLUDED IN PROJECT DOCUMENTS FOR PAVEMENT CONSTRUCTION.
2- CONSTRUCT ALL PARKING STALLS TO AUTO REQUIREMENTS.
CONSTRUCT ALL OTHER AREAS INCLUDING DRIVE AISLES TO TRUCK REQUIREMENTS

AC PAVEMENT SECTION
NTS

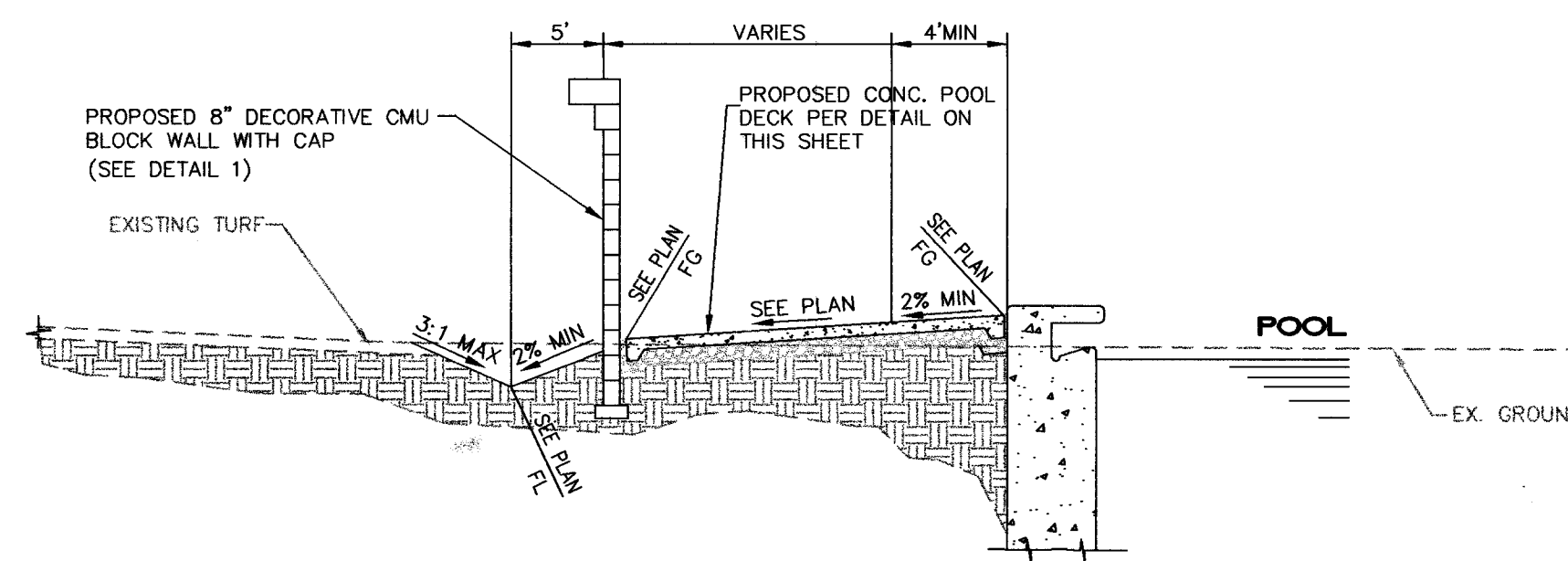

E SECTION E-E
NTS

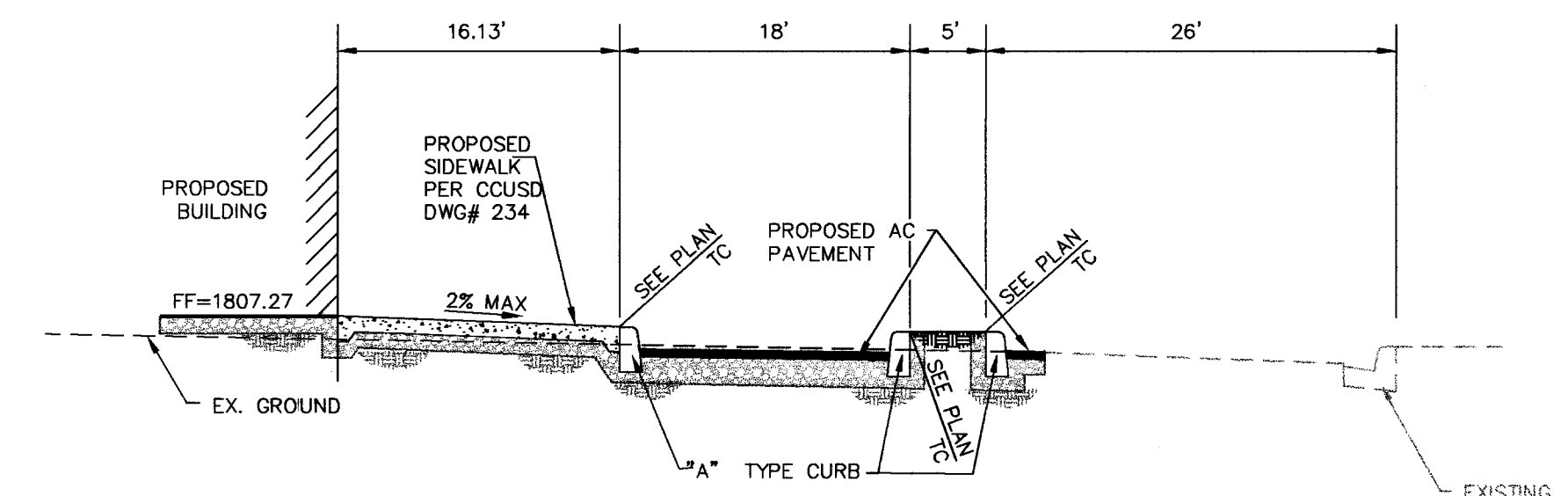

B SECTION B-B
NTS

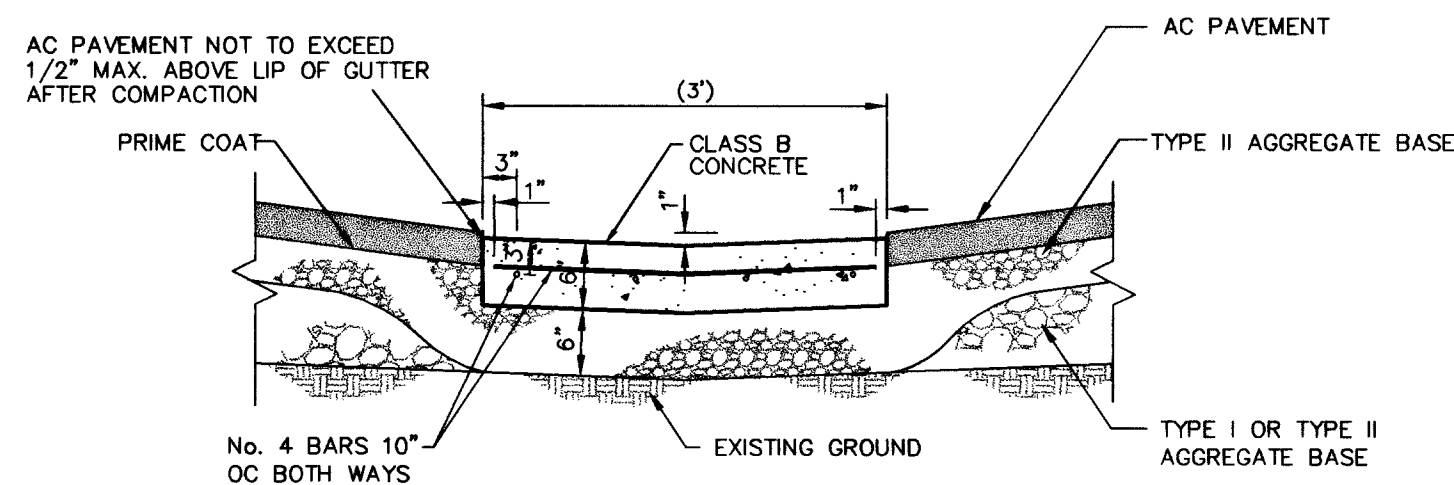

CONSTRUCT 1/2" EXPANSION JOINT AT ALL COLD JOINTS, INTERVALS NOT TO EXCEED 30'. FOR DETAILS NOT SHOWN SEE CADS No. 234. REFER TO SOILS REPORT FOR THICKNESS OF AC STRUCTURAL SECTION.

VALLEY GUTTER DETAIL
NTS

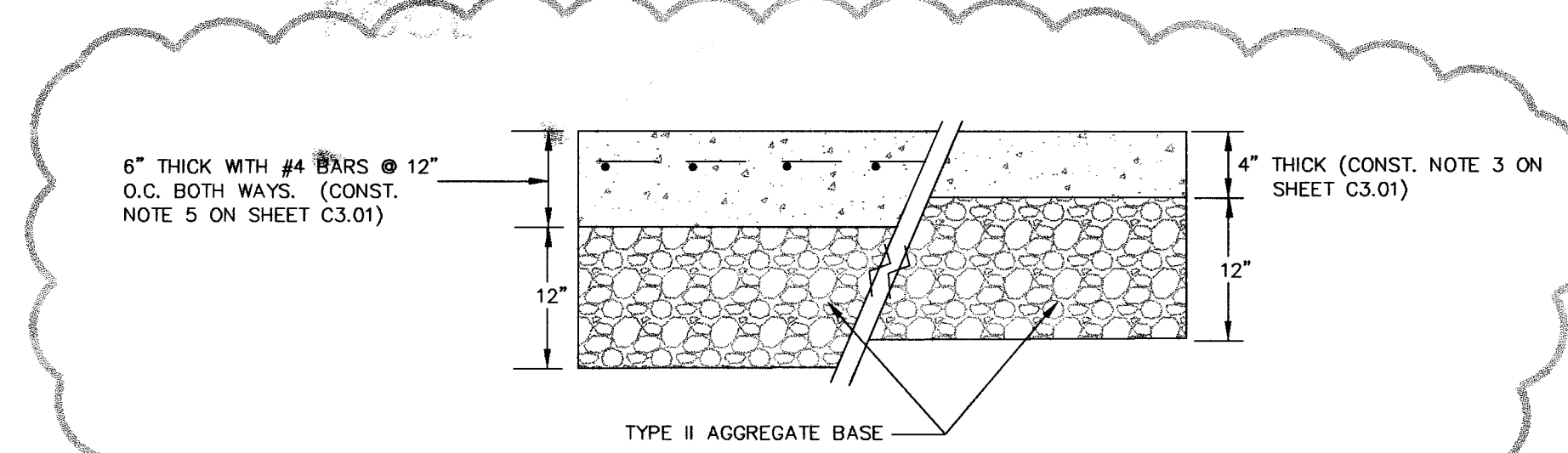

F SITE CONCRETE PAVEMENT SECTION
(SEE CONST. NOTE 5 ON SHEET C3.01) NTS

NOTE: INSTALL EXPANSION JOINTS EVERY 30 FEET CUT CONTROL JOINTS EVERY 5 FEET SQUARE
NOTE: ALL ADA ACCESSIBLE SIDEWALKS AND ROUTES WITHIN THE SITE DEVELOPMENT MUST BE CONSTRUCTED WITH LESS THAN 2.0% CROSS SLOPES.

1

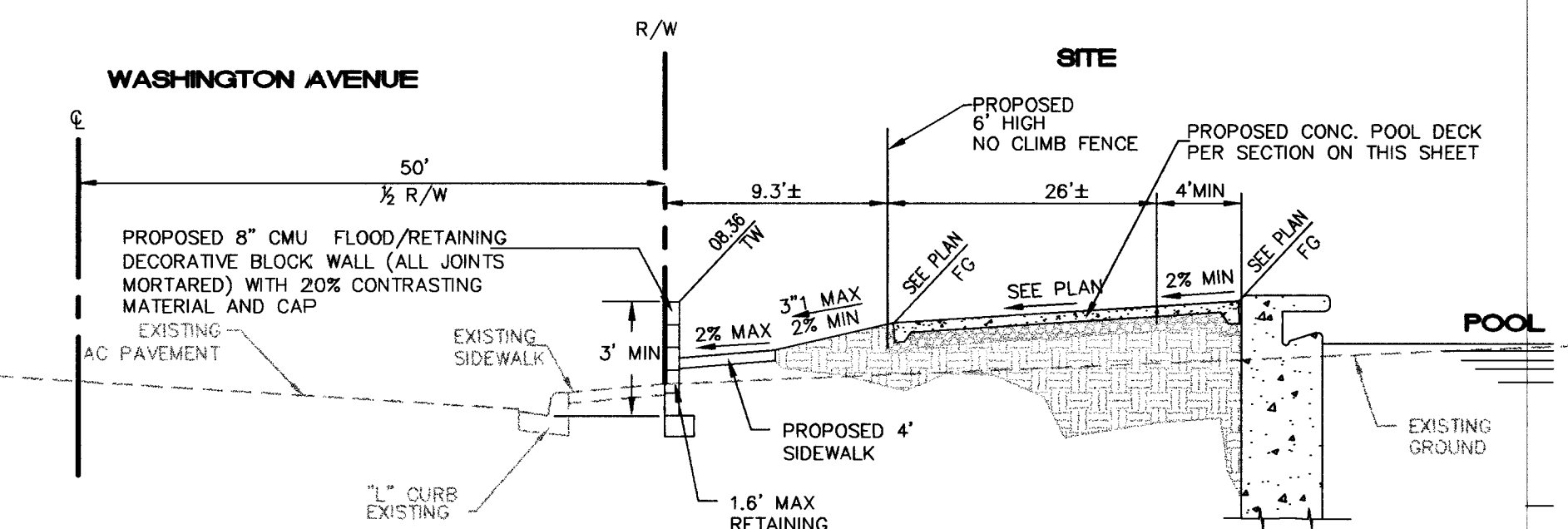

C SECTION C-C
NTS

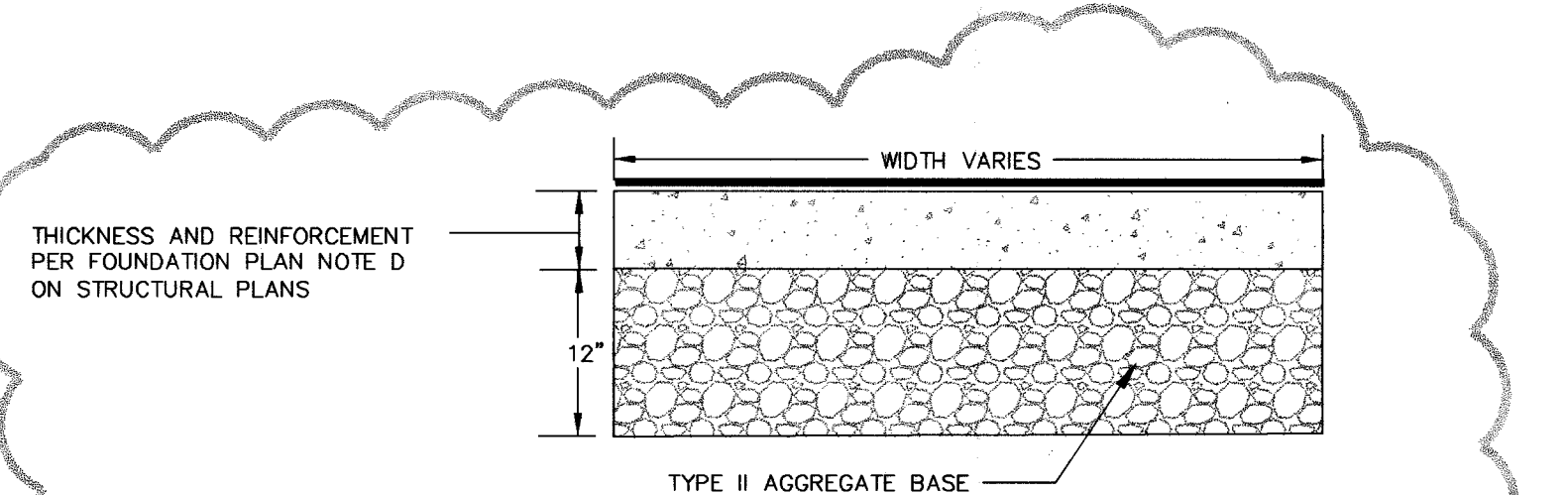

G CONCRETE POOL DECK SECTION
NTS

NOTE: INSTALL EXPANSION JOINTS EVERY 30 FEET CUT CONTROL JOINTS EVERY 5 FEET SQUARE
NOTE: ALL ADA ACCESSIBLE SIDEWALKS AND ROUTES WITHIN THE SITE DEVELOPMENT MUST BE CONSTRUCTED WITH LESS THAN 2.0% CROSS SLOPES.

1

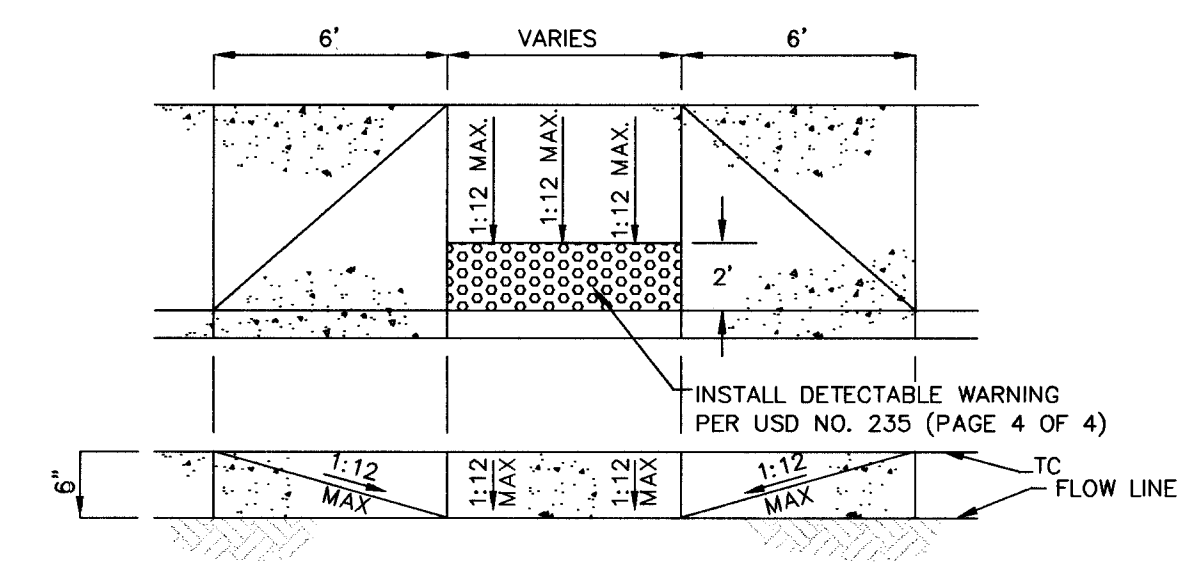

SIDEWALK RAMP
NTS

AVOID CUTTING UNDERGROUND UTILITY LINES. IT'S COSTLY.
Call before you Dig.
1-800-227-2600
UNDERGROUND SERVICE (USA)

AVOID HITTING OVERHEAD POWER LINES. IT'S COSTLY.
CALL BEFORE YOU CRANE
1-702-227-2929

Call before you UnderGround
1-702-455-7511
1-702-229-6611

REVISIONS

10/19/04
CAG 10/11/04 BID ADDENDUM 1

CONSULTANT

ESTAR ARCHITECTS
ARCHITECTURE • PLANNING • INTERIOR DESIGN
3900 MEADOWS LANE SUITE 220 LAS VEGAS, NEVADA 89107
TELEPHONE: (702) 878-0000 FAX: (702) 878-0450
www.wagnarchitects.com

FREEDOM PARK POOL AND BATHHOUSE
WASHINGTON AVE. & PECOS RD.
LAS VEGAS, NV.

100% CONSTRUCTION DOCUMENTS
DETAIL SHEET

STAMP

TIMOTEO S. MORENO
Exp. 12-31-06
CIVIL
Professional Engineer - State of Nevada
No. 10361

OWNER: CITY OF LAS VEGAS
DEPARTMENT OF PUBLIC WORKS
ARCHITECTURAL SERVICES

400 EAST STEWART AVENUE
LAS VEGAS, NEVADA 89101
PHONE: (702) 229-6535
FAX: (702) 382-3232
TDD: (702) 386-9108

DATE: 09-17-04
SCALE: NONE
BID NO: 04.15341.06
CLY DWG NO: 650.22-17

C6.01

2480 E. Tompkins Ave.
Suite # 232
Las Vegas, NV 89121
phone: 702.456.4664
fax: 702.456.4919

INTEGRITY ENGINEERING