

# PARCEL MAP OF FLOYD LAMB STATE PARK

A MERGER AND RESUBDIVISION OF A PORTION OF SECTIONS 3, 4 AND 9, TOWNSHIP 19 SOUTH, RANGE 60 EAST, M.D.M., TOGETHER WITH LOT 9 OF FINAL MAP OF "LOG CABIN RANCH" RECORDED IN BOOK 123 OF MAPS PAGE 88, TOGETHER WITH LOTS 2 AND 3 OF PARCEL MAP RECORDED IN FILE 97 OF PARCEL MAPS, PAGE 46 OF THE CLARK COUNTY, NEVADA OFFICIAL RECORDS.

## OWNER'S CERTIFICATE

THE STATE OF NEVADA, ACTING BY AND THROUGH THE DIVISION OF STATE LANDS, FOR AND ON BEHALF OF THE NEVADA DIVISION OF STATE PARKS DOES HEREBY CERTIFY THAT BEING THE OWNER OF THE LAND WHICH IS SHOWN HEREON, DOES CONSENT TO THE PREPARATION AND RECORDATION OF THIS PARCEL MAP, AND HAS CAUSED THE LAND TO BE SURVEYED AND PLATTED INTO PARCELS AND DOES HEREBY OFFER AND DEDICATE TO THE CITY OF LAS VEGAS, NEVADA, ITS SUCCESSORS AND ASSIGNS, ALL PUBLIC STREETS AND RIGHTS-OF-WAY TO AND FOR THE USE OF THE PUBLIC, AND GRANTS EASEMENTS AS SHOWN HEREON.

FURTHER, THE UNDERSIGNED OWNER HEREBY GRANTS AND CONVEYS TO THE CITY OF LAS VEGAS AND TO ITS SUCCESSORS AND ASSIGNS A FIVE FOOT WIDE EASEMENT ADJACENT TO ALL PROPERTY LINES WHERE LOTS OR COMMON AREAS ABUT PUBLIC STREETS FOR PURPOSES OF PLACING PUBLIC FIRE HYDRANTS AND PUBLIC STREETLIGHTS, TRAFFIC SIGNALS, CONDUITS AND APPURTENANCES, AND AN ADDITIONAL EASEMENT OF UP TO TWO FEET IN RADIUS FROM EACH FIRE HYDRANT AND STREETLIGHT, TRAFFIC SIGNAL, CONDUIT AND APPURTENANCE TO EXTEND BEYOND THE FIVE FOOT EASEMENT IF NECESSARY, TOGETHER WITH THE RIGHT OF INGRESS TO AND EGRESS FROM THESE EASEMENTS.

DATED THIS 10<sup>th</sup> DAY OF May, 2007.

STATE OF NEVADA  
DIVISION OF STATE LANDS

  
PAMELA B. WILCOX  
ADMINISTRATOR AND EX-OFFICIO STATE LAND REGISTRAR

## ACKNOWLEDGMENT

STATE OF NEVADA  
S.S.  
CARSON CITY

THIS INSTRUMENT WAS ACKNOWLEDGED BEFORE ME ON THE 10<sup>th</sup> DAY OF MAY, 2007 BY PAMELA B. WILCOX AS ADMINISTRATOR AND EX-OFFICIO STATE LAND REGISTRAR OF THE STATE OF NEVADA, DIVISION OF STATE LANDS.

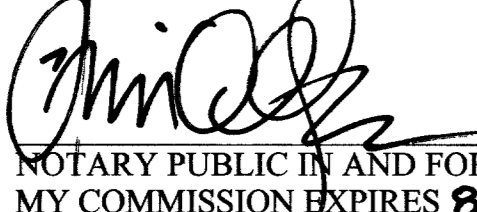
  
NOTARY PUBLIC IN AND FOR SAID COUNTY AND STATE  
MY COMMISSION EXPIRES 8-3-2008

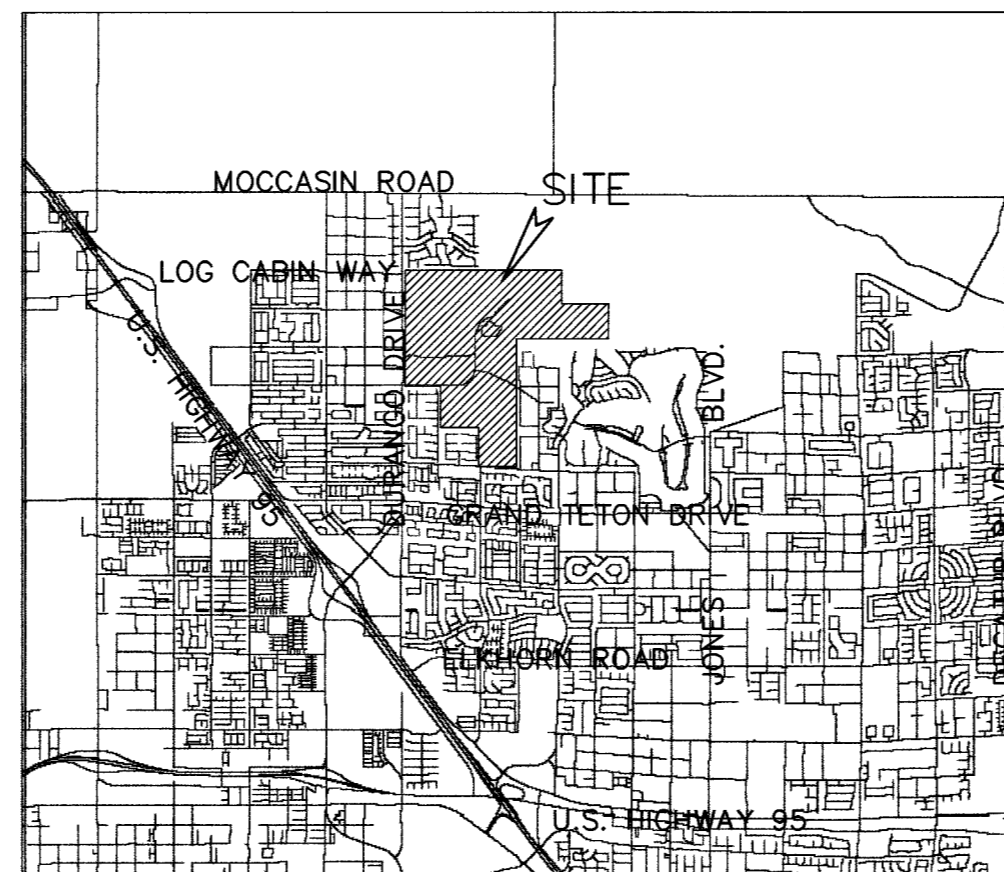
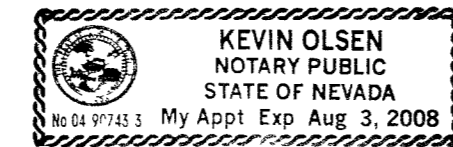

VICINITY MAP  
NOT TO SCALE

## SURVEYOR'S CERTIFICATE

I, ALAN R. RIEKKI, A PROFESSIONAL LAND SURVEYOR LICENSED IN THE STATE OF NEVADA, AS AN AGENT FOR THE CITY OF LAS VEGAS, CERTIFY THAT:

1. THIS MAP REPRESENTS THE RESULTS OF A SURVEY CONDUCTED UNDER MY DIRECT SUPERVISION AT THE INSTANCE OF THE CITY OF LAS VEGAS.
2. THE LANDS SURVEYED LIE WITHIN SECTIONS 3, 4 AND 9, TOWNSHIP 19 SOUTH, RANGE 60 EAST, M.D.M., CLARK COUNTY, NEVADA AND THE SURVEY WAS COMPLETED ON DECEMBER 28, 2006.
3. THIS PLAT COMPLIES WITH THE APPLICABLE STATE STATUTES AND ANY LOCAL ORDINANCES IN EFFECT ON THE DATE THAT THE LOCAL GOVERNMENT GAVE ITS FINAL APPROVAL.
4. THE MONUMENTS DEPICTED ON THE PLAT ARE OF THE CHARACTER SHOWN, OCCUPY THE POSITIONS INDICATED AND ARE OF SUFFICIENT NUMBER AND DURABILITY.

ALAN R. RIEKKI, PLS  
NEVADA CERTIFICATE NO. 12469  
EXPIRATION DATE: 12-31-2007

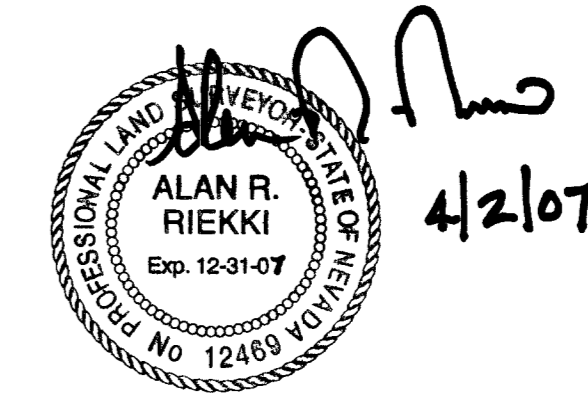

## CERTIFICATE OF CITY ENGINEER

I, JORGE CERVANTES, CITY ENGINEER OF THE CITY OF LAS VEGAS, DO HEREBY CERTIFY THAT I HAVE EXAMINED THIS PARCEL MAP AND AM SATISFIED THAT THE MAP IS TECHNICALLY CORRECT.

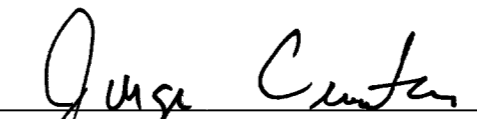
  
JORGE CERVANTES, P.E. # 13977, P.T.O.E.  
CITY ENGINEER  
CITY OF LAS VEGAS

5-21-07  
DATE

## CERTIFICATE OF DIRECTOR OF PLANNING AND DEVELOPMENT

I CERTIFY THAT THE DIRECTOR OF PLANNING AND DEVELOPMENT, CITY OF LAS VEGAS, ON THE 23<sup>rd</sup> DAY OF MAY, 2007, DID APPROVE FOR THE PURPOSES OF LAND DIVISION AND ACCEPT IN BEHALF OF THE PUBLIC, THIS MAP AND ANY PARCELS OFFERED FOR DEDICATION FOR THE PUBLIC USE IN CONFORMITY WITH THE TERMS OF THE OFFER OF DEDICATION PER NEVADA REVISED STATUTES AND ANY APPLICABLE LOCAL ORDINANCES.

  
M. MARGO WHEELER, AICP  
DIRECTOR OF PLANNING AND DEVELOPMENT  
CITY OF LAS VEGAS

DATE 05/23/07

## REFERENCES

### BASIS OF BEARINGS:

N 89°34'57" W, BEING THE GRID BEARING BETWEEN CLARK COUNTY GIS CONTROL POINTS 801 AND 802 AS SHOWN ON A RECORD OF SURVEY IN FILE 88, PAGE 53 OF SURVEYS, OFFICIAL RECORDS, CLARK COUNTY, NEVADA.

### RECORDER'S NOTE:

ANY SUBSEQUENT CHANGES TO THIS MAP SHOULD BE EXAMINED AND MAY BE DETERMINED BY REFERENCE TO THE COUNTY RECORDER'S CUMULATIVE MAP INDEX NRS 278.5695.

| PLAT MAPS |      | PARCEL MAPS |      | RECORDS OF SURVEY |      |
|-----------|------|-------------|------|-------------------|------|
| BOOK      | PAGE | FILE        | PAGE | FILE              | PAGE |
| 95        | 73   | 8           | 56   | 17                | 22   |
| 96        | 21   | 97          | 46   | 28                | 30   |
| 98        | 65   |             |      | 28                | 92   |
| 100       | 30   |             |      | 30                | 43   |
| 103       | 31   |             |      | 32                | 26   |
| 112       | 100  |             |      | 53                | 74   |
| 117       | 97   |             |      | 73                | 14   |
| 118       | 40   |             |      | 93                | 13   |
| 123       | 88   |             |      | 95                | 76   |
| 125       | 67   |             |      |                   |      |
| 129       | 33   |             |      |                   |      |

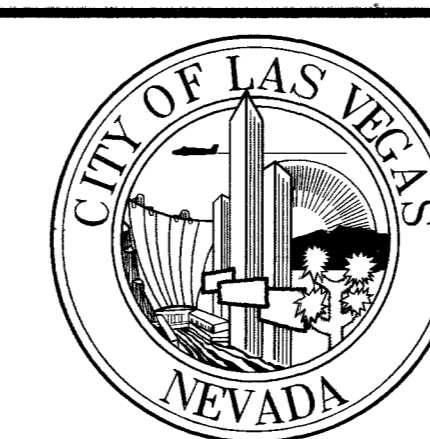

3001 RONEMUS DRIVE  
LAS VEGAS, NV 89128  
TEL: (702) 229-6217

PARCEL MAP OF  
**FLOYD LAMB STATE PARK**  
A MERGER AND RESUBDIVISION OF A PORTION OF SECTIONS 3, 4 AND 9, TOWNSHIP 19 SOUTH, RANGE 60 EAST, M.D.M., TOGETHER WITH LOT 9 OF FINAL MAP OF "LOG CABIN RANCH" RECORDED IN BOOK 123 OF MAPS PAGE 88, TOGETHER WITH LOTS 2 AND 3 OF PARCEL MAP RECORDED IN FILE 97 OF PARCEL MAPS, PAGE 46 OF THE CLARK COUNTY, NEVADA OFFICIAL RECORDS.

NO. 4619  
FILED AT THE REQUEST OF  
THE CITY OF LAS VEGAS  
DATE: 6-19-07 TIME 10:50  
FILE 114, PAGE 0014  
OF PARCEL MAPS  
OFFICIAL RECORDS  
BOOK NO. 20070619  
CLARK COUNTY, NEVADA  
RECORDS  
DEBBIE CONWAY RECORDER  
FEE 41<sup>00</sup> DEPUTY 642

PMP 17368  
SHEET 1 OF 3