

NOTE:
THE PIPELINE ROUTE INTO
MULBERRY POND WILL BE
USED AS THE ONLY EQUIP-
MENT ACCESS TO AND FROM
THE POND. ALL EXISTING
LANDSCAPE, TURF, AC WALKS,
CONC. CURBS, WATERLINES,
ETC. THAT ARE DAMAGED
SHALL BE REPLACED TO
ORIGINAL OR BETTER CONDITION.

NOTE:
GRADES 39-54 ARE PROPOSED.
SEE SHEET 2 FOR TYPICAL
SECTION A-A.

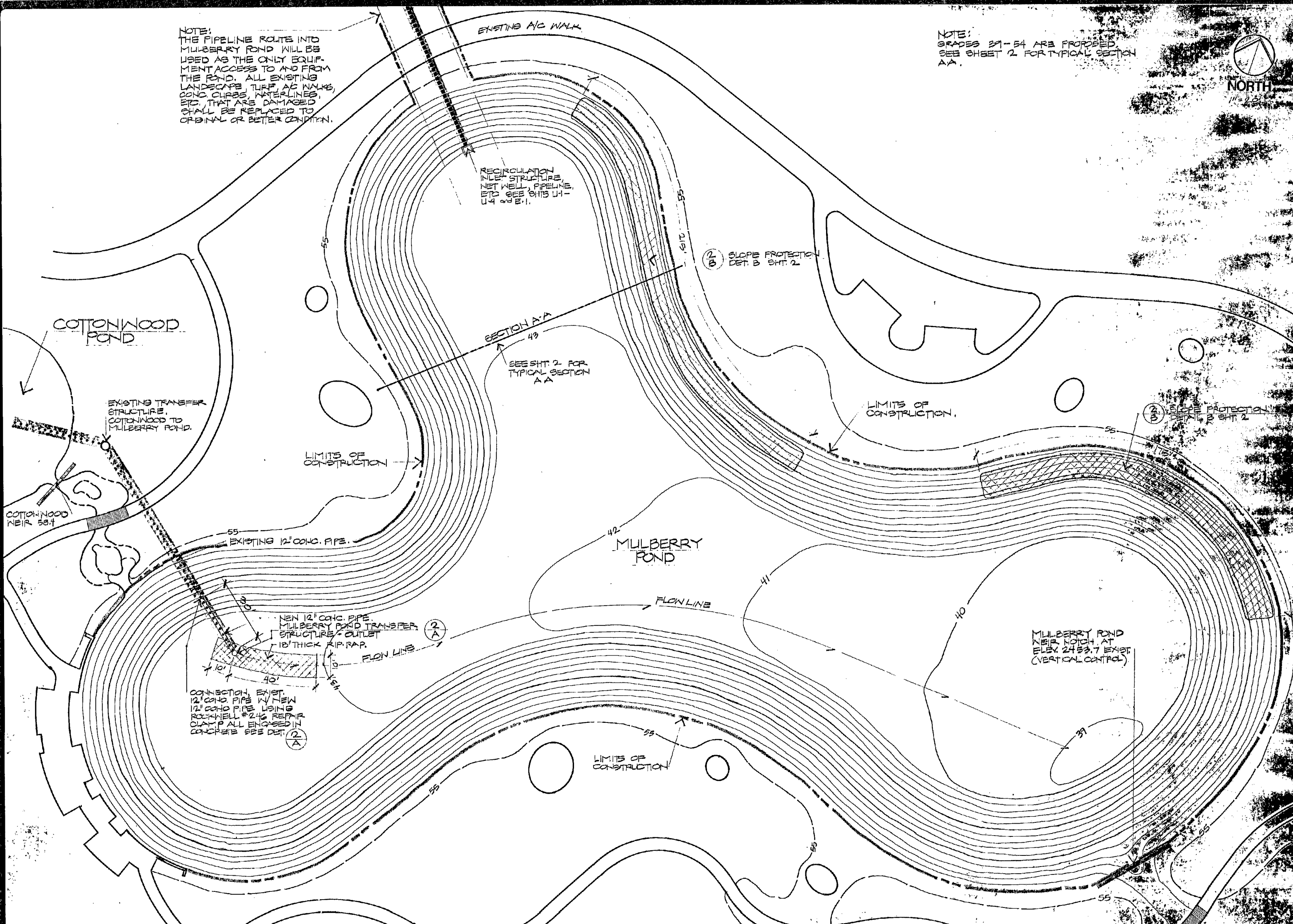

RECIRCULATION
NET STRUCTURE,
NET WELL, PIPELINE,
ETC. SEE SHS LH-1
L-4 & E-1.

(2) SLOPE PROTECTION
DET. D SHIT 2

SECTION A-A
49
SEE SHIT 2 FOR
TYPICAL SECTION
A-A

LIMITS OF
CONSTRUCTION.

(2) SLOPE PROTECTION
DET. D SHIT 2

EXISTING TRANSFER
STRUCTURE,
COTTONWOOD TO
MULBERRY POND.

LIMITS OF
CONSTRUCTION

COTTONWOOD
NEAR 53.1

EXISTING 12" CONC. PIPE.

MULBERRY
POND

FLOW LINE

NEW 12" CONC. PIPE
MULBERRY POND TRANSFER
STRUCTURE OUTLET
18" THICK RIP RAP

CONNECTION EXIST.
12" CONC. PIPE W/ NEW
12" CONC. PIPE LIGNING
ROCKWELL #246 REPAIR
CLAMP ALL ENCASED IN
CONCRETE SEE DET.

MULBERRY POND
NEAR NOTCH AT
ELEV. 2453.7 EXIST.
(VERTICAL CONTROL)

LIMITS OF
CONSTRUCTION

FILE NO. 12-151-53-5 44-0
PROJ. NO. 12-151-53-5 44-0
PROJ. COORD. [Signature] DATE
UNIT SUPV. [Signature] INITIAL
ASST. ADM. [Signature] PRED.
ADM. ADMIN. [Signature] O&M

MULBERRY POND PLAN

DEPARTMENT OF CONSERVATION, ORIGINAL RESOURCES
NEVADA DIVISION
OF STATE PARKS
SPECIAL COMPLEX, CARSON CITY, NEVADA 89710