

- NOTES:
1. LOCATION OF NATURAL SEWER LINES ARE APPROXIMATE AND MUST BE VERIFIED IN THE FIELD WITH THE PARK MAINTENANCE SUPERVISOR. ALL SINKS MUST BE CLEANED AND TRAPPED.
 2. CONTRACTOR SHALL REMOVE A MINIMUM OF 10 FEET ON EACH SIDE OF ALL ASPHALT AND CONCRETE WHEN TRENCHING AND REPLACE AS REQUIRED OR REMOVE AND REPLACE AS DIRECTED BY THE ENGINEER.

NOTE:
 ALL POWER & TELEPHONE LINE LOCATIONS ARE APPROXIMATE AND MUST BE VERIFIED IN THE FIELD WITH THE APPROPRIATE UTILITY COMPANY PRIOR TO START OF TRENCHING.

CENTEL COMMUNICATIONS CO.
 702.305.5121
 NEVADA POWER CO.
 702.386.1700

RECIRCULATION PIPELINE LAYOUT STA. 2+00 THRU 9+42
 SCALE: 1" = 30'

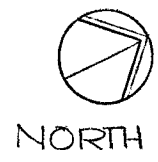

MATCH LINE STA. 9+80
 SEE SHEET U-3
 FOR CONTINUATION

MATCH LINE STA. 2+00
 SEE SHEET U-1
 FOR CONTINUATION

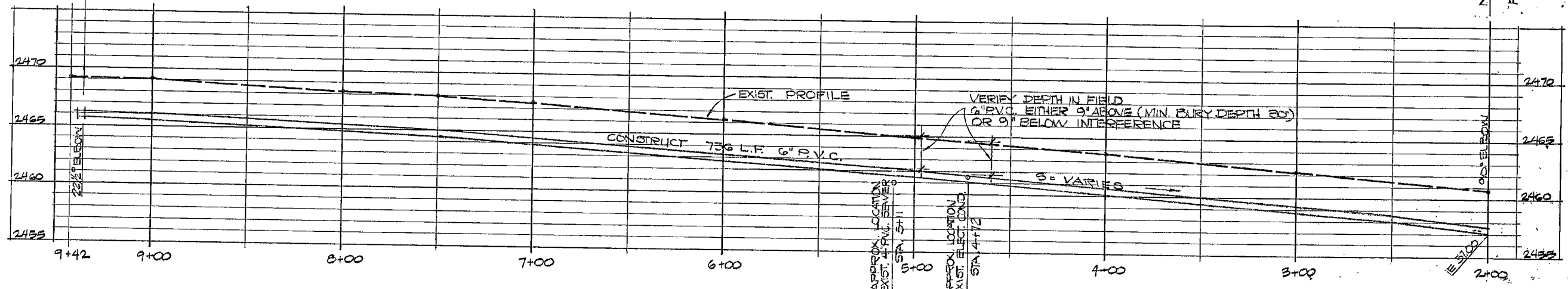

RECIRCULATION PIPELINE PROFILE
 SCALE: HORIZONTAL - 1" = 30'
 VERTICAL - 1" = 20'

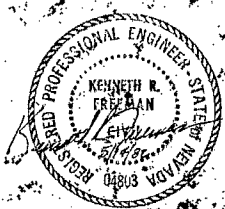

DATE	REVISIONS
MAY 03	

FILE NO.	DATE
EL 0103-B-449-0	02/02/04
PROJ. NO.	INITIAL
22-02-00147	MM
PROJ. COORD.	DATE
EEC MASHIN	
UNIT SUPV.	
ASST. ADM. P&M	
ASST. ADM. O&M	
DIV. ADMIN.	

FLOOD LAMB STATE PARK - PHASE III
 RECIRCULATION PIPELINE
 PLAN & PROFILE

DEPARTMENT OF CONSERVATION AND NATURAL RESOURCES
 NEVADA DIVISION
 OF STATE PARKS
 CAPITOL COMPLEX CARSON CITY NEVADA 89710