

NOTE: PLANTING IS PART OF ADDITIVE ALTERNATE #2

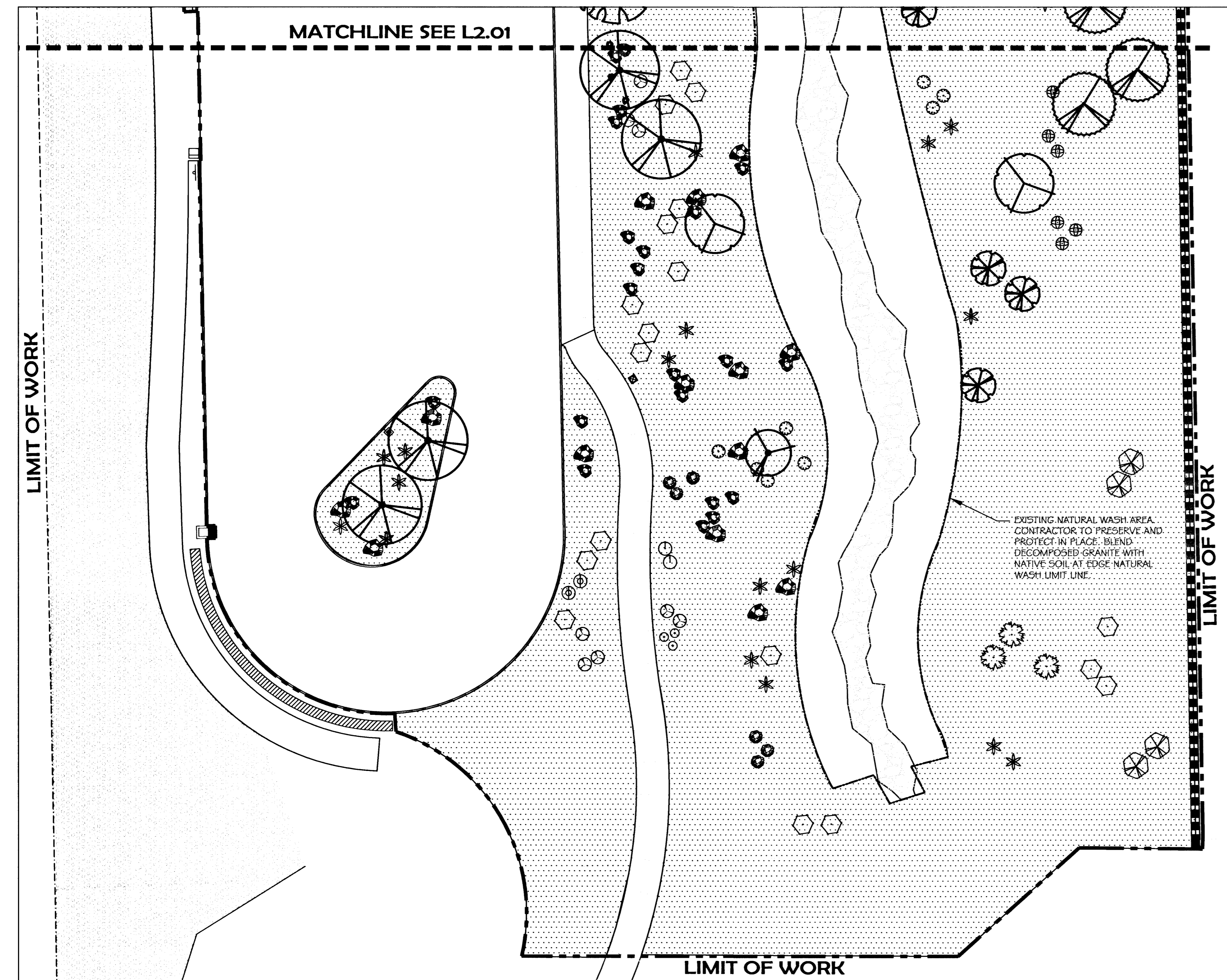

PLANTING LEGEND

SYMBOL	BOTANICAL-COMMON NAME
TREES	
	ACACIA ANEURA MULGA TREE
	ACACIA GREGGII CAT CLAW ACACIA
	ACACIA STENOPHYLLA - MULTI SHOESTRING ACACIA
	CHILOPSIS LINEARIS 'LUCRETIA HAMILTON' - MULTI LUCRETIA HAMILTON DESERT WILLOW
	CHILOPSIS LINEARIS 'RIO SALADO' - MULTI RIO SALADO DESERT WILLOW
	FRAXINUS VELLUTINA ARIZONA ASH
	FRAXINUS VELLUTINA 'RIO GRANDE' FAN-TEX ASH
	GLEDITSIA TRIACANTHOS 'SHADEMASTER' SHADEMASTER HONEY LOCUST
	PARKINSONIA HYBRID 'DESERT MUSEUM'-MULTI DESERT MUSEUM PALO VERDE
	VITEX AGNUS-CASTUS-MULTI CHASTE TREE
	YUCCA BREVIFOLIA JOSHUA TREE

SYMBOL	DESCRIPTION
SHRUBS	
	ATRIPLEX CANESCENS FOUR-WING SALTBUCH
	ANISACANTHUS THURBERI DESERT HONEYSUCKLE
	ACACIA REDOLENS 'DESERT CARPET' CREEPING ACACIA
	BUDDLEIA MARRUBIFOLIA WOOLLY BUTTERFLY BUSH
	CAESALPINIA GILLIESII YELLOW BIRD OF PARADISE
	DALEA GREGGII INDIGO BUSH
	ENCELIA FARINOSA BRITTLEBUSH
	EPHEDRA VIRIDIS MORMON TEA
	HESPERALOE PARVIFLORA RED HESPERALOE
	LANтана SPECIES 'NEW GOLD' NEW GOLD LANTANA
	LARREA TRIDENTATA CREOSOTE BUSH
	LEUCOPHYLLUM LAEVIGATUM CHIHUAHUA RAIN SAGE
	LEUCOPHYLLUM ZYGOPHYLLUM 'CIMARRON' CIMARRON SAGE
	MUHLENBERGIA RIGENS DEER GRASS

SYMBOL	DESCRIPTION
DESERT SHRUBS	
	AGAVE AMERICANA 'MARGINATA' VARIEGATED CENTURY PLANT
	AGAVE VICTORIAE-REGINAE QUEEN VICTORIA AGAVE
	FOUQUIERIA SPLENDENS OCOTILLO
	GAURA LINDHEIMERI GAURA
	PENSTEMON EATONII FIRECRACKER PENSTEMON
	YUCCA ROSTRATA CHIHUAHUA DESERT TREE
	YUCCA SCHIDIGERA (SALVAGED & RELOCATED) MOJAVE YUCCA (SEE SALVAGE NOTE)

SYMBOL	DESCRIPTION
CACTI	
	ECHINOCACTUS GRUSONII GOLDEN BARREL CACTUS
	OPUNTIA BASILARIS (SALVAGED & RELOCATED) BEAVERTAIL CACTUS (SEE SALVAGE NOTE)
	ECHINOCEREUS ENGELMANNII (SALVAGED & RELOCATED) HEDGEHOG CACTUS (SEE SALVAGE NOTE)
	FEROCACTUS ACANTHODES (SALVAGED & RELOCATED) COMPASS BARREL CACTUS (SEE SALVAGE NOTE)

GROUNDCOVERS LEGEND

SYMBOL	BOTANICAL-COMMON NAME
	LANDSCAPE BOULDERS: COLOR TO MATCH DECOMPOSED GRANITE. AVAILABLE THROUGH MINERAL PARK DECORATIVE ROCK. SIZES TO VARY, ACCORDING TO FOLLOWING PERCENTAGES: 25% 2'X2'X3' 40% 3'X3'X4' 30% 4'X4'X5' 5% 5'X5'X5' SEE SHEET LG.01 FOR APPROXIMATE BOULDER QUANTITIES. QUANTITIES DO NOT INCLUDE BOULDER WALLS.
	RIP-RAP PER CIVIL DRAWINGS. COLOR TO MATCH DECOMPOSED GRANITE. CONTRACTOR TO PROVIDE SAMPLE FOR APPROVAL.

NOTES:

- 1) PROVIDE NATIVE REVEGETATION IN ALL PLANTING AREAS.
- 2) SEE SHEET LG.01 FOR PLANT SIZES, QUANTITIES AND DETAILS.
- 3) ALL MULTI-TRUNK TREES ARE TO HAVE 3 TO 4 TRUNKS. THE LOWEST HORIZONTAL BRANCHING PATTERN FROM ANY TRUNK ON ONE TREE SHALL BE A MINIMUM OF 30" FROM FINISH GRADE.
- 4) EACH JOSHUA TREE AND OCOTILLO MUST NOT BE PLANTED DEEPER THAN THE PLANT'S ORIGINAL PLANTED DEPTH.
- 5) CONTRACTOR TO PRESERVE AND PROTECT EXISTING AND NATIVE LANDSCAPE OUTSIDE LIMIT OF WORK.
- 6) TREES ADJACENT TO HORSE TRAIL TO BE PRUNED REGULARLY TO ALLOW FOR SAFE PASSAGE OF HORSE AND RIDER.
- 7) MAINTAIN MINIMUM COVERAGE ABOVE SUBSURFACE DRAINAGE CULVERT. SEE CIVIL DRAWINGS.

NATIVE REVEGETATION LEGEND

SYMBOL	DESCRIPTION
	NATIVE REVEGETATION. SEE BELOW.
	THE ABOVE PHOTOS ARE EXAMPLES OF THE INTENT OF THE NATIVE REVEGETATION. THE ABOVE PHOTOS WERE TAKEN ADJACENT TO THE PROPOSED SITE.

NATIVE REVEGETATION AT 50% TO NATIVE IS TO BE SIMILAR TO THE ADJACENT EXISTING CONDITIONS OF BLUES RIDGE ROCK CONSERVATION AREA. NATIVE REVEGETATION TO BE INSTALLED BY NATIVE RESOURCES OR APPROVED EQUAL.

NATIVE RESOURCES: 5375 S. CAMERON DRIVE, SUITE L, LAS VEGAS, NV 89118  
PHONE: (702) 873-2023  
CONTACT: BRIAN VELLINGA

NATIVE RESTORATION TO INCLUDE THE FOLLOWING:  
NATIVE ROCK  
NATIVE PLANTING  
NATIVE SEEDING  
NATIVE PLANT SALVAGE AND PLACEMENT  
ROCK COLOR RESTORATION (PERMEON)  
PLANT ESTABLISHMENT (HAND WATERING AND MAINTENANCE)  
BOULDER PLACEMENT NEAR TREES (PERMEON)

NATIVE REVEGETATION NOTES:  
1) CONTRACTOR TO CONTACT NATIVE RESTORATION TEAM PRIOR TO CONSTRUCTION.  
2) CONTRACTOR TO SALVAGE AND STOCKPILE NATIVE ROCK FOR USE IN NATIVE RESTORATION PER NATIVE RESTORATION TEAM.  
3) CONTRACTOR TO PROVIDE NO SOIL PREPARATION IN NATIVE RESTORATION AREAS.  
4) CONTRACTOR TO PROVIDE NO PRE-EMERGENT HERBICIDE IN AREAS TO HAVE NATIVE RESTORATION.

**RECORD DRAWINGS  
NOT FOR CONSTRUCTION**

1. TO ALTER THESE DOCUMENTS FOR ANOTHER PROJECT BY ANYONE OTHER THAN THE ORIGINAL ARCHITECT IS A VIOLATION OF NRS 623.

2. THIS RECORD DRAWING HAS BEEN PREPARED IN PART, BASED UPON INFORMATION FURNISHED BY THE GENERAL CONTRACTOR. WHILE THIS INFORMATION IS BELIEVED TO BE RELIABLE, THE DESIGN PROFESSIONAL CANNOT ASSURE ITS ACCURACY, AND THIS IS NOT RESPONSIBLE FOR THE ACCURACY OF THIS RECORD DRAWING OR FOR ANY ERRORS OR OMISSIONS WHICH MAY HAVE BEEN INCORPORATED INTO IT AS A RESULT. THE DESIGN PROFESSIONAL CANNOT AND DOES NOT WARRANT THEIR ACCURACY.

3. INFORMATION THAT MAY BE INCLUDED WOULD BE SIGNIFICANT CHANGES TO PLANTING OR IRRIGATION LAYOUT PLANS AND ASSOCIATED DRAWINGS, MINOR DIMENSION OR CONSTRUCTION DETAIL CHANGES MAY NOT BE INCLUDED.

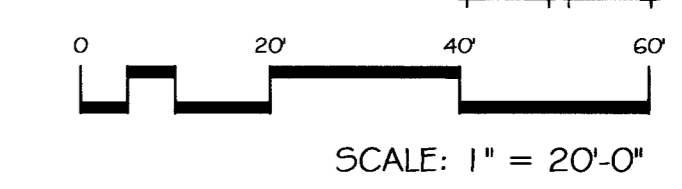

REVISIONS

CITY COMMENTS

RECORD DWG

CONSULTANT

**SOUTHWEST LANDSCAPE ARCHITECTS**  
12 Commerce Center Plaza  
Suite 204  
Henderson, NV 89004  
Phone: 702.597.3088  
Fax: 702.597.3177

City of Las Vegas  
Gilmore Cliff Shadows Trail Head  
PLANTING PLAN  
(ADDITIVE ALTERNATE #2)

OWNER: CITY OF LAS VEGAS  
DEPARTMENT OF PUBLIC WORKS  
ARCHITECTURAL SERVICES

400 EAST STEWART AVENUE  
LAS VEGAS, NEVADA 89101  
PHONE: (702) 229-6535  
FAX: (702) 384-4846  
TDD: (702) 386-9108

DRAWN: 6E/WCD  
FILE: L04-093T  
DATE: SEPTEMBER 2006  
SCALE: AS SHOWN  
SHEET NO: 06.1534.11  
CLV DWG NO: 65083  
SHEET NO: L2.02

108601