

**BLM RED ROCK CONSERVATION AREA**  
 NO WORK IS TO ENCRANCH UPON THE BLM RED ROCK CONSERVATION AREA. KEEP ALL WORK, EQUIPMENT AND PERSONNEL WITHIN THE GILMORE CLIFF SHADOWS PARK AND TRAIL HEAD AT ALL TIMES. DISTURBANCES OF ANY KIND TO THE BLM RED ROCK CONSERVATION AREA CAN RESULT IN SUBSTANTIAL FINES. CONTRACTOR IS RESPONSIBLE FOR THE LOCATION AND MAINTENANCE OF BOUNDARY LINE LOCATION.

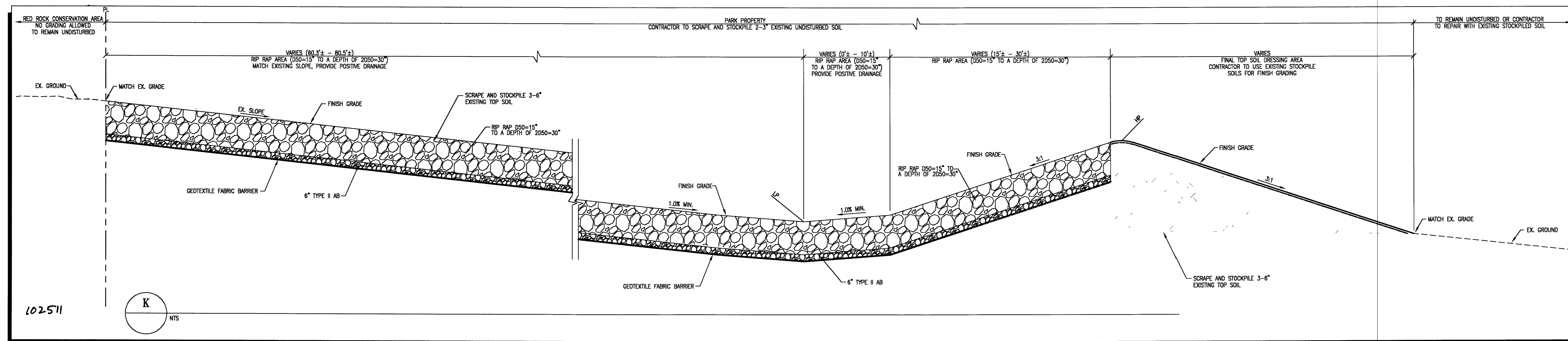

Use of the information contained in this instrument for other than the specific purpose for which it was intended and for other than the client for whom it was prepared is forbidden unless expressly permitted in writing in advance by t&grf Civil Engineering, and t&grf Civil Engineering shall have no liability to any use of this information without their written consent.

Avoid cutting underground utility lines. It's costly.  
**Call before you Dig**  
 1-800-227-2600  
 UNDERGROUND SERVICE ALERT (U.S.A.)

Avoid overhead power line contact.  
**Call before you CRANE**  
 1-702-593-6111  
 NEVADA POWER ENVIRONMENT & SAFETY SERVICES DEPARTMENT

**NOTICE!**  
 EXISTING UTILITIES ARE LOCATED ON THE PLANS FOR THE CONVENIENCE OF THE CONTRACTOR ONLY. THE ENGINEER BEARS NO RESPONSIBILITY FOR THE LOCATION OF UTILITIES SHOWN OR NOT SHOWN ON THE PLANS. THE CONTRACTOR SHALL NOTIFY ALL UTILITY COMPANIES BEFORE STARTING CONSTRUCTION AND IT SHALL BE THE RESPONSIBILITY OF THE CONTRACTOR TO VERIFY THE LOCATION OF ALL UTILITIES WITH THE UTILITY COMPANIES.

Avoid cutting underground utility lines. It's costly.  
**CALL BEFORE YOU Dig**  
 1-800-227-2600  
 UNDERGROUND SERVICE (USA)

- SITE NOTES:**
- 1) CONTRACTOR RESPONSIBLE FOR THE LOCATION AND MAINTENANCE OF BOUNDARY LINE LOCATION. NO WORK TO ENCRANCH UPON THE BLM RED ROCK CONSERVATION AREA. KEEP ALL WORK EQUIPMENT AND PERSONNEL WITHIN THE GILMORE CLIFF SHADOWS TRAIL HEAD BOUNDARY/PROPERTY AT ALL TIMES. ENCRANCHMENT AND/OR DISTURBANCE TO THE BLM AREA CAN RESULT IN SUBSTANTIAL FINES.
  - 2) CONTRACTOR TO PROVIDE DUST CONTROL DURING AND UPON COMPLETION OF WORK.
  - 3) PROTECT EXISTING PLANTS DURING CONSTRUCTION. REFER TO LANDSCAPE ARCHITECTS PLANS.
  - 4) CONTRACTOR TO SCRAPE AND STOCKPILE THE TOP 3"-6" OF EXISTING NATIVE UNDISTURBED SOIL WITH ASSOCIATED PLANT MATERIAL (OTHER THAN SALVAGED PLANT MATERIAL) WITHIN THE LIMIT OF WORK, OVER ALL SURFACES TO BE DISTURBED BY CONSTRUCTION. STOCKPILE COLLECTED TOPSOIL MATERIAL WITHIN LIMIT OF WORK. STOCKPILED SOIL WITH PLANT DEBRIS TO BE REINSTALLED. STOCKPILED SOIL IS TO BE EVENLY DISTRIBUTED OVER ALL DISTURBED AREAS. BEFORE STOCKPILED SOIL IS REINSTALLED, FINE GRADE EARTH TO BE REMOVE UNUSUAL IRREGULARITIES. REINSTALL STOCKPILED TOPSOIL OVER ALL DISTURBED AREAS AND LIGHTLY RAKE SURFACE TO RESTORE NATURAL CONDITION. APPLY ECO-TEX SOIL BINDER PER MANUFACTURER'S RECOMMENDATION AND SPECIFICATIONS (702) 873-2033. DO NOT APPLY A PRE-EMERGENT OR ROCK MULCH AREAS THAT ARE TO RECEIVE THE STOCKPILED SOIL.

**CONTRACTOR NOTE:**  
 PRIOR TO ANY CONSTRUCTION, THE CONTRACTOR SHALL SCRAPE AND STOCKPILE THE TOP 3"-6" OF EXISTING UNDISTURBED SOIL WITHIN THE LIMITS OF THE PROPOSED WORK AREA. CONTRACTOR TO LOCATE AND STOCKPILE THIS SCRAPED EXISTING UNDISTURBED SOIL ON-SITE IN AN AREA AGREED UPON BY CONTRACTOR AND OWNER PROVIDING EASE OF ACCESS TO AND LEAST AMOUNT OF DISTURBANCE TO THE SITE.  
 CONTRACTOR TO USE SCRAPED STOCKPILED SOIL AS FINAL TOP DRESSING IN AREAS NOT COVERED WITH RIP-RAP, CONCRETE, ASPHALT, OR COMPACTED GRAVEL PATHWAYS. STOCKPILED SOIL CONTAINS DORMANT SEEDS FOR RE-VEGETATION OF NATIVE PLANTS.

REVISIONS  
 CONSULTANT  
**t&grf**  
 CIVIL ENGINEERING  
 1231 DARMARK DRIVE  
 LAS VEGAS, NV 89102  
 PHONE: 702-670-2660  
 FAX: 702-670-6053

GOWAN LONE MOUNTAIN SYSTEM  
 CLIFF SHADOWS PARK  
 SECTIONS AND DETAILS



OWNER: CITY OF LAS VEGAS  
 DEPARTMENT OF PUBLIC WORKS  
 ARCHITECTURAL SERVICES

400 EAST STEWART AVENUE  
 LAS VEGAS, NEVADA 89101  
 PHONE: (702) 229-6535  
 FAX: (702) 384-4846  
 TDD: (702) 386-9108

DRAWN: gfr  
 FILE: C401004arch  
 DATE: DECEMBER 2006  
 SCALE: NA  
 SHEET NO.: 65083  
 CVDWGNO:  
 SHEET NO.:  
**C4.01**

102511