

**SANITARY SEWER 1 - PLAN VIEW**  
HORIZONTAL SCALE: 1" = 30'

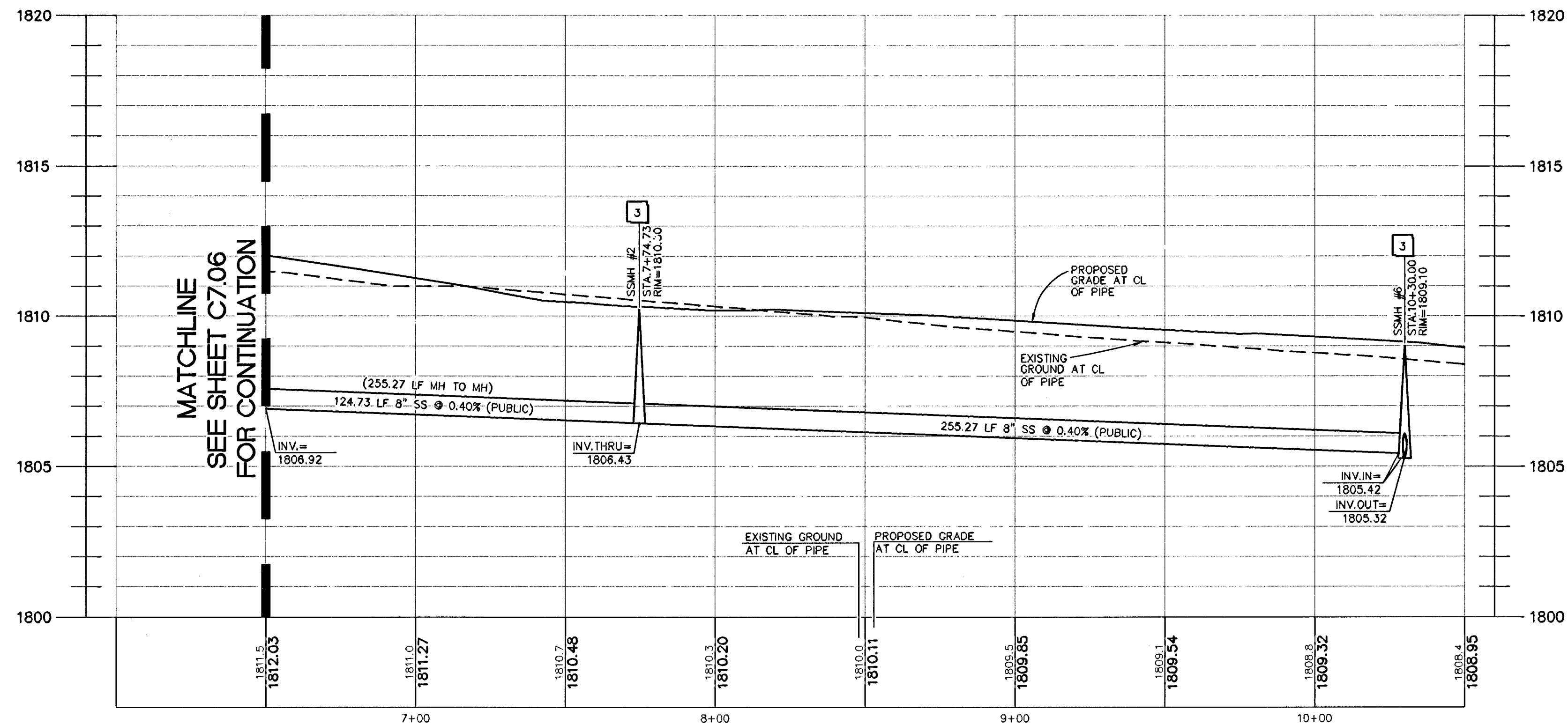

**SANITARY SEWER 1 - PROFILE VIEW**  
HORIZONTAL SCALE: 1" = 30'  
VERTICAL SCALE: 1" = 3'

- SEWER NOTES**
- 1 INSTALL 8" PVC SANITARY SEWER
  - 2 CONSTRUCT SANITARY SEWER CLEANOUT PER DETAIL 15 ON SHEET C2.02
  - 3 CONSTRUCT SANITARY SEWER MANHOLE PER DETAIL ON SHEET C2.07

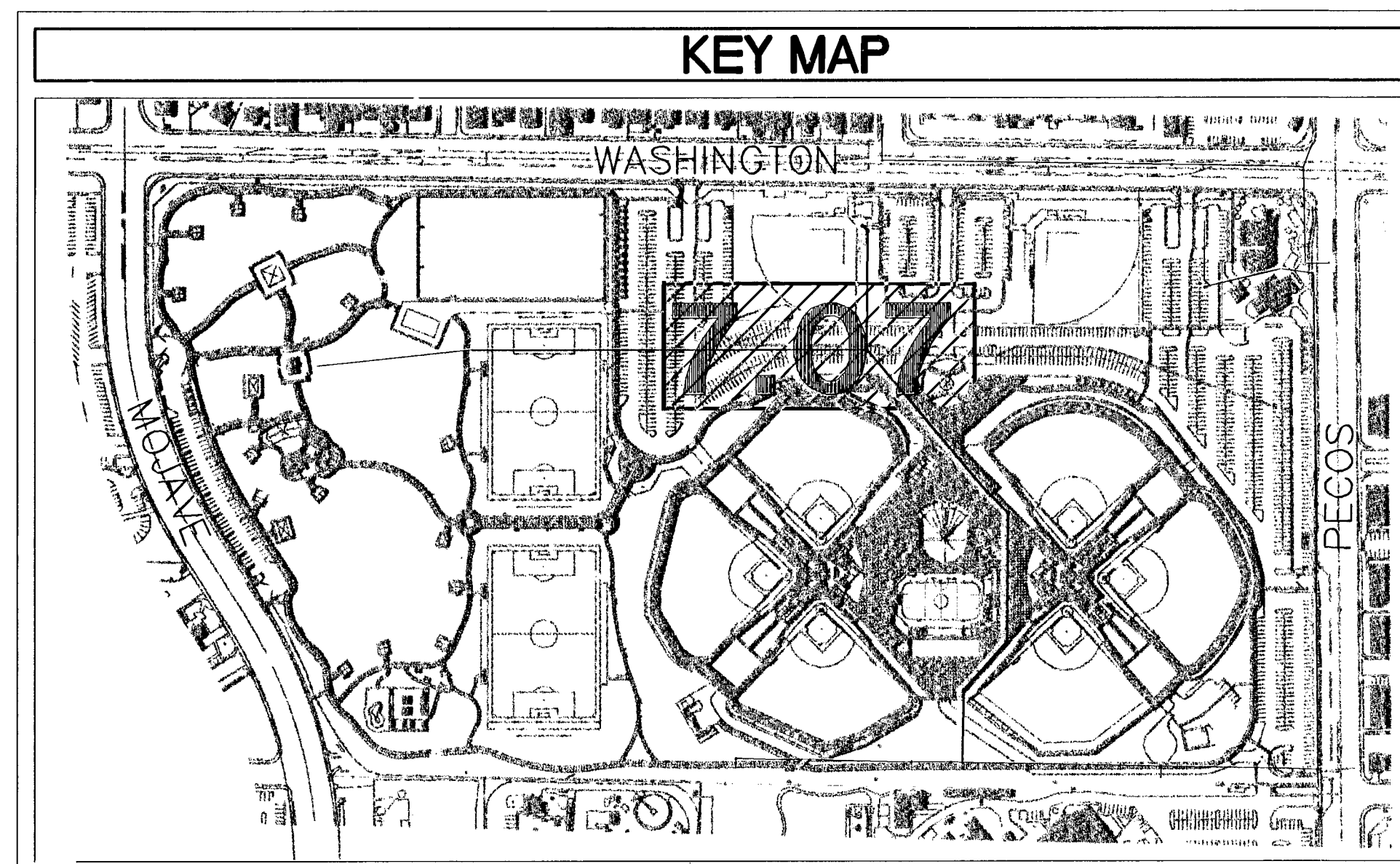

**Call before you Underground**  
1-702-455-7511  
CLARK COUNTY PUBLIC WORKS  
1-702-455-5300  
CLARK COUNTY PUBLIC WORKS  
1-702-455-7511

**Call before you Overhead**  
1-800-227-2600  
CLARK COUNTY PUBLIC WORKS  
1-702-455-7511

**BENCHMARK**  
CITY OF LAS VEGAS RIVET AND ROUND PLATE IN TOP OF CURB, SOUTHWEST CORNER OF WASHINGTON AND MOJAVE, T205, R60E. ELEVATION FEET=1819.41  
BM 2LV01 25C4 ELEVATION METERS=554.56 NAVD88

**BASIS OF BEARING**  
THE BASIS OF BEARINGS FOR THIS PROJECT IS GRID NORTH AS DEFINED BY THE NEVADA COORDINATE SYSTEM OF 1983 (NCS83), EAST ZONE, (2701), DETERMINED BY GIS CONTROL POINTS, "CC-GIS 808" AND "CC-GIS 808" AS SHOWN ON THE MAP THEREOF IN FILE 88 OF SURVEYS, PAGE 53, OFFICIAL RECORDS, CLARK COUNTY, NEVADA.

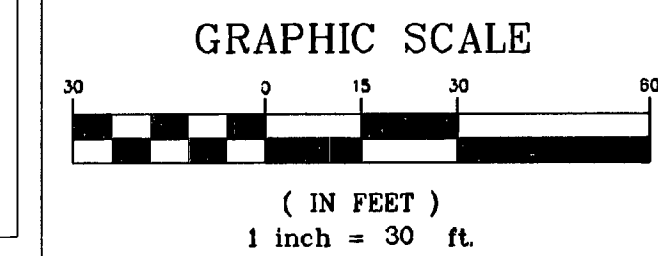

650.22-18

REVISIONS

**Dekker Perich Sabatini**  
architecture  
interiors  
planning  
engineering  
6860 Bermuda Road, Ste. 100  
Las Vegas, Nevada 89119  
702.438.1006  
fax 438.1050  
info@dpsdesign.org

**PBSJ**  
ENGINEERING PLANNING SURVEYING  
CONSTRUCTION SERVICES

2270 Corporate Circle  
Suite 100  
Henderson, Nevada 89074  
Telephone: 702/263-7275  
Fax: 702/263-7200

**CITY OF LAS VEGAS**  
**FREEDOM PARK RENOVATION**  
**850 NORTH MOJAVE, LAS VEGAS, NEVADA 89101**  
**SANITARY SEWER PLAN AND PROFILE TWO**

STAMP

OWNER: CITY OF LAS VEGAS  
DEPARTMENT OF PUBLIC WORKS  
ARCHITECTURAL SERVICES

400 EAST STEWART AVENUE  
LAS VEGAS, NEVADA 89101  
PHONE: (702) 229-6535  
FAX: (702) 384-4846  
TDD: (702) 386-9108

DRAWN

FILE	3008-C7.07P
DATE	DECEMBER 1, 2008
SCALE	1" = 30'
RID NO	070354
CLV DWG NO	650.22-18
	H30306
SHEET NO	SHEET 69 OF 78

**C7.07**

115173