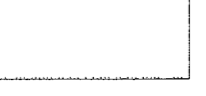

LEGEND

-  CONCRETE WITH BRUSHED FINISH (SEE ARCHITECTURAL PLANS)
-  PROPOSED AC PAVEMENT

CONSTRUCTION NOTES

1. CONSTRUCT "L" TYPE CURB PER USD NO 216
2. CONSTRUCT "A" TYPE CURB PER USD NO 219
3. CONSTRUCT CONCRETE SIDEWALK PER USD DWG NO 234 (USE 12" TYPE II AGGREGATE BASE)
4. CONSTRUCT CONCRETE POOL DECK SECTION PER DETAIL G ON SHEET C6 01
5. CONSTRUCT SITE CONCRETE PAVEMENT SECTION PER DETAIL F ON SHEET C6 01
6. CONSTRUCT RAMP PER DETAIL ON SHEET C6 01
7. INSTALL TRASH ENCLOSURE SCREEN GATES PER ARCH PLANS (ENSURE GATES WILL FULLY OPEN)
8. CONSTRUCT BUS TURNOUT PER USD NO 234 1
9. CONSTRUCT 3 VALLEY GUTTER PER DETAIL ON SHEET C6 01
10. REMOVE 1 BLOCK FOR DRAINAGE
11. CONSTRUCT RETAINING WALL
12. CONSTRUCT CMU BLOCK WALL PER DETAIL ON SHEET C6 01
13. CONSTRUCT 4" CHANNEL DRAIN PER DETAIL THIS SHEET & PER MANUFACTURER'S SPECIFICATIONS
14. INSTALL WHEEL STOP PER USD DWG NO 239
15. CONSTRUCT AC PAVEMENT PER DETAIL ON SHEET C6 01
16. LANDSCAPING (SEE LANDSCAPING PLAN)

GRADING CERTIFICATION

I CERTIFY THAT THIS GRADING PLAN CONFORMS TO THE APPROVED DRAINAGE STUDY ON FILE AT THE CITY OF LAS VEGAS FOR THE PROJECT - DS3627
TIM S. MORENO, P.E. #10361 DATE

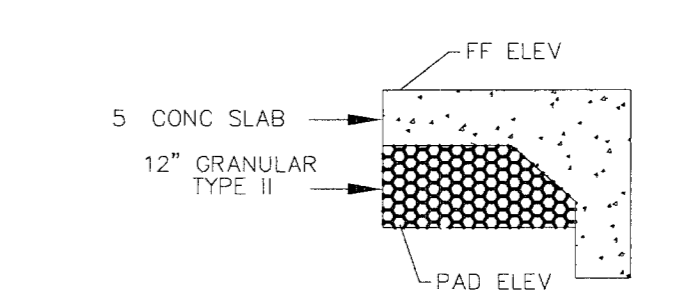

NOTE: REFER TO GEOTECHNICAL DATA REPORT AND STRUCTURAL ENGINEERING DRAWINGS TO VERIFY PAD ELEVATION, FINISH FLOOR ELEVATION, BUILDING FOUNDATION AND BUILDING SLAB DESIGN. THE STRUCTURAL DESIGN DRAWINGS AND GEOTECHNICAL DATA REPORT TAKE PRECEDENCE.

TYPICAL BUILDING PAD DETAIL
NTS

* PAD GRADE IS APPROXIMATE ONLY CONTRACTOR MUST REFER TO GEOTECHNICAL DATA REPORT AND ARCHITECTURAL PLANS TO DETERMINE THE PAD GRADE WHICH WILL RESULT IN THE FINISH FLOOR ELEVATION SHOWN HEREON

REFER TO GEOTECHNICAL DATA REPORT #64045084 BY TERRACON DATED DECEMBER 7, 2004 INCLUDED IN THE SPECIFICATIONS

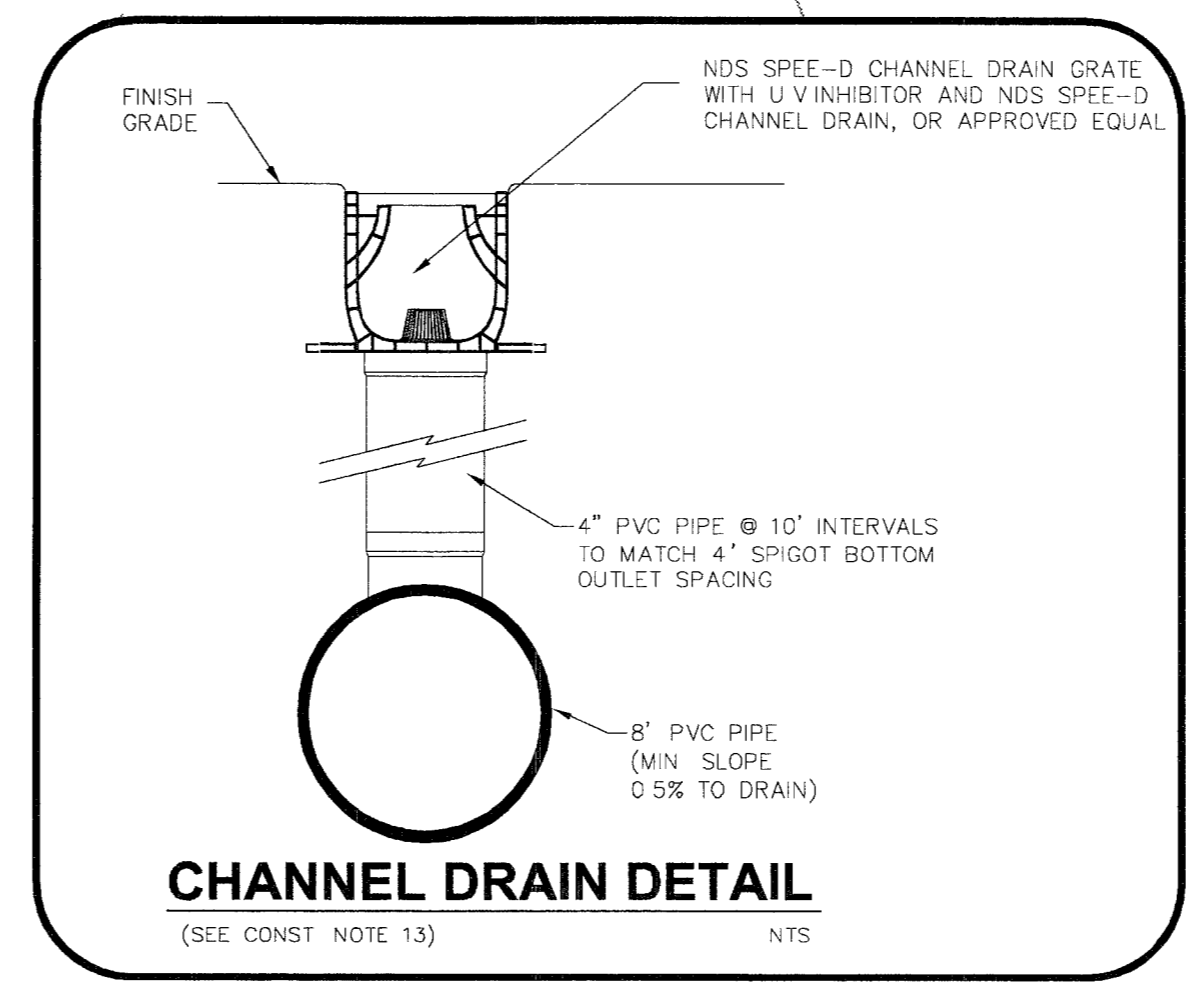

CHANNEL DRAIN DETAIL
(SEE CONST NOTE 13) NTS

SIDEWALK CONSTRUCTION NOTE

ALL ADA ACCESSIBLE SIDEWALKS AND ROUTES WITHIN THE SITE DEVELOPMENT MUST BE CONSTRUCTED WITH A MAXIMUM OF 2.0% CROSS SLOPES

PEDESTRIAN ACCESS NOTE

SIDEWALK IN WASHINGTON AVENUE MUST BE CLEAR AT ALL TIMES FOR PEDESTRIAN ACCESS DURING CONSTRUCTION

BENCHMARK

CLV BM 2LV02 30W4 RIVET & PLATE IN TOP OF CURB SE CORNER OF WASHINGTON AVENUE AND PECOS ROAD ELEV 1805.04' (NAV888)

BASIS OF BEARING

THE NORTH LINE OF THE SOUTHEAST QUARTER (SE 1/4) OF SECTION 25, TOWNSHIP 20 SOUTH, RANGE 61 EAST, M.D.M. CLARK COUNTY, NEVADA BEING THE CENTERLINE OF WASHINGTON AVENUE BEARS N 89°06'43" W AS SHOWN ON CERTAIN PARCEL MAP RECORDED IN FILE 86 OF PARCELS, PAGE 48 CLARK COUNTY, NEVADA, OFFICIAL RECORDS

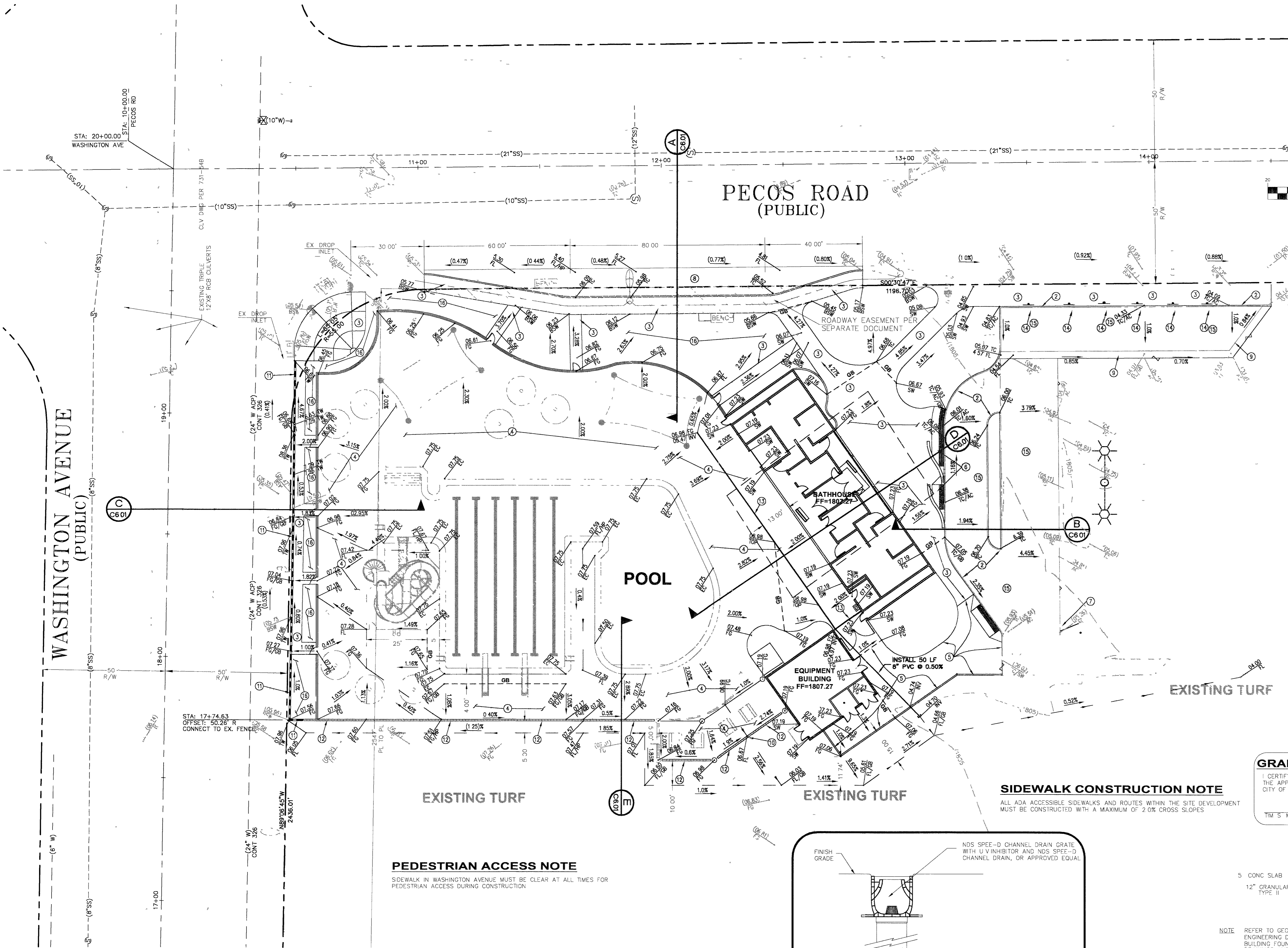

AVOID CUTTING UNDERGROUND UTILITY LINES IT'S COSTLY

Call before you Dig.
1-800-227-2600
UNDERGROUND SERVICE (USA)

AVOID HITTING OVERHEAD POWER LINES IT'S COSTLY

CALL BEFORE YOU CRANE

1-702-227-2929

AVOID HITTING UNDERGROUND TRAFFIC SIGNALS AND STREET LIGHTS SYSTEMS OPERATED BY THE CITY

Call before you UnderGround

1-702-455-7511
CLARK COUNTY TRAFFIC OPERATORS AND
1-702-229-6611
FREIGHTWAY AND ARTISAN SYSTEMS OF TRANSPORTATION