



SHEET NOTES

- 1 VIA LC-1. USE #10 WIRES THROUGHOUT CKT.
- 2 LIGHTING IN DAY ROOM TO BE CONTROLLED BY TWO THREE WAY SWITCH ONE OF WHICH IS A DIMMER.
- 3 PROVIDE FLUSH CEILING MOUNTED JUNCTION BOX FOR ENTRY WAY LIGHTING.
- 4 WALL MOUNTED SWITCHES. LOCATE ADJACENT TO THE RANGE. FOR HOOD LIGHTS AND EXHAUST & EVAPORATIVE COOLER MOTOR CONTROL. SEE SCHEMATICS ON SHEET E-6.3
- 5 FURNISH AND INSTALL SAME TYPE FIXTURE AS NOTE NUMBER 6 EXCEPT THAT THIS IS MOUNTED VERTICALLY. LOCATE J BOX ABOVE THE DISPLAY CABINET OUT OF SIGHT.
- 6 FURNISH AND INSTALL BRUCK HIGHLINE LOW VOLTAGE LIGHTING SYSTEM ON CABLE. PROVIDE CABLE: #150 119 TIN-PLATED, WITH KEVLAR, TRANSPARENT INSULATED MOUNTING SET: #150 510 CH, POLISHED NICKEL PLATED TIGHTENERS WITH COVERED FASTENERS. POWER FEED: #150 514 CH
POWER FEED: #150 503, CEILING POWER FEED, 11-1/8", CHROME
FIXTURES: (2) #150 267 OPAL, MENA CEILING FLOODS
(5) #150 600 CH, MICRO DIRECTIONAL SPOTS
- 7 OFFSET SWITCH TO AVOID PRIVACY CURTAIN.

SHEET GENERAL NOTES

1. REFER TO ARCHITECTURAL ELEVATIONS FOR MOUNTING HEIGHT AND LOCATION FOR ALL EXTERIOR FIXTURES.
2. REFER TO MYTECH SPECIFICATIONS FOR LIGHTING SENSOR WIRING REQUIREMENTS.

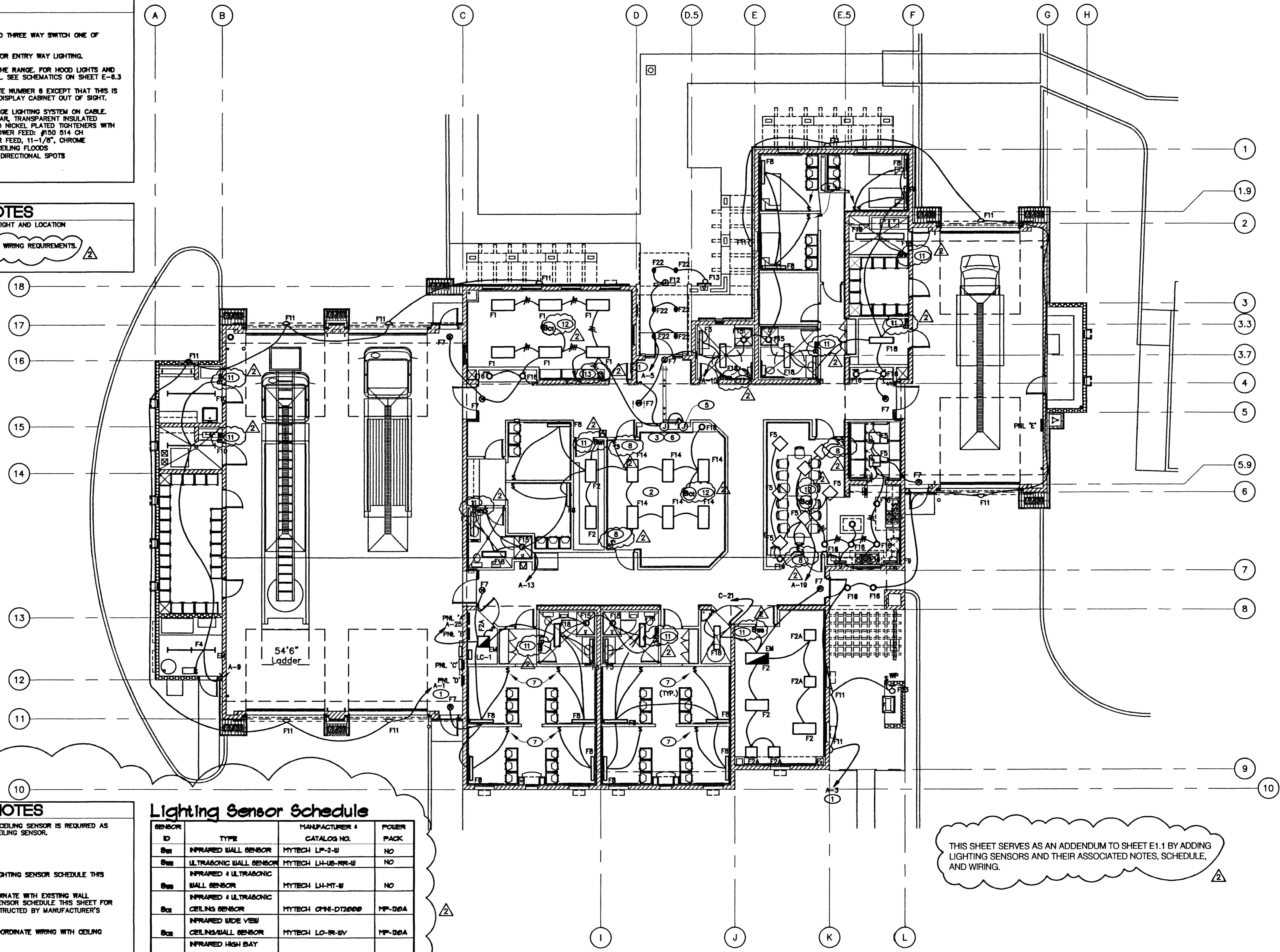

LIGHTING CONTROL NOTES

- 8 EXISTING 3 WAY WALL SWITCH TO REMAIN. WHERE CEILING SENSOR IS REQUIRED AS SHOWN ON THE PLAN, COORDINATE WIRING WITH CEILING SENSOR.
- 9 NOT USED.
- 10 NOT USED.
- 11 REPLACE WALL SWITCH WITH WALL SENSOR. SEE LIGHTING SENSOR SCHEDULE THIS SHEET FOR SENSOR TYPE.
- 12 NEW CEILING SENSOR WITH POWER PACK TO COORDINATE WITH EXISTING WALL SWITCHES FOR LIGHTING CONTROL. SEE LIGHTING SENSOR SCHEDULE THIS SHEET FOR SENSOR TYPE. PROVIDE NECESSARY WIRING AS INSTRUCTED BY MANUFACTURER'S SPECIFICATIONS.
- 13 EXISTING DUAL LEVEL WALL SWITCH TO REMAIN. COORDINATE WIRING WITH CEILING SENSOR FOR LIGHTING CONTROL THIS ROOM.

Lighting Sensor Schedule

SENSOR ID	TYPE	MANUFACTURER & CATALOG NO.	POWER PACK
S11	INFRARED WALL SENSOR	MYTECH LP-2-W	NO
S12	ULTRASONIC WALL SENSOR	MYTECH LH-US-RR-W	NO
S13	INFRARED & ULTRASONIC WALL SENSOR	MYTECH LH-MT-W	NO
S14	INFRARED & ULTRASONIC CEILING SENSOR	MYTECH CH-1-DT2000	MP-200A
S15	INFRARED WIDE VIEW CEILING/WALL SENSOR	MYTECH LC-IR-WV	MP-200A
S16	INFRARED HIGH BAY CEILING/WALL SENSOR	MYTECH LC-HB	MP-200A

ELECTRICAL LIGHTING PLAN

SCALE: 1/8"=1'-0"



THIS SHEET SERVES AS AN ADDENDUM TO SHEET E1.1 BY ADDING LIGHTING SENSORS AND THEIR ASSOCIATED NOTES, SCHEDULE, AND WIRING.

57315

PROPOSED	ADD LIGHTING SENSOR	
CONSULTANT		
CITY OF LAS VEGAS, NEVADA FIRE STATION #44		ELECTRICAL LIGHTING PLAN
OWNER: CITY OF LAS VEGAS DEPARTMENT OF FIELD OPERATIONS FACILITIES MANAGEMENT		
3104 EAST BONANZA ROAD LAS VEGAS, NEVADA 89101 PHONE: (702) 229-5220 FAX: (702) 882-0619 TDD: (702) 886-1108		
DRAWN: JH	CHECKED: JH	
DATE: 8/2/02	SCALE: 1/8"=1'-0"	
RVD NO: 02.1534102	CVDW NO: 63097	
930 F106	SHT NO: ES1.1	

DRAWINGS AND SPECIFICATIONS ARE THE PROPERTY OF THE DESIGN PROFESSIONAL. THESE DRAWINGS OR REPRODUCTIONS THEREOF ARE NOT TO BE USED FOR ANY OTHER PROJECT WITHOUT THE WRITTEN CONSENT OF THE DESIGN PROFESSIONAL. THE DESIGN PROFESSIONAL SHALL BE RESPONSIBLE FOR THE ACCURACY OF THE INFORMATION PROVIDED HEREON. THE CITY OF LAS VEGAS, NEVADA, IS NOT RESPONSIBLE FOR THE ACCURACY OF THE INFORMATION PROVIDED HEREON.