

Call before you Overhead
1-702-227-2929

Call before you Underground
1-702-455-7511

Call before you Dig
1-800-227-2600

Avoid cutting underground utility lines. It's costly.

Avoid cutting underground utility lines. It's costly.

CLARK COUNTY TRAFFIC OPERATIONS AND FREIGHT AND ARTERIAL SYSTEM OF TRANSPORTATION

BASIS OF BEARINGS
THE BASIS OF BEARINGS FOR THIS PROJECT IS NORTH 27°54'36" EAST - THE CENTERLINE OF LAS VEGAS BOULEVARD FROM STATION "B" 1077+00.00 POT TO STATION "B" 1155+93.64 POT (AND FREMONT AVENUE) BEARS NORTH 27°54'36" EAST PER NEVADA DEPARTMENT OF HIGHWAY DRAWINGS, PROJECT NUMBER F005-(13), AS SHOWN BY THAT RECORD OF SURVEY ON FILE IN THE OFFICE OF THE COUNTY RECORDER, CLARK COUNTY, NEVADA, IN FILE 67 OF SURVEYS, AT PAGE 79.

PROJECT BENCHMARK
PROJECT DATUM: CITY OF LAS VEGAS BENCH MARK NO. CLVBM FREMONT 5 - RIVET AND PLATE IN THE TOP OF CURB AT THE NORTHEAST RETURN OF FREMONT AND LAS VEGAS BOULEVARDS.
NAVD88 ELEVATION: 2007.32 METERS (6586.70 FEET)

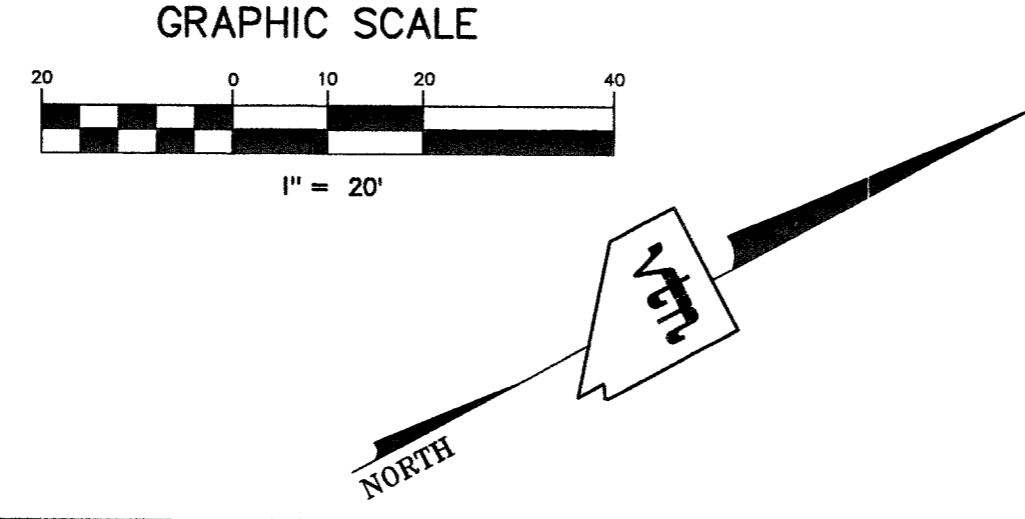

DEMOLITION KEYNOTES

- 1 SAWCUT AND REMOVE EXISTING CONCRETE PAVING AND PREP SURFACE FOR NEW FINISH. VERIFY EXTENT OF EXISTING CONCRETE FINISH IN PARKING LOT. SEE SHEET ASD.01
- 2 REMOVE EXISTING ASPHALT PAVING AND PREP SURFACE FOR NEW FINISH. SEE SHEET ASD.01
- 3 REMOVE EXISTING ROOTS AND TREES AND PREP FOR NEW LANDSCAPING. SEE SHEET LI.01
- 4 REMOVE EXISTING CONCRETE PAVED STAIRS
- 5 REMOVE EXISTING CONCRETE RAMP
- 6 EXISTING CONCRETE RAMP AND HANDRAILS TO BE REMOVED.
- 7 REMOVE EXISTING BASES 18" BELOW GRADE.
- 8 REMOVE STEEL BOLLARDS
- 9 EXISTING FLAGPOLE. REMOVE TILE FROM BASE AND RESTORE TO ORIGINAL CONCRETE.
- 10 REMOVE EXISTING CONCRETE PAD.
- 11 REMOVE EXISTING STEEL POST.
- 12 EXISTING TELECOMMUNICATIONS CONCRETE CURB AND VAULT SHALL BE REMOVED AND RELOCATED - SEE EMBARGO DRAWINGS. BACKFILL PER USD DWG. #503.
- 13 REMOVE EXISTING FLOOR DRAIN.
- 14 SAWCUT AND REMOVE AREAS OF PAVING AFFECTED BY HEAVING/UPLIFTING. VERIFY AREA IN FIELD. SEE CONSULTANT.
- 15 EXISTING CONCRETE BASEMENT STAIRS AND HANDRAILS TO REMAIN. FILL IN STAIRWELL W/ TYPE II AGG. BASE @ 90% COMPACTION. ADD CAP WITH CONCRETE SLAB. SEE SHEET ASD.01
- 16 REMOVE EXTERIOR ACCESS LADDER. PATCH AND REPAIR AREAS AFFECTED BY DEMOLITION.
- 17 REMOVE EXISTING COURTYARD CONCRETE. PREP SURFACE FOR NEW PAVED SURFACE.
- 18 REMOVE EXISTING BUS SHELTER AND SIGNAGE. REPLACE WITH NEW BUS SHELTER AND SIGNAGE. BY OTHERS. SEE SHEET GR2.
- 19 REMOVE EXISTING CONCRETE STAIR AND HANDRAILS.
- 20 ABANDON IN PLACE INLET DRAIN, CAP BELOW SURFACE.
- 21 REMOVE PIPE, CAP NEAR WALKWAY AND BEHIND BACK OF CURB AT NEW SIDEWALK. SEE SHEET GR1, GR2 AND GR3 FOR NEW SIDEWALK LOCATION.
- 22 PROTECT IN PLACE EXISTING COURTYARD - CENTENNIAL PLAZA.
- 23 REMOVE AND SALVAGE STREETLIGHT POLES TO CITY OF LAS VEGAS.
- 24 REMOVE EXISTING VAULT PER ELECTRICAL PLANS. BACKFILL TO 90% COMPACTION. SEE DT4 FOR DETAILS.
- 25 EXISTING DRAIN OUTLET TO BE CUT, CAPPED AND ABANDONED AT NEW SIDEWALK. SEE SHEET GR2 FOR NEW SIDEWALK LOCATION.
- 26 REMOVE EXISTING GRASS AND CONCRETE. PREP FOR NEW 5'-10" CONCRETE SIDEWALK. PER SHEET GR1, GR2 AND GR3. SEE SHEET GR2 AND DT3 FOR DETAILS.
- 27 REMOVE EXISTING CURB, GUTTER AND SIDEWALK AT NEAREST JOINTS PER NEW DESIGN. SEE SHEETS GR2, GR3 AND DT3 FOR DETAILS.
- 28 SAWCUT AND REMOVE EXISTING CONCRETE PAVING AT NEAREST JOINT AND PREP SURFACE FOR NEW FINISH PER NEW WATER LINE. SEE SHEET UT1 FOR WATER LINE LOCATION.

LEGEND

- DENOTES DEMOLITION AREA BY THE CITY OF LAS VEGAS
- DENOTES DEMOLITION BOUNDARY BY THE CITY OF LAS VEGAS
- SITE VISIBILITY ZONE
- EXISTING WALK TO BE REMOVED
- REMOVE EXISTING CONCRETE PAVING AND PREP SURFACE FOR NEW FINISH
- EXISTING GRAVEL TO BE REPLACED WITH STAINED/COLORED CONCRETE

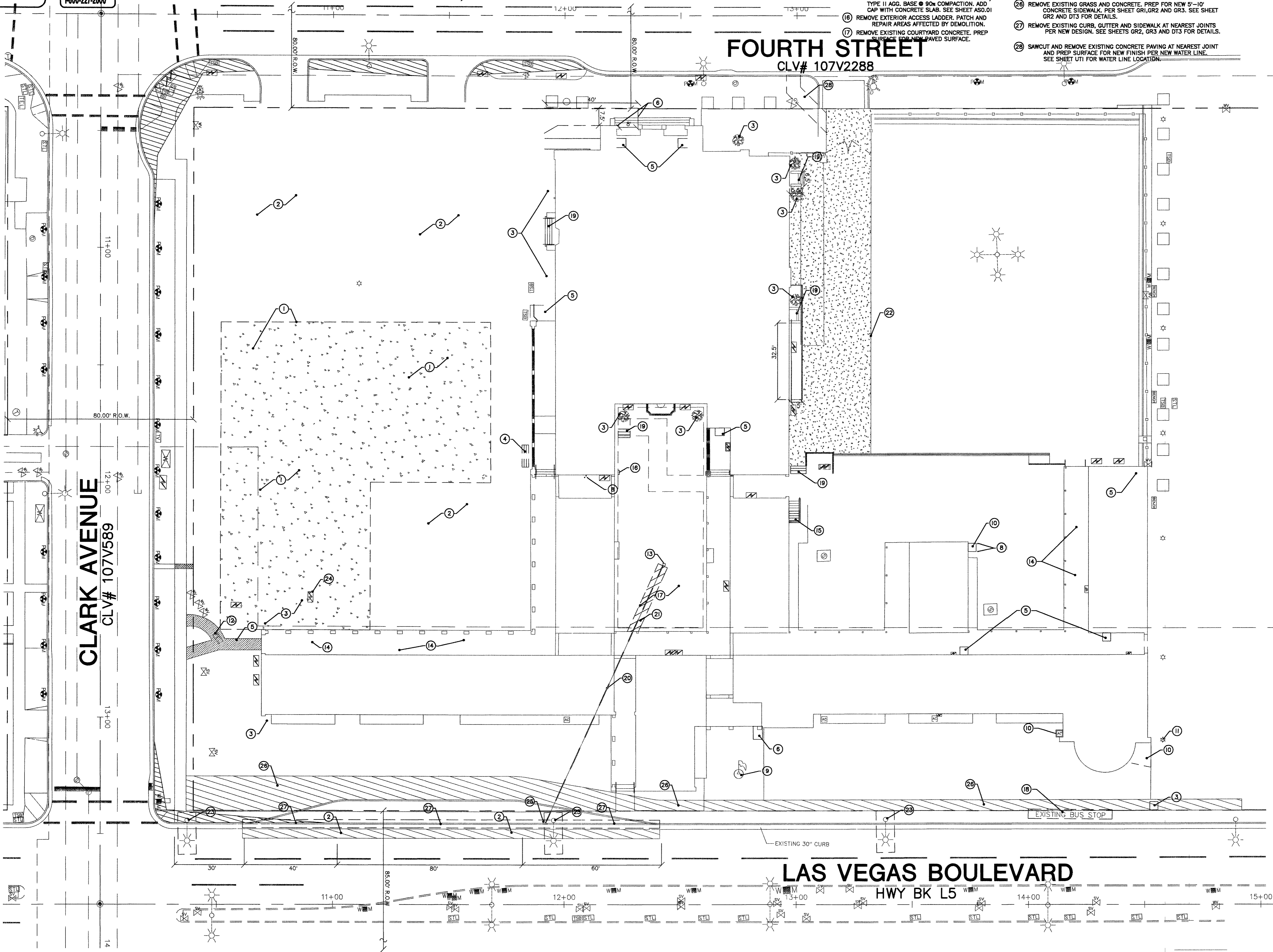

**LEWIS AVENUE
CORRIDOR IMPROVEMENTS**
CLV# 107V3502

7	6	5	4	3	2	1	REV	DATE	BY
<p>CITY OF LAS VEGAS 400 EAST STEWART AVENUE LAS VEGAS, NEVADA 89101 (702) 228-6535</p> <p>CITY OF LAS VEGAS, NEVADA 2727 SOUTH RAINBOW BOULEVARD LAS VEGAS, NEVADA 89146-5148 PH. (702) 973-7500 FAX (702) 362-2597</p> <p>nevada CONSULTING ENGINEERS PLANNERS & LAND SURVEYORS</p>									
<p>DEMOLITION PLAN FIFTH STREET SCHOOL</p> <p>FIFTH STREET SCHOOL REHABILITATION BUILDING DEPARTMENT SUBMITTAL</p>									
<p>DRAWN BY: SPAPPA</p> <p>DESIGNED BY:</p> <p>CHECKED BY:</p> <p>PROJECT NO: 5716</p> <p>SCALE: 1"=20' HORIZ. 1"=20' VERT.</p>									
<p>PROFESSIONAL ENGINEER STATE OF NEVADA DANIEL J. HOOD Exp. 6/30/07 CIVIL No. 12811</p>									
<p>SHEET DEMO 6 OF 11 SHEETS DRAWING NO. CLV# 513-65E</p>									

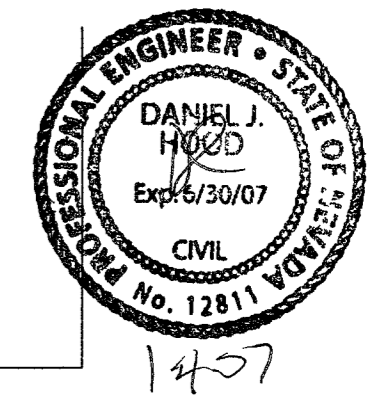

HANSEN# 18021