

**ABBREVIATIONS**

|       |                    |        |                                 |
|-------|--------------------|--------|---------------------------------|
| FL    | FINISH GRADE       | PT     | POINT OF TANGENCY               |
| TC    | TOP OF CURB        | PRC    | POINT OF REVERSE CURVATURE      |
| TRC   | TOP OF ROLL CURB   | PC     | POINT OF COMPOUND CURVATURE     |
| EP    | EDGE OF PAVEMENT   | BVC    | BEGIN VERTICAL CURVE            |
| FUT.  | FUTURE             | MVC    | MID-POINT OF VERTICAL CURVE     |
| EXIST | EXISTING           | EVC    | END VERTICAL CURVE              |
| VG    | VALLEY GUTTER      | PRVC   | POINT OF REVERSE VERTICAL CURVE |
| NG    | NATURAL GROUND     | VPI    | VERTICAL POINT OF INTERSECTION  |
| H.P.  | HIGH POINT         | TPW    | TOP OF PLANTER WALL             |
| L.P.  | LOW POINT          | TOP    | TOP OF CHANNEL/SCARP            |
| C/L   | CENTER LINE        | TOE    | TOE OF CHANNEL/SCARP            |
| O/C   | OFFSET CROWN       | TOB    | TOP OF BOX                      |
| BC    | BACK OF CURB       | PP     | POWER POLE                      |
| BCR   | BEGIN CURB RETURN  | TRANS. | TRANSITION                      |
| IF    | TOP OF FOOTING     | RET.   | RETAINMENT                      |
| OB    | GRADE BREAK        | INT.   | INTERSECTION                    |
| PC    | POINT OF CURVATURE | D.C.   | DESIGN GRADE                    |
| S/W   | SIDEWALK           | TSW    | TOP OF SIDEWALK                 |
|       |                    | TW     | TOP OF WALL                     |

**Call before you Underground**  
1-702-455-7511  
1-702-229-0811

**Call before you Overhead**  
1-702-227-2928

**Call before you Dig**  
1-800-227-2600

**BASIS OF BEARINGS**  
THE BASIS OF BEARINGS FOR THIS PROJECT IS NORTH 27°54'36" EAST - THE CENTERLINE OF LAS VEGAS BOULEVARD FROM STATION 10+107.40 TO STATION 10+115.53.64 (AND FREMONT AVENUE) BEARS NORTH 27°54'36" EAST PER NEVADA DEPARTMENT OF HIGHWAY DRAWINGS, PROJECT NUMBER F005-1(3), AS SHOWN BY THAT RECORD OF SURVEY ON FILE IN THE OFFICE OF THE COUNTY RECORDER, CLARK COUNTY, NEVADA, IN FILE 67 OF SURVEYS, AT PAGE 73.

**PROJECT BENCHMARK**  
PROJECT DATUM: CITY OF LAS VEGAS BENCHMARK NO. CLVBM FREMONT 5 - RIVET AND PLATE IN THE TOP OF CURB AT THE NORTHEAST RETURN OF FREMONT AND LAS VEGAS BOULEVARD.  
NAVD88 ELEVATION: 2007.32 METERS (6586.70 FEET)

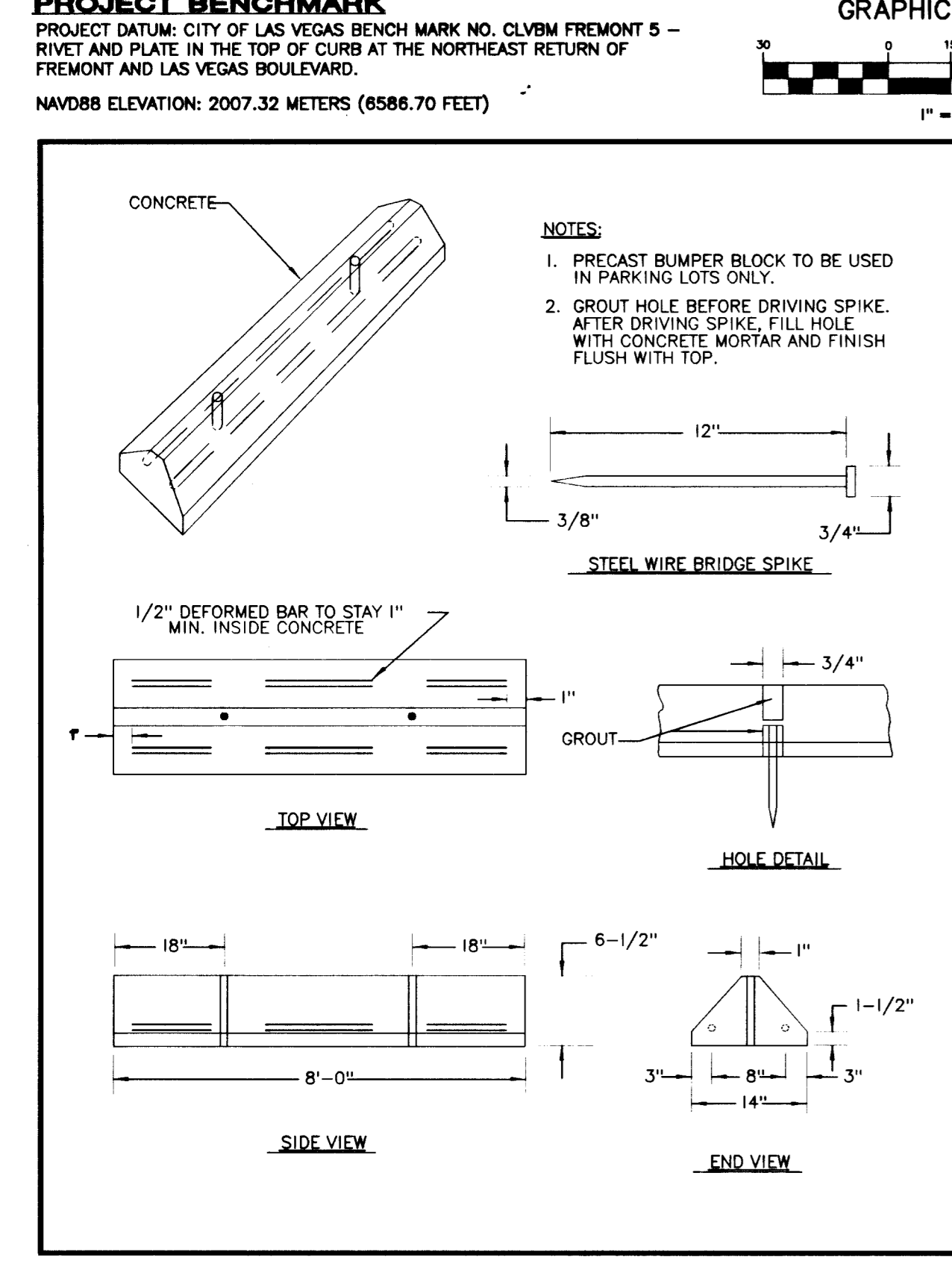

**TYPICAL PARKING STOP DETAIL**  
USD# 238

**CURVE TABLE**

| CURVE | LENGTH | RADIUS | TANGENT | DELTA      |
|-------|--------|--------|---------|------------|
| C1    | 3.10   | 3.00   | 1.70    | 59°06'54"  |
| C2    | 4.69   | 2.50   | 3.40    | 107°24'01" |
| C3    | 19.94  | 20.50  | 10.84   | 55°43'13"  |
| C4    | 7.76   | 20.50  | 3.93    | 21°40'48"  |
| C5    | 32.20  | 20.50  | 20.50   | 90°00'00"  |
| C6    | 2.62   | 2.50   | 1.44    | 59°59'59"  |
| C7    | 5.24   | 2.50   | 4.34    | 120°05'05" |
| C8    | 3.95   | 2.50   | 2.52    | 90°34'12"  |
| C9    | 1.85   | 3.50   | 0.95    | 30°21'03"  |
| C10   | 5.11   | 2.50   | 4.09    | 117°05'04" |
| C11   | 3.93   | 2.50   | 2.50    | 89°59'14"  |
| C12   | 1.32   | 2.50   | 0.67    | 30°09'04"  |
| C13   | 2.62   | 2.50   | 1.44    | 60°00'00"  |
| C14   | 5.24   | 2.50   | 4.33    | 120°00'00" |
| C15   | 4.14   | 2.45   | 2.76    | 96°35'59"  |
| C16   | 17.33  | 25.94  | 9.00    | 38°15'43"  |
| C17   | 1.09   | 2.50   | 0.55    | 24°54'00"  |
| C18   | 14.46  | 49.46  | 7.28    | 16°45'13"  |
| C19   | 2.11   | 2.41   | 1.13    | 50°18'01"  |
| C20   | 5.24   | 2.50   | 4.33    | 120°00'00" |
| C21   | 4.97   | 25.00  | 2.50    | 11°24'02"  |
| C22   | 4.80   | 25.05  | 2.41    | 10°58'14"  |
| C23   | 3.44   | 25.00  | 1.78    | 7°52'22"   |
| C24   | 3.42   | 25.00  | 1.71    | 7°50'22"   |
| C25   | 0.73   | 2.50   | 0.37    | 16°40'29"  |
| C26   | 2.61   | 2.50   | 1.44    | 59°51'42"  |

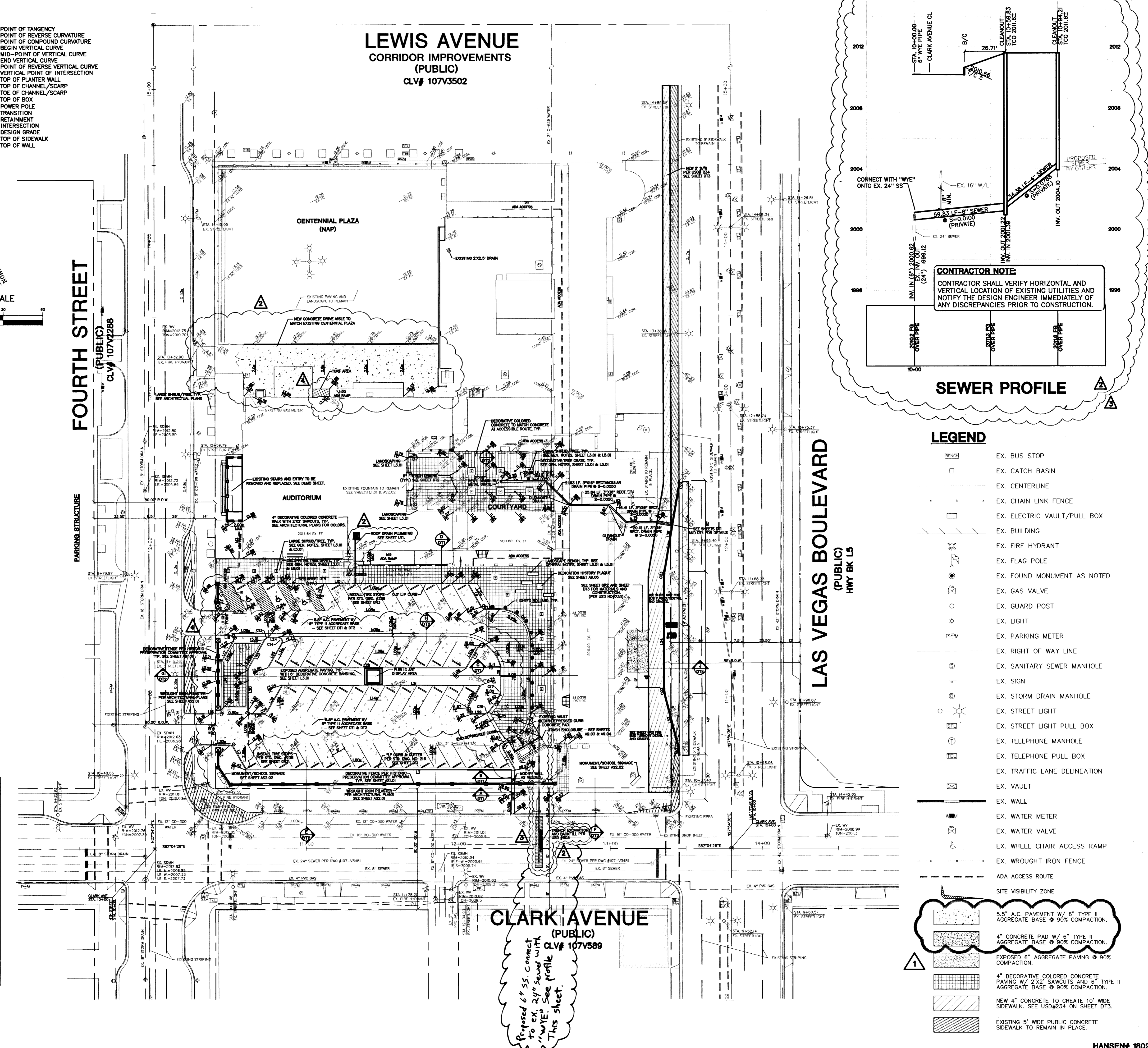

**CITY OF LAS VEGAS**  
400 EAST STEWART AVENUE  
LAS VEGAS, NEVADA 89101  
(702) 229-4535

**OVERALL GRADING FIFTH STREET SCHOOL**

**FIFTH STREET SCHOOL REHABILITATION BUILDING DEPARTMENT SUBMITTAL**

**DESIGNED BY:** S.PAPPA  
**CHECKED BY:** [Signature]  
**PROJECT NO.:** 9716  
**SHEET:** GR3  
**5 OF 11 SHEETS**  
**DRAWING NO.:** CLV# 513-65E

**REVISIONS:**

| NO. | DATE    | BY   | REVISION   |
|-----|---------|------|--|
| 1   | 2/12/07 | S.P. | DELETED THE WORDS, "PROPOSED"  |
| 2   | 2/12/07 | S.P. | REVISED GRADES AT DRIVE AISLE, ADDED S.S. PROFILE, REVISED ROOF DRAIN-REF. ARCHITECT REV. #11, & ADDED TRENCHING FOR |
| 3   | 2/12/07 | S.P. | REVISED SEWER  |
| 4   | 2/12/07 | S.P. | REVISED FENCE LOCATION, PARKING LOT, & ADDED TURF AREA   |

**HANSEN# 18021**