

BASIS OF BEARINGS
 THE BASIS OF BEARINGS FOR THIS PROJECT IS NORTH 27°54'38" EAST - THE CENTERLINE OF LAS VEGAS BOULEVARD FROM STATION 18+1077+00.00 POT TO STATION 18+1155+93.64 POT (AND FREMONT AVENUE) BEARS NORTH 27°54'38" EAST PER NEVADA DEPARTMENT OF HIGHWAY DRAWINGS, PROJECT NUMBER P005-(3), AS SHOWN BY THAT RECORD OF SURVEY ON FILE IN THE OFFICE OF THE COUNTY RECORDER, CLARK COUNTY, NEVADA, IN FILE 87 OF SURVEYS, AT PAGE 79.

PROJECT BENCHMARK
 PROJECT DATUM: CITY OF LAS VEGAS BENCH MARK NO. CLVBM FREMONT 5 - RIVET AND PLATE IN THE TOP OF CURB AT THE NORTHEAST RETURN OF FREMONT AND LAS VEGAS BOULEVARD.
 NAVD88 ELEVATION: 2007.32 METERS (6586.70 FEET)

Call before you dig
 1-702-455-7511
 1-702-229-8611

Call before you dig
 1-702-229-2929
 Call before you dig
 1-800-227-2800

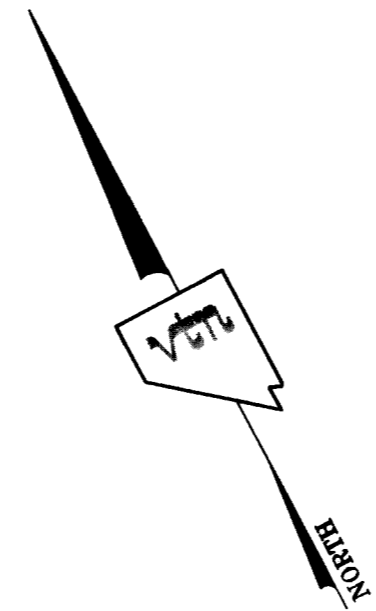
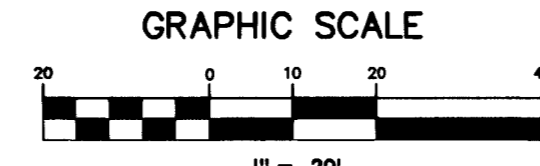

- ABBREVIATIONS**
- FG FINISH GRADE
 - FL FLOW LINE
 - TC TOP OF CURB
 - TRC TOP OF ROLL CURB
 - EP EDGE OF PAVEMENT
 - FUT FUTURE
 - EXIST EXISTING
 - VG VALLEY GUTTER
 - NG NATURAL GROUND
 - HP HIGH POINT
 - LP LOW POINT
 - C/C CENTER LINE
 - BC BACK OF CURB
 - BCR BEGIN CURB RETURN
 - TF TOP OF FOOTING
 - GB GRADE BREAK
 - PC POINT OF CURVATURE
 - S/W SIDEWALK
 - PT POINT OF TANGENCY
 - PRC POINT OF REVERSE CURVATURE
 - PCC POINT OF COMPOUND CURVATURE
 - BVC BEGIN VERTICAL CURVE
 - MVC MID-POINT OF VERTICAL CURVE
 - EVC END VERTICAL CURVE
 - PRVC POINT OF REVERSE VERTICAL CURVE
 - VPI VERTICAL POINT OF INTERSECTION
 - TPM TOP OF PLANTER WALL
 - TOP TOP OF CHANNEL/SCARP
 - TOE TOP OF BOX
 - POB POWER POLE TRANSITION
 - TRANS. TRANS.
 - RET. RETAINMENT
 - INT. INTERSECTION
 - D.G. DESIGN GRADE
 - TSW TOP OF SIDEWALK
 - TW TOP OF WALL

LEGEND

- EX. BUS STOP
- EX. CATCH BASIN
- EX. CENTERLINE
- EX. CHAIN LINK FENCE
- EX. ELECTRIC VAULT/PULL BOX
- EX. BUILDING
- EX. FIRE HYDRANT
- EX. FLAG POLE
- EX. FOUND MONUMENT AS NOTED
- EX. GAS VALVE
- EX. GUARD POST
- EX. LIGHT
- EX. PARKING METER
- EX. RIGHT OF WAY LINE
- EX. SANITARY SEWER MANHOLE
- EX. SIGN
- EX. STORM DRAIN MANHOLE
- EX. STREET LIGHT
- EX. STREET LIGHT PULL BOX
- EX. TELEPHONE MANHOLE
- EX. TELEPHONE PULL BOX
- EX. TRAFFIC LANE DELINEATION
- EX. VAULT
- EX. WALL
- EX. WATER METER
- EX. WATER VALVE
- EX. WHEEL CHAIR ACCESS RAMP
- EX. WROUGHT IRON FENCE
- ADA ACCESS ROUTE
- SITE VISIBILITY ZONE

LINE TABLE

LINE	LENGTH	BEARING
L1	12.10	S61°24'04"E
L2	17.07	S01°56'08"W
L3	188.22	S61°56'08"W
L4	15.94	N01°56'08"W
L6	48.24	N28°03'32"E
L8	9.53	N61°56'08"W
L9	17.90	N01°56'08"W
L10	165.70	N61°56'07"W
L11	16.23	S01°56'08"E
L12	9.18	N61°51'27"W
L13	19.20	N27°55'09"E
L14	30.76	N27°55'09"E
L15	5.90	N27°55'09"E
L16	6.08	S 61°39'35" E
L17	14.28	N58°03'32"E
L18	14.25	S 61°54'25" E
L19	21.73	N27°54'48"E
L21	5.66	N27°54'48"E
L22	1.38	N27°54'48"E
L23	21.54	N58°03'32"E
L24	2.99	N 61°57'37" W
L25	18.47	S 58°3'52" W
L26	131.67	S61°56'08"E
L27	15.99	N58°03'32"E
L28	16.65	S28°03'32"W
L29	7.59	N61°56'08"W
L30	17.30	N58°03'32"E
L31	131.25	S 61°56'08"E
L32	19.64	N 58°3'52" E
L33	36.21	N3°25'07"E
L34	71.01	N27°54'38"E
L35	57.40	N37°32'38"E
L36	7.32	N62°04'26"W

CURVE TABLE

CURVE	LENGTH	RADIUS	TANGENT	DELTA
C1	3.10	3.00	1.70	59°06'54"
C2	4.69	2.50	3.40	107°24'01"
C3	19.94	20.50	10.84	35°43'13"
C4	7.76	20.50	3.93	21°40'48"
C5	32.20	20.50	20.50	90°00'00"
C6	2.62	2.30	1.44	59°59'59"
C7	5.24	2.50	4.34	120°05'09"
C8	3.95	2.50	2.52	90°34'12"
C9	1.85	3.50	0.95	30°21'52"
C10	5.11	2.50	4.09	117°05'04"
C11	7.18	7.80	3.85	52°33'41"
C12	1.32	2.50	0.67	30°09'04"
C13	2.52	2.50	1.38	57°45'53"
C14	5.20	2.50	4.27	119°15'12"
C15	4.16	2.50	2.74	95°11'55"
C16	16.39	24.94	8.51	37°39'24"
C17	1.10	2.50	0.56	25°10'25"
C18	14.91	48.46	7.51	17°37'26"
C19	2.06	2.50	1.09	47°12'09"
C20	5.24	2.50	4.33	120°05'09"
C21	4.57	25.00	2.50	11°24'02"
C22	4.80	25.05	2.41	10°58'14"
C23	3.44	25.00	1.72	7°52'22"
C24	3.42	25.00	1.71	7°50'22"
C25	0.74	2.50	0.37	17°24'41"
C26	7.08	4.30	4.62	94°13'55"

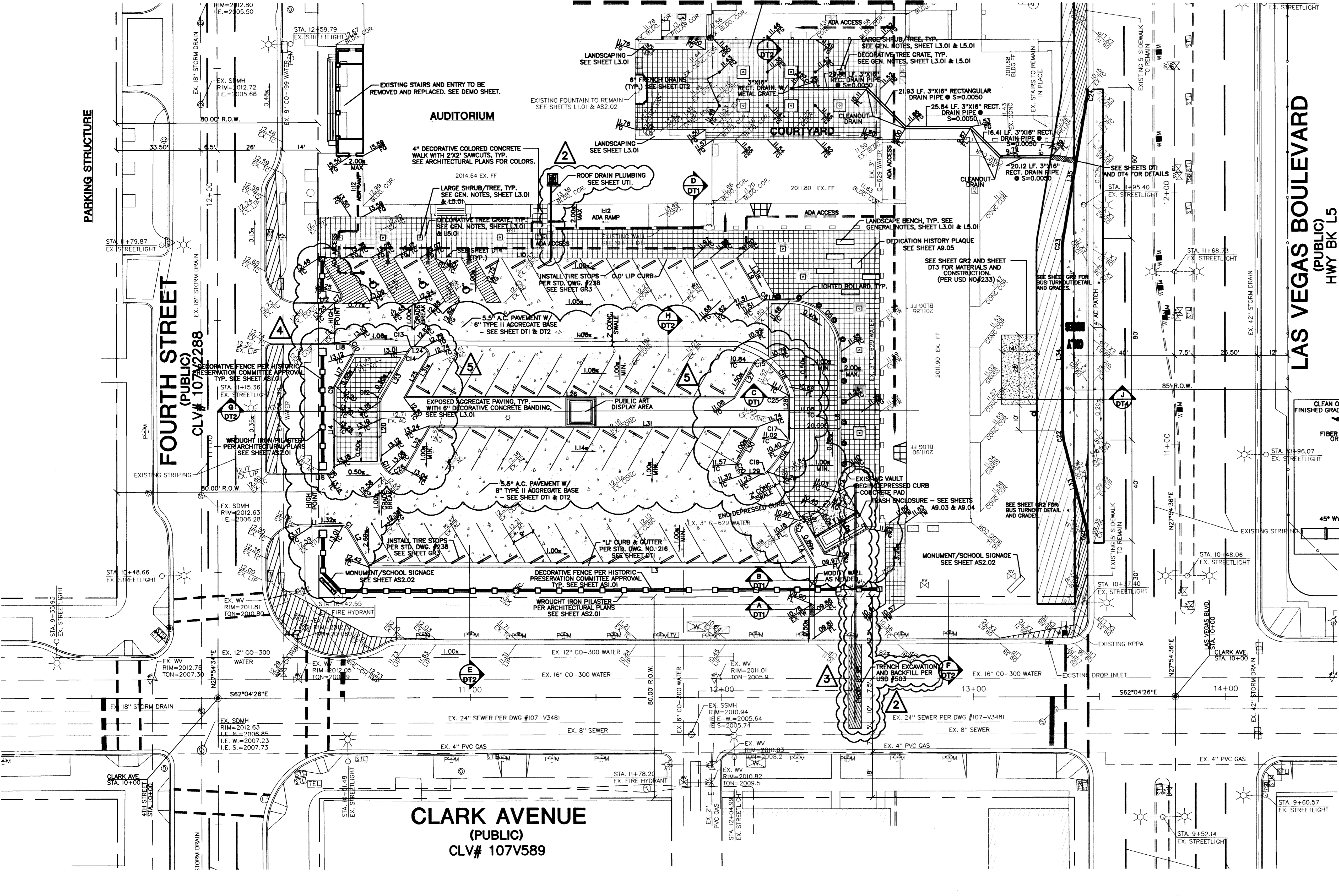

LAS VEGAS BOULEVARD (PUBLIC) HWY BK L5

FOURTH STREET (PUBLIC) CLV# 107A2288

CLARK AVENUE (PUBLIC) CLV# 107V589

CITY OF LAS VEGAS
 400 EAST STEWART AVENUE
 LAS VEGAS, NEVADA 89101
 (702) 229-8535

GRADING PLAN FIFTH STREET SCHOOL

FIFTH STREET SCHOOL REHABILITATION BUILDING DEPARTMENT SUBMITTAL

SCALE: 1"=20' HORIZ. 1"=20' VERT.

SHEET 3 OF 11 SHEETS
 DRAWING NO.

REVISIONS:

NO.	DATE	BY	REVISION
1	12/16/07	J.P.	REVISED CURB
2	12/16/07	J.P.	REVISED FENCE LOCATION, PARKING LOT & ADDED TURF AREA
3	12/16/07	J.P.	REVISED SEWER
4	12/16/07	J.P.	ADDED PROPOSED S.S. AND TRENCHING INFO AND REVISED ROOF-
5	12/16/07	J.P.	DRAIN-RET. ARCHITECT REV. #11
6	12/16/07	S.P.	DELETED THE WORDS "PROPOSED"

CONSULTING ENGINEERS PLANNERS & LAND SURVEYORS

THIS SITE IS LOCATED IN FLOOD ZONE "X" AS SHOWN ON FEMA PANEL #32003C2170E DATED SEPT. 27, 2002