

Call before you Overhead  
1-702-227-2929

Call before you Dig  
1-702-227-2929

Call before you Overhead  
1-702-227-2929

Call before you Dig  
1-702-227-2929

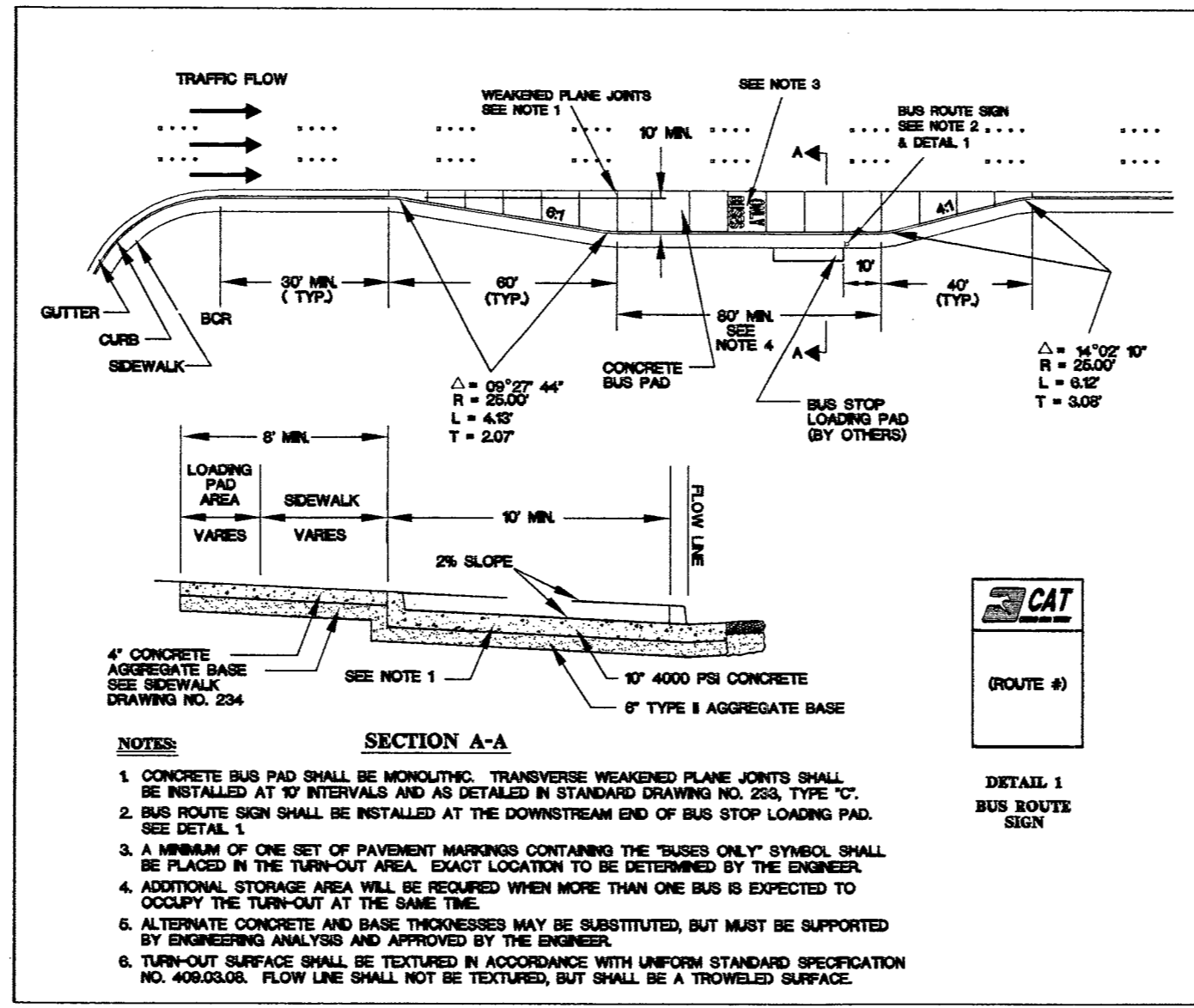
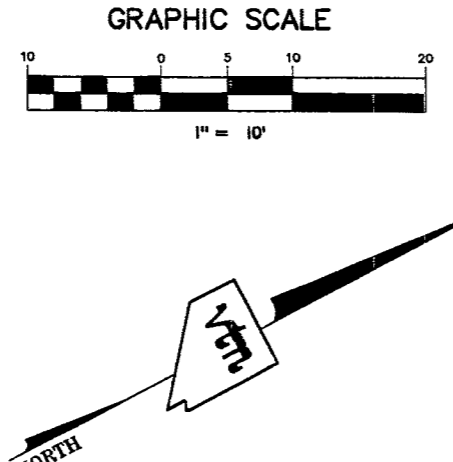

**ABBREVIATIONS**

FG	FINISH GRADE	PT	POINT OF TANGENCY
FL	FLOW LINE	PRC	POINT OF REVERSE CURVATURE
TC	TOP OF CURB	POC	POINT OF COMPOUND CURVATURE
TRC	TOP OF ROLL CURB	BVC	BEGIN VERTICAL CURVE
EP	EDGE OF PAVEMENT	MVC	MID-POINT OF VERTICAL CURVE
FUT	FUTURE	END	END VERTICAL CURVE
EXIST	EXISTING	PRVC	POINT OF REVERSE VERTICAL CURVE
VG	VALLEY GUTTER	VPI	VERTICAL POINT OF INTERSECTION
NG	NATURAL GROUND	TPW	TOP OF PLANTER WALL
H.P.	HIGH POINT	TOP	TOP OF CHANNEL/SCARP
L.P.	LOW POINT	TOE	TOE OF CHANNEL/SCARP
C/L	CENTER LINE	TOB	TOP OF BOX
O/C	OFFSET CROWN	PP	POWER POLE
BC	BACK OF CURB	TRANS.	TRANSITION
BCK	BEGIN CURB RETURN	RET.	RETAINMENT
IT	TOP OF FOOTING	INT.	INTERSECTION
CB	CURB BREAK	D.G.	DESIGN GRADE
PC	POINT OF CURVATURE	TSW	TOP OF SIDEWALK
S/W	SIDEWALK	TW	TOP OF WALL

**LEGEND**

	PROPOSED 4" CONCRETE PAD W/ 6" TYPE II AGGREGATE BASE @ 90% COMPACTION.
	NEW 4" CONCRETE TO CREATE 10' WIDE SIDEWALK. SEE USD#234 ON SHEET D13.
	EXISTING 5' WIDE PUBLIC CONCRETE SIDEWALK TO REMAIN IN PLACE.

**LEGEND**

	EX. BUS STOP
	EX. CATCH BASIN
	EX. CENTERLINE
	EX. CHAIN LINK FENCE
	EX. ELECTRIC VAULT/PULL BOX
	EX. BUILDING
	EX. FIRE HYDRANT
	EX. FLAG POLE
	EX. FOUND MONUMENT AS NOTED
	EX. GAS VALVE
	EX. GUARD POST
	EX. LIGHT
	EX. PARKING METER
	EX. RIGHT OF WAY LINE
	EX. SANITARY SEWER MANHOLE
	EX. SIGN
	EX. STORM DRAIN MANHOLE
	EX. STREET LIGHT
	EX. STREET LIGHT PULL BOX
	EX. TELEPHONE MANHOLE
	EX. TELEPHONE PULL BOX
	EX. TRAFFIC LANE DELINEATION
	EX. VAULT
	EX. WALL
	EX. WATER METER
	EX. WATER VALVE
	EX. WHEEL CHAIR ACCESS
	EX. WROUGHT IRON FENCE
	SITE VISIBILITY ZONE

**BASIS OF BEARINGS**  
THE BASIS OF BEARINGS FOR THIS PROJECT IS NORTH 27°54'39" EAST - THE CENTERLINE OF LAS VEGAS BOULEVARD FROM STATION 78+1077+00.00 P.O.T. TO STATION 78+1054+33.64 P.O.T. (AND FREMONT AVENUE) BEARS NORTH 27°54'39" EAST PER NEVADA DEPARTMENT OF HIGHWAY DRAWINGS, PROJECT NUMBER F005-103, AS SHOWN BY THAT RECORD OF SURVEY ON FILE IN THE OFFICE OF THE COUNTY RECORDER, CLARK COUNTY, NEVADA, IN FILE 67 OF SURVEYS, AT PAGE 79.

**PROJECT BENCHMARK**  
PROJECT DATUM: CITY OF LAS VEGAS BENCH MARK NO. CLVBM FREMONT 5 - RIVET AND PLATE IN THE TOP OF CURB AT THE NORTHEAST RETURN OF FREMONT AND LAS VEGAS BOULEVARD.

NAVD88 ELEVATION: 2007.32 METERS (6586.70 FEET)

- NOTES**
- CONCRETE BUS PAD SHALL BE MONOLITHIC. TRANSVERSE WEAKENED PLANE JOINTS SHALL BE INSTALLED AT 10' INTERVALS AND AS DETAILED IN STANDARD DRAWING NO. 233, TYPE "C". SEE DETAIL 1.
  - BUS ROUTE SIGN SHALL BE INSTALLED AT THE DOWNSTREAM END OF BUS STOP LOADING PAD. SEE DETAIL 1.
  - A MINIMUM OF ONE SET OF PAVEMENT MARKINGS CONTAINING THE "BUSES ONLY" SYMBOL SHALL BE PLACED IN THE TURN-OUT AREA. EXACT LOCATION TO BE DETERMINED BY THE ENGINEER.
  - ADDITIONAL STORAGE AREA WILL BE REQUIRED WHEN MORE THAN ONE BUS IS EXPECTED TO OCCUPY THE TURN-OUT AT THE SAME TIME.
  - ALTERNATE CONCRETE AND BASE THICKNESSES MAY BE SUBSTITUTED, BUT MUST BE SUPPORTED BY ENGINEERING ANALYSIS AND APPROVED BY THE ENGINEER.
  - TURN-OUT SURFACE SHALL BE TEXTURED IN ACCORDANCE WITH UNIFORM STANDARD SPECIFICATION NO. 409.00. FLOW LINE SHALL NOT BE TEXTURED, BUT SHALL BE A TROWELED SURFACE.

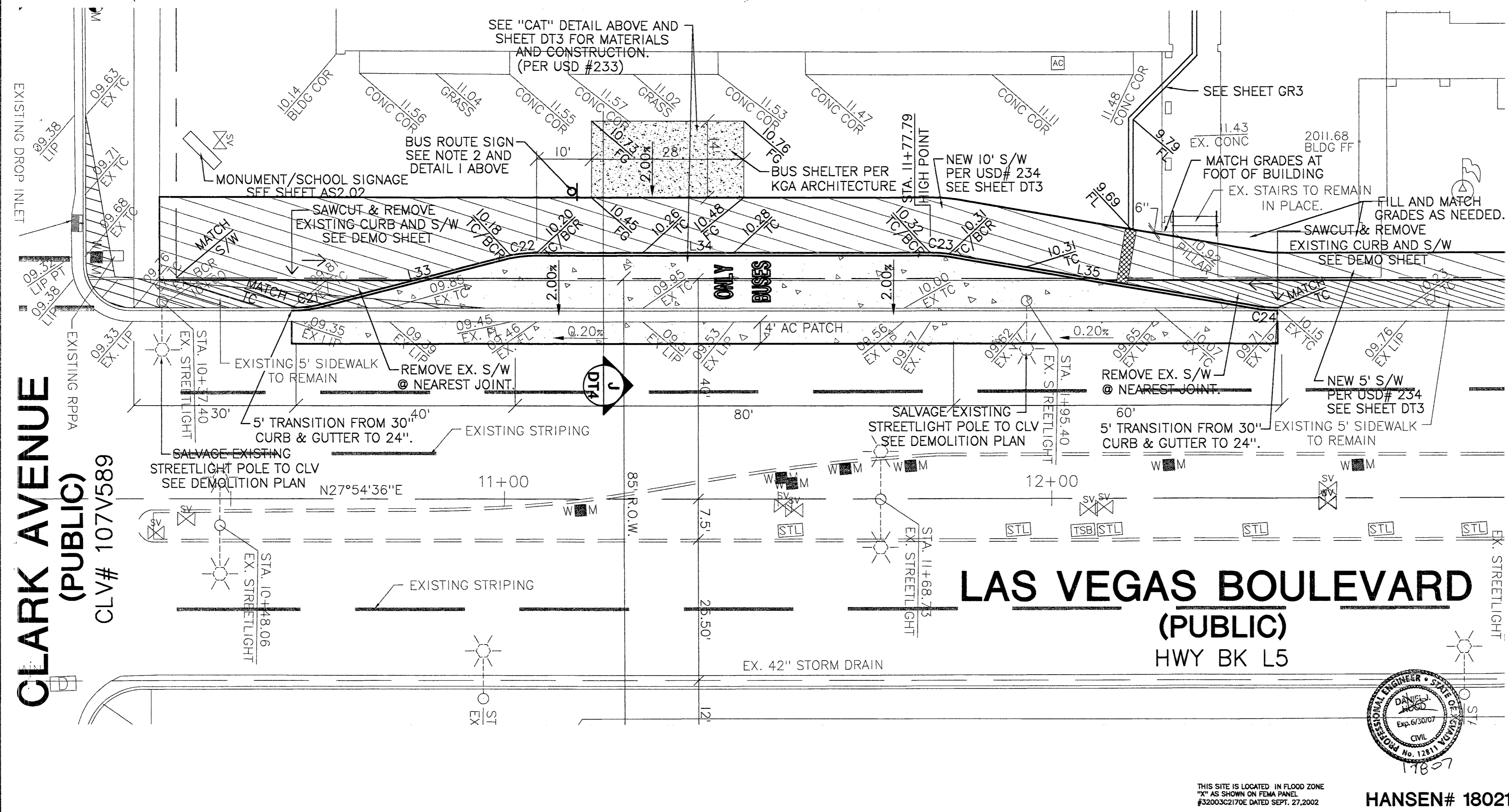

**LINE TABLE**

LINE	LENGTH	BEARING
L1	12.10	S61°24'04"E
L2	17.07	S01°56'08"E
L3	188.22	S61°56'08"E
L4	15.94	N01°56'08"W
L5	48.24	N28°03'52"E
L6	9.53	N61°56'08"W
L7	17.90	N01°56'08"W
L8	165.70	N61°56'07"W
L9	16.23	S01°56'08"E
L10	9.18	N61°53'77"W
L11	19.20	N27°55'09"E
L12	5.66	N27°55'09"E
L13	5.90	N27°55'09"E
L14	1.02	S61°31'00"E
L15	14.28	N58°03'52"E
L16	9.19	N61°53'49"W
L17	19.16	N27°54'48"E
L18	9.66	N27°54'48"E
L19	1.38	N27°54'48"E
L20	21.54	N58°03'52"E
L21	6.43	S61°56'08"E
L22	18.48	S58°03'52"W
L23	136.24	S61°56'08"E
L24	17.02	N58°03'52"E
L25	17.02	N27°54'48"E
L26	8.96	N01°56'08"W
L27	17.30	N58°03'52"E
L28	136.25	N61°56'08"W
L29	20.32	S58°03'52"W
L30	36.21	N13°25'07"E
L31	71.81	N27°52'57"E
L32	57.40	N37°32'38"E
L33	7.32	N62°04'26"W

**CURVE TABLE**

CURVE	LENGTH	RADIUS	TANGENT	DELTA
C1	3.10	3.00	1.70	59°06'54"
C2	4.65	2.50	3.40	107°24'01"
C3	19.94	20.50	10.84	53°43'13"
C4	7.76	20.50	3.93	21°40'48"
C5	32.20	20.50	20.50	90°00'00"
C6	2.62	2.50	1.44	59°59'59"
C7	5.24	2.50	4.34	120°05'05"
C8	3.95	2.50	2.52	90°34'12"
C9	1.85	3.50	0.95	30°21'52"
C10	5.11	2.50	4.09	117°05'04"
C11	3.93	2.50	2.50	89°59'14"
C12	1.32	2.50	0.67	30°09'04"
C13	2.62	2.50	1.44	60°00'00"
C14	5.24	2.50	4.33	120°00'00"
C15	4.14	2.45	2.76	96°35'59"
C16	17.33	25.94	9.00	38°15'43"
C17	1.09	2.50	0.55	24°54'00"
C18	14.46	49.46	7.28	16°45'13"
C19	2.11	2.41	1.13	50°18'01"
C20	5.24	2.50	4.33	120°00'00"
C21	4.97	25.00	2.50	11°24'02"
C22	4.80	25.05	2.41	10°58'14"
C23	3.44	25.00	1.72	7°52'22"
C24	3.42	25.00	1.71	7°50'22"
C25	0.73	2.50	0.37	16°40'29"
C26	2.61	2.50	1.44	59°51'42"

**CITY OF LAS VEGAS**  
100 EAST STEWART AVENUE  
LAS VEGAS, NEVADA 89101  
(702) 228-6535

**GRADING PLAN  
FIFTH STREET SCHOOL**

**FIFTH STREET SCHOOL  
REHABILITATION  
BUILDING DEPARTMENT SUBMITTAL**

DESIGNED BY: [Signature]  
CHECKED BY: [Signature]  
PROJECT NO.: 2017-001  
SCALE: 1"=10' HORIZ. 1"=10' VERT.

EXPIRES 06-30-07  
PROFESSIONAL ENGINEER - STATE OF NEVADA  
DANIEL J. MOOD  
No. 12811  
CIVIL  
1/18/07

SHEET  
GR2  
4 OF 11 SHEETS  
DRAWING NO.  
CLV# 513-65E

REVISION  
DATE  
BY

HANSEN# 18021

THIS SITE IS LOCATED IN FLOOD ZONE  
"X" AS SHOWN ON FEMA PANEL  
#32003C2170E DATED SEPT. 27, 2002