

PLAN NOTES

P	DESCRIPTION
P1.	DASHED LINE INDICATES STRUCTURE ABOVE TELEPHONE
P2.	NEW CONCRETE STAIR AND WALL TO MATCH EXISTING
P3.	ALIGN WALL BETWEEN WINDOWS.
P4.	AUDITORIUM WALLS SHALL BE WITH 2" THICK FABRIC ACOUSTICAL WALL PANELS SEE INTERIOR ELEVATIONS
P5.	CLEARESTORY AUDITORIUM AND PLATFORM WINDOW SHALL HAVE MOTORIZED BLACKOUT SHADES
P6.	NEW ACCESSIBLE RAMP AND RAILING
P7.	FIRE EXTINGUISHER CABINET. SEE 14/A9.01.
P8.	NEW STAIR AND HANDRAIL
P9.	MECHANICAL/MOTORIZED LIFT TO PLATFORM
P10.	RELOCATED ELECTRICAL PANEL SYSTEM. SEE ELECTRICAL DRAWINGS.
P11.	NEW CASEWORK.
P12.	NEW TWO-BAY SINK. SEE PLUMBING DWGS.
P13.	NEW REFRIGERATOR - NLC
P14.	NEW CMU WALL ENCLOSURE. SEE 5/AS2.01.
P15.	STEEL BOLLARD. SEE DETAIL SHEET AS2.01
P16.	CONCRETE PER. SEE STRUCTURAL DWGS.
P17.	GATE ENCLOSURE-SEE DETAIL 6/AS2.01
P18.	LINE OF EXISTING SKYLIGHT TO BE RESTORED
P19.	REMOVEABLE RAILING FOR TRUCK DELIVERY. SEE DETAIL 1/A1.33.
P20.	PROVIDE HORIZONTAL MANUAL WINDOW BUND AT THIS WINDOW.
P21.	EXISTING CONCRETE COLUMN TO REMAIN.
P22.	DRINKING FOUNTAIN. SEE PLUMBING DWGS.
P23.	EXISTING FOUNTAIN TO BE RENOVATED.
P24.	EXISTING COVERED BREEZEWAY
P25.	EXISTING CONSTRUCTION TO BE REMOVED AND/OR RESTORED WITH DOORS AND/OR WINDOWS TO MATCH HISTORIC ERA- REFER TO WINDOW AND DOOR SCHEDULE
P26.	FURNITURE SHOWN ON PLAN SHALL BE TENANT FURNISHED AND TENANT INSTALLED
P27.	NEW SINK. SEE PLUMBING DWGS.
P28.	EXISTING BASEMENT STAIR TO REMAIN.
P29.	INFILL STAIRWELL & CAP WITH CONC. SLAB.
P30.	EXISTING CONCRETE WALL TO BE REMOVED
P31.	SAND AND FINISH EXISTING CONCRETE WALL FOR PAINT
P32.	NEW BABY CHANGING STATION.
P33.	ALIGN FACE OF NEW PARTITION WITH FACE OF EXISTING CONCRETE
P34.	NEW COUNTER TRASH DISPOSAL.
P35.	ACCESS LADDER AND HATCH. SEE 5/A7.31
P36.	NEW CONCRETE. SEE 11/AS2.01.
P37.	1" RECESS INFILL PER 4/A9.05
P38.	LINE INDICATE DIRECTION OF WOOD PLANK FLOORING. SEE STRUCTURAL DWGS.
P39.	RECONSTRUCT SEGMENT OF PARTIAL HEIGHT WALL TO MATCH ADJACENT EXISTING WALL. REMOVE DOOR. INFILL OPENING WITH CONCRETE. FLUSH TO EXTERIOR WALL. MATCH EXISTING FINISH AND TEXTURE. PATTERNED GLASS WINDOW PER SPEC. EXISTING METAL GATE
P40.	ROOF DRAIN SEE DETAIL 3/A7.31
P41.	INSTALL NEW CABINET DOORS ON EXISTING CABINET. SEE DETAIL 5/A8.02
P42.	STAGELAM HIGH TRAFFIC FLOORING
P43.	EXISTING CONCRETE PAD TO REMAIN
P44.	EXISTING DIVIDED LIGHT TRANSOM/DOOR ASSEMBLY
P45.	CONCRETE SUMP PIT W/ STEEL GRATE
P46.	FURR OVER WINDOW.

GENERAL NOTES

- DIMENSIONS ARE TO FACE OF STUD, FACE OF MASONRY OR FACE OF CONCRETE UNLESS NOTED OTHERWISE
- INFORM ARCHITECT OF ANY DISCREPANCIES BEFORE BEGINNING WORK.
- PRIOR TO CONSTRUCTION, CONTRACTOR SHALL FIELD VERIFY ALL EXISTING CONDITIONS. IN AREAS REQUIRING REPAIR AND/OR REMOVAL, CONTRACTOR SHALL PATCH AND PREP SURFACES FOR NEW FINISH.
- PATCH ALL HOLES IN EXTERIOR CONCRETE WALLS INCLUDING LADDER HOLES, CONDUIT, AND PIPE HOLES, ETC. CAUSED BY DEMO. REPAIR AND PAINT ALL CRAWL SPACE VENT GRILLES - TYPICAL

WALL TYPES

1. WALL TYPE SYMBOL - SEE SHEET A2.32 & A2.33 FOR WALL TYPES
- NOTES
- WALL TYPES WITH AN "S" SUBSCRIPT INDICATE FIBERGLASS ACOUSTICAL INSULATION FULL HEIGHT AND DEPTH OF PARTITION NOTED AND REQUIRES THE GYP. BOARD TO EXTEND FROM TOP OF FLOOR SLAB TO UNDERSIDE OF STRUCTURE ABOVE ON ONE SIDE OF PARTITION THAT OTHERWISE WOULD NOT EXTEND TO THE STRUCTURE ABOVE.
 - PROVIDE HEAVY GAGE METAL STUDS IN LIEU OF LIGHT GAGE METAL STUDS AT WALLS WITH ANY WALL HUNG TYPE ATTACHMENTS AND/OR SUPPORTING ATTACHMENTS SUCH AS WALL SINKS, GRAB BARS, WALL CABINETS AND OTHER MISC. EQUIPMENT.
 - ALL WALLS IN WET AREAS SHALL HAVE 5/8" TYPE "X" WATER-RESISTANT GYPSUM BOARD IN LIEU OF 5/8" TYPE "X" (REGULAR) GYPSUM BOARD.
 - ALL INTERIOR PARTITIONS ARE NON-BEARING.
 - WALLS WITH SUBSCRIPT "T" INDICATES WALLS WITH THERMAL INSULATION FOR THE FULL HEIGHT OF THE WALL.

WALL LEGEND

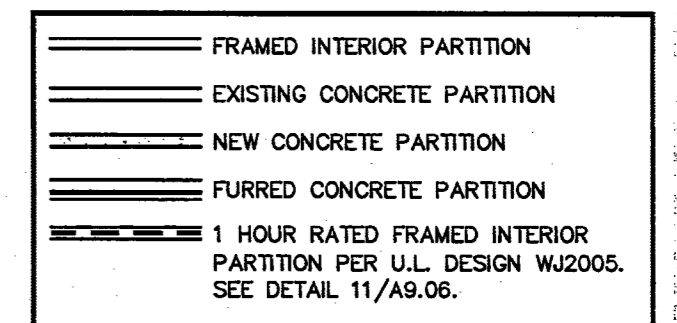

BUILDING MAP

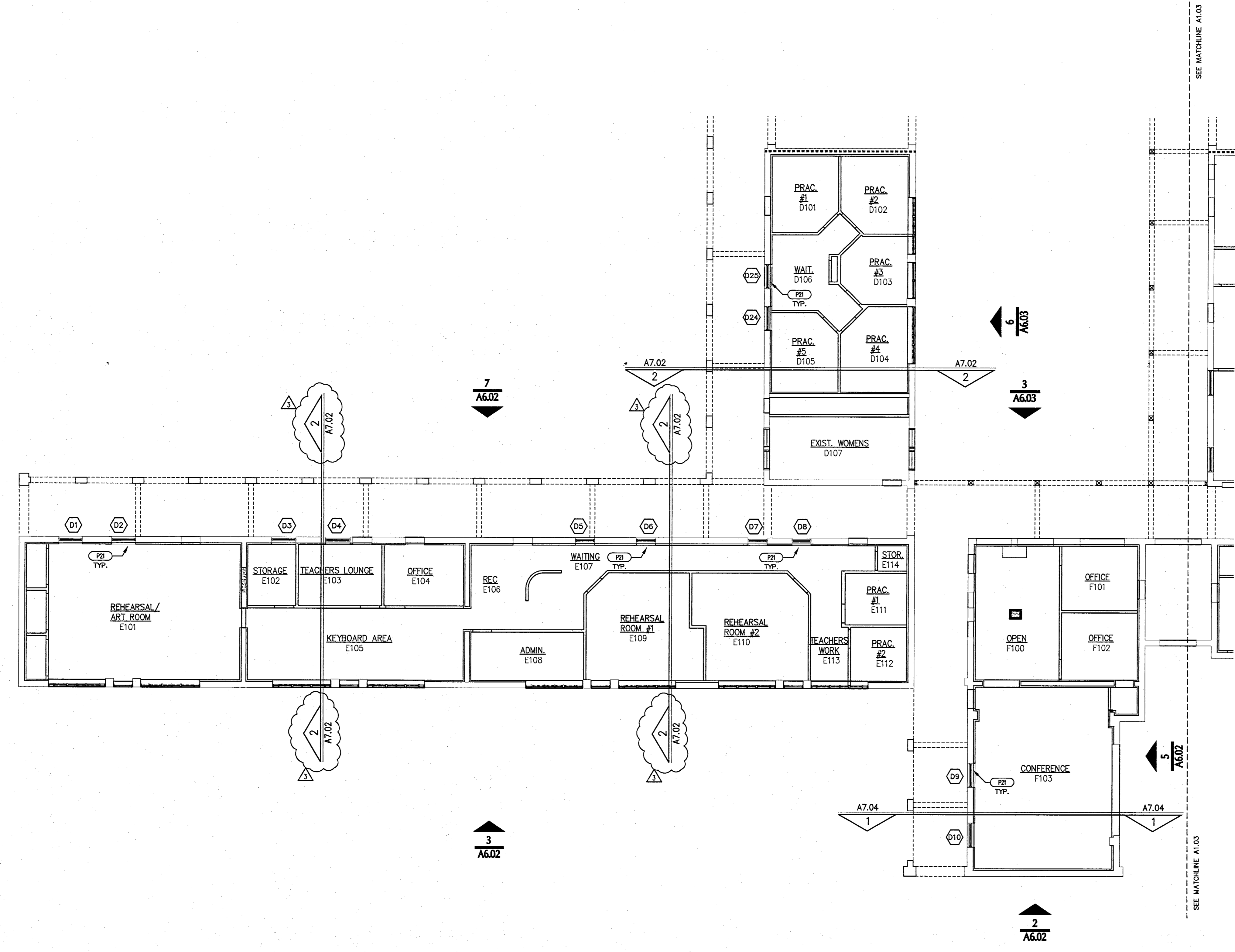
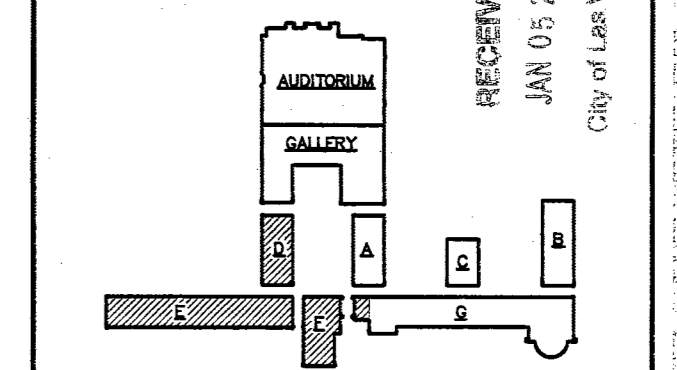

PLANS APPROVED
ARCHITECTURAL
 Building & Safety Dept.
 City of Las Vegas
 JCF JAN 12 2007

Does Not Include Electrical, Plumbing, Mechanical, Structural or Civil Improvements. Make No Change Without Approval. Plans to Not in Force in Violation of Ordinance

CLV COMMENTS
 1-4-2007

KCA ARCHITECTURE
 400 EAST STEWART AVENUE
 LAS VEGAS, NEVADA 89101
 PHONE: (702) 229-6535
 TELEPHONE: (702) 386-6646
 FACSIMILE: (702) 386-6646

HERITAGE ARCHITECTURE & PLANNING
 PHONE: 88-258-7888
 FAX: 88-258-7888

VTM
 NEVADA
 PHONE: 702-259-7258

BARKER DROTAR ASSOCIATES
 STRUCTURAL ENGINEERS
 PHONE: 702-381-8800

MECHANICAL - PLUMBING - ELECTRICAL
 USE SHEET - ACADÉMICA - GENERAL BUILDING
SEA CONSULTING ENGINEERS
 PHONE: 702-362-5555

TRACE EXTERIOR DESIGN GROUP
 PHONE: 88-200-2323

LANDSCAPE
AVZUMMO & ASSOCIATES
 PHONE: 702-381-8800

COFF ESTIMATING
RIDER HUNT LEVETT & BAILEY
 PHONE: 702-381-8800

ADA ACCESSIBILITY
ENDELMAN AND ASSOCIATES
 PHONE: 950-381-8800



FIFTH STREET SCHOOL REHABILITATION BUILDING DEPARTMENT SUBMITTAL

REVISED
 7-27-07

CITY OF LAS VEGAS REDEVELOPMENT AGENCY

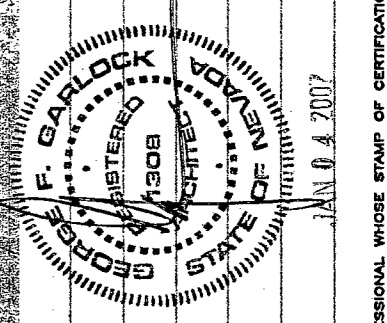

OWNER: CITY OF LAS VEGAS
 DEPARTMENT OF PUBLIC WORKS
 ARCHITECTURAL SERVICES

400 EAST STEWART AVENUE
 LAS VEGAS, NEVADA 89101
 PHONE: (702) 229-6535
 FAX: (702) 386-6646
 TDD: (702) 386-6646

DATE: 12/12/2006
 SCALE: 1/8" = 1'-0"
 SHEET NO: 513-65E
 DRAWING NO: A1.02

113257