

KCA
KCA CONSULTING ENGINEERS
4400 EAST STEWART AVENUE
LAS VEGAS, NEVADA 89151
PHONE: (702) 229-8535
FAX: (702) 384-8846
TDD: (702) 386-9108

HISTORICAL ARCHITECTURE CONSULTING ENGINEERS
ONE - 1/2
VTM
NEVADA
PHONE: 702-977-7500
FAX: 702-977-7500

BARKER DROTTER ASSOCIATES STRUCTURAL ENGINEERS
PHONE: 702-388-8000

MEDICAL - PLUMBING - ELECTRICAL - LIFE SAFETY - ACoustICAL - GENERAL LIGHTING
SEA CONSULTING ENGINEERS
PHONE: 702-342-9500

SPACE WORKING & DESIGN - COMMERCIAL LIGHTING DESIGN GROUP
PHONE: 702-342-9500

LANDSCAPE - IRRIGATION - PLUMBING - ELECTRICAL - LIFE SAFETY - ACoustICAL - GENERAL LIGHTING
SEA CONSULTING ENGINEERS
PHONE: 702-342-9500

COORINATING - RIDER HUNT LEVETT & BAILEY
PHONE: 702-342-9500

ADA ACCESSIBILITY ENDELMAN AND ASSOCIATES
PHONE: 702-342-9500



FIFTH STREET SCHOOL REHABILITATION BUILDING DEPARTMENT SUBMITTAL

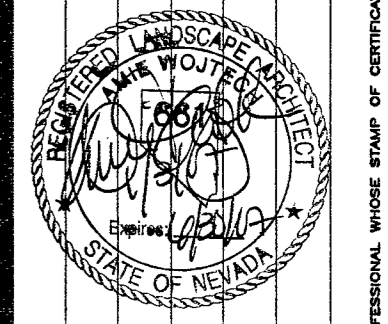
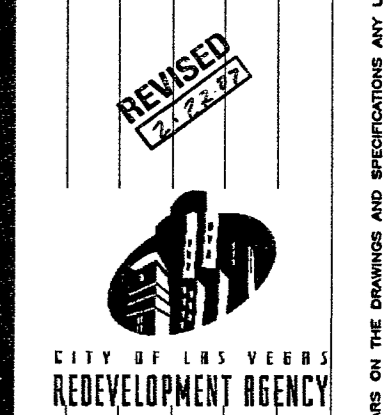

OWNER: CITY OF LAS VEGAS
DEPARTMENT OF PUBLIC WORKS
ARCHITECTURAL SERVICES

DATE: 12/12/2006
SCALE: 1" = 20'-0"
DRAWING NO: IRRIGATION PLAN
SHEET NO: L4.01

113246

IRRIGATION EQUIPMENT LEGEND

SYMBOL	DESCRIPTION	MANUFACTURER	MODEL	SIZE & NOTES
PC	POINT OF CONNECTION	SEE UTILITY PLAN		
GV	CAST IRON GATE VALVE	NIBCO OR MILWAUKEE		SIZE PER LINE
CC	QUICK COUPLING VALVE W/KEY & SNIWEL	RAINBIRD	44 NP 30 6PM	1" - INSTALL WITHIN 24" FROM SIDEWALK EDGE.
SV	SOLENOID VALVE WITH NYE FILTER/BALL VALVE	RAINBIRD	100-PEB SERIES RBY-100-200MX	SIZE PER PLAN 1" NYE FILTER WITH AG. PRODUCT BALL VALVE
PR	PRESSURE REGULATOR	RAINBIRD	PSI-M30X-75	3/4"
IC	IRRIGATION CONTROLLER	RAINBIRD	ESP-24SAT-2X+HM	24 STATIONS, POWDER COATED STEEL CABINET
ML	PVC MAINLINE		SCHEDULE 40	2"
LL	PVC LATERAL LINE		SCHEDULE 40	1"
LLT	PVC LATERAL LINE (FOR TREES)		SCHEDULE 40	1"
FT	FLEXIBLE TUBING	EXCALIBUR		1/2" IPS
EM	EMITTER	AGRIFIM UNI-FLO	UFC 10/WFC 20	SEE EMITTER SCHEDULE
EMT	INLINE EMITTER TUBING (EXISTING TREES)	AGRIFIM W/FLUSH CAP VALVES	SFFC-BL-7424-05	SEE EMITTER SCHEDULE AND NOTE 12
SU	SLEEVE UNDER PAVED AREAS		SCHEDULE 40	SEE IRRIGATION NOTE 4

IRRIGATION CONTROLLER
1/2" GPM - FLOW IN GPM
SIZE - TYPE - PLANT MATERIAL
VALVE SIZE

EMITTER SCHEDULE

PLANT SIZE	G.P.H.	QTY.	EMITTER	MANUFACTURER
48" BOX	48	24	(UFC 20)	AGRIFIM
24" BOX	24	12	(UFC 20)	AGRIFIM
5 GAL.	2	2	(UFC 10)	AGRIFIM
EXISTING TREES	20	TUBING	SFFC-BL-7424-05	AGRIFIM

IRRIGATION NOTES

- THE CONTRACTOR SHALL VERIFY THE STATIC PRESSURE AT THE POINT OF CONNECTION AND MAKE FINAL CONNECTIONS ALLOWING FOR ANY POSSIBLE DEVIATIONS FROM LOCATION SHOWN ON PLANS DUE TO SITE CONDITIONS. ANY DEVIATIONS FROM THE DESIGN SHALL BE BROUGHT TO THE ATTENTION OF THE OWNER'S REPRESENTATIVE.
- THE IRRIGATION PLAN IS DRAWN FOR GRAPHIC CLARITY, WHERE PIPING AND VALVES ARE SHOWN IN CONCRETE OR PAVED AREAS. THE INTENT IS FOR THE PIPING AND VALVES TO BE PLACED IN THE ADJACENT PLANTING AREAS.
- INSTALL SLEEVING BASED ON THE SIZING GUIDE BELOW:

PIPE SIZE	REQUIRED SLEEVING
6" PVC	1 - 12" SCH 80 PVC SLEEVE
3" TO 4" PVC	1 - 8" SCH 80 PVC SLEEVE
1 1/2" TO 2" PVC	1 - 4" SCH 40 PVC SLEEVE
1" TO 1 1/2" PVC	1 - 3" SCH 40 PVC SLEEVE
3/4" PVC	1 - 2" SCH 40 PVC SLEEVE

WIRE QUANTITY	REQUIRED SLEEVING
1 - 20 CONTROL WIRES	1 - 2" SCH 40 PVC SLEEVE
21 - 40 CONTROL WIRES	2 - 2" SCH 40 PVC SLEEVE
- CONTRACTOR TO PROVIDE ALL NECESSARY SLEEVING UNDER ROADS, CONCRETE SLABS, ETC.
- ALL VALVE BOXES TO BE PERMANENTLY BRANDED WITH CONTROLLER LETTER & STATION (EXAMPLES: STATION = A3, QUICK COUPLER = CC, GATE VALVE = GV, PRESSURE REGULATOR = PR) LETTER AND STATION IDENTIFICATION SHALL BE 2 INCH HIGH MIN. VALVE BOXES TO HAVE LOCKING CAPABILITY. VALVE BOXES TO BE LOCATED IN PLANTING BEDS ONLY.
- ALL VALVES ARE TO BE NUMBERED WITH CHRISTY TAGS.
- CONTRACTOR IS RESPONSIBLE TO VERIFY UTILITY LOCATION, OBTAIN COORDINATE AND PAY FOR ANY PERMITS AND ALL INSPECTIONS AS REQUIRED.
- CONTRACTOR RESPONSIBLE FOR POWER CONNECTION TO IRRIGATION CONTROLLER. CONTRACTOR SHALL PROVIDE A HARD LINE PHONE LINE FOR FUTURE MAXCOM CONNECTION. REFER TO SHEET T1.11 FOR EXACT LOCATION AND FURTHER INFORMATION AND REFER TO SHEET E2.11 FOR POWER INFORMATION.
- IN ALL AREAS TO REMAIN, CONTRACTOR IS TO PROVIDE NEW IRRIGATION COMPONENTS. IT IS THE RESPONSIBILITY OF THE CONTRACTOR TO ENSURE ALL PLANT MATERIAL TO REMAIN IS WATERED DURING DEMOLITION AND CONSTRUCTION. SEE SHEET L1.01 FOR LOCATION OF EXISTING MATERIAL TO REMAIN.
- CONTRACTOR SHALL LOCATE AND VERIFY SIZE, LINE TYPE, CONDITION, DEPTH, PRESSURE, AND LOCATION OF ALL EXISTING UTILITY LINES WITHIN THE CONSTRUCTION AREA PRIOR TO CONSTRUCTION.
- SEE SHEETS L5.02 FOR IRRIGATION DETAILS.
- INLINE EMITTER TUBING SHALL HAVE A FLOW RATE OF 1/2 GPM WITH 24" EMITTER SPACING. INLINE EMITTER TUBING SHALL BE PLACED AT DRIP LINE OF EXISTING TREE. WHEN TUBING CANNOT BE PLACED AT DRIP LINE OF TREE CONTRACTOR TO PAINT PROPOSED LOCATION FOR APPROVAL BY OWNERS REPRESENTATIVE.
- CONTRACTOR TO VERIFY IF A BACKFLOW PREVENTION DEVICE EXISTS AFTER EXISTING POINT OF CONNECTION. IT IS THE RESPONSIBILITY OF THE CONTRACTOR TO ENSURE THAT THE BACKFLOW PREVENTION DEVICE IS IN PROPER WORKING ORDER AND IS IN COMPLIANCE WITH ALL CODES AND REGULATIONS SET FORTH BY LVYMD. IF A BACKFLOW PREVENTION DEVICE DOES NOT EXIST THE CONTRACTOR SHALL INSTALL THE BACKFLOW PREVENTION DEVICE.
MANUFACTURER: FESCO
MODEL NUMBER: 925 YA (SIZE PER LINE) W/ALUMINUM ENCLOSURE (SEE IRRIGATION DETAILS)

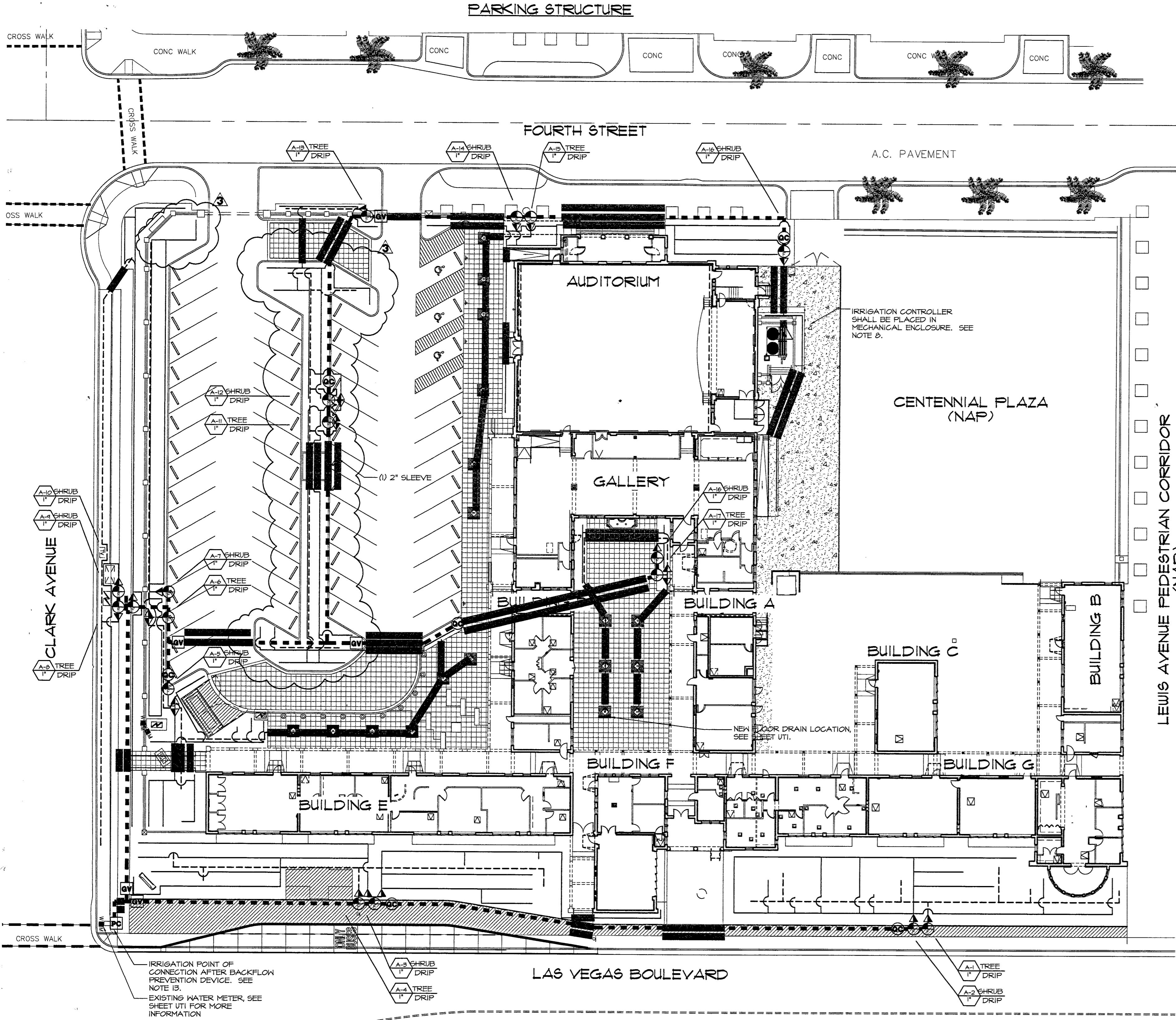

Call before you OVERHEAD 1-702-593-6111
Call before you Dig. 1-800-227-2600

WZUNINO & ASSOCIATES
LANDSCAPE ARCHITECTURE - LAND PLANNING
3191 South Jones Blvd. Las Vegas, Nevada 89146
Phone (702) 253-4300 Fax (702) 253-4076 Email wzunino@msn.com

