

115670

MASTER EGRESS PLAN

SCALE: 1/16" = 1'-0"

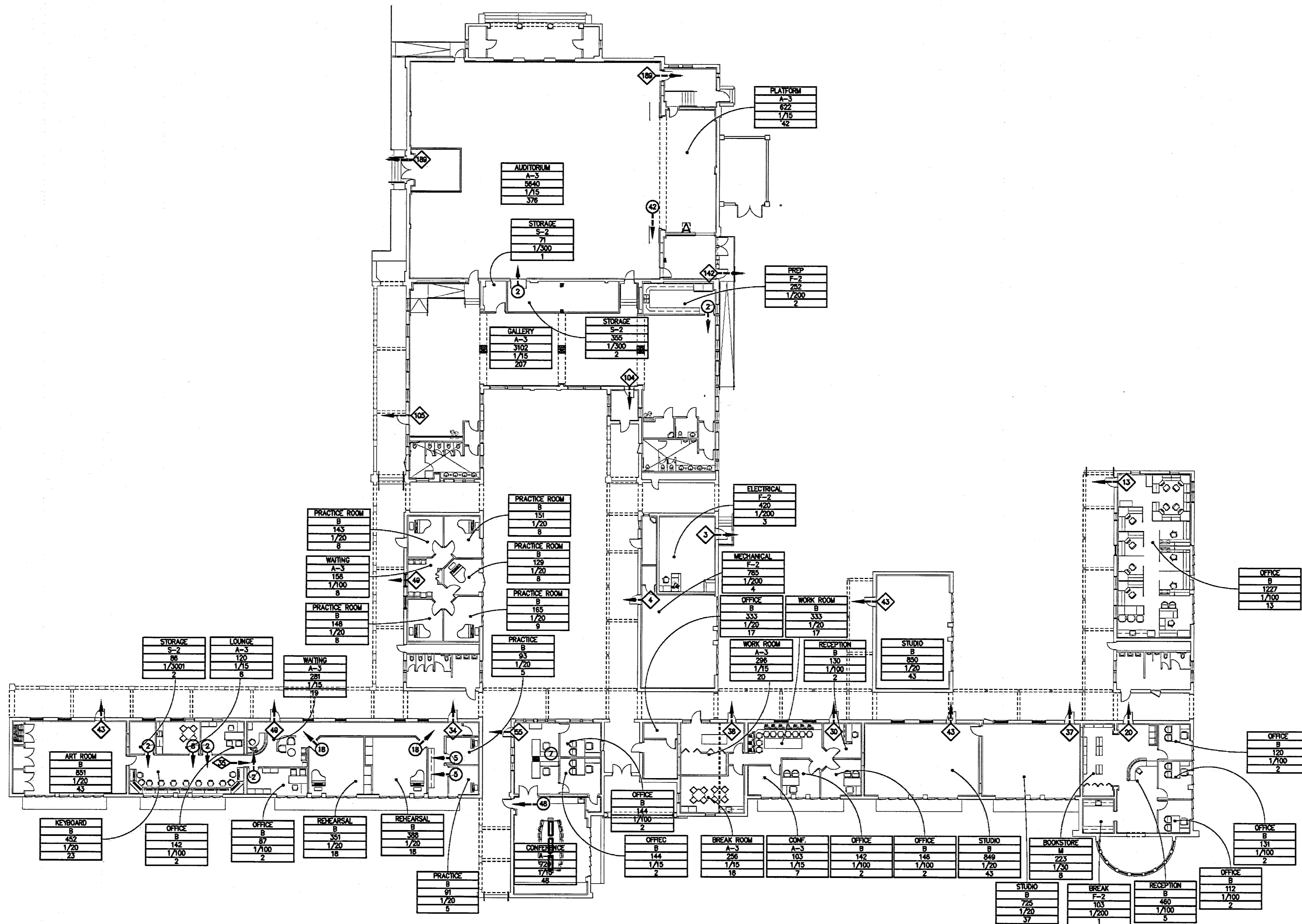

EGRESS LEGEND

- | | |
|--|----------------------|
| | ROOM NAME |
| | OCCUPANCY CLASS |
| | AREA IN SQ. FT. |
| | OCCUPANT LOAD FACTOR |
| | NO. OF OCCUPANTS |
- | | |
|--|------------------------|
| | EXIT NUMBER |
| | CLEAR EXIT WIDTH (IN.) |
| | WIDTH PER PERSON |
| | MAX. CAPACITY |
- | | |
|--|---------------------|
| | OCCUPANTS PER SPACE |
|--|---------------------|
- | | |
|--|-----------------------|
| | ACCUMULATED OCCUPANTS |
|--|-----------------------|
- | | |
|--|-----------------|
| | TOTAL OCCUPANTS |
|--|-----------------|
- | | |
|--|--------------------------|
| | DIRECTION/PATH OF EGRESS |
|--|--------------------------|

BUILDING MAP

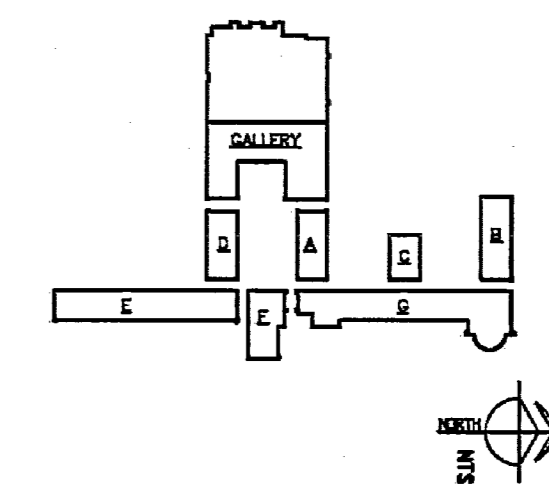

VICINITY MAP

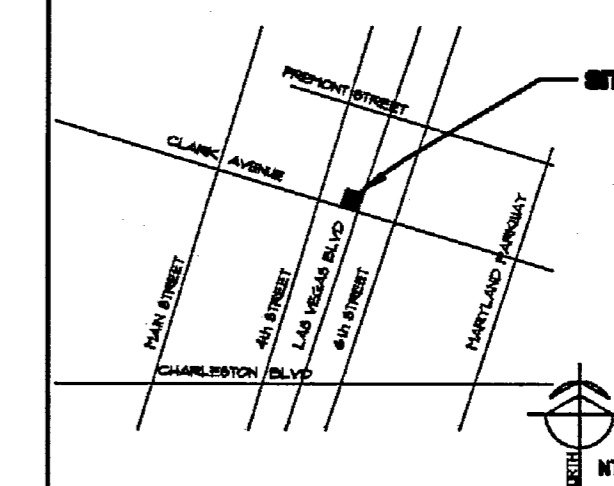

KCA ARCHITECTURE
 400 EAST STEWART AVENUE
 LAS VEGAS, NEVADA 89103
 PHONE: (702) 259-8335
 FAX: (702) 384-8846
 WWW: KCAARCHITECTURE.COM

HERITAGE ARCHITECTURE CONSULTING ENGINEERS
 1000 W. WASHINGTON
 SUITE 200
 LAS VEGAS, NEVADA 89102
 PHONE: (702) 259-8335

BARBER DROTTER ASSOCIATES STRUCTURAL ENGINEERS
 1000 W. WASHINGTON
 SUITE 200
 LAS VEGAS, NEVADA 89102
 PHONE: (702) 259-8335

MECHANICAL - PLUMBING - ELECTRICAL - LIFE SAFETY - ACoustical - ENVIRONMENTAL
SEA CONSULTING ENGINEERS
 1000 W. WASHINGTON
 SUITE 200
 LAS VEGAS, NEVADA 89102
 PHONE: (702) 259-8335

CDM+ LIGHTING DESIGN GROUP
 1000 W. WASHINGTON
 SUITE 200
 LAS VEGAS, NEVADA 89102
 PHONE: (702) 259-8335

JWCORNO & ASSOCIATES
 1000 W. WASHINGTON
 SUITE 200
 LAS VEGAS, NEVADA 89102
 PHONE: (702) 259-8335

RIDER HUNT LEVETT & BAILEY
 1000 W. WASHINGTON
 SUITE 200
 LAS VEGAS, NEVADA 89102
 PHONE: (702) 259-8335

ANDERSON AND ASSOCIATES
 1000 W. WASHINGTON
 SUITE 200
 LAS VEGAS, NEVADA 89102
 PHONE: (702) 259-8335

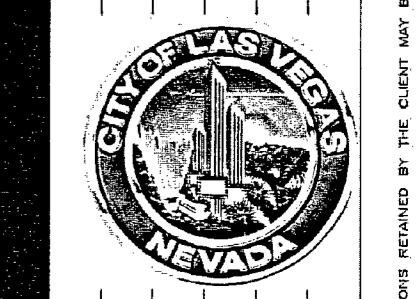

FIFTH STREET SCHOOL REHABILITATION
 DESIGN DEVELOPMENT SUBMITTAL



CITY OF LAS VEGAS REDEVELOPMENT AGENCY
 400 EAST STEWART AVENUE
 LAS VEGAS, NEVADA 89103
 PHONE: (702) 259-8335
 FAX: (702) 384-8846
 WWW: CLV.DIGITALCITY.COM

OWNER: CITY OF LAS VEGAS
 DEPARTMENT OF PUBLIC WORKS
 ARCHITECTURAL SERVICES

DATE: 9/14/2006
SCALE: 1/16" = 1'-0"
NO. AX1.01