

PLAN NOTES

P	DESCRIPTION
P1.	DASHED LINE INDICATES STRUCTURE ABOVE TELEPHONE
P2.	NEW CONCRETE STAIR AND WALL TO MATCH EXISTING
P3.	ALIGN WALL BETWEEN WINDOWS. AUDITORIUM WALLS SHALL BE WITH 2" THICK FABRIC ACOUSTICAL WALL PANELS SEE INTERIOR ELEVATIONS
P4.	CLERESTORY AUDITORIUM AND PLATFORM WINDOW SHALL HAVE MOTORIZED BLACKOUT SHADES
P5.	NEW ACCESSIBLE RAMP AND RAILING
P6.	FIRE EXTINGUISHER CABINET. SEE 14/AG.01
P7.	NEW STAIR AND HANDRAIL
P8.	MECHANICAL/MOTORIZED LIFT TO PLATFORM
P9.	RELOCATED ELECTRICAL PANEL SYSTEM. SEE ELECTRICAL DRAWINGS.
P10.	NEW CASEWORK
P11.	NEW TWO-BAY SINK. SEE PLUMBING DWGS.
P12.	NEW REFRIGERATOR - N.L.C.
P13.	NEW CMU WALL ENCLOSURE. SEE 5/AS2.01
P14.	STEEL BOLLARD. SEE DETAIL SHEET AS2.01
P15.	CONCRETE PIER. SEE STRUCTURAL DWGS.
P16.	GATE ENCLOSURE-SEE DETAIL 6/AS2.01
P17.	LINE OF EXISTING SKYLIGHT TO BE RESTORED
P18.	REMOVABLE RAILING FOR TRUCK DELIVERY. SEE DETAIL 1/A1.33
P19.	PROVIDE HORIZONTAL MANUAL WINDOW BLIND AT THIS WINDOW
P20.	EXISTING CONCRETE COLUMN TO REMAIN
P21.	DRINKING FOUNTAIN. SEE PLUMBING DWGS.
P22.	EXISTING FOUNTAIN TO BE RENOVATED
P23.	EXISTING COVERED BREEZEWAY
P24.	EXISTING CONSTRUCTION TO BE REMOVED AND/OR RESTORED WITH DOORS AND/OR WINDOWS TO MATCH HISTORIC ERA
P25.	REFER TO WINDOW AND DOOR SCHEDULE FURNITURE SHOWN ON PLAN SHALL BE TENANT FURNISHED AND TENANT INSTALLED
P26.	NEW SINK. SEE PLUMBING DWGS.
P27.	EXISTING BASEMENT STAIR TO REMAIN
P28.	INFILL STAIRWELL & GAP WITH CONC. SLAB
P29.	EXISTING CONCRETE WALL TO BE REMOVED SAND AND FINISH EXISTING CONCRETE WALL FOR PAINT
P30.	NEW BABY CHANGING STATION
P31.	ALIGN FACE OF NEW PARTITION WITH FACE OF EXISTING CONCRETE
P32.	NEW COUNTER TRASH DISPOSAL
P33.	ACCESS LADDER AND HATCH SEE 5/A7.31
P34.	NEW CONCRETE. SEE 11/AS2.01
P35.	1" RECESS INFILL PER 4/AG.05
P36.	NEW CONCRETE. SEE 11/AS2.01
P37.	FLOORING. SEE STRUCTURAL DWGS.
P38.	RECONSTRUCT SEGMENT OF PARTIAL HEIGHT WALL TO MATCH ADJACENT EXISTING WALL
P39.	REMOVE DOOR, INFILL OPENING WITH CONCRETE. FLUSH TO EXTERIOR WALL MATCH EXISTING FINISH AND TEXTURE
P40.	PATTERNED GLASS WINDOW PER SPEC.
P41.	EXISTING METAL GATE
P42.	ROOF DRAIN SEE DETAIL 3/A7.31
P43.	INSTALL NEW CABINET DOORS ON EXISTING CABINET. SEE DETAIL 5/AB.02
P44.	STAGELAM HIGH TRAFFIC FLOORING
P45.	EXISTING CONCRETE PAD TO REMAIN
P46.	EXISTING DIVIDED LIGHT TRANSOM/DOOR ASSEMBLY
P47.	CONCRETE SUMP PIT W/ STEEL GRATE
P48.	FURR OVER WINDOW.
P49.	

GENERAL NOTES

- DIMENSIONS ARE TO FACE OF STUD, FACE OF MASONRY OR FACE OF CONCRETE UNLESS NOTED OTHERWISE.
- INFORM ARCHITECT OF ANY DISCREPANCIES BEFORE BEGINNING OF WORK
- PRIOR TO CONSTRUCTION, CONTRACTOR SHALL FIELD VERIFY ALL EXISTING CONDITIONS. IN AREAS REQUIRING REPAIR AND/OR REMOVAL, CONTRACTOR SHALL PATCH AND PREP SURFACES FOR NEW FINISH
- FOR NEW FINISH IN EXTERIOR CONCRETE WALLS INCLUDING LADDER HOLES, CONDUIT, AND PIPE HOLES, ETC. CAUSED BY DEMO, REPAIR AND PAINT ALL CRAWL SPACE VENT GRILLES - TYPICAL.

WALL TYPES

- NOTES**
- WALL TYPES WITH AN "S" SUBSCRIPT INDICATE FIBERGLASS ACOUSTICAL INSULATION FULL HEIGHT AND DEPTH OF PARTITION NOTED AND REQUIRES THE GYP. BOARD TO EXTEND FROM TOP OF FLOOR SLAB TO UNDERSIDE OF STRUCTURE ABOVE ON ONE SIDE OF PARTITION THAT OTHERWISE WOULD NOT EXTEND TO THE STRUCTURE ABOVE.
 - PROVIDE HEAVY GAGE METAL STUDS IN LIEU OF LIGHT GAGE METAL STUDS AT WALLS WITH ANY WALL HUNG TYPE ATTACHMENTS AND/OR SUPPORTING ATTACHMENTS SUCH AS WALL SINKS, GRAB BARS, WALL CABINETS AND OTHER MISC. EQUIPMENT.
 - ALL WALLS IN WET AREAS SHALL HAVE 5/8" TYPE "X" WATER-RESISTANT GYPSUM BOARD IN LIEU OF 5/8" TYPE "X" (REGULAR) GYPSUM BOARD.
 - ALL INTERIOR PARTITIONS ARE NON-BEARING.
 - WALLS WITH SUBSCRIPT "T" INDICATES WALLS WITH THERMAL INSULATION FOR THE FULL HEIGHT OF THE WALL.

WALL LEGEND

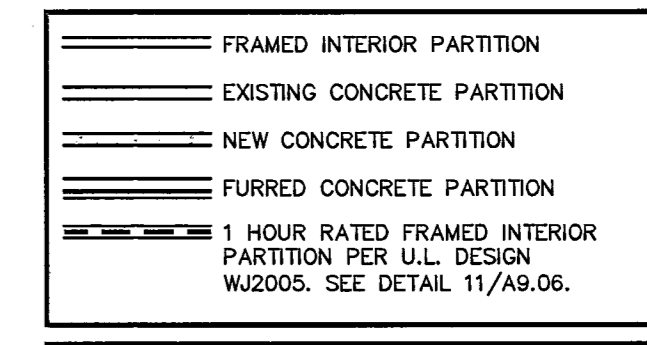

BUILDING MAP

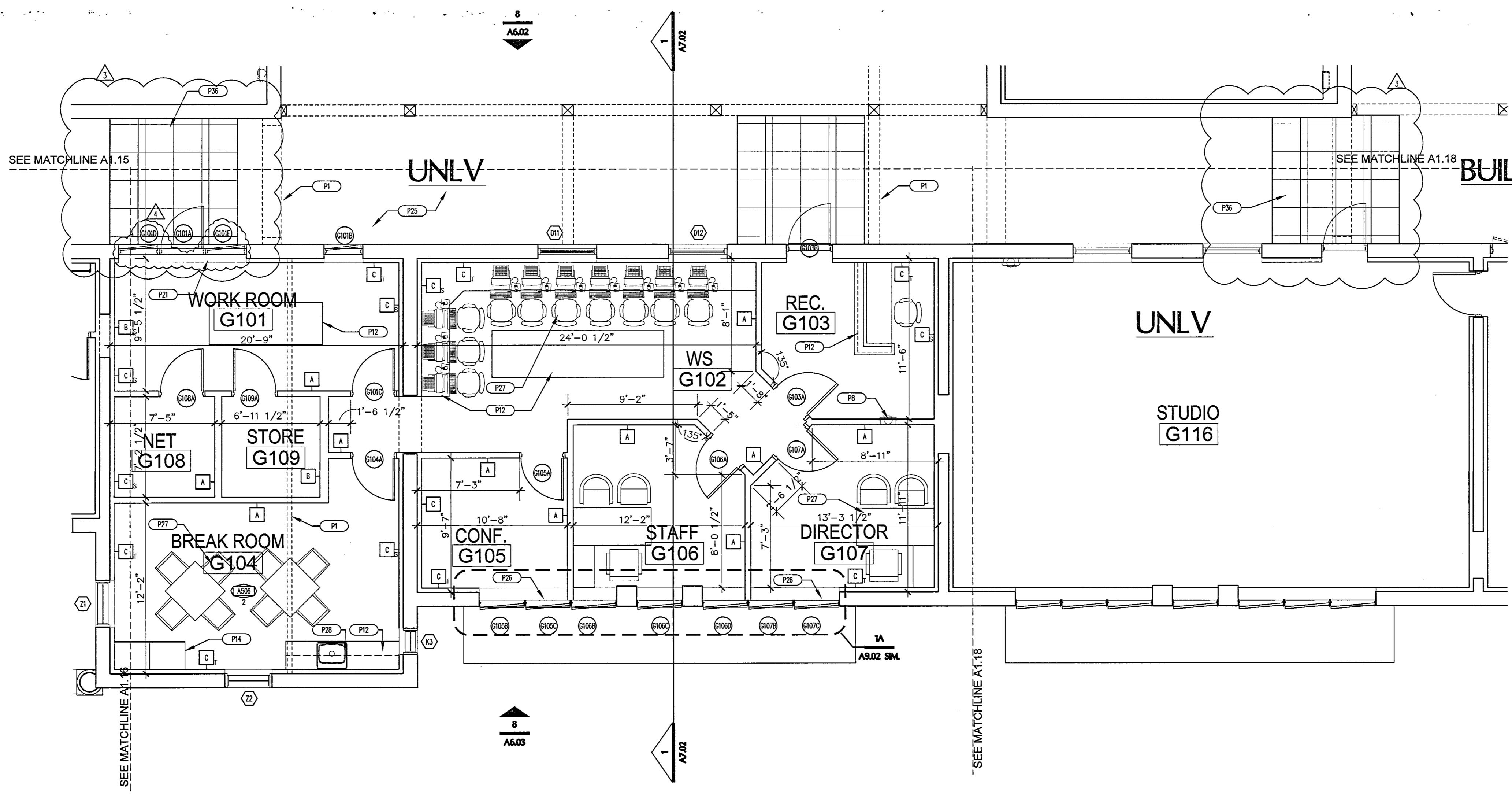
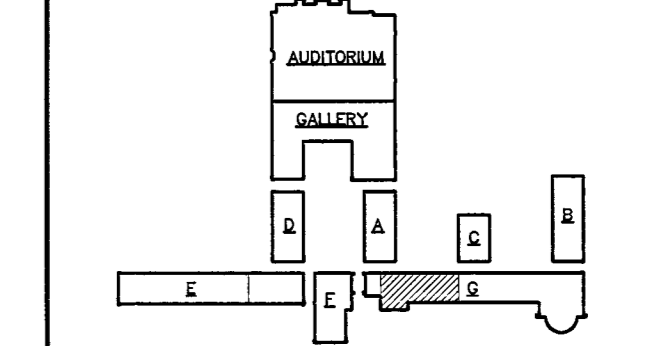

PLAN NOTES

P	DESCRIPTION
P1.	DASHED LINE INDICATES STRUCTURE ABOVE TELEPHONE
P2.	NEW CONCRETE STAIR AND WALL TO MATCH EXISTING
P3.	ALIGN WALL BETWEEN WINDOWS. AUDITORIUM WALLS SHALL BE WITH 2" THICK FABRIC ACOUSTICAL WALL PANELS SEE INTERIOR ELEVATIONS
P4.	CLERESTORY AUDITORIUM AND PLATFORM WINDOW SHALL HAVE MOTORIZED BLACKOUT SHADES
P5.	NEW ACCESSIBLE RAMP AND RAILING
P6.	FIRE EXTINGUISHER CABINET. SEE 14/AG.01
P7.	NEW STAIR AND HANDRAIL
P8.	MECHANICAL/MOTORIZED LIFT TO PLATFORM
P9.	RELOCATED ELECTRICAL PANEL SYSTEM. SEE ELECTRICAL DRAWINGS.
P10.	NEW CASEWORK
P11.	NEW TWO-BAY SINK. SEE PLUMBING DWGS.
P12.	NEW REFRIGERATOR - N.L.C.
P13.	NEW CMU WALL ENCLOSURE. SEE 5/AS2.01
P14.	STEEL BOLLARD. SEE DETAIL SHEET AS2.01
P15.	CONCRETE PIER. SEE STRUCTURAL DWGS.
P16.	GATE ENCLOSURE-SEE DETAIL 6/AS2.01
P17.	LINE OF EXISTING SKYLIGHT TO BE RESTORED
P18.	REMOVABLE RAILING FOR TRUCK DELIVERY. SEE DETAIL 1/A1.33
P19.	PROVIDE HORIZONTAL MANUAL WINDOW BLIND AT THIS WINDOW
P20.	EXISTING CONCRETE COLUMN TO REMAIN
P21.	DRINKING FOUNTAIN. SEE PLUMBING DWGS.
P22.	EXISTING FOUNTAIN TO BE RENOVATED
P23.	EXISTING COVERED BREEZEWAY
P24.	EXISTING CONSTRUCTION TO BE REMOVED AND/OR RESTORED WITH DOORS AND/OR WINDOWS TO MATCH HISTORIC ERA
P25.	REFER TO WINDOW AND DOOR SCHEDULE FURNITURE SHOWN ON PLAN SHALL BE TENANT FURNISHED AND TENANT INSTALLED
P26.	NEW SINK. SEE PLUMBING DWGS.
P27.	EXISTING BASEMENT STAIR TO REMAIN
P28.	INFILL STAIRWELL & GAP WITH CONC. SLAB
P29.	EXISTING CONCRETE WALL TO BE REMOVED SAND AND FINISH EXISTING CONCRETE WALL FOR PAINT
P30.	NEW BABY CHANGING STATION
P31.	ALIGN FACE OF NEW PARTITION WITH FACE OF EXISTING CONCRETE
P32.	NEW COUNTER TRASH DISPOSAL
P33.	ACCESS LADDER AND HATCH SEE 5/A7.31
P34.	NEW CONCRETE. SEE 11/AS2.01
P35.	1" RECESS INFILL PER 4/AG.05
P36.	NEW CONCRETE. SEE 11/AS2.01
P37.	FLOORING. SEE STRUCTURAL DWGS.
P38.	RECONSTRUCT SEGMENT OF PARTIAL HEIGHT WALL TO MATCH ADJACENT EXISTING WALL
P39.	REMOVE DOOR, INFILL OPENING WITH CONCRETE. FLUSH TO EXTERIOR WALL MATCH EXISTING FINISH AND TEXTURE
P40.	PATTERNED GLASS WINDOW PER SPEC.
P41.	EXISTING METAL GATE
P42.	ROOF DRAIN SEE DETAIL 3/A7.31
P43.	INSTALL NEW CABINET DOORS ON EXISTING CABINET. SEE DETAIL 5/AB.02
P44.	STAGELAM HIGH TRAFFIC FLOORING
P45.	EXISTING CONCRETE PAD TO REMAIN
P46.	EXISTING DIVIDED LIGHT TRANSOM/DOOR ASSEMBLY
P47.	CONCRETE SUMP PIT W/ STEEL GRATE
P48.	FURR OVER WINDOW.
P49.	

CLV COMMENTS
14-2007

OWNER COMMENTS
09-2007

ARCHITECTURE
KCA
KUTERALL GARLOCK ARCHITECTURE
400 SOUTH POLARIS AVENUE
LAS VEGAS, NEVADA 89102
PHONE: 702.337.3600
FACSIMILE: 702.337.3943

STRUCTURAL
BARKER DROTTER ASSOCIATES
STRUCTURAL ENGINEERS
PHONE: 702.380.8000

MECHANICAL - PLUMBING - ELECTRICAL - FIRE SAFETY - ACOUSTICAL - GREEN BUILDING
JBA CONSULTING ENGINEERS
PHONE: 702.362.9200

STAGE LIGHTING & DESIGN
COM-LIGHTING DESIGN GROUP
PHONE: 88-238-2323

LANDSCAPE
JWZUMMO & ASSOCIATES
PHONE: 702.251.5990

COST ESTIMATING
RIDER HUNT
LEVETT & BAILEY
702.527.9888

ADA ACCESSIBILITY
ENDELMAN AND ASSOCIATES
PHONE: 266-3444

CITY OF LAS VEGAS
REDEVELOPMENT AGENCY

OWNER: CITY OF LAS VEGAS
DEPARTMENT OF PUBLIC WORKS ARCHITECTURAL SERVICES

400 EAST STRAWBERRY AVENUE
LAS VEGAS, NEVADA 89102
PHONE: (702) 226-6535
FACSIMILE: (702) 388-4866
TDD: (702) 388-9108

ED C.
UNLV OFFICE SPACE
12/12/2006
SCALE
1/4" = 1'-0"
SYMBOL NO.
513-65E

1

A1.17

115682

ENLARGED FLOOR PLAN - UNLV OFFICE SPACE

SCALE: 1/4" = 1'-0"