

BUILDING D
NSA

PLAN NOTES

- | P | DESCRIPTION |
|------|--|
| P1. | DASHED LINE INDICATES STRUCTURE ABOVE TELEPHONE |
| P2. | NEW CONCRETE STAIR AND WALL TO MATCH EXISTING |
| P3. | AUDITORIUM WALLS SHALL BE WITH 2" THICK FABRIC ACOUSTICAL WALL PANELS SEE INTERIOR ELEVATIONS |
| P4. | CLERESTORY AUDITORIUM AND PLATFORM WINDOW SHALL HAVE MOTORIZED BLINDS |
| P5. | NEW ACCESSIBLE RAMP AND RAILING |
| P6. | FIRE EXTINGUISHER CABINET. SEE 14/A9.01. |
| P7. | NEW STAIR AND HANDRAIL |
| P8. | MECHANICAL/MOTORIZED LIFT TO PLATFORM |
| P9. | RELOCATED ELECTRICAL PANEL SYSTEM. SEE ELECTRICAL DRAWINGS. |
| P10. | NEW CASEWORK |
| P11. | NEW TWO-BAY SINK. SEE PLUMBING DWGS. |
| P12. | NEW REFRIGERATOR - N.I.C. |
| P13. | NEW CMU WALL ENCLOSURE. SEE 5/A52.01. |
| P14. | STEEL BOLLARD. SEE DETAIL SHEET AS2.01. |
| P15. | CONCRETE PIER. SEE STRUCTURAL DWGS. |
| P16. | GATE ENCLOSURE-SEE DETAIL 6/A52.01 |
| P17. | LINE OF EXISTING SKYLIGHT TO BE RESTORED. |
| P18. | REMOVABLE RAILING FOR TRUCK DELIVERY. SEE DETAIL 1/A1.33. |
| P19. | PROVIDE HORIZONTAL WINDOW BLIND AT THIS WINDOW. |
| P20. | EXISTING CONCRETE COLUMN TO REMAIN. |
| P21. | DRINKING FOUNTAIN. SEE PLUMBING DWGS. |
| P22. | EXISTING FOUNTAIN TO BE REVOLVED. |
| P23. | EXISTING COVERED BREEZEWAY |
| P24. | EXISTING CONSTRUCTION TO BE REMOVED AND/OR RESTORED WITH DOORS AND/OR WINDOWS TO MATCH HISTORIC ER |
| P25. | REFER TO WINDOW AND DOOR SCHEDULE FURNITURE SHOWN ON PLAN SHALL BE TENANT FURNISHED AND TENANT INSTALLED |
| P26. | NEW SINK. SEE PLUMBING DWGS. |
| P27. | EXISTING BASEMENT STAIR TO REMAIN. |
| P28. | INFILL STAIRWELL & CAP WITH CONC. SLAB. |
| P29. | EXISTING CONCRETE WALL TO BE REMOVED SAND AND FINISH EXISTING CONCRETE WALL FOR PAINT. |
| P30. | NEW BABY CHANGING STATION. |
| P31. | ALIGN FACE OF NEW PARTITION WITH FACE OF EXISTING CONCRETE |
| P32. | NEW COUNTER TRASH DISPOSAL. |
| P33. | ACCESS LADDER AND HATCH SEE 5/A7.31 |
| P34. | NEW CONCRETE. SEE 11/A52.01. |
| P35. | 1" RECESS INFILL PER 4/A9.05 |
| P36. | LINE INDICATE DIRECTION OF WOOD PLANK FLOORING. SEE STRUCTURAL DWGS. |
| P37. | RECONSTRUCT SEGMENT OF PARTIAL HEIGHT WALL TO MATCH ADJACENT EXISTING WALL |
| P38. | REMOVE DOOR, INFILL OPENING WITH CONCRETE. FLUSH TO EXTERIOR WALL. MATCH EXISTING FINISH AND TEXTURE. |
| P39. | PATTERNED GLASS WINDOW PER SPEC. |
| P40. | EXISTING METAL GATE |
| P41. | ROOF DRAIN SEE DETAIL 3/A7.31 |
| P42. | INSTALL NEW CABINET DOORS ON EXISTING CABINET. SEE DETAIL 5/A8.02 |
| P43. | STAGELAM HIGH TRAFFIC FLOORING |
| P44. | EXISTING CONCRETE PAD TO REMAIN |
| P45. | EXISTING DIVIDED LIGHT TRANSOM/DOOR ASSEMBLY |
| P46. | CONCRETE SUMP PIT W/ STEEL GRATE |
| P47. | FURR OVER WINDOW. |

GENERAL NOTES

- DIMENSIONS ARE TO FACE OF STUD, FACE OF MASONRY OR FACE OF CONCRETE UNLESS NOTED OTHERWISE.
- INFORM ARCHITECT OF ANY DISCREPANCIES BEFORE BEGINNING OF WORK.
- PRIOR TO CONSTRUCTION, CONTRACTOR SHALL FIELD VERIFY ALL EXISTING CONDITIONS. IN AREAS REQUIRING REPAIR AND/OR REMOVAL, CONTRACTOR SHALL PATCH AND PREP SURFACES FOR NEW FINISH.
- PATCH ALL HOLES IN EXTERIOR CONCRETE WALLS INCLUDING LADDER HOLES, CONDUIT, AND PIPE HOLES, ETC. CAUSED BY DEMO. REPAIR AND PAINT ALL CRACK SPACE VENT GRILLES - TYPICAL.

WALL TYPES

- WALL TYPE SYMBOL - SEE SHEET A2.32 & A2.33 FOR WALL TYPES
- NOTES**
- WALL TYPES WITH AN "S" SUBSCRIPT INDICATE FIBERGLASS ACOUSTICAL INSULATION FULL HEIGHT AND DEPTH OF PARTITION NOTED AND REQUIRES THE GYP. BOARD TO EXTEND FROM TOP OF FLOOR SLAB TO UNDERSIDE OF STRUCTURE ABOVE ON ONE SIDE OF PARTITION THAT OTHERWISE WOULD NOT EXTEND TO THE STRUCTURE ABOVE.
 - PROVIDE HEAVY GAGE METAL STUDS IN LIEU OF LIGHT GAGE METAL STUDS AT WALLS WITH ANY WALL HUNG TYPE ATTACHMENTS AND/OR SUPPORTING ATTACHMENTS SUCH AS WALL SINKS, GRAB BARS, WALL CABINETS AND OTHER MISC. EQUIPMENT.
 - ALL WALLS IN WET AREAS SHALL HAVE 5/8" TYPE "X" WATER-RESISTANT GYPSUM BOARD IN LIEU OF 5/8" TYPE "X" (REGULAR) GYPSUM BOARD.
 - ALL INTERIOR PARTITIONS ARE NON-BEARING.
 - WALLS WITH SUBSCRIPT "T" INDICATES WALLS WITH THERMAL INSULATION FOR THE FULL HEIGHT OF THE WALL.

WALL LEGEND

- FRAMED INTERIOR PARTITION
- EXISTING CONCRETE PARTITION
- NEW CONCRETE PARTITION
- FURRED CONCRETE PARTITION
- 1 HOUR RATED FRAMED INTERIOR PARTITION PER L.L. DESIGN W2005. SEE DETAIL 11/A9.06.

BUILDING MAP

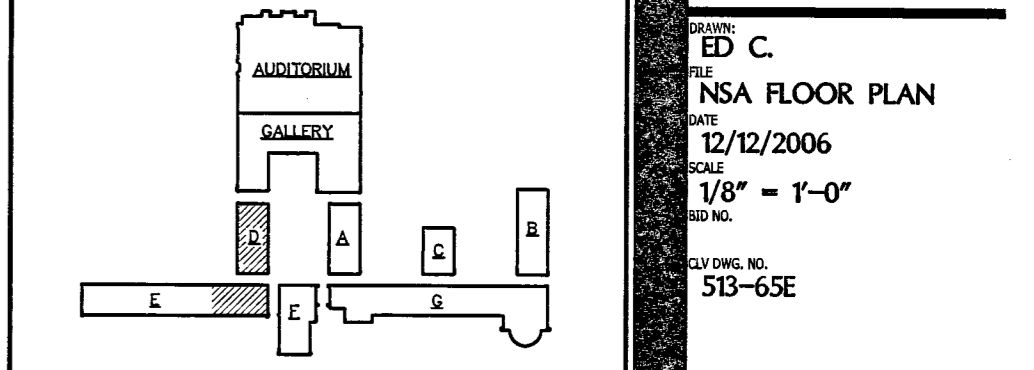

CLV COMMENTS
4-1-2007

OWNER COMMENTS
8-1-2007

ARCH. COORDINATION
8-1-2007

ARCHITECT
KGA ARCHITECTURE
KOTIALL GARLOUGH
ARCHITECTS
100 SOUTH FRANKS AVENUE
LAS VEGAS, NEVADA 89101
WWW.KGAARCHITECTURE.COM
TEL: (702) 388-6848
FAX: (702) 388-6848

STRUCTURAL
BARKER DROTTER ASSOCIATES
STRUCTURAL ENGINEERS
PHONE: 702-362-9000

Mechanical - Plumbing - Electrical
JEK & ASSOCIATES - CIVIL ENGINEERING
JEK CONSULTING ENGINEERS
PHONE: 702-362-9000

STAGE LIGHTING & DESIGN
COHM LIGHTING DESIGN GROUP
PHONE: 88-28-2323

LANDSCAPE
JWZUNDO & ASSOCIATES
PHONE: 702-362-9000

COST ESTIMATING
RIDER HUNT
LEVITT & BAILEY
702-362-9000

ADA ACCESIBILITY
ENDELMAN AND ASSOCIATES
PHONE: 360-341-9400

CITY OF LAS VEGAS REDEVELOPMENT AGENCY

OWNER: CITY OF LAS VEGAS
DEPARTMENT OF PUBLIC WORKS ARCHITECTURAL SERVICES

400 EAST STEWART AVENUE
LAS VEGAS, NEVADA 89101
PHONE: (702) 229-6835
FAX: (702) 388-6848
TDD: (702) 388-6848

ED C.
NSA FLOOR PLAN
12/12/2006
SCALE:
1/8" = 1'-0"
10' NO.

CLV NO.:
513-65E

DR. NO.:
A1.14

ENLARGED FLOOR PLAN - NEVADA SCHOOL OF THE ARTS
SCALE: 1/4" = 1'-0"