

SEE DRAWINGS C-6 AND C-7 FOR DRAINAGE PLAN

SEE DRAWING R-9 FOR INTERSECTION DETAIL

- REMOVAL ITEMS**
- [F] REMOVE AC PAVEMENT
  - [L] REMOVE GUARDRAIL TO CONSTRUCTION LIMITS
  - [M] REMOVE BITUMINOUS SHOULDER DIKE
- CONSTRUCTION ITEMS**
- ① "MLK-S" 0+046.038, 4.505m RT TO "MLK-S" 0+127.570, 2.400m RT  
CONSTRUCT GALVANIZED GUARDRAIL (TRIPLE CORRUGATION NDOT) STD. DWG. R-8.1.5.1
  - ② "MLK-S" 0+045.070, 4.500m RT TO "MLK-S" 0+127.570, 2.400m RT  
CONSTRUCT BITUMINOUS SHOULDER DIKE. NDOT STD DWG R-8.1.4
  - ③ "MLK-S" 0+007.340, 5.400m LT TO "MLK-S" 0+127.570, 5.400m LT  
CONSTRUCT TYPE I CURB AND GUTTER NDOT STD DRAWING R-5.1.1
  - ④ "MLK-S" 0+036.565, 8.462m RT TO "MLK-S" 0+046.038, 4.505m RT  
CONSTRUCT GUARDRAIL TERMINAL (FLARED)

"MLK-S" CURVE DATA

No.	Δ	R	L	T
C9	27°25'09"	54.000m	25.842m	13.173m

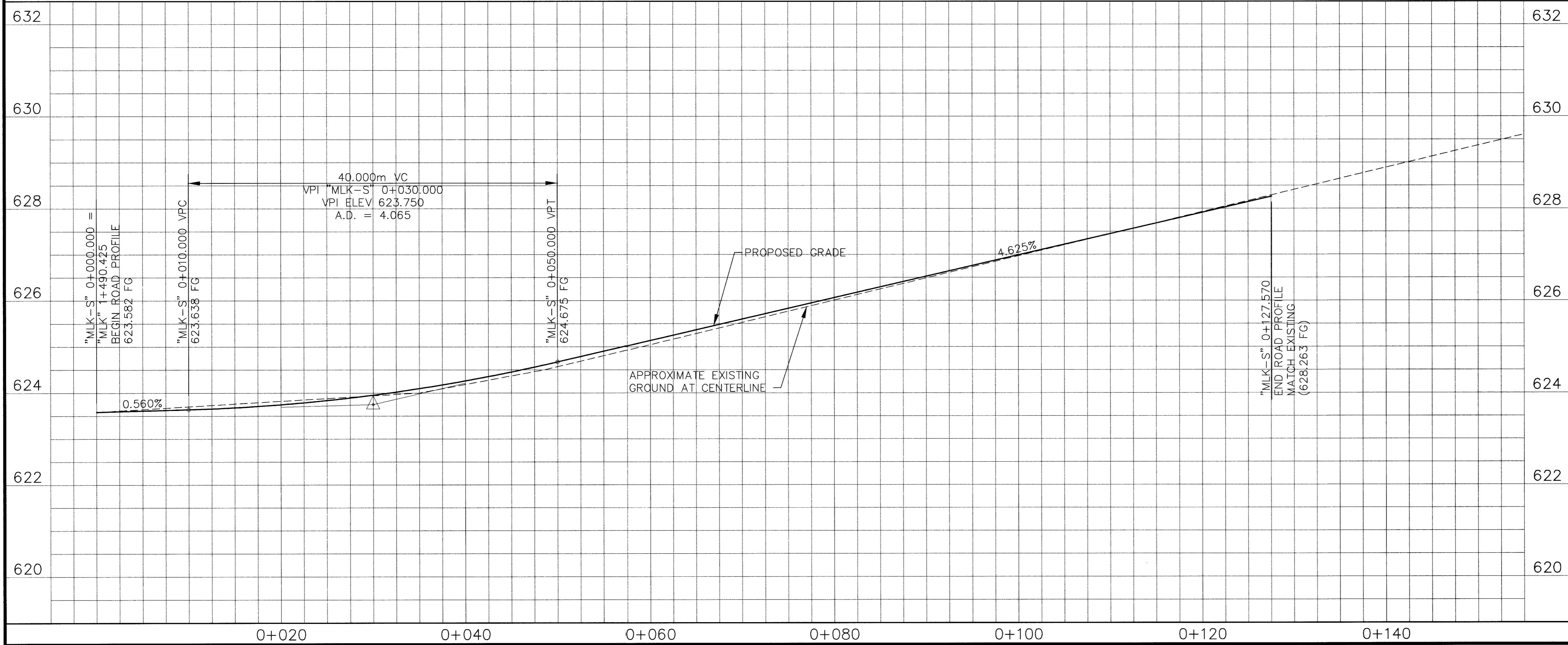

**Call before you Dig.**  
1-800-277-2600  
UNDERGROUND SERVICE (USA)

**Call before you Overhead**  
563-6111  
OVERHEAD SERVICE (USA)

DATE	4/20/03
REVISIONS	
RECORD DRAWING	
PROJECT #	31604
DESIGN BY	KFN
SCALE (V)	1:50
DATE	DEC 17, 1999
SCALE (H)	1:250
FLD. BK. #	N/A

**PARSONS BRINCKERHOFF**  
Las Vegas, Nevada

**DEPARTMENT OF PUBLIC WORKS**  
I-15 FREEWAY CHANNEL  
CONSTRUCTION PLAN AND PROFILE  
"MLK-S" 0+000 TO "MLK-S" 1+500

**JOHN CLARK**  
CIVIL ENGINEER

DRAWING No.	102
<b>RECORD DRAWING</b>	<b>METRIC</b>
<b>R-6</b>	241