

- CONSTRUCTION ITEMS**
- ① "MLK" 1+300.000, 11.200m LT TO CONSTRUCT 200mm SANITARY SEWER
 - "MLK" 1+320.000, 10.700m LT TO CONSTRUCT 200mm SANITARY SEWER
 - "MLK" 1+320.000, 10.700m LT TO CONSTRUCT TYPE I SANITARY SEWER MH
 - "MLK" 1+386.916, 10.660m LT TO CONSTRUCT TYPE I SANITARY SEWER MH
 - "MLK" 1+440.000, 14.149m LT TO CONSTRUCT TYPE I SANITARY SEWER MH
 - "MLK" 1+386.916, 10.660m LT TO CONSTRUCT TYPE I SANITARY SEWER MH
 - "MLK" 1+387.010, 16.112m LT TO CONSTRUCT TYPE I SANITARY SEWER MH
 - "MLK" 1+386.916, 10.660m LT TO CONSTRUCT TYPE I SANITARY SEWER MH

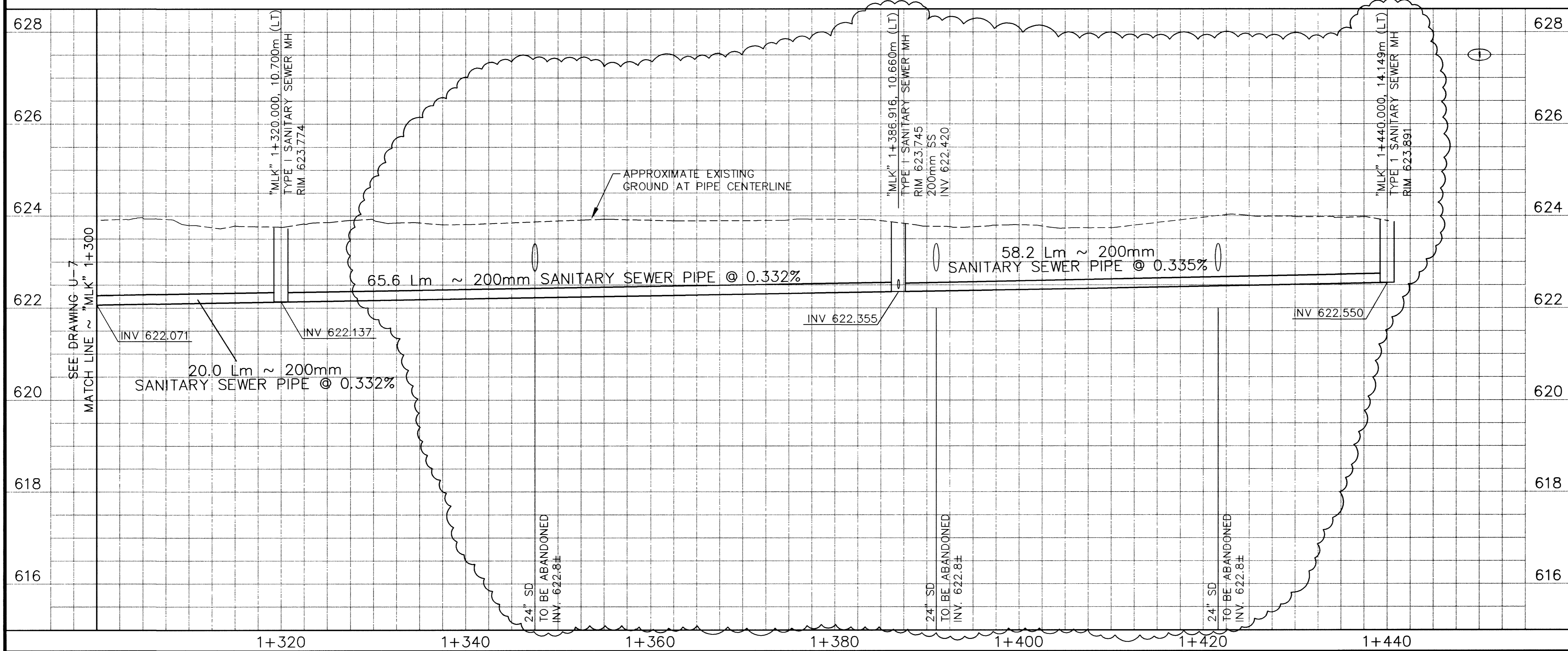

APPROVED FOR CONSTRUCTION

LAS VEGAS VALLEY WATER DISTRICT DATE

Call before you Dig.
1-800-227-2600
UNDERGROUND SERVICE (USA)

Call before you Overhead.
563-6111
OVERHEAD SERVICE (USA)

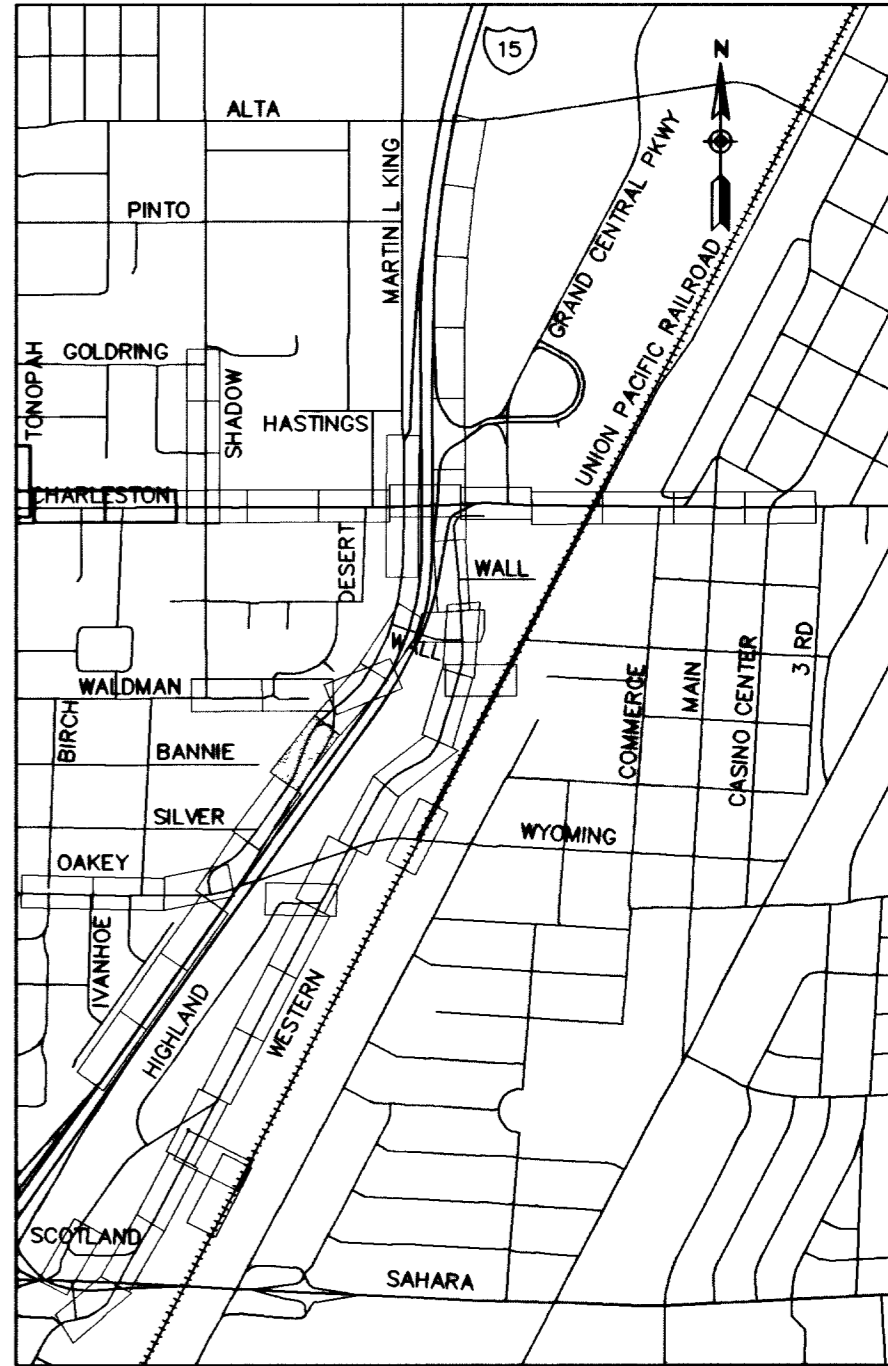

DATE	REVISIONS
6/29/00	REVISION FOR CIV FIRE STATION RECORD DRAWING
4/20/03	

SCALE (H) 1:250
SCALE (V) 1:50
FLD. BK. # N/A
PROJECT # 31804
DESIGN BY KFN
DATE DEC 17, 1999

PARSONS BRINCKERHOFF
Las Vegas, Nevada



DEPARTMENT OF PUBLIC WORKS
I-15 FREEWAY CHANNEL
UTILITY RELOCATION (MLK BLVD)
"MLK" 1+300 TO "MLK" 1+440

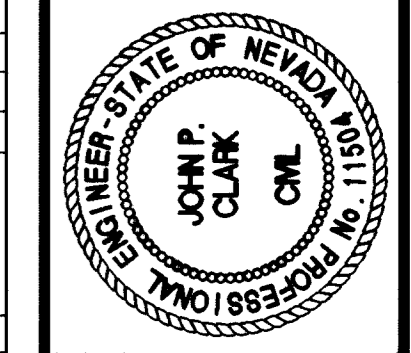

DRAWING No. 167
U-8

5262