

26-5-4

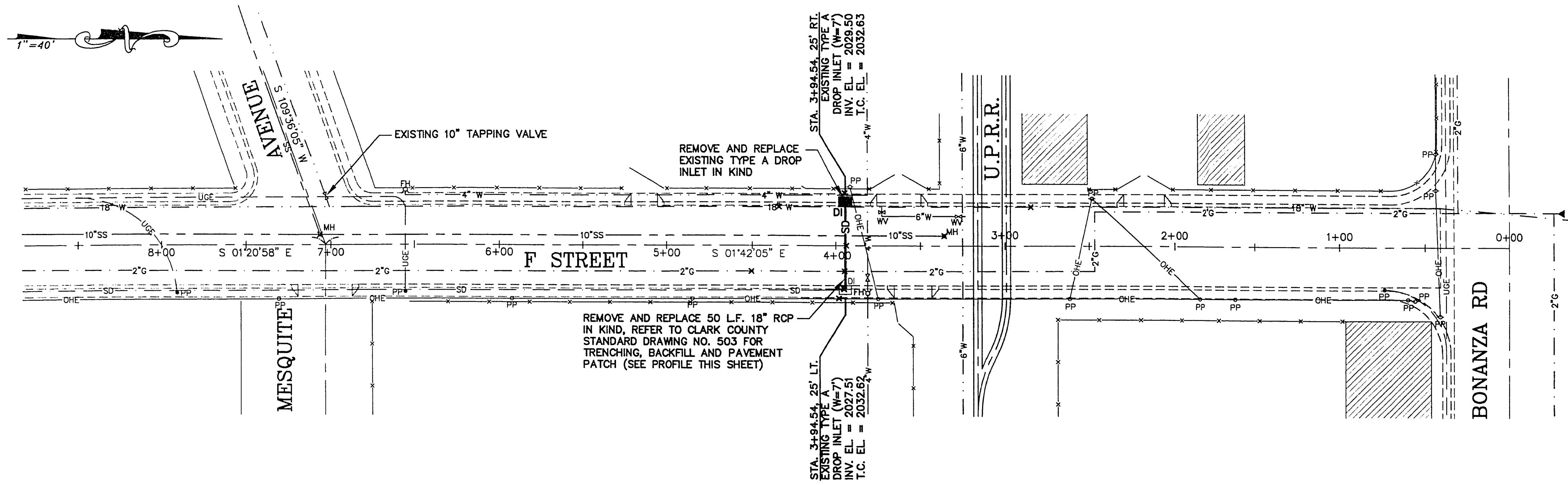

F STREET PLAN VIEW
SCALE: 1"=40'

NOTE:

THE UTILITIES SHOWN ON THIS DRAWING WERE OBTAINED BY A SEARCH OF AVAILABLE RECORDS. THE CONTRACTOR MUST VERIFY HORIZONTAL AND VERTICAL LOCATION OF EXISTING UTILITIES PRIOR TO CONSTRUCTION.

APPROVAL

[Signature]
DENNIS ANDERSON, P.E.
LAS VEGAS CITY ENGINEER

1-30-95
DATE

PROJECT BENCHMARK

CITY OF LAS VEGAS - 2LV01-27SWW6 ELEV. 2036.715
RIVET AND PLATE IN THE TOP OF CURB AT THE NORTHEAST RETURN OF BONANZA ROAD AND H STREET.

BASIS OF BEARING

NORTH 01°42'05" WEST, BEING THE BEARING OF THE CENTERLINE OF F STREET AS SHOWN ON A PARCEL MAP ON FILE IN CLARK COUNTY RECORDER'S OFFICE IN FILE 48 OF PARCEL MAPS, AT PAGE 25.

2 working days
Call before you Dig
1-800-227-2600

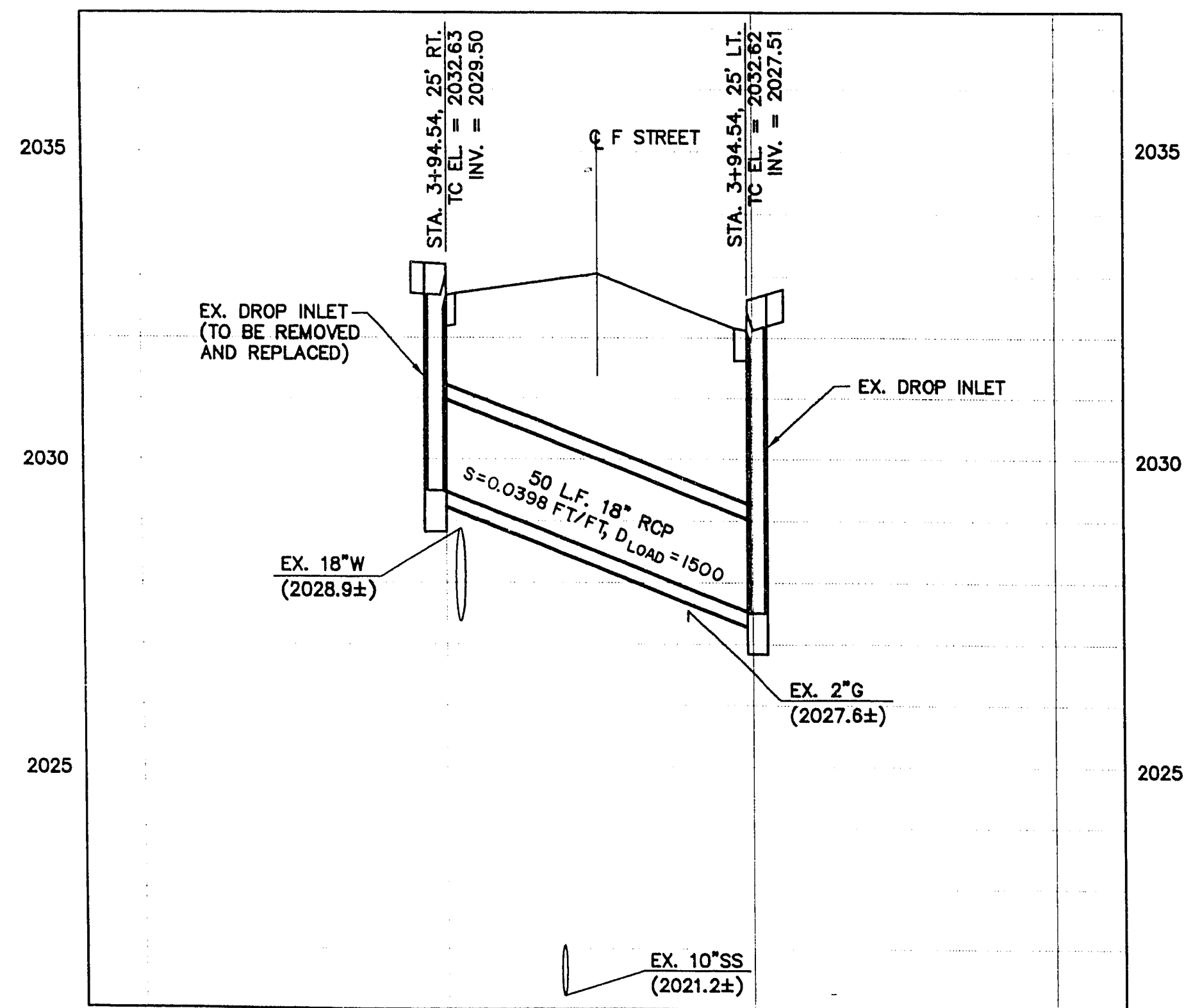

STORM DRAIN PROFILE
SCALE: HORIZ. 1"=20'
VERT. 1"=2'

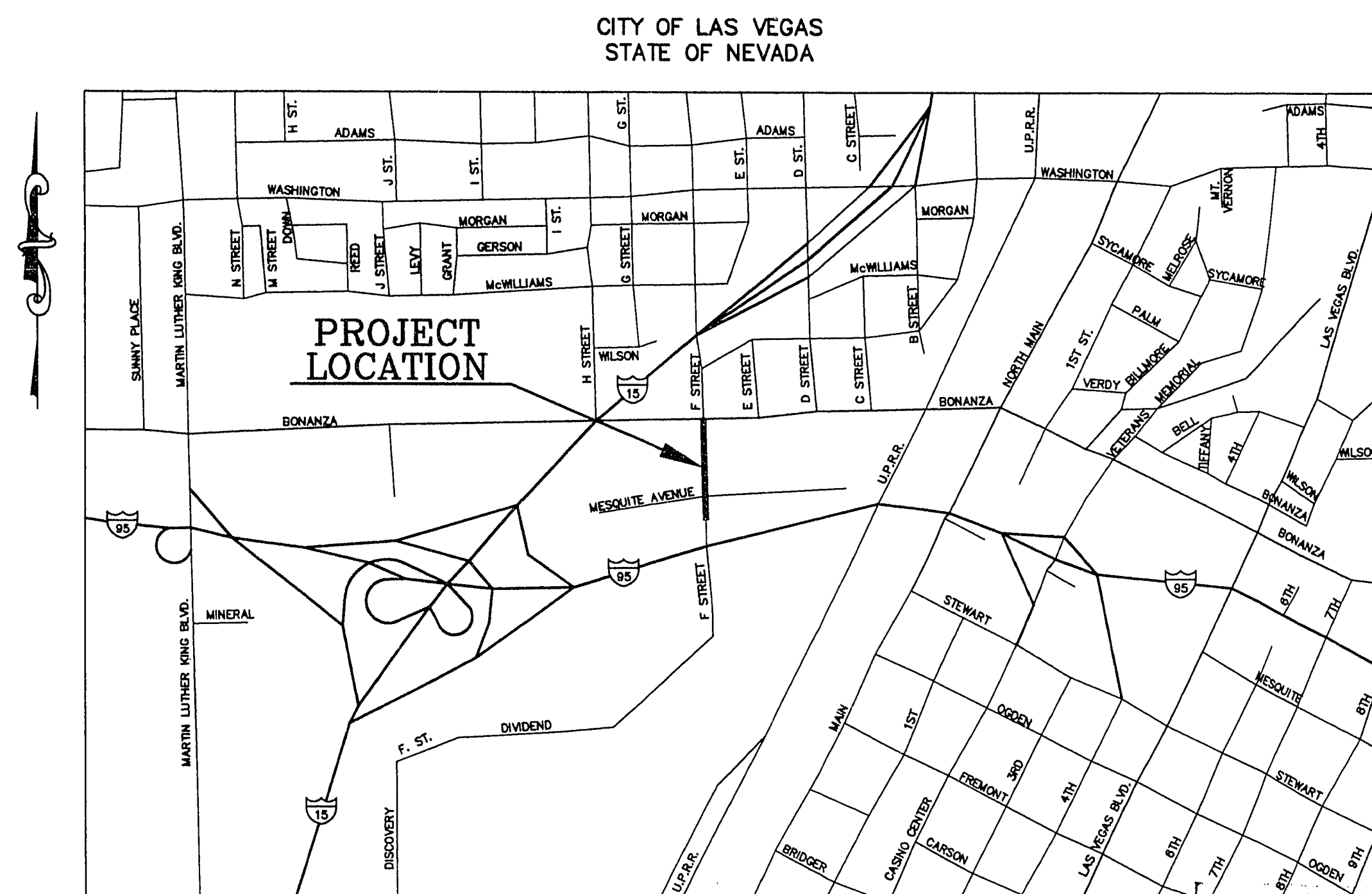

VICINITY MAP
NO SCALE

CITY OF LAS VEGAS
CLARK COUNTY, NEVADA

CONSULTING ENGINEERS • PLANNERS • LAND SURVEYORS
2727 SOUTH RAINBOW BOULEVARD
LAS VEGAS, NEVADA 89102-5148 PHONE (702) 873-7550 FAX (702) 362-2587

vtn nevada

TITLE: PLAN VIEW AND STORM DRAIN PROFILE
PROJECT: F STREET STORM DRAIN REPLACEMENT

1-24-95

WD NO. 4788
BY: WBM/SJF
DATE: 1/24/95
SCALE: HORIZ. AS NOTED
VERT. NONE

1 OF 1 SHEETS

